

NO. OF COPIES RECEIVED	5
DISTRIBUTION	
SANTA FE	1
FILE	2
U.S.G.S.	1
LAND OFFICE	
OPERATOR	1

NEW MEXICO OIL CONSERVATION COMMISSION

30-031-20585
Form C-101
Revised 1-1-65

5A. Indicate Type of Lease
STATE <input type="checkbox"/> FEE <input checked="" type="checkbox"/>
5. State Oil & Gas Lease No.
N/A

APPLICATION FOR PERMIT TO DRILL, DEEPEN, OR PLUG BACK

1a. Type of Work		7. Unit Agreement Name	
DRILL <input checked="" type="checkbox"/> DEEPEN <input type="checkbox"/> PLUG BACK <input type="checkbox"/>		N/A	
b. Type of Well		8. Farm or Lease Name	
OIL WELL <input checked="" type="checkbox"/> GAS WELL <input type="checkbox"/> OTHER <input type="checkbox"/>		Santa Fe Pacific 9-18	
2. Name of Operator		9. Well No.	
RIO COLORADO OIL & GAS, INC.		# 3	
3. Address of Operator		10. Field and Pool, or Wildcat	
1546 Cole Boulevard, Golden, Colorado 80401		Wildcat <u>Dakota</u>	
4. Location of Well		12. County	
UNIT LETTER <u>I</u> LOCATED <u>330</u> FEET FROM THE <u>East</u> LINE		McKinlev	
AND <u>2310</u> FEET FROM THE <u>South</u> LINE OF SEC. <u>18</u> TWP. <u>17N</u> RGE. <u>9W</u> NADPM			
19. Proposed Depth		19A. Formation	
2,500		Dakota	
20. Rotary or C.T.		Rotary	
1. Elevations (Show whether D.P., R.P., etc.)		21A. Kind & Status Plug, Bond	
6979' G.L.		1 well	
21B. Drilling Contractor		22. Approx. Date Work will start	
Stewart Drilling		November 20, 1979	

23. PROPOSED CASING AND CEMENT PROGRAM

SIZE OF HOLE	SIZE OF CASING	WEIGHT PER FOOT	SETTING DEPTH	SACKS OF CEMENT	EST. TOP
8-3/4"	7"	17 lb.	100'	30 SX	Surface
6 1/2"	4 1/2"	9.5 lb.	2500'	65 SX	1750

1. Drill 8-3/4" diameter hole to 100'+ and run 7" casing to bottom and cement to surface.
2. Drill 6-1/4" diameter hole to total depth.
3. Drillstem test all oil and gas shows that warrant testing.
4. Run Induction-Electric log from total depth to base of surface casing. Run porosity logs over all porous zones.
5. Run 4 1/2" production casing and production test all formations that warrant production testing.

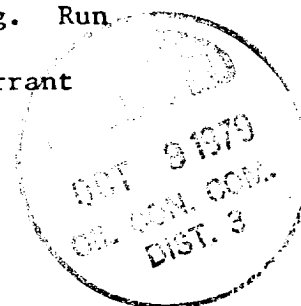

IN ABOVE SPACE DESCRIBE PROPOSED PROGRAMS IF PROPOSAL IS TO DEEPEN OR PLUG BACK, GIVE DATA ON PRESENT PRODUCTIVE ZONE AND PROPOSED NEW PRODUCTIVE ZONE, GIVE BLOWOUT PREVENTER PROGRAM, IF ANY.

I hereby certify that the information above is true and complete to the best of my knowledge and belief.

Signed [Signature] Title Petroleum Engineer Date 9/25/79

(This space for State Use)

APPROVED BY [Signature] TITLE DEPUTY OIL & GAS ENGINEER, DIST. 3 DATE 5 1979

CONDITIONS OF APPROVAL, IF ANY:

NEW MEXICO OIL CONSERVATION COMMISSION
WELL LOCATION AND ACREAGE DEDICATION PLAT

Form C-102
Supersedes C-128
Effective 1-1-65

All distances must be from the outer boundaries of the Section.

Operator <i>Rio Colorado Oil & Gas Inc.</i>		Lease <i>Santa Fe - Pacific #9-18</i>		Well No. <i>3</i>	
Unit Letter <i>I</i>	Section <i>18</i>	Township <i>17 North</i>	Range <i>9 West</i>	County <i>McKinley</i>	
Actual Postage Location of Well: <i>2.310</i> feet from the <i>South</i> line and <i>3.30</i> feet from the <i>East</i> line					
Ground Level Elev. <i>6979'</i>	Producing Formation <i>Dakota</i>		Pool <i>Wildcat</i>	Dedicated Acreage: <i>40</i>	

1. Outline the acreage dedicated to the subject well by colored pencil or hatchure marks on the plat below.
2. If more than one lease is dedicated to the well, outline each and identify the ownership thereof (both as to working interest and royalty).
3. If more than one lease of different ownership is dedicated to the well, have the interests of all owners been consolidated by communitization, unitization, force-pooling, etc?

☐ Yes ☐ No If answer is "yes," type of consolidation _____

If answer is "no," list the owners and tract descriptions which have actually been consolidated. (Use reverse side of this form if necessary.) _____

No allowable will be assigned to the well until all interests have been consolidated (by communitization, unitization, forced-pooling, or otherwise) or until a non-standard unit, eliminating such interests, has been approved by the Commission.

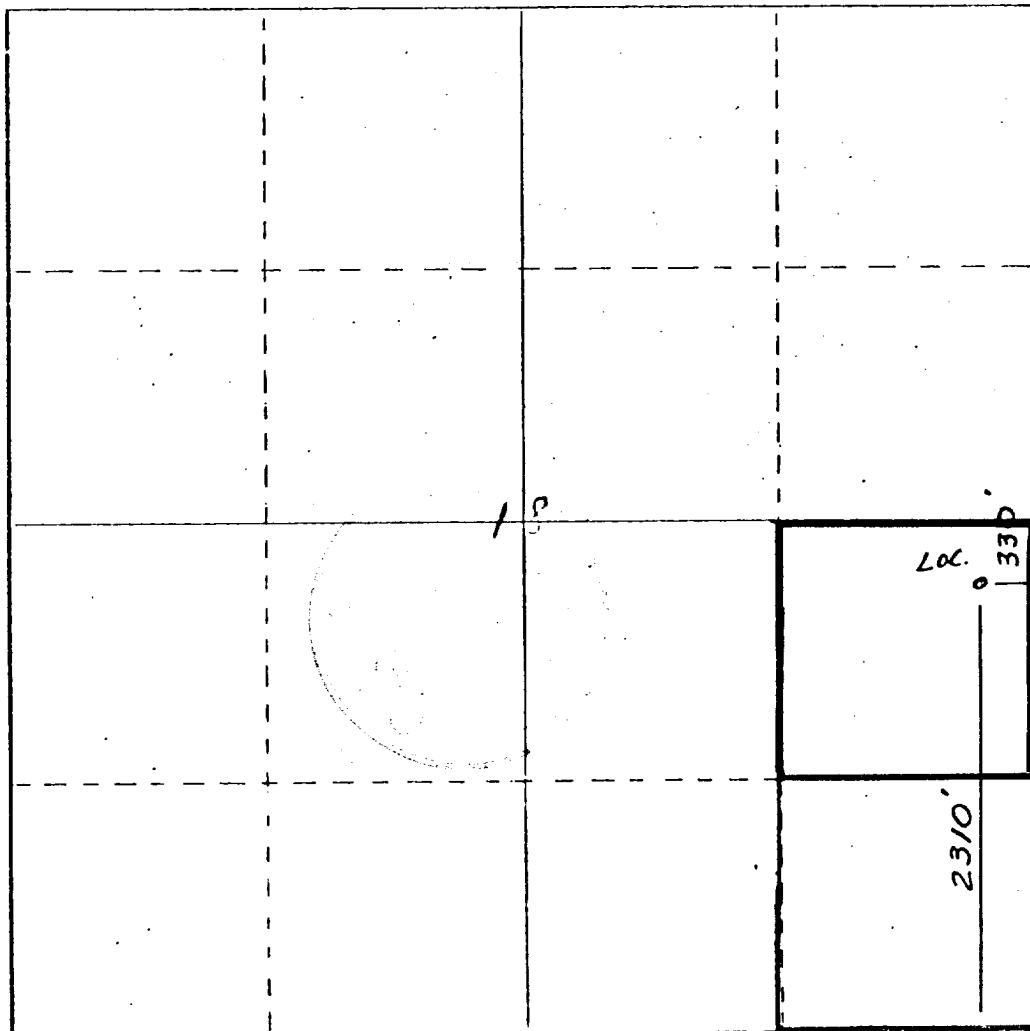

CERTIFICATION

I hereby certify that the information contained herein is true and complete to the best of my knowledge and belief.

Name *Harold M. Edwards*
Position *Agent*
Company *Rio Colorado Oil & Gas Inc.*

Date *9-29-79*

I hereby certify that the well location shown on this plat was plotted from field notes of actual surveys made by me or under my supervision and that the same is true and correct to the best of my knowledge and belief.

Date Surveyed *9-29-79*
Harold M. Edwards
Registered Professional Engineer
and/or Land Surveyor

Certificate No. *6857*

