

NO. OF COPIES RECEIVED	6
DISTRIBUTION	
SANTA FE	
FILE	
U.S.G.S.	2
LAND OFFICE	
OPERATOR	2

NEW MEXICO OIL CONSERVATION COMMISSION

38-031-20588
Form C-101
Revised 1-1-65

5A. Indicate Type of Lease	
STATE <input type="checkbox"/>	FEE <input checked="" type="checkbox"/>
5. State Oil & Gas Lease No.	

APPLICATION FOR PERMIT TO DRILL, DEEPEN, OR PLUG BACK

1a. Type of Work			7. Unit Agreement Name		
b. Type of Well DRILL <input checked="" type="checkbox"/> DEEPEN <input type="checkbox"/> PLUG BACK <input type="checkbox"/> OIL WELL <input checked="" type="checkbox"/> GAS WELL <input type="checkbox"/> OTHER <input type="checkbox"/> SINGLE ZONE <input checked="" type="checkbox"/> MULTIPLE ZONE <input type="checkbox"/>			8. Farm or Lease Name Santa Fe 4-20-10		
2. Name of Operator Dome Petroleum Corp.			9. Well No. 1		
3. Address of Operator 501 Airport Drive, Suite 107, Farmington, NM 87401			10. Field and Pool, or Wildcat Wildcat - Entrada		
4. Location of Well UNIT LETTER <u>H</u> LOCATED <u>1700</u> FEET FROM THE <u>North</u> LINE AND <u>460</u> FEET FROM THE <u>East</u> LINE OF SEC. <u>4</u> TWP. <u>20N</u> RGE. <u>10W</u> NMPM			12. County McKinley		
21. Elevations (Show whether DF, RT, etc.) 6241' GR			19. Proposed Depth 5255		19A. Formation Entrada
21A. Kind & Status Plug. Bond Statewide		21B. Drilling Contractor Four Corners		20. Rotary or C.T. Rotary	
22. Approx. Date Work will start 12/15/79					

23.

PROPOSED CASING AND CEMENT PROGRAM

SIZE OF HOLE	SIZE OF CASING	WEIGHT PER FOOT	SETTING DEPTH	SACKS OF CEMENT	EST. TOP
13 1/4"	9 5/8"	32.5	200'	200	surface
8 3/4"	7"	20 & 23	5255'	900 - 2 stage	surface

Move in Rotary tools. Drill 13 1/4" hole to 200'. Set 200' of new 9 5/8" casing and cement as above. Wait on cement 12 hours. Install 10' 900 series blowout preventer and test to 500 psi before drilling out from under surface pipe. Drill 8 3/4" hole to total depth. No abnormal temperature or pressures are anticipated. Mud system will be low solids non dispersed mud, weighing 8.5 - 9.2# per gal., W.L. 8-10 cc, and viscosity 30-50 sec./quart. Logging program will be IES, FDC/CNL, with Caliper Log. If commercial 7" casing will be run and cemented as above. If non-commercial, plug and abandonment will follow NMOCC specifications.

APPROVAL TAND
FOR THE COMMISSION
1-27-80



IN ABOVE SPACE DESCRIBE PROPOSED PROGRAM: IF PROPOSAL IS TO DEEPEN OR PLUG BACK, GIVE DATA ON PRESENT PRODUCTIVE ZONE AND PROPOSED NEW PRODUCTIVE ZONE. GIVE BLOWOUT PREVENTER PROGRAM, IF ANY.

I hereby certify that the information above is true and complete to the best of my knowledge and belief.

Signed [Signature] Title Drilling and Production Foreman Date 10/25/79

(This space for State Use)

APPROVED BY [Signature] TITLE Drilling and Production Foreman DATE OCT 29 1979

CONDITIONS OF APPROVAL, IF ANY:

OIL CONSERVATION DIVISION

STATE OF NEW MEXICO
ENERGY AND MINERALS DEPARTMENTP. O. BOX 2088
SANTA FE, NEW MEXICO 87501Form C-107
Revised 10-1-78

All distances must be from the outer boundaries of the Section.

Operator DOMO PETROLEUM CORPORATION			Lease SANTA FE 4-20-10			Well No. 1		
Unit Letter H	Section 4	Township 20N	Range 10W	County McKinley				
Actual Footage Location of Well:								
1700 feet from the North line and 460 feet from the East line								
Ground Level Elev. 6241	Producing Formation Entrada		Pool Undesignated Entrada			Dedicated Acreage: 40 Acres		

1. Outline the acreage dedicated to the subject well by colored pencil or hachure marks on the plat below.

2. If more than one lease is dedicated to the well, outline each and identify the ownership thereof (both as to working interest and royalty).

3. If more than one lease of different ownership is dedicated to the well, have the interests of all owners been consolidated by communitization, unitization, force-pooling, etc?

☐ Yes ☐ No If answer is "yes," type of consolidation _____

If answer is "no," list the owners and tract descriptions which have actually been consolidated. (Use reverse side of this form if necessary.) _____

No allowable will be assigned to the well until all interests have been consolidated (by communitization, unitization, forced-pooling, or otherwise) or until a non-standard unit, eliminating such interests, has been approved by the Commission.

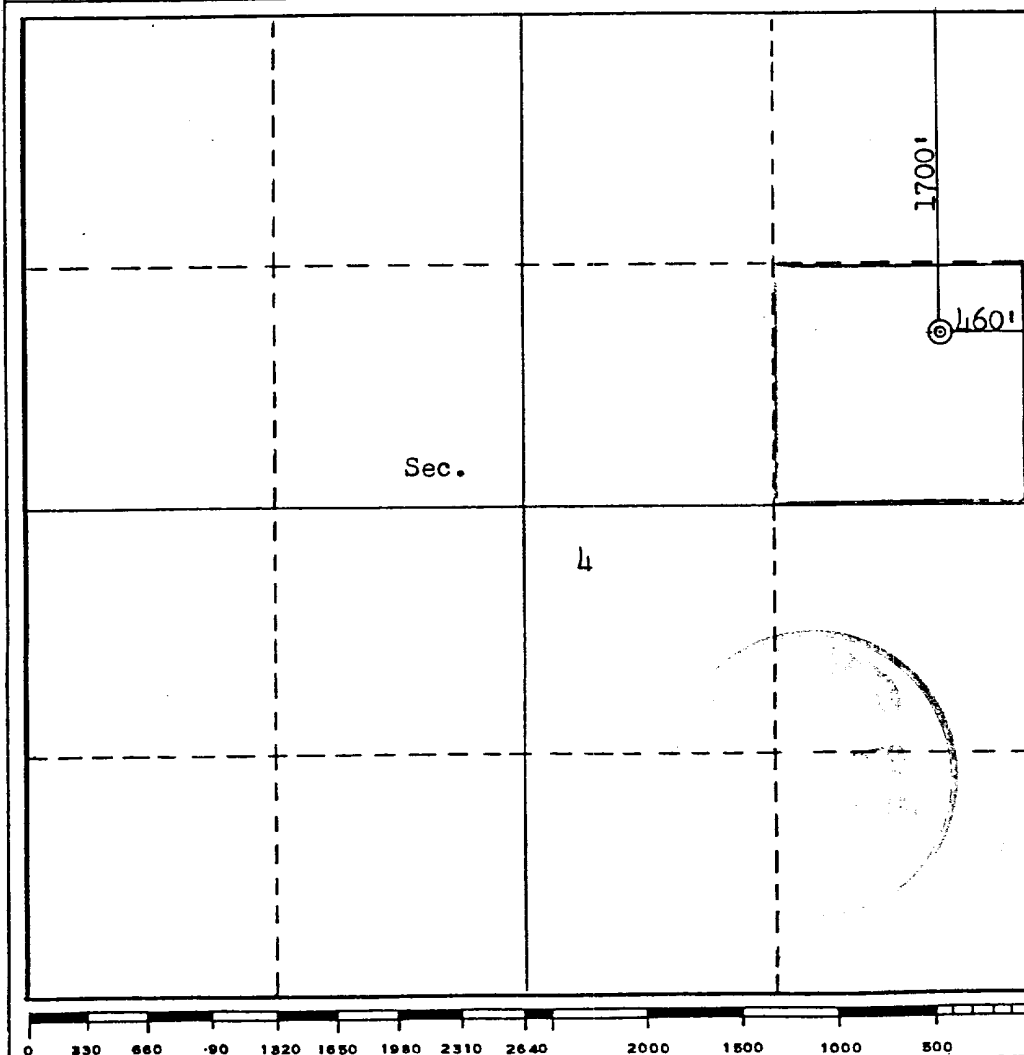

CERTIFICATION

I hereby certify that the information contained herein is true and complete to the best of my knowledge and belief.

H. D. Hollingsworth
Name

H. D. Hollingsworth

Position

Drilling & Production Foreman

Company

Dome Petroleum Corp.

Date

October 25, 1979

I hereby certify that the well location shown on this plat was plotted from field notes of actual surveys made by me or under my supervision, and that the same is true and correct to the best of my knowledge and belief.

Date Surveyed

October 25, 1979

Registered Professional Engineer and/or Land Surveyor

Fred B. Kerr
Fred B. Kerr
Certificate No. 3950

3950

Vicinity Map for
DOME PETROLEUM CORP. #1 SANTA FE 4-20-10
1700' FNL 460' FEL Sec 4-T20N-R10W
MCKINLEY COUNTY, NEW MEXICO

