

UNITED STATES
DEPARTMENT OF THE INTERIOR
GEOLOGICAL SURVEY

APPLICATION FOR PERMIT TO DRILL, DEEPEN, OR PLUG BACK

1a. TYPE OF WORK

DRILL ☒DEEPEN ☐PLUG BACK ☐

b. TYPE OF WELL

OIL
WELL ☒GAS
WELL ☐OTHER ☐SINGLE
ZONE ☐MULTIPLE
ZONE ☐

2. NAME OF OPERATOR

Basin Fuels, Limited

3. ADDRESS OF OPERATOR

Suite 300, 300 W. Arrington, Farmington, N.M. 87401

4. LOCATION OF WELL (Report location clearly and in accordance with any State requirements.)*

At surface

K 2310' FSL, 1650' FWL

At proposed prod. zone

14. DISTANCE IN MILES AND DIRECTION FROM NEAREST TOWN OR POST OFFICE*

23 miles (Lybrook)

15. DISTANCE FROM PROPOSED*

LOCATION TO NEAREST

PROPERTY OR LEASE LINE, FT.

(Also to nearest drlg. unit line, if any) 1650'

18. DISTANCE FROM PROPOSED LOCATION*

TO NEAREST WELL, DRILLING, COMPLETED,

OR APPLIED FOR, ON THIS LEASE, FT.

990'

16. NO. OF ACRES IN LEASE

960

19. PROPOSED DEPTH

2800'

17. NO. OF ACRES ASSIGNED
TO THIS WELL

40

20. ROTARY OR CABLE TOOLS

Rotary

21. ELEVATIONS (Show whether DF, RT, GR, etc.)

6778' GR

22. APPROX. DATE WORK WILL START*
12/1/79 (If approval ob-
tained by that date)

23.

PROPOSED CASING AND CEMENTING PROGRAM

SIZE OF HOLE	SIZE OF CASING	WEIGHT PER FOOT	SETTING DEPTH	QUANTITY OF CEMENT
12-1/4	8-3/8	20	100	100 sacks
7-7/8	4-1/2	10.5	2800'	325 sacks

(SEE ATTACHMENTS)

Gas under this lease is not dedicated to a contract.



RECEIVED

NOV 13 1979

IN ABOVE SPACE DESCRIBE PROPOSED PROGRAM: If proposal is to deepen or plug back, give data on present productive zone and proposed new productive zone. If proposal is to drill or deepen directionally, give pertinent data on subsurface locations and measured and true vertical depths. Give blowout preventer program, if any.

24.

ORIGINAL SIGNED BY

SIGNED JOEL B. BURR JR.

TITLE General Partner

DATE Oct. 23, 1979

Joel B. Burr, Jr.

(This space for Federal or State office use)

PERMIT NO.

APPROVAL DATE

APPROVED BY

TITLE

DATE

CONDITIONS OF APPROVAL, IF ANY:

ok Brock

*See Instructions On Reverse Side

NEW MEXICO OIL CONSERVATION COMMISSION
WELL LOCATION AND ACREAGE DEDICATION PLAT

Form C-101
Supersedes C-128
Effective 1-1-65

All distances must be from the outer boundaries of the Section.

Operator BASIN FUELS, LTD.			Lease STAR		Well No. 7
Chart Letter	Section 7	Township 20 NORTH	Range 5 WEST	County MCKINLEY	
Actual Placement Location of Well: 2310 feet from the SOUTH line and 1650 feet from the WEST line					
Ground Level Elev. 6778	Producing Formation Mesaverde		Foot Franciscan Lake-Mesaverde		Dedicated Acreage: 40 Acres

1. Outline the acreage dedicated to the subject well by colored pencil or hachure marks on the plat below.
2. If more than one lease is dedicated to the well, outline each and identify the ownership thereof (both as to working interest and royalty).
3. If more than one lease of different ownership is dedicated to the well, have the interests of all owners been consolidated by communitization, unitization, force-pooling, etc?

☐ Yes ☐ No If answer is "yes," type of consolidation _____

If answer is "no," list the owners and tract descriptions which have actually been consolidated. (Use reverse side of this form if necessary.) _____

No allowable will be assigned to the well until all interests have been consolidated (by communitization, unitization, forced-pooling, or otherwise) or until a non-standard unit, eliminating such interests, has been approved by the Commission.

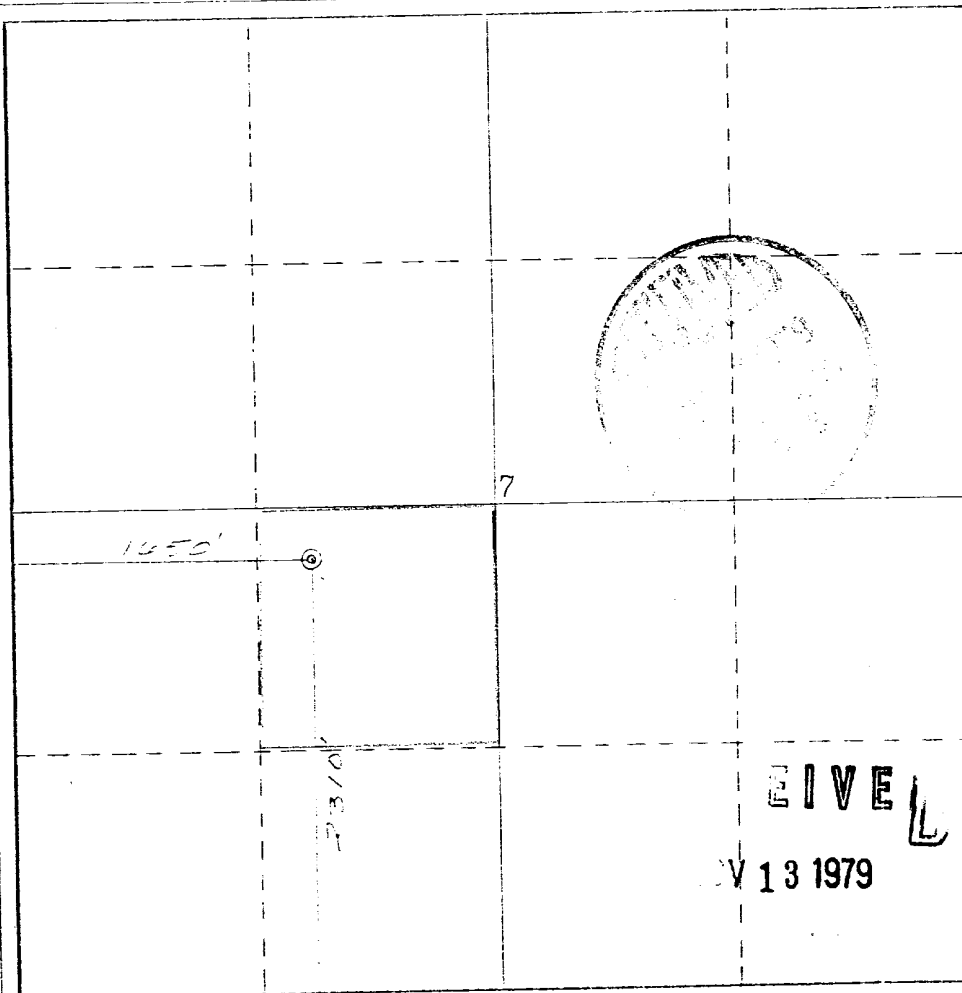

CERTIFICATION

I hereby certify that the information contained herein is true and complete to the best of my knowledge and belief.
ORIGINAL SIGNED BY
JOEL B. BURN JR.

Name
Partner
Position
Basin Fuels, Limited
Company
Nov. 2, 1979
Date

I hereby certify that the well location shown on this plat was plotted from field notes of actual survey made by me or under my supervision, and that the same is true to the best of my knowledge and belief.
JOEL B. BURN JR.

Date Surveyed
October 29, 1979
Registered Professional Engineer
and Land Surveyor

James P. Lease

Certificate No.

1463

0 330 660 990 1320 1650 1980 2310 2640 2970 3300 3630 3960 4290 4620 4950 5280 5610 5940 6270 6600

BASIN FUELS, LIMITED
FORMATION INFORMATION AND DRILLING PRACTICE

WELL:

STAR 7

LOCATION:

2310' FSL, 1650' FWL

Sec. 7-T20N-R5W

McKinley County, New Mexico

Lease Number:

NM 0555838-A

FIVE

NOV 13 1979

1. GEOLOGIC NAME OF SURFACE FORMATION

Kirtland

2. ESTIMATED TOPS OF IMPORTANT GEOLOGIC MARKERS

La Ventana	935'	Menefee	1901'
Chacra	1293'	Point Lookout	2735'
Cliff House	1839'		

3. ESTIMATED DEPTHS AT WHICH ANTICIPATED WATER, OIL, GAS OR OTHER MINERAL-BEARING FORMATIONS ARE EXPECTED:

2725' - Oil & Gas

4. PROPOSED CASING PROGRAM

Surface: 8 5/8" 20#, new casing to be set at 100'. Cement will be with 100 sacks class "B"+ 2% gel+ 0.5% CFR-2.

Production: 4 1/2" 10.5#, K-55 new casing to be set at 2800'. Cement will be 325 sacks class "B"+ 2% gel+ 0.5% CFR-2.

5. SPECIFICATIONS FOR PRESSURE CONTROL EQUIPMENT

The attached schematic shows the type of blowout preventer to be used while drilling. The unit will be tested to 200 psi as soon as possible after its installation on the surface pipe. Testing will be done with the rig pump. This is a manual-type preventer; its operation will be manually checked when practical.

6. DRILLING FLUIDS

DEPTH	TYPE	VISCOSITY	WEIGHT	FLUID LOSS (cc)
0-100	Gel-lime	35-45	8.6-9.0	N/C
100-2600	Low-solids	29-33	8.4-8.8	15
2600-2800	Gel-chem	35-40	8.8-9.4	8

7. AUXILIARY EQUIPMENT

- a. Bit float
- b. Full opening stabbing valve to be used when kelly is not in the string.

8. LOGGING-CORING-TESTING

Logging: Induction Electric Log, Formation Compensated Density, Gamma Ray Caliper
Coring: None
Drill Stem Testing: None

9. ABNORMAL TEMP., PRESSURE OR HAZARDOUS CONDITIONS

None expected.

FIVE

NOV 13 1979

10. STARTING DATE

Anticipated starting date is December 1, 1979*. Approximately six days will be needed to build roads and location and drill the well to total depth. If commercial, completion will commence immediately and require 10 days.

*If approval obtained by that date.

EIVE L

NOV 13 1979

BLOWOUT PREVENTERS

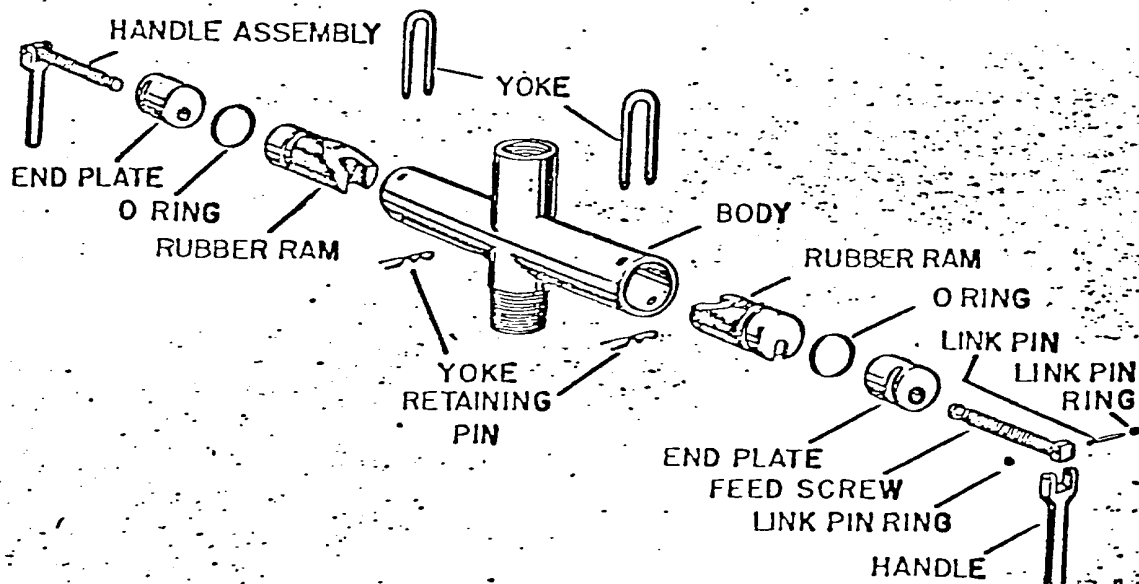

ATTACHMENT TO POINT 5
API SERIES 6" 600

V-13-1979

BASIN FUELS, LIMITED
DEVELOPMENT PLAN FOR SURFACE USE

WELL:

STAR 7

LOCATION:

2310' FSL, 1650' FWL

Sec. 7-T20N-R5W

McKinley County, New Mexico

Lease Number:

NM 0555838-A

EIVEL
V 13 1979

1. EXISTING ROADS (Shown in green)

The attached topographic map shows all existing roads within one mile of the proposed location. All roads are in fair condition and will require a minimal amount of work to upgrade them to handle normal drilling activity traffic.

2. PLANNED ACCESS ROAD (Shown in Red)

The new access road will be approximately 20' wide and 150' long. No cut, fill, turnouts or culverts will be needed. No fences, gates or cattle-guards will be crossed. Maximum grade will be 5%. Water bars will be used where needed to aid drainage.

3. LOCATION OF EXISTING WELLS

All production facilities for this well will be located on the site. All tank batteries, production facilities or production gathering and service lines within one mile of the proposed location are shown on the attached section layout.

4. LOCATION OF EXISTING PRODUCTION FACILITIES

All production facilities for this well will be located on the site. All tank batteries, production facilities or production gathering and service lines within one mile of the proposed location are shown on the attached section layout.

5. LOCATION AND TYPE OF WATER SUPPLY

Water for drilling will be trucked from local produced water holes. This water is privately owned.

6. SOURCE OF CONSTRUCTION MATERIAL

Any construction material required for road or location will be excess material accumulated during building of such sites.

7. METHODS OF HANDLING WASTE MATERIAL

(Refer to attached well site layout). All material that can be safely burned will be so disposed of when weather conditions permit. All nonburnable waste (drilling fluids, cuttings, chemicals, etc.) will be held in the reserve pit until dry, and then buried. Any oil that accumulates on the pit will be removed prior to leaving the pit to dry. Pits will be fenced during dryout, then completely backfilled with dirt prior to preparing the location for production or abandonment.

Any solid waste that cannot be buried will be taken from the location and properly destroyed.

8. ANCILLARY FACILITIES

None planned.

EIVE L

IV 13 1979

9. WELL SITE LAYOUT

The attached layout shows the drilling rig with all supporting facilities. Cut and fill, required for pad construction, is also shown.

10. PLANS FOR RESTORATION OF SURFACE

Restoration of the well site and access road will begin within 30 days of well completion, weather permitting. Should the well be abandoned, the drilling site will be reshaped to its approximate former contour. The access road will be reseeded when germination can occur. Should the well be commercial, that portion of location not needed for operation will be repaired as above. The portion of the location needed for daily production operations, and the access road, will be kept in good repair and clean.

In either case, cleanup of the site will include burning any safely burnable material, filling of all pits, and proper disposal of any nonburnable material that cannot be safely buried. Any oil that has accumulated on the pits will be trucked away.

11. OTHER INFORMATION

General topography of the area may be seen on the attached map. This location is 1 mile west of the Continental Divide at Deja Del Raton Mesa. The site has a small westerly slope. The area is sandy and is covered with sagebrush and native grasses. There is evidence of sheep and small animal life in the area.

Surface at this location belongs to the Bureau of Land Management. There are no occupied dwellings in the area.

There were no archeological or cultural sites visible on the location. The archaeologist's report is forthcoming.

12. JACK COOK

3-E Company, Inc.
Box 190
Farmington, N.M. 87401
Telephone: (505) 327-4020

13. I hereby certify that I or persons under my direct supervision, have inspected the proposed drill site and access route; that I am familiar with the conditions which presently exist; that the statements made in the plan are to the best of my knowledge, true and correct; and, that the work associated with the operations proposed herein will be performed by Basin Fuels, Limited, and its contractors and subcontractors in conformity with this plan and the terms and conditions under which it is approved.

ORIGINAL SIGNED BY
JOEL B. BURR JR.

Joel B. Burr, Jr.

October 23, 1979

FIVE

V 13 1979

JBB:jh

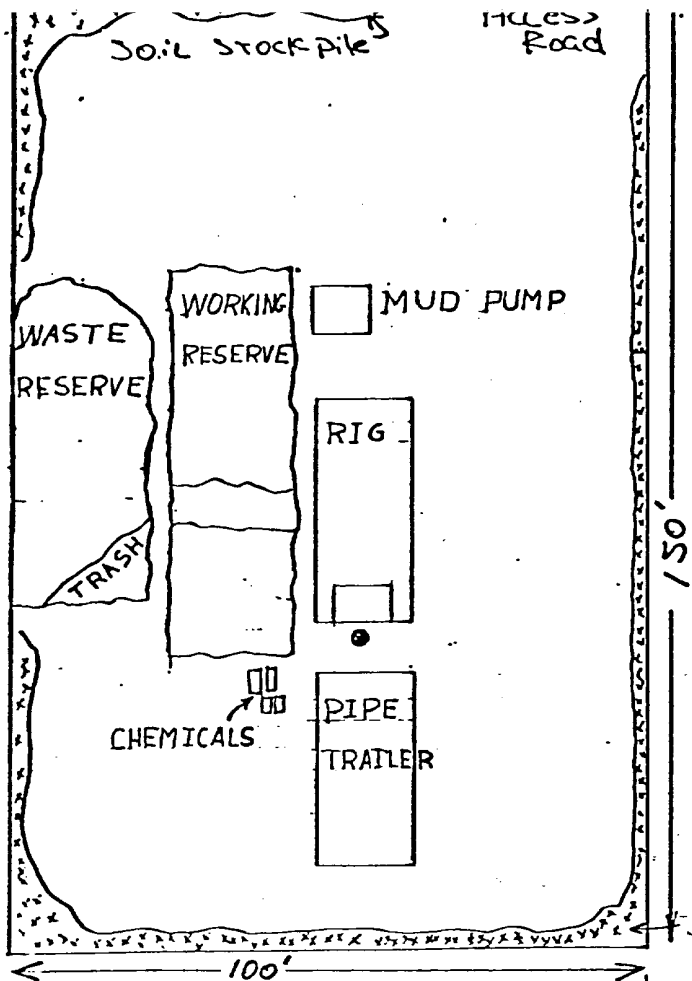

SOIL MATERIAL STOCKPILE

Vertical Scale 1" = 10'

PLAN VIEW 1" = 30'
ALL PITS - EARTHEN

WELL SITE LAYOUT
BASIN FUELS, LTD.

STAR NO. 7

location grade

EIVE

NOV 13 1979

O = Subject well
 Δ = Plugged & abandoned
 □ = Producing w/ tank on 10
 □ = Producing
 X = Injection well
 = WATER INJECTION L

Township 20 N, Range 5 & 6, County _____, State _____

R. 6 | R. 5

Standard Township Plat

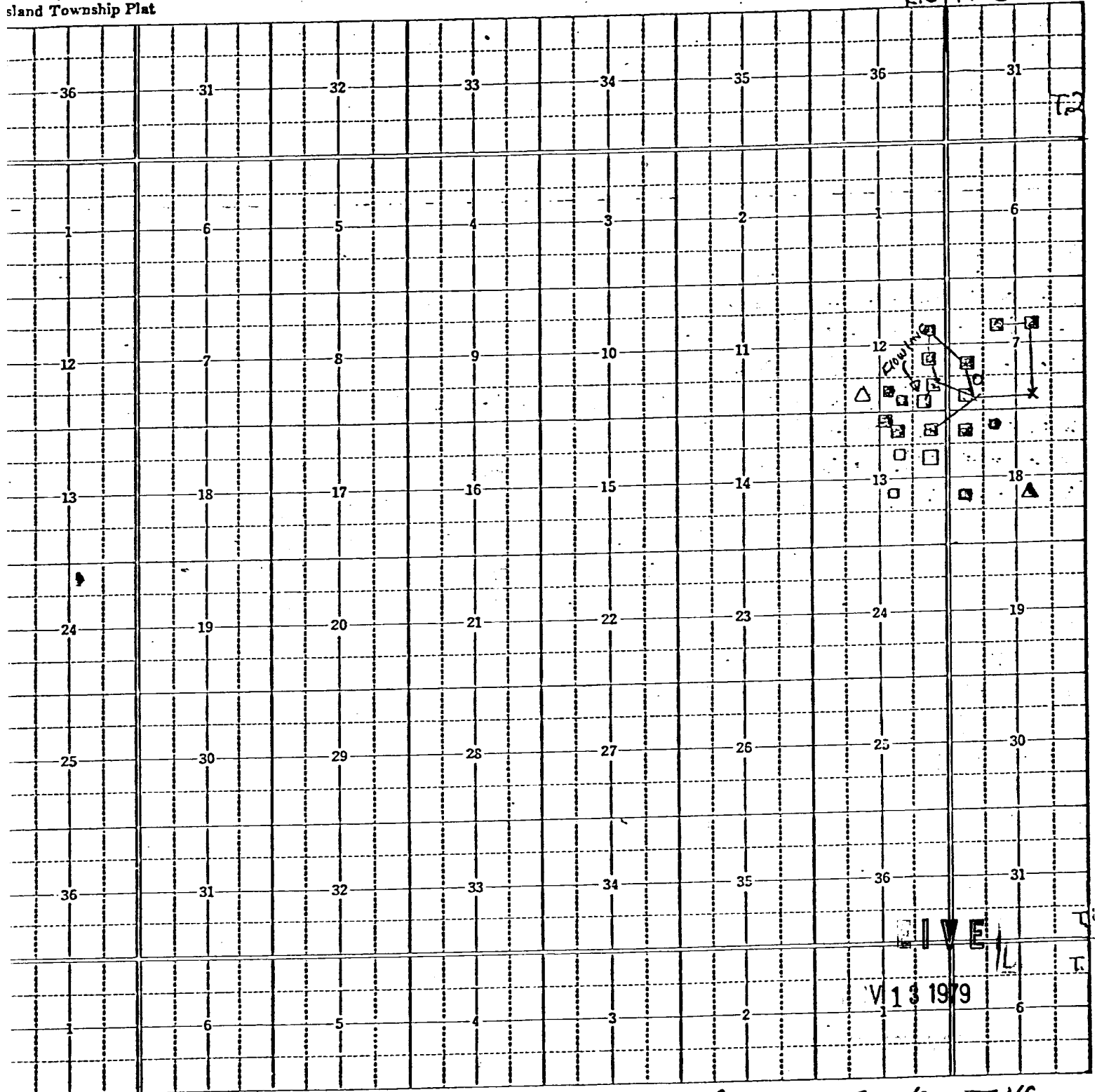

BASIN FUELS INC.
 OFFSET WELLS

STAR LAKE QUADRANG
NEW MEXICO
15 MINUTE SERIES (TOPOGRAPHIC)

25° 55' N. 106° 00' W.

1:50,000 FEET

32 SANDOVAL CO
31 MCKINLEY CO

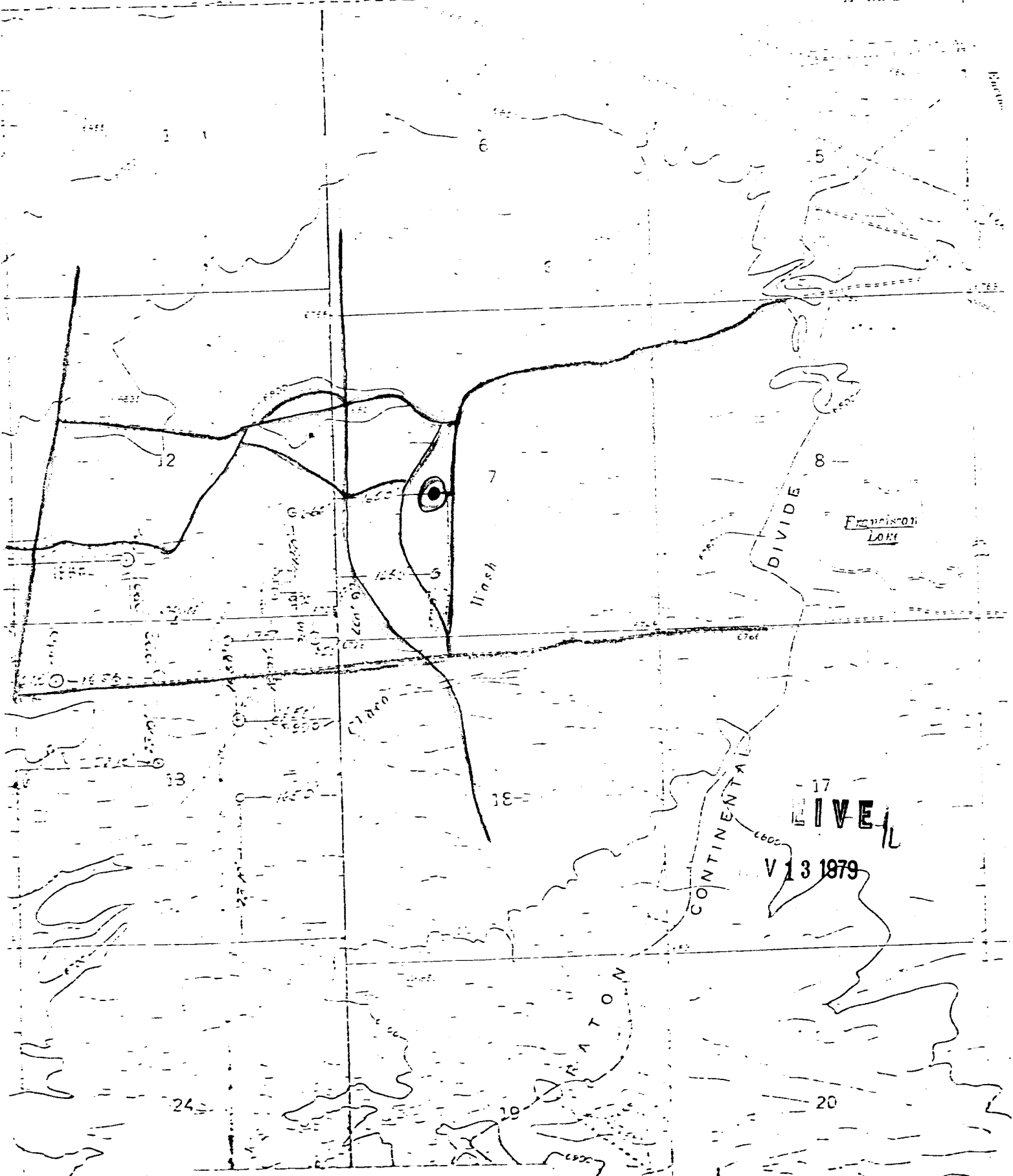

17
LIVE
V 13 1979

Basin Fuels, Inc. Elev. 6778
SW 1/4 Sec. 7, T20N, R5W, N.M.P.M.
McKinley County, N.M.