

30-031-20618

NO. OF COPIES RECEIVED	
DISTRIBUTION	
SANTA FE	
FILE	
U.S.G.S.	
LAND OFFICE	
OPERATOR	

NEW MEXICO OIL CONSERVATION COMMISSION

Form C-101
Revised 1-1-65

5A. Indicate Type of Lease
STATE FEE

5. State Oil & Gas Lease No.
LG 2779

APPLICATION FOR PERMIT TO DRILL, DEEPEN, OR PLUG BACK

1a. Type of Work b. Type of Well DRILL <input checked="" type="checkbox"/> DEEPEN <input type="checkbox"/> PLUG BACK <input type="checkbox"/> OIL WELL <input checked="" type="checkbox"/> GAS WELL <input type="checkbox"/> OTHER <input type="checkbox"/> SINGLE ZONE <input checked="" type="checkbox"/> MULTIPLE ZONE <input type="checkbox"/>		7. Unit Agreement Name
2. Name of Operator Red Mountain Associates Limited Partnership, c/o K & A/Helton		8. Farm or Lease Name SECTION 28 State
3. Address of Operator 2200 Security Life Bldg., 1616 Glenarm, Denver, CO 80202		9. Well No. 28
4. Location of Well UNIT LETTER A LOCATED 707 FEET FROM THE North LINE AND 1,273 FEET FROM THE East LINE OF SEC. 28 TWP. 20N RGE. 9W NMPM		10. Field and Pool, or Wildcat CHACO WASH ml 40
		12. County McKinley
		19. Proposed Depth 450
		19A. Formation Menefee
		20. Rotary or C.T. Rotary
21. Elevations (Show whether DF, RT, etc.) 6,419' GL	21A. Kind & Status Plug. Bond	21B. Drilling Contractor Bruce Black
		22. Approx. Date Work will start August 10, 1980

PROPOSED CASING AND CEMENT PROGRAM

SIZE OF HOLE	SIZE OF CASING	WEIGHT PER FOOT	SETTING DEPTH	SACKS OF CEMENT	EST. TOP
6 1/2	4 1/2	10.5	450	25	250 circ.

Operator proposes to drill this well to test the Fino and Chaco Wash sands for oil production and development of secondary recovery potential. Water base mud will be used to remove cuttings. Resistivity logs will be used to evaluate the pay zone along with porosity logs and cores of selected intervals. Close spacing is required to obtain economical drainage of the very low pressure formations.

APPROVAL VALID
FOR 90 DAYS UNLESS
DRILLING COMMENCED,
EXPIRES 11-9-80

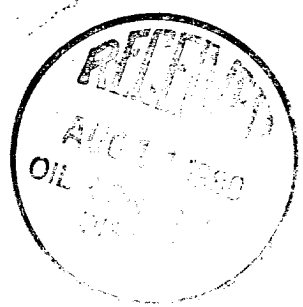

IN ABOVE SPACE DESCRIBE PROPOSED PROGRAM: IF PROPOSAL IS TO DEEPEN OR PLUG BACK, GIVE DATA ON PRESENT PRODUCTIVE ZONE AND PROPOSED NEW PRODUCTIVE ZONE. GIVE BLOWOUT PREVENTER PROGRAM, IF ANY.

I hereby certify that the information above is true and complete to the best of my knowledge and belief.
Signed W.E. Landry *W.E. Landry* Title K & A/Helton Eng. & Geo. Services
Area Manager Date August 8, 1980

(This space for State Use)
APPROVED BY Frank S. Chang *Frank S. Chang* TITLE SUPERVISOR DISTRICT # 3 DATE 8-14-80
AUG 14 1980

Hold C-104 for NSL circulate cement

OIL CONSERVATION DIVISION

STATE OF NEW MEXICO
ENERGY AND MINERALS DEPARTMENT

P. O. BOX 2088

SANTA FE, NEW MEXICO 87501

Form C-107
Revised 10-1-78

All distances must be from the outer boundaries of the Section.

Operator RED MOUNTAIN ASSOCIATES		Lease SECTION 28 <i>Slide</i>		Well No. <i>2 B</i>
Unit Letter A	Section 28	Township 20N	Range 9W	County McKinley
Actual Footage Location of Well: 707 feet from the North line and 1273 feet from the East line				
Ground Level Elev: 6419	Producing Formation Fino and Chaco Wash <input checked="" type="checkbox"/>	Pool Chaco Wash	Dedicated Acreage: 40 Acres	

1. Outline the acreage dedicated to the subject well by colored pencil or hachure marks on the plat below.
2. If more than one lease is dedicated to the well, outline each and identify the ownership thereof (both as to working interest and royalty).
3. If more than one lease of different ownership is dedicated to the well, have the interests of all owners been consolidated by communitization, unitization, force-pooling, etc?

Yes No If answer is "yes," type of consolidation _____

If answer is "no," list the owners and tract descriptions which have actually been consolidated. (Use reverse side of this form if necessary.) _____

No allowable will be assigned to the well until all interests have been consolidated (by communitization, unitization, forced-pooling, or otherwise) or until a non-standard unit, eliminating such interests, has been approved by the Commission.

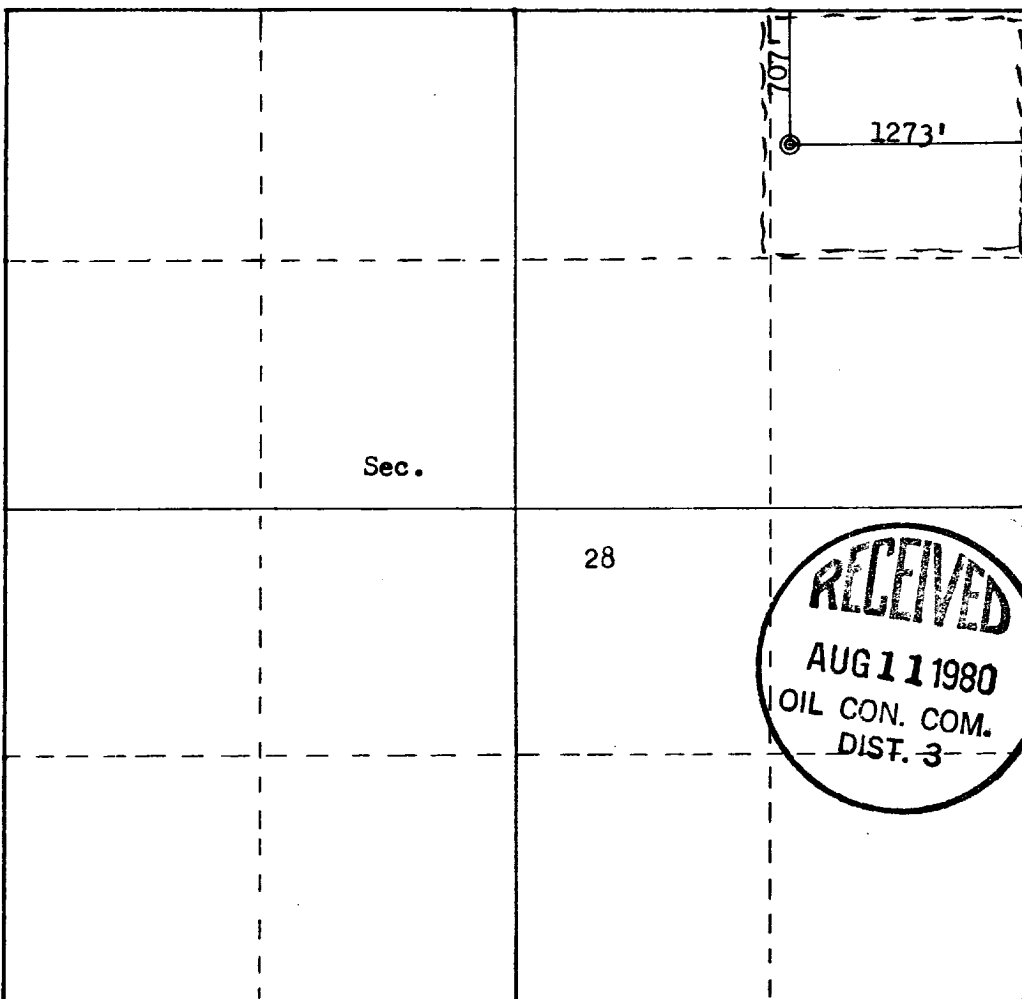

Scale: 1"=1000'

CERTIFICATION

I hereby certify that the information contained herein is true and complete to the best of my knowledge and belief.

W.E. Landry

Name	<i>W.E. Landry</i>
Position	Area Manager
Company	K & A/Helton Eng. & Geo. Serv.
Date	August 8, 1980

I hereby certify that the well location shown on this plat was plotted from field notes of actual surveys made by me or under my supervision, and that the same is true and correct to the best of my knowledge and belief.

Date Surveyed	July 24, 1980
Registered Professional Land Surveyor and	<i>Fred B. Kerr, Jr.</i>
Certificate No.	3950

