

STATE OF NEW MEXICO
ENERGY AND MINERALS DEPARTMENT

OIL CONSERVATION DIVISION
P. O. BOX 2088
SANTA FE, NEW MEXICO 87501

Form C-101
Revised 10-1-70

NO. OF COPIES REQUIRED	
DISTRIBUTION	
SANTA FE	
FILE	
U.S.G.S.	
LAND OFFICE	
OPERATOR	

5A. Indicate Type of Lease
STATE ☐ FEE ☒

5. State Oil & Gas Lease No.
0-9725

APPLICATION FOR PERMIT TO DRILL, DEEPEN, OR PLUG BACK

1a. Type of Work DRILL <input checked="" type="checkbox"/> DEEPEN <input type="checkbox"/> PLUG BACK <input type="checkbox"/>		7. Unit Agreement Name
b. Type of Well OIL WELL <input checked="" type="checkbox"/> GAS WELL <input type="checkbox"/> OTHER <input type="checkbox"/> SINGLE ZONE <input type="checkbox"/> MULTIPLE ZONE <input type="checkbox"/>		8. Name or Lease Name SFPRR
2. Name of Operator Zent Energy Corporation		9. Well No. 30
3. Address of Operator P.O. Box 1038 Kilgore, Texas 75662		10. Field and Pool, or Wildcat Miguel Creek Gallup <i>ET</i>
4. Location of Well UNIT LETTER <u>P</u> LOCATED <u>525</u> FEET FROM THE <u>South</u> LINE AND <u>990</u> FEET FROM THE <u>East</u> LINE OF SEC. <u>20</u> TWP. <u>16N</u> RGE. <u>6W</u> NMPM		11. County <u>McKinley</u>
19. Proposed Depth 800'		19A. Formation Hospah
20. Rotary or C.T. Rotary		
21. Elevations (Show whether DF, KI, etc.) 6412 GL	21A. Kind & Status Plug. Bond Blanket-on file	21B. Drilling Contractor A & M Drilling
22. Approx. Date Work will start 9-8-80		

PROPOSED CASING AND CEMENT PROGRAM

SIZE OF HOLE	SIZE OF CASING	WEIGHT PER FOOT	SETTING DEPTH	SACKS OF CEMENT	EST. TOP
7 7/8"	4 1/2"	11 lbs.	800'	160 class H	Surface

The location was moved due to the fact that it fell in the Arroyo.

APPROVAL VALID
FOR 90 DAYS UNLESS
DRILLING COMMENCED,
EXPIRES 12-7-80



IN ABOVE SPACE DESCRIBE PROPOSED PROGRAM; IF PROPOSAL IS TO DEEPEN OR PLUG BACK, GIVE DATA ON PRESENT PRODUCTIVE ZONE AND PROPOSED NEW PRODUCTIVE ZONE. GIVE BLOWOUT PREVENTER PROGRAM, IF ANY.

I hereby certify that the information above is true and complete to the best of my knowledge and belief.

Signed Darryl L. Blank Title Representative Date 9-2-80
(This space for State Use)
APPROVED BY Emil J. Chang TITLE SUPERVISOR DISTRICT #3 DATE SEP 8 1980
CONDITIONS OF APPROVAL, IF ANY:

**NEW MEXICO OIL CONSERVATION COMMISSION
WELL LOCATION AND ACREAGE DEDICATION PLAT**

Form C-162
Supersedes C-128
Effective 1-1-65

All distances must be from the outer boundaries of the Section.

Operator <u>Zenith Energy Corp.</u>			Lease <u>SFPRR</u>		Well No. <u>30</u>
Unit Letter	Section <u>20</u>	Township <u>16 North</u>	Range <u>6 West</u>	County <u>McKinley</u>	
Actual Footage Location of Well: <u>525</u> feet from the <u>South</u> line and <u>990</u> feet from the <u>East</u> line					
Ground Level Elev. <u>6412</u>	Producing Formation <u>Galeup</u>	Pool <u>Miguel Creek E-Jt</u>	Dedicated Acreage: <u>35.27</u> Acres		

1. Outline the acreage dedicated to the subject well by colored pencil or hachure marks on the plat below.
2. If more than one lease is dedicated to the well, outline each and identify the ownership thereof (both as to working interest and royalty).
3. If more than one lease of different ownership is dedicated to the well, have the interests of all owners been consolidated by communitization, unitization, force-pooling, etc?

☐ Yes ☐ No If answer is "yes," type of consolidation _____

If answer is "no," list the owners and tract descriptions which have actually been consolidated. (Use reverse side of this form if necessary.) _____

No allowable will be assigned to the well until all interests have been consolidated (by communitization, unitization, forced-pooling, or otherwise) or until a non-standard unit, eliminating such interests, has been approved by the Commission.

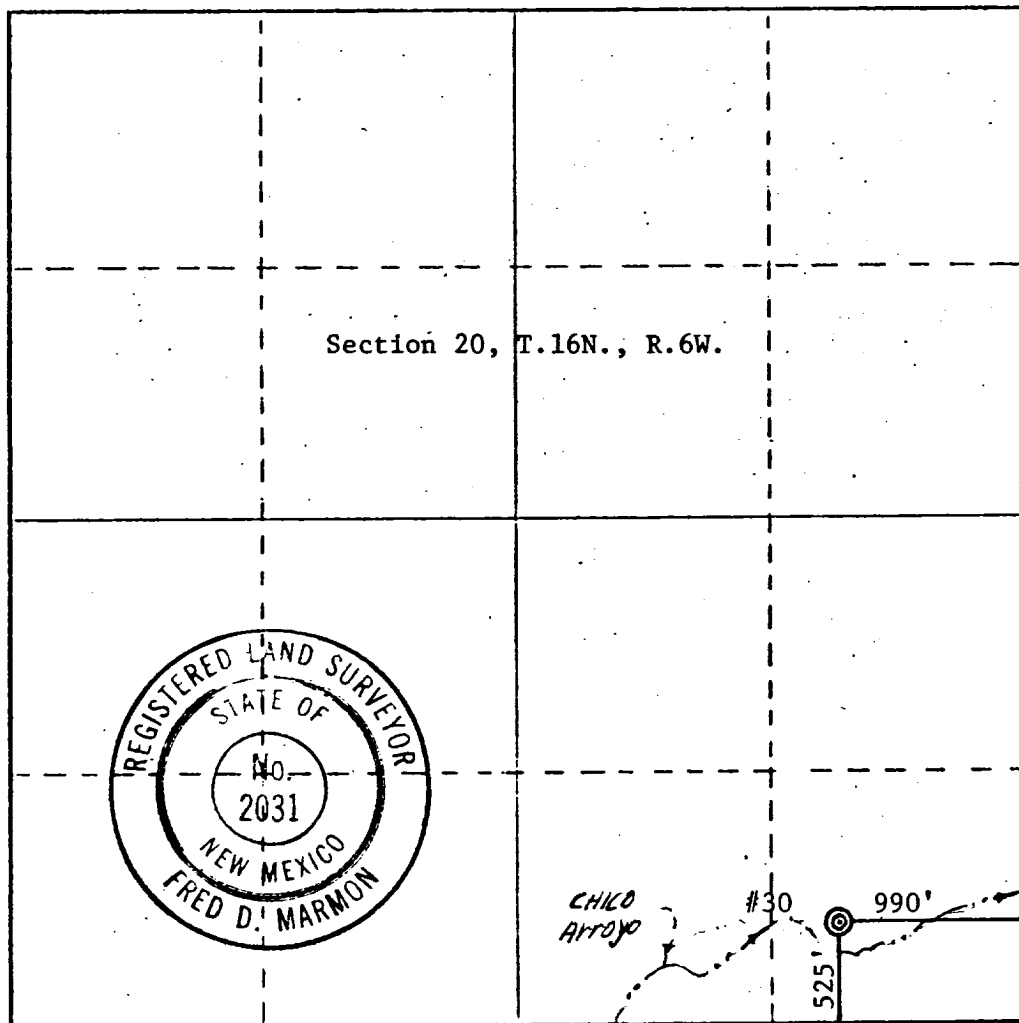

CERTIFICATION

I hereby certify that the information contained herein is true and complete to the best of my knowledge and belief.

Darryl L. Blanton
Name

Position

Representative

Company

Zenith Energy Corporation

Date

9-2-80

I hereby certify that the well location shown on this plat was plotted from field notes of actual surveys made by me or under my supervision, and that the same is true and correct to the best of my knowledge and belief.

Date Surveyed

August 27, 1980

Registered Professional Engineer and/or Land Surveyor

Fred D. Marmion

Certificate No.

2031