

NO. OF COPIES RECEIVED	
DISTRIBUTION	
SANTA FE	
FILE	
U.S.G.S.	
LAND OFFICE	
OPERATOR	

# NEW MEXICO OIL CONSERVATION COMMISSION

30031-20637

Form 1-1-65  
Revised 1-1-65

5A. Indicate Type of Lease	STATE <input type="checkbox"/>	FILE <input checked="" type="checkbox"/>
5. State Oil & Gas Lease No.		

## APPLICATION FOR PERMIT TO DRILL, DEEPEN, OR PLUG BACK

a. Type of Work		7. Unit Agreement Name	
DRILL <input checked="" type="checkbox"/> DEEPEN <input type="checkbox"/> PLUG BACK <input type="checkbox"/>			
b. Type of Well		8. Farm or Lease Name	
OIL WELL <input checked="" type="checkbox"/> GAS WELL <input type="checkbox"/> OTHER <input type="checkbox"/> SINGLE ZONE <input type="checkbox"/> MULTIPLE ZONE <input type="checkbox"/>		Moleres Ranch 34	
c. Name of Operator		9. Well No.	
SANTA FE ENERGY COMPANY		1	
d. Address of Operator		10. Field and Pool, or Wildcat	
One Security Park, 7200 I-40 West, Amarillo, Texas 79106		Wildcat <i>Entrada</i>	
e. Location of Well		12. County	
UNIT LETTER <u>G</u> LOCATED <u>1980</u> FEET FROM THE <u>North</u> LINE <u>1980</u> FEET FROM THE <u>East</u> LINE OF SEC. <u>34</u> TWP. <u>18N</u> RGE. <u>8W</u> NMPM		McKinley	

1. Elevations (Show whether DF, RT, etc.)		19. Proposed Depth	19A. Formation	20. Rotary or C.T.
6800' GL		4250'	Entrada	Rotary
21A. Kind & Status Plug. Bond	21B. Drilling Contractor		22. Date Work will start	
Statewide	Kenai		10/15/80	

3. PROPOSED CASING AND CEMENT PROGRAM					
SIZE OF HOLE	SIZE OF CASING	WEIGHT PER FOOT	SETTING DEPTH	SACKS OF CEMENT	EST. TOP
12-1/4"	8-5/8"	24.0	250	250	Surface
7-7/8"	5-1/2"	15.50	T.D.	300	1500

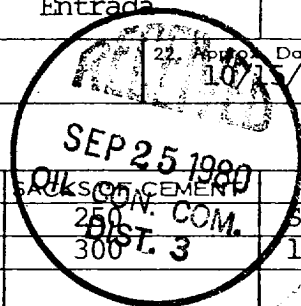

It is proposed to drill this well with rotary tools, using water base mud as circulating medium, and test the Entrada Formation. Possible productive interval in the Entrada will be completed. Production casing will be cemented in such a manner to protect the Dakota and Gallup Formations.

### ESTIMATED FORMATION TOPS:

Point Lookout	600'	Morrison	2800'
Gallup	1700'	Entrada	4010'
Dakota	2500'		

APPROVAL VALID  
FOR 90 DAYS UNLESS  
DRILLING COMMENCED,

The SW/4, NE/4, Section 34 is dedicated to this well.

The gas for this well is not committed.

EXPIRES 12-24-80

ABOVE SPACE DESCRIBE PROPOSED PROGRAM: IF PROPOSAL IS TO DEEPEN OR PLUG BACK, GIVE DATA ON PRESENT PRODUCTIVE ZONE AND PROPOSED NEW PRODUCTIVE ZONE. GIVE BLOWOUT PREVENTER PROGRAM, IF ANY.

I hereby certify that the information above is true and complete to the best of my knowledge and belief.

FOR: SANTA FE ENERGY COMPANY  
ORIGINAL SIGNED BY President, Walsh Engr. & Prod. Co. Date 9/23/80  
and Ewell N. Walsh, P.E. Title  Date

(This space for State Use)

PROVED BY [Signature] TITLE SUPERVISOR DISTRICT 3 DATE SEP 25 1980

CONDITIONS OF APPROVAL, IF ANY:

All distances must be from the outer boundaries of the Section.

Operator <b>SANTA FE ENERGY COMPANY</b>			Lease <b>MOLERES RANCH 34</b>		Well No. <b>1</b>
Unit Letter <b>G</b>	Section <b>34</b>	Township <b>18N</b>	Range <b>8W</b>	County <b>McKinley</b>	
Actual Footage Location of Well:					
1980 feet from the North line and		1980 feet from the East line			
Ground Level Elev. <b>6800</b>	Producing Formation <b>Entrada</b>	Pool <b>Wildcat</b>	Dedicated Acreage: <b>40</b> Acres		

1. Outline the acreage dedicated to the subject well by colored pencil or hatchure marks on the plat below.
2. If more than one lease is dedicated to the well, outline each and identify the ownership thereof (both as to working interest and royalty).
3. If more than one lease of different ownership is dedicated to the well, have the interests of all owners been consolidated by communitization, unitization, force-pooling, etc?

☐ Yes ☐ No If answer is "yes," type of consolidation \_\_\_\_\_

If answer is "no," list the owners and tract descriptions which have actually been consolidated. (Use reverse side of this form if necessary.) \_\_\_\_\_

No allowable will be assigned to the well until all interests have been consolidated (by communitization, unitization, forced-pooling, or otherwise) or until a non-standard unit, eliminating such interests, has been approved by the Commission.

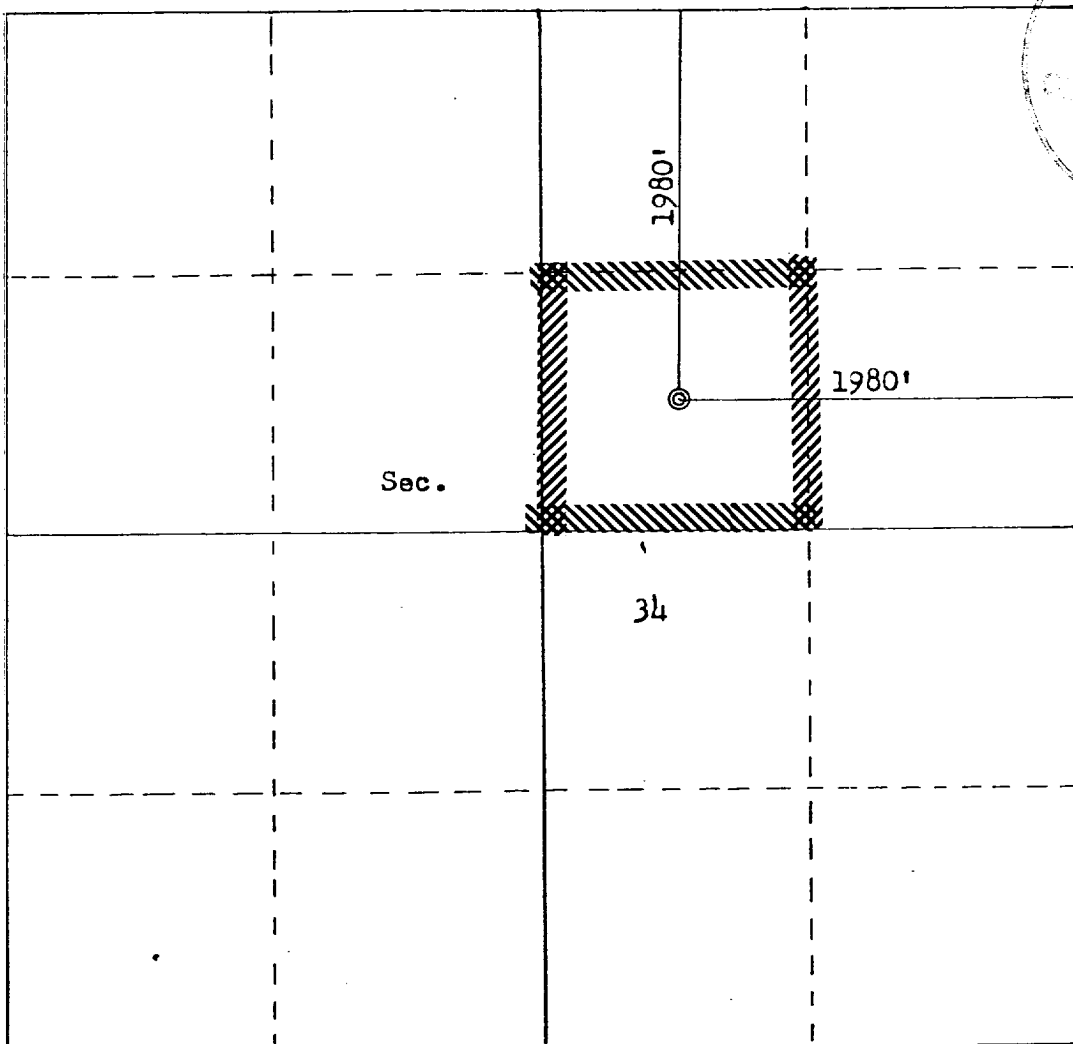

Scale: 1"=1000'

<b>CERTIFICATION</b>	
I hereby certify that the information contained herein is true and complete to the best of my knowledge and belief.	
FOR: <b>SANTA FE ENERGY COMPANY</b> <b>ORIGINAL SIGNED BY</b> <b>EWELL N. WALSH</b>	
Name	<b>Ewell N. Walsh, P.E.</b>
Position	<b>President</b>
Company	<b>Walsh Engr. &amp; Prod. Corp.</b>
Date	<b>9/23/80</b>
I hereby certify that the well location shown on this plat was plotted from field notes of actual surveys made by me or under my supervision, and that the same is true and correct to the best of my knowledge and belief.	
Date Surveyed	<b>September 23, 1980</b>
Registered Professional Engineer and Land Surveyor	
<b>Fred B. Kerr, Jr.</b>	
Certificate No.	<b>3950</b>

SANTA FE ENERGY COMPANY  
MOLERES RANCH 34, NO. 1  
1980'FNL, 1980'FEL, SEC. 34-T18N-R8W  
McKinley County, New Mexico

1. Surface Casing.  
See Application for Permit to Drill.
2. Spools and Flanges
  - A. Surface Casing - 8", Series 600, 2000 psi W.P.
  - B. Production, 8", Series 600, 2000 psi W.P.
  - C. Tubing Head - Series 600, 2000 psi W.P.
3. Intermediate Casing.  
None
4. Blowout Preventers  
Production Hole - 10", 3000 psi  
Fill, Kill and Choke Manifold - 5000 psi. W.P.
5. Additional Equipment (If Necessary)
  - A. Kelly Cock
  - B. Bit Float
  - C. Degasser
  - D. Pit Level Indicator
  - F. Sub with valve for drill pipe.
6. Anticipated Bottom Hole Pressure  
1700 psi. Current mud program is for 9.2 lb./gal mud  
with hydrostatic head of 2020 psi at 4250 feet. Mud  
weight will be increased if necessary for higher pressures.
7. Drilling Fluid  
Gel-Water