

NO. OF COPIES RECEIVED	
DISTRIBUTION	
SANTA FE	
FILE	
U.S.G.S.	
LAND OFFICE	
OPERATOR	

# NEW MEXICO OIL CONSERVATION COMMISSION

30-031-20643

Form C-101  
Revised 1-1-65

5A. Indicate Type of Lease STATE <input checked="" type="checkbox"/> FEE <input type="checkbox"/>
5. State Oil & Gas Lease No. LG 2779
7. Unit Agreement Name
8. Farm or Lease Name State
9. Well No. 20
10. Field and Pool, or Wildcat Chaco Wash <i>M</i>
12. County McKinley
19. Proposed Depth 570
19A. Formation Menefee
20. Rotary or C.T. Rotary
21. Elevations (Show whether DF, RT, etc.) 6418 GL
21A. Kind & Status Plug. Bond
21B. Drilling Contractor C.P.G.S., Inc.
22. Approx. Date Work will start Nov 17 1980

APPLICATION FOR PERMIT TO DRILL, DEEPEN, OR PLUG BACK	
1a. Type of Work b. Type of Well OIL WELL <input checked="" type="checkbox"/> GAS WELL <input type="checkbox"/> OTHER <input type="checkbox"/> DRILL <input checked="" type="checkbox"/> DEEPEN <input type="checkbox"/> PLUG BACK <input type="checkbox"/> SINGLE ZONE <input type="checkbox"/> MULTIPLE ZONE <input type="checkbox"/>	2. Name of Operator Red Mountain Associates Limited Partnership
3. Address of Operator 2200 Security Life Building, Denver, Co. 80202	
4. Location of Well UNIT LETTER <u>A</u> LOCATED <u>990</u> FEET FROM THE <u>North</u> LINE AND <u>1315</u> FEET FROM THE <u>East</u> LINE OF SEC. <u>28</u> TWP. <u>20N</u> RGE. <u>9W</u> NMPM	
5. Proposed Depth 570	
6. Formation Menefee	
7. Rotary or C.T. Rotary	
8. Approx. Date Work will start Nov 17 1980	

PROPOSED CASING AND CEMENT PROGRAM					
SIZE OF HOLE	SIZE OF CASING	WEIGHT PER FOOT	SETTING DEPTH	SACKS OF CEMENT	ST. TOP Surface
6 3/4	4 1/2	10.5	560	85	

Operator proposes to drill this well to test the Fino and Chaco Wash Sands for oil production and development of secondary recovery potential. Water base mud will be used to remove cuttings. Resistivity logs will be used to evaluate the pay zone along with cores of selected intervals. Close spacing is required to obtain economical drainage of this very low pressure.

APPROVAL VALID  
FOR 90 DAYS UNLESS  
DRILLING COMMENCED,

EXPIRES 2-14-81

ABOVE SPACE DESCRIBE PROPOSED PROGRAM: IF PROPOSAL IS TO DEEPEN OR PLUG BACK, GIVE DATA ON PRESENT PRODUCTIVE ZONE AND PROPOSED NEW PRODUCTION ZONE. GIVE BLOWOUT PREVENTER PROGRAM, IF ANY.

I hereby certify that the information above is true and complete to the best of my knowledge and belief.

Signed M. Zenati Title Project Engineer - Keplinger & Assoc. Date Nov. 4, 1980

(This space for State Use)  
Mohamed Zenati

Original Signed by CHARLES GHOLSON

DEPUTY OIL & GAS INSPECTOR, DIST. #3

NOV 17 1980

APPROVED BY \_\_\_\_\_ TITLE \_\_\_\_\_ DATE \_\_\_\_\_

CONDITIONS OF APPROVAL, IF ANY:

Hold C-101 for 11/5/80

NEW MEXICO OIL CONSERVATION COMMISSION  
WELL LOCATION AND ACREAGE DEDICATION PLAT

Form C-102  
Supersedes C-128  
Effective 1-1-65

All distances must be from the outer boundaries of the Section.

Operator <b>Red Mountain Associates Ltd. Partners</b>			Lease <b>State</b>		Well No. <b>20</b>
Unit Letter <b>A</b>	Section <b>28</b>	Township <b>20 North</b>	Range <b>9 West</b>	County <b>McKinley</b>	
Actual Footage Location of Well:					
<b>990</b>		feet from the <b>North</b>	line and <b>1315</b>	feet from the <b>East</b>	line
Ground Level Elev. <b>6418</b>	Producing Formation <b>Menefee - mJ</b>		Pool <b>Chaco Wash</b>	Dedicated Acreage: <b>40</b> Acres	

1. Outline the acreage dedicated to the subject well by colored pencil or hatchure marks on the plat below.
2. If more than one lease is dedicated to the well, outline each and identify the ownership thereof (both as to working interest and royalty).
3. If more than one lease of different ownership is dedicated to the well, have the interests of all owners been consolidated by communitization, unitization, force-pooling, etc?

☐ Yes    ☐ No    If answer is "yes," type of consolidation \_\_\_\_\_

If answer is "no," list the owners and tract descriptions which have actually been consolidated. (Use reverse side of this form if necessary.) \_\_\_\_\_

No allowable will be assigned to the well until all interests have been consolidated (by communitization, unitization, forced-pooling, or otherwise) or until a non-standard unit, eliminating such interests, has been approved by the Commission.

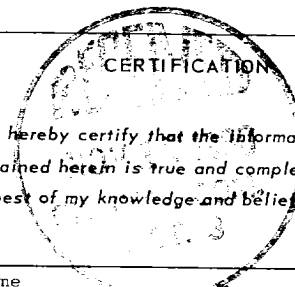
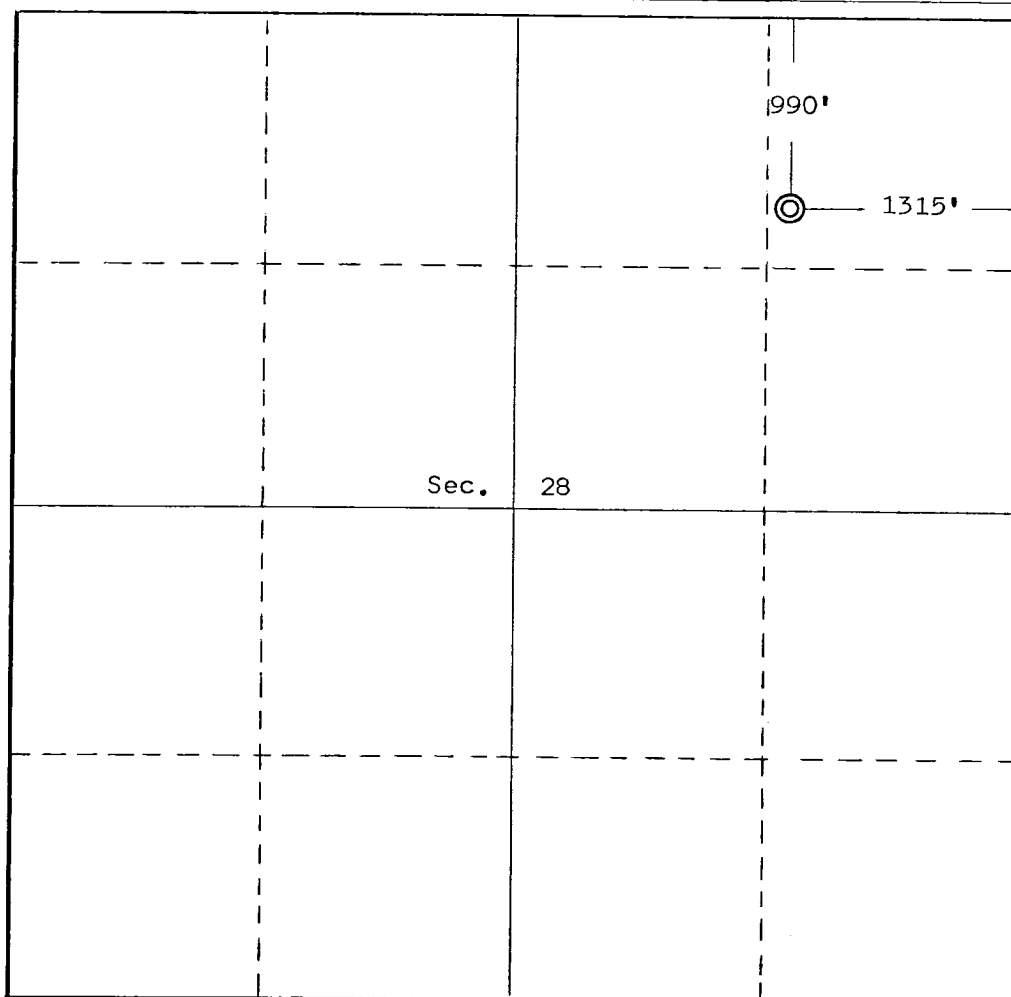

Name  
**M. Zenati**

Position  
**Project Engineer**

Company  
**Keplinger & Associates**

Date  
**November 4, 1980**



Date Surveyed  
**October 19, 1980**

Registered Professional Engineer  
and/or Land Surveyor  
**Edgar L. Risenhoover**

Certificate No. **5979**

**Edgar L. Risenhoover, L.S.**

