

NO. OF COPIES RECEIVED	
DISTRIBUTION	
SANTA FE	
FILE	
U.S.G.S.	
LAND OFFICE	
OPERATOR	

# NEW MEXICO OIL CONSERVATION COMMISSION

30-031-20645

Form C-101  
Revised 1-1-65

5A. Indicate Type of Lease STATE <input checked="" type="checkbox"/> FEE <input type="checkbox"/>
5. State Oil & Gas Lease No. LG 2779
7. Unit Agreement Name
8. Farm or Lease Name State
9. Well No. 22
10. Field and Pool, or Wildcat Chaco Wash <i>m</i>
12. County McKinley
19. Proposed Depth 570
19A. Formation Menefee
20. Rotary or C.T. Rotary
21. Elevations (Show whether DF, RT, etc.) 6453 GL
21A. Kind & Status Plug. Bond
21B. Drilling Contractor C.P.G.S., Inc.
22. Approx. Date Work will start Nov. 20, 1980

## APPLICATION FOR PERMIT TO DRILL, DEEPEN, OR PLUG BACK

1a. Type of Work DRILL <input checked="" type="checkbox"/> DEEPEN <input type="checkbox"/> PLUG BACK <input type="checkbox"/>	b. Type of Well OIL WELL <input checked="" type="checkbox"/> GAS WELL <input type="checkbox"/> OTHER <input type="checkbox"/>	SINGLE ZONE <input type="checkbox"/> MULTIPLE ZONE <input type="checkbox"/>
2. Name of Operator Red Mountain Associates Limited Partnership		
3. Address of Operator 2200 Security Life Building, Denver, Co. 80202		
4. Location of Well UNIT LETTER B LOCATED 990 FEET FROM THE North LINE AND 2635 FEET FROM THE East LINE OF SEC. 28 TWP. 20N RGE. 9W NMPM		
21. Elevations (Show whether DF, RT, etc.) 6453 GL		
21A. Kind & Status Plug. Bond		
21B. Drilling Contractor C.P.G.S., Inc.		
22. Approx. Date Work will start Nov. 20, 1980		

## PROPOSED CASING AND CEMENT PROGRAM

SIZE OF HOLE	SIZE OF CASING	WEIGHT PER FOOT	SETTING DEPTH	SACKS OF CEMENT	EST. TOP
6 3/4	4 1/2	10.5	560	85	Surface

Operator proposes to drill this well to test the Fino and Chaco Wash Sands for oil production and development of secondary recovery potential. Water base mud will be used to remove cuttings. Resistivity logs will be used to evaluate the pay zone along with cores of selected intervals. Close spacing is required to obtain economical drainage of this very low pressure.

APPROVAL VALID  
FOR 90 DAYS UNLESS  
DRILLING COMMENCED,

EXPIRES 2-14-81

ABOVE SPACE DESCRIBE PROPOSED PROGRAM: IF PROPOSAL IS TO DEEPEN OR PLUG BACK, GIVE DATA ON PRESENT PRODUCTIVE ZONE AND PROPOSED NEW PRODUCTIVE ZONE. GIVE BLOWOUT PREVENTER PROGRAM, IF ANY.

hereby certify that the information above is true and complete to the best of my knowledge and belief.

Signed M. Zenati Title Project Engineer - Keplinger & Assoc. Date Nov. 4, 1980

(This space for State Use)  
Original Signed by CHARLES GHOLSON

Mohamed Zenati

APPROVED BY TIT DEPUTY OIL & GAS INSPECTOR, DIST. #3

CONDITIONS OF APPROVAL, IF ANY:

DATE NOV 17 1980

*Hold new logs*

NEW MEXICO OIL CONSERVATION COMMISSION  
WELL LOCATION AND ACRAGE DEDICATION PLAT

Form C-102  
Supersedes C-128  
Effective 1-1-65

All distances must be from the outer boundaries of the Section.

Operator <b>Red Mountain Associates Ltd. Partners</b>		Lease <b>State</b>		Well No. <b>22</b>
Unit Letter <b>B</b>	Section <b>28</b>	Township <b>20 North</b>	Range <b>9 West</b>	County <b>McKinley</b>

Actual Footage Location of Well:

<b>990</b>	feet from the <b>North</b>	line and <b>2635</b>	feet from the <b>East</b>	line
Ground Level Elev. <b>6453.</b>	Producing Formation <b>Menefee mv</b>	Pool <b>Chaco Wash</b>	Dedicated Acreage: <b>40</b> Acres	

1. Outline the acreage dedicated to the subject well by colored pencil or hachure marks on the plat below.
2. If more than one lease is dedicated to the well, outline each and identify the ownership thereof (both as to working interest and royalty).
3. If more than one lease of different ownership is dedicated to the well, have the interests of all owners been consolidated by communitization, unitization, force-pooling, etc?

☐ Yes ☐ No If answer is "yes," type of consolidation \_\_\_\_\_

If answer is "no," list the owners and tract descriptions which have actually been consolidated. (Use reverse side of this form if necessary.) \_\_\_\_\_

No allowable will be assigned to the well until all interests have been consolidated (by communitization, unitization, forced-pooling, or otherwise) or until a non-standard unit, eliminating such interests, has been approved by the Commission.

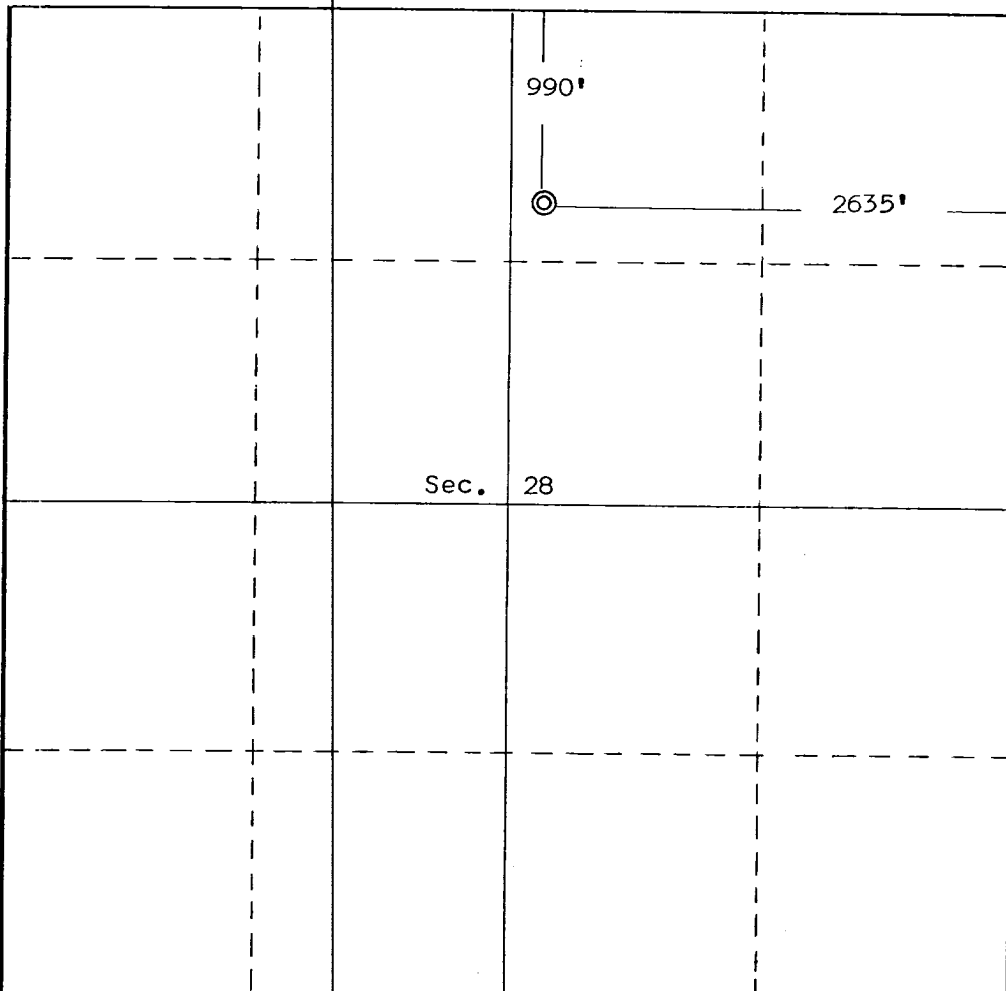

I hereby certify that the information contained herein is true and complete to the best of my knowledge and belief.

Name  
**M. Zenati**  
Position  
**Project Engineer**  
Company  
**Keplinger & Associates**  
Date  
**November 4, 1980**

I hereby certify that the well location shown on this plat was obtained from field notes of actual surveys made by me or under my supervision, and that the same is true and correct to the best of my knowledge and belief.

Date Surveyed  
**October 19, 1980**

Registered Professional Engineer  
and/or Land Surveyor

**Edgar L. Risenhoover**  
Certificate No. **5979**  
**Edgar L. Risenhoover, L.S.**

