

UNITED STATES
DEPARTMENT OF THE INTERIOR
GEOLOGICAL SURVEY

30-031-20690

APPLICATION FOR PERMIT TO DRILL, DEEPEN, OR PLUG BACK

1a. TYPE OF WORK

DRILL ☒

DEEPEN ☐

PLUG BACK ☐

b. TYPE OF WELL

OIL
WELL ☒

GAS
WELL ☐

OTHER Injection

SINGLE
ZONE ☒

MULTIPLE
ZONE ☐

2. NAME OF OPERATOR

Tenneco Oil Company

3. ADDRESS OF OPERATOR

P.O. Box 3249, Englewood, Colorado 80155

4. LOCATION OF WELL (Report location clearly and in accordance with any State requirements.)

At surface

2010 FNL, 4380 FFL
1290 FWL

At proposed prod. zone

same as above

14. DISTANCE IN MILES AND DIRECTION FROM NEAREST TOWN OR POST OFFICE*

Approximately 1 mile south of Hospah, N.M.

15. DISTANCE FROM PROPOSED*

LOCATION TO NEAREST
PROPERTY OR LEASE LINE, FT.
(Also to nearest drlg. unit line, if any)

630'

16. NO. OF ACRES IN LEASE

344.08 ? 304.08

17. NO. OF ACRES ASSIGNED
TO THIS WELL

40 injection well

18. DISTANCE FROM PROPOSED LOCATION*
TO NEAREST WELL, DRILLING, COMPLETED,
OR APPLIED FOR, ON THIS LEASE, FT.

19. PROPOSED DEPTH

±1770

20. ROTARY OR CABLE TOOLS

Rotary

21. ELEVATIONS (Show whether DF, RT, GR, etc.)

7055' GR

22. APPROX. DATE WORK WILL START*

May 1981

23.

PROPOSED CASING AND CEMENTING PROGRAM

SIZE OF HOLE	SIZE OF CASING	WEIGHT PER FOOT	SETTING DEPTH	QUANTITY OF CEMENT
12 1/4"	8 5/8" new	24#	±150'	Circulate to surface
7 7/8"	5 1/2" new	15.5#	±1770'	Circulate to surface

See attached drilling procedure.

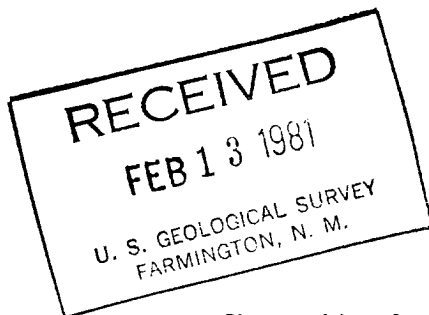

IN ABOVE SPACE DESCRIBE PROPOSED PROGRAM: If proposal is to deepen or plug back, give data on present productive zone and proposed new productive zone. If proposal is to drill or deepen directionally, give pertinent data on subsurface locations and measured and true vertical depths. Give blowout preventer program, if any.

24.

SIGNED

R. A. Mishler
R.A. Mishler

TITLE

Sr. Production Analyst

DATE

February 6, 1981

(This space for Federal or State office use)

PERMIT NO.

APPROVAL DATE

APPROVED BY

TITLE

CONDITIONS OF APPROVAL, IF ANY:

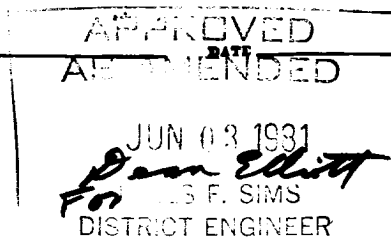

*See Instructions On Reverse Side

Form C-102
Supersedes C-128
Effective 1-1-65

Operator TENNECO OIL COMPANY			Lease HOSPAP		Well No. 68
Unit Letter E	Section 12	Township 17N	Range 9W	County McKinley	
Actual Footage Location of Well: 2010 feet from the North line and 4380 ¹²⁹⁰ feet from the West = East line					
Ground Level Elev. 7055	Producing Formation N/A		Pool LOWER HOSPAP		Dedicated Acreage: INJECTION WELL Acres

- No allowable will be assigned to the well until all interests have been consolidated (by communitization, unitization, forced-pooling, or otherwise) or until a non-standard unit, eliminating such interests, has been approved by the Commission.

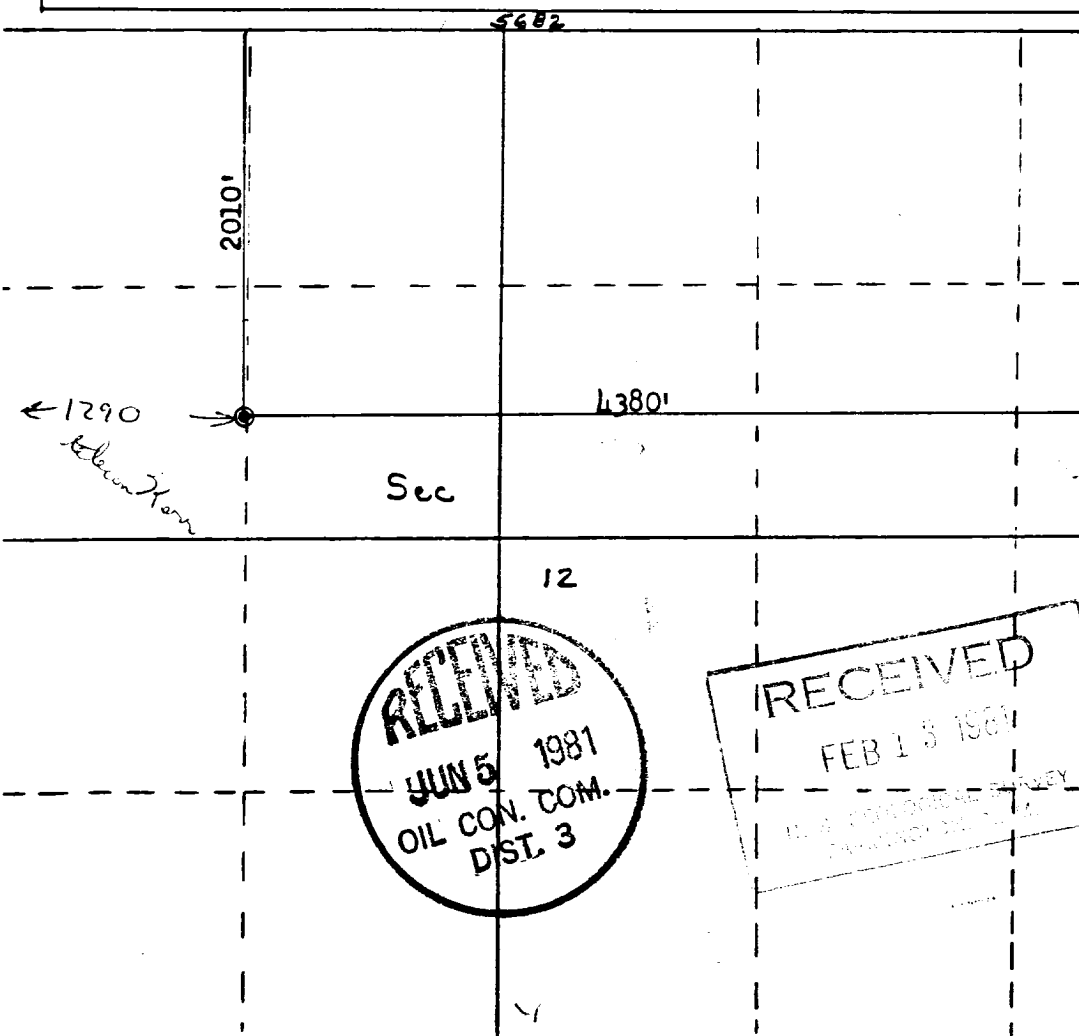

Scale: $1'' = 1000'$

Date Surveyed
January 30, 1981
Registered Professional Engineer
and Land Surveyor
Fred B. Kerr Jr.
Fred B. Kerr Jr.
Certificate No.
3950