

UNITED STATES
DEPARTMENT OF THE INTERIOR
GEOLOGICAL SURVEY

30-031-20692

APPLICATION FOR PERMIT TO DRILL, DEEPEN, OR PLUG BACK

1a. TYPE OF WORK DRILL <input checked="" type="checkbox"/> DEEPEN <input type="checkbox"/> PLUG BACK <input type="checkbox"/>		5. LEASE DESIGNATION AND SERIAL NO. NM-012335 081208
b. TYPE OF WELL OIL WELL <input type="checkbox"/> GAS WELL <input type="checkbox"/> OTHER injection well SINGLE ZONE <input checked="" type="checkbox"/> MULTIPLE ZONE <input type="checkbox"/>		6. IF INDIAN, ALLOTTEE OR TRIBE NAME
2. NAME OF OPERATOR Tenneco Oil Company		7. UNIT AGREEMENT NAME
3. ADDRESS OF OPERATOR P.O. Box 3249, Englewood, Colorado 80155		8. FARM OR LEASE NAME Hospah
4. LOCATION OF WELL (Report location clearly and in accordance with any State requirements.) At surface 1860 FNL, 3210 FEL At proposed prod. zone 2460 FWL same as above		9. WELL NO. #70
14. DISTANCE IN MILES AND DIRECTION FROM NEAREST TOWN OR POST OFFICE* Approximately 1 mile south of Hospah		10. FIELD AND POOL, OR WILDCAT South Hospah, Lower Hospah
10. DISTANCE FROM PROPOSED* LOCATION TO NEAREST PROPERTY OR LEASE LINE, FT. (Also to nearest drlg. unit line, if any) 780'		11. SEC., T., R., M., OR BLK. AND SURVEY OR AREA Sec. 12, T17N, R9W
16. NO. OF ACRES IN LEASE 344.08 344.09		12. COUNTY OR PARISH McKinley
18. DISTANCE FROM PROPOSED LOCATION* TO NEAREST WELL, DRILLING COMPLETED, OR APPLIED FOR, ON THIS LEASE, FT. ±1715'		13. STATE N.M.
21. ELEVATIONS (Show whether DF, RT, GR, etc.) 7006' GR		17. NO. OF ACRES ASSIGNED TO THIS WELL injection well
20. ROTARY OR CABLE TOOLS 40 Rotary		22. APPROX. DATE WORK WILL START* May 1981

23. PROPOSED CASING AND CEMENTING PROGRAM

SIZE OF HOLE	SIZE OF CASING	WEIGHT PER FOOT	SETTING DEPTH	QUANTITY OF CEMENT
12 1/4"	8 5/8" new	24#	±150'	Circulate to surface
7 7/8"	5 1/2" new	15.5#	±1715'	Circulate to surface

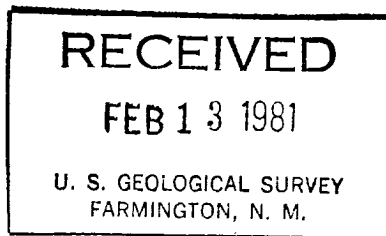
This action is subject to administrative
appeal pursuant to 30 CFR 290.STANDARDIZED ARE
SEE ATTACHED
"GENERAL INSTRUCTIONS"
See attached drilling procedure.

IN ABOVE SPACE DESCRIBE PROPOSED PROGRAM: If proposal is to deepen or plug back, give data on present productive zone and proposed new productive zone. If proposal is to drill or deepen directionally, give pertinent data on subsurface locations and measured and true vertical depths. Give blowout preventer program, if any.

34. SIGNED R. A. Mishler Sr. Production Analyst DATE February 6, 1981
R. A. Mishler
(This space for Federal or State office use)

PERMIT NO. _____ APPROVAL DATE _____

APPROVED BY _____ TITLE _____
CONDITIONS OF APPROVAL, IF ANY: _____

*See Instructions On Reverse Side

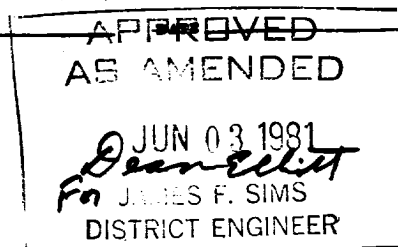

**NEW MEXICO OIL CONSERVATION COMMISSION
WELL LOCATION AND ACREAGE DEDICATION PLAT**

Form C-102
Supersedes C-128
Effective 1-1-65

All distances must be from the outer boundaries of the Section.

Operator TENNECO OIL COMPANY			Lease HOSPAH		Well No. 70
Unit Letter F	Section 12	Township 17N	Range 9W	County McKinley	
Actual Footage Location of Well: <div style="display: flex; justify-content: space-between;"> 1860 feet from the North line and 2460 feet from the West line 3210 feet from the East line </div>					
Ground Level Elev. 7006	Producing Formation N/A	Pool LOWER HOSPAH		Dedicated Acreage: injection well Acres	

1. Outline the acreage dedicated to the subject well by colored pencil or hachure marks on the plat below.
2. If more than one lease is dedicated to the well, outline each and identify the ownership thereof (both as to working interest and royalty).
3. If more than one lease of different ownership is dedicated to the well, have the interests of all owners been consolidated by communitization, unitization, force-pooling, etc?

☐ Yes ☐ No If answer is "yes," type of consolidation _____

If answer is "no," list the owners and tract descriptions which have actually been consolidated. (Use reverse side of this form if necessary.) _____

No allowable will be assigned to the well until all interests have been consolidated (by communitization, unitization, forced-pooling, or otherwise) or until a non-standard unit, eliminating such interests, has been approved by the Commission.

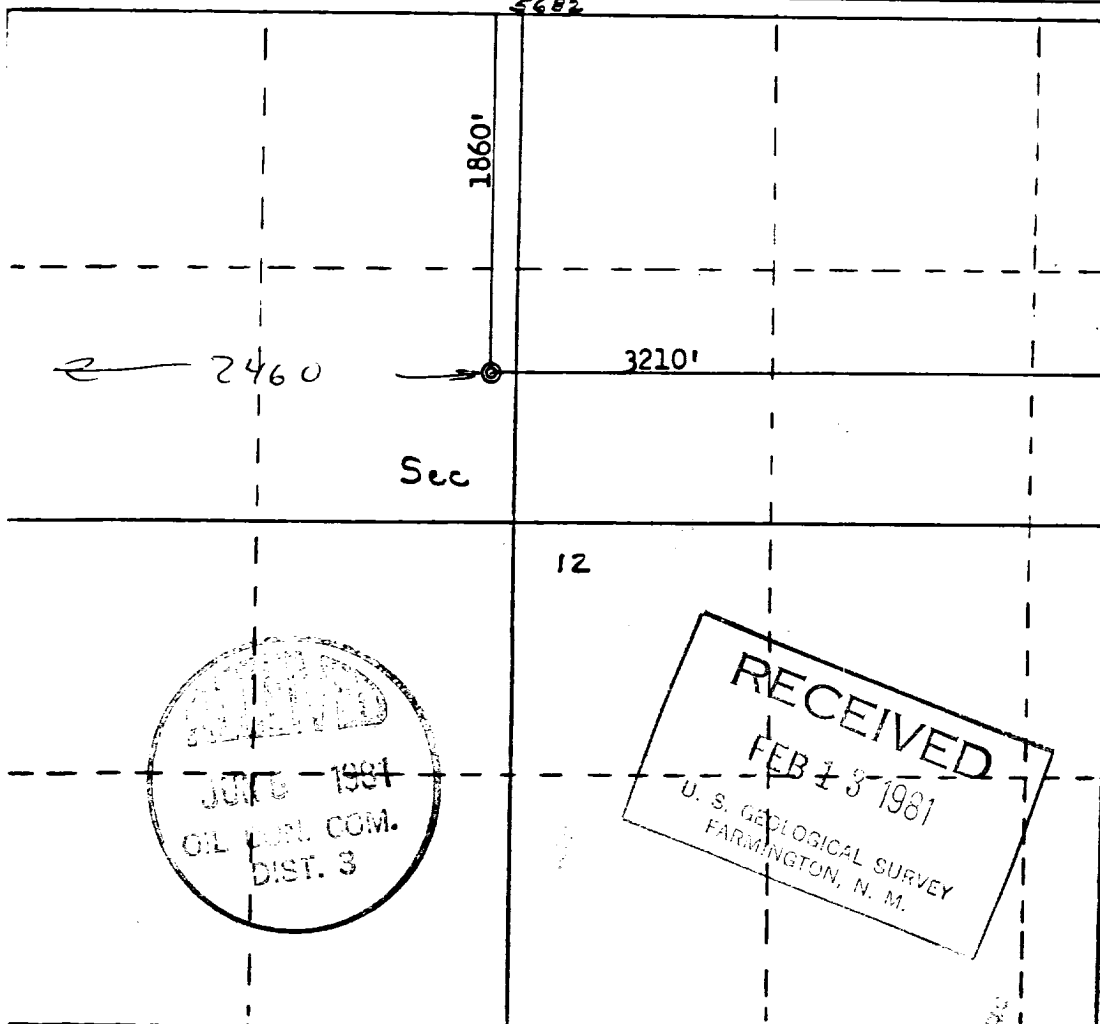

Scale: 1" = 1000'

CERTIFICATION	
I hereby certify that the information contained herein is true and complete to the best of my knowledge and belief.	
<i>R. A. Mishler</i>	
Name	R. A. Mishler
Position	Sr. Production Analyst
Company	Tenneco Oil Company
Date	February 6, 1981
I hereby certify that the well location shown on this plat was plotted from field notes of actual surveys made by me or under my supervision, and that the same is true and correct to the best of my knowledge and belief.	
Date Surveyed	January 30, 1981
Registered Professional Engineer and Land Surveyor	<i>Fred E. Kerr Jr.</i>
Certificate No.	3950