

AS RECEIVED	
DISTRIBUTION	
SANTA FE	
FILE	
U.S.G.S.	
LAND OFFICE	
OPERATOR	

5A. Indicate Type of Lease STATE <input type="checkbox"/> FEDERAL <input checked="" type="checkbox"/>
5. State Oil & Gas Lease No. 09725
7. Unit Agreement Name Miguel Creek
8. Form or Lease Name SFPRR
9. Well No. #54
10. Field and Pool, or Wildcat
12. County McKinley

APPLICATION FOR PERMIT TO DRILL, DEEPEN, OR PLUG BACK

1. Type of Work
DRILL ☒ DEEPEN ☐ PLUG BACK ☐

2. Type of Well
OIL WELL ☒ GAS WELL ☐ OTHER ☐ SINGLE ZONE ☐ MULTIPLE ZONE ☐

3. Name of Operator
Capital Oil & Gas Corporation

4. Address of Operator
P. O. Box 1038, Kilgore, Texas 75662

6. Location of Well
UNIT LETTER K LOCATED 2310' FEET FROM THE South LINE
2310' FEET FROM THE West LINE OF SEC. 21 TWP. 16N RGE. 6W NMPM

13. Proposed Depth 850'	13A. Formation Hospah	13B. Interval or C.T. RT
14. Elevations (Show whether DF, RI, etc.) 6408	21A. Kind & Status Plug. Bond 50,000 Blanket	21B. Drilling Contractor Balazar
		22. Approx. Date Work will start 6-27-81

3. PROPOSED CASING AND CEMENT PROGRAM

SIZE OF HOLE	SIZE OF CASING	WEIGHT PER FOOT	SETTING DEPTH	SACKS OF CEMENT	EST. TOP
7 7/8"	4 1/2"	9.5#	850'	150sx	Surf.

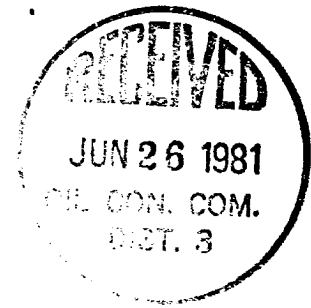

APPROVAL VALID
FOR 60 DAYS UNLESS
DRILLING COMMENCED,
EXPIRES 12-26-81

ABOVE SPACE DESCRIBE PROPOSED PROGRAM: IF PROPOSAL IS TO DEEPEN OR PLUG BACK, GIVE DATA ON PRESENT PRODUCTIVE ZONE AND PROPOSED NEW PRODUCTION ZONE. GIVE BLOWOUT PREVENTER PROGRAM, IF ANY.

I hereby certify that the information above is true and complete to the best of my knowledge and belief.

and Dary Blanks Title Representative Date 6/22/81

(This space for State Use)
APPROVED BY Frank J. Dary TITLE SUPERVISOR DISTRICT #3 DATE JUN 24 1981

CONDITIONS OF APPROVAL, IF ANY:

**NEW MEXICO OIL CONSERVATION COMMISSION
WELL LOCATION AND ACREAGE DEDICATION PLAT**

Form C-102
Supersedes C-128
Effective 1-1-65

All distances must be from the outer boundaries of the Section.

Operator Capital Oil & Gas Corporation			Lease 09725		Well No. 54
Unit Letter K	Section 21	Township 16N	Range 6W	County McKinley	
Actual Footage Location of Well: 2310 feet from the South line and 2310 feet from the West line					
Ground Level Elev. 6408	Producing Formation Hospah-Gallup		Pool Miguel Creek		Dedicated Acreage: 18.40 Acres

1. Outline the acreage dedicated to the subject well by colored pencil or hatchure marks on the plat below.
2. If more than one lease is dedicated to the well, outline each and identify the ownership thereof (both as to working interest and royalty).
3. If more than one lease of different ownership is dedicated to the well, have the interests of all owners been consolidated by communitization, unitization, force-pooling, etc?

☐ Yes ☐ No If answer is "yes," type of consolidation _____

If answer is "no," list the owners and tract descriptions which have actually been consolidated. (Use reverse side of this form if necessary.) _____

No allowable will be assigned to the well until all interests have been consolidated (by communitization, unitization, forced-pooling, or otherwise) or until a non-standard unit, eliminating such interests, has been approved by the Commission.

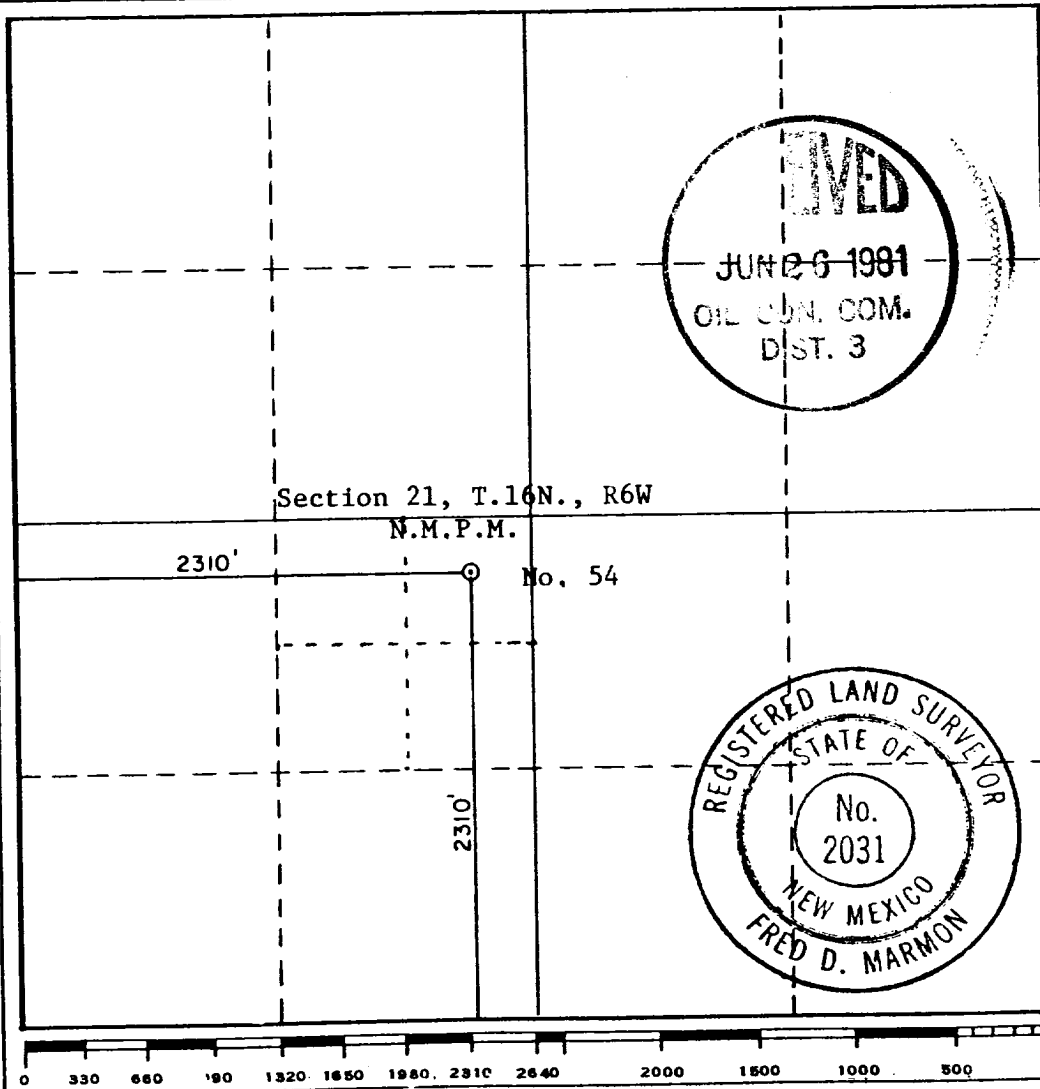

CERTIFICATION

I hereby certify that the information contained herein is true and complete to the best of my knowledge and belief.

Darryl Blonder
Name

Rep.
Position

Capital
Company

6-22-81
Date

I hereby certify that the well location shown on this plat was plotted from field notes of actual surveys made by me or under my supervision, and that the same is true and correct to the best of my knowledge and belief.

Date Surveyed
June 17, 1981

Registered Professional Engineer
and/or Land Surveyor

Fred D. Marmon

Certificate No.

2031