

OIL CONSERVATION DIVISION  
P. O. BOX 2088  
SANTA FE, NEW MEXICO 87501

30-031-20718  
Form C-101  
Revised 10-1-75

NO. OF COPIES REQUIRED	
DISTRIBUTION	
SANTA FE	
FILE	
U.S.G.S.	
LAND OFFICE	
OPERATOR	

APPLICATION FOR PERMIT TO DRILL, DEEPEN, OR PLUG BACK

1a. Type of Work  
 DRILL ☒ DEEPEN ☐ PLUG BACK ☐

b. Type of Well  
 OIL WELL ☒ GAS WELL ☐ OTHER ☐ SINGLE ZONE ☐ MULTIPLE ZONE ☐

2. Name of Operator  
 Capital Oil & Gas Corporation

3. Address of Operator  
 P. O. Box 1038, Kilgore, Texas 75662

4. Location of Well  
 UNIT LETTER M LOCATED 4244-1036 FEET FROM THE North ~~South~~ line  
 AND 330' FEET FROM THE West LINE OF SEC. 28 TWP. 16N RGE. 6W NMPA

5. Proposed Depth  
 3300'

6. Formation  
 Entrada

7. History of C.T.  
 RT

8. Elevations (Show whether D.F., R.I., etc.)  
 6442'

9. Kind & Status Plug. Bond  
 Blanket 50,000

10. Drilling Contractor  
 Salazar

11. Approx. Date Work will start  
 6/28/81

5A. Indicate Type of Lease  
 STATE ☐ FEE ☒

5. State Oil & Gas Lease No.  
 09725

7. Unit Agreement Name  
 White Mesa

8. Name of Lease Name  
 Montoya

9. Well No.  
 Lisa Lynn #1

10. Field and Pool, or Wildcat  
 Entrada Wildcat

12. County  
 McKinley

23. PROPOSED CASING AND CEMENT PROGRAM

SIZE OF HOLE	SIZE OF CASING	WEIGHT PER FOOT	SETTING DEPTH	SACKS OF CEMENT	EST. TOP
12 1/2	8 5/8	27#	400'	120sx	surf.
7 7/8	4 1/2	11.60#	3200'	150sx	2300'

Sufficient to cover  
 St. Joseph

- Set 400' 8 5/8" surface. Circulate cement to surface.
- If productive, set 3,200' of 4 1/2" - 11.60#, N-80 casing. Cement with 150 sx cement.

APPROVAL VALID  
 FOR 30 DAYS UNLESS  
 DRILLING COMMENCED,

EXPIRES 1-10-82



IN ABOVE SPACE DESCRIBE PROPOSED PROGRAM: IF PROPOSAL IS TO DEEPEN OR PLUG BACK, GIVE DATA ON PRESENT PRODUCTIVE ZONE AND PROPOSED NEW PRODUCTIVE ZONE. GIVE BLOWOUT PREVENTER PROGRAM, IF ANY.

I hereby certify that the information above is true and complete to the best of my knowledge and belief.

Signed Dorey Blankenship Title Representative Date 6/22/81

(This space for State Use)

APPROVED BY Frank J. Chang TITLE SUPERVISOR DISTRICT # 3 DATE JUL 10 1981

CONDITIONS OF APPROVAL, IF ANY:

See cementing  
 Well C-104 for NSP

**NEW MEXICO OIL CONSERVATION COMMISSION  
WELL LOCATION AND ACREAGE DEDICATION PLAT**

Form C-102  
Supersedes C-128  
Effective 1-1-65

All distances must be from the outer boundaries of the Section.

Operator <b>Capital Oil &amp; Gas Corporation</b>			Lease <b>Montoya</b>		Well No. <b>Lisa Lynn #1</b>
Unit Letter <b>M</b>	Section <b>28</b>	Township <b>16N</b>	Range <b>6W</b>	County <b>McKinley</b>	
Actual Footage Location of Well: <b>4244</b> feet from the <b>North</b> line and <b>330</b> feet from the <b>West</b> line					
Ground Level Elev. <b>6442</b>	Producing Formation <b>Entrada</b>		Pool <b>Entrada</b>		Dedicated Acreage: <b>40</b> Acres

1. Outline the acreage dedicated to the subject well by colored pencil or hachure marks on the plat below.
2. If more than one lease is dedicated to the well, outline each and identify the ownership thereof (both as to working interest and royalty).
3. If more than one lease of different ownership is dedicated to the well, have the interests of all owners been consolidated by communitization, unitization, force-pooling, etc?

☐ Yes    ☒ No    If answer is "yes," type of consolidation \_\_\_\_\_

If answer is "no," list the owners and tract descriptions which have actually been consolidated. (Use reverse side of this form if necessary.) Zenith Energy and Capital Oil & Gas, 100% working interest on the lease.

No allowable will be assigned to the well until all interests have been consolidated (by communitization, unitization, forced-pooling, or otherwise) or until a non-standard unit, eliminating such interests, has been approved by the Commission.

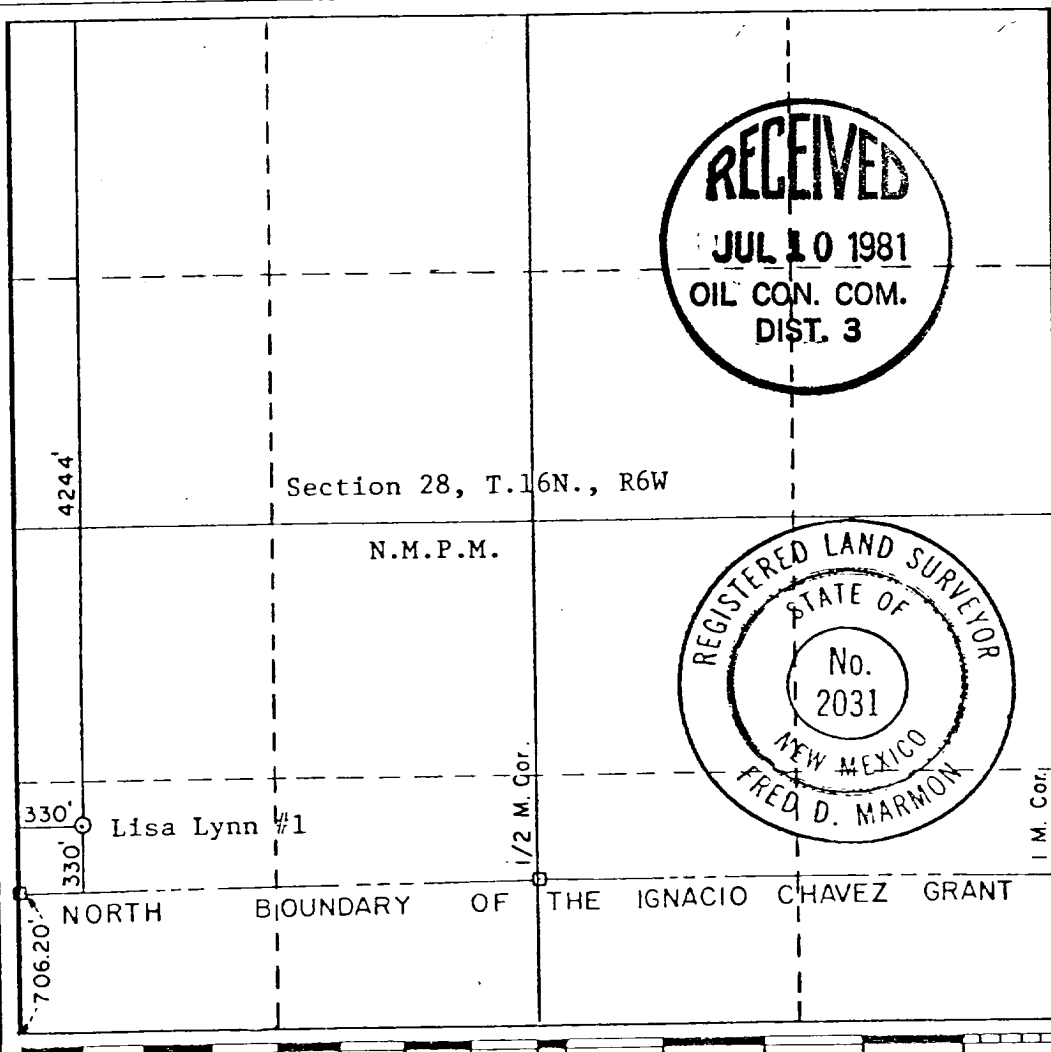

**CERTIFICATION**

I hereby certify that the information contained herein is true and complete to the best of my knowledge and belief.

Name Dary Blanks

Position Rep

Company Capital

Date 6-22-81

Date

I hereby certify that the well location shown on this plat was plotted from field notes of actual surveys made by me or under my supervision, and that the same is true and correct to the best of my knowledge and belief.

Date Surveyed  
**June 17, 1981**

Registered Professional Engineer  
and/or Land Surveyor

Fred D. Marmion  
Certificate No.