

NO. OF COPIES RECEIVED	
DISTRIBUTION	
SANTA FE	
FILE	
U.S.G.S.	
LAND OFFICE	
OPERATOR	

1. Indicate Type of Lease
STATE ☐ FEDERAL ☒

2. State Oil & Gas Lease No.
09725

APPLICATION FOR PERMIT TO DRILL, DEEPEN, OR PLUG BACK

10. Type of Work
a. Type of Well
DRILL ☒ DEEPEN ☐ PLUG BACK ☐
b. Type of Well
OIL WELL ☒ GAS WELL ☐ OTHER ☐
SINGLE ZONE ☒ MULTIPLE ZONE ☐

2. Name of Operator
CAPITAL OIL & GAS CORPORATION

3. Address of Operator
P.O. BOX 1038, KILGORE, TEXAS 75662

4. Location of Well
UNIT LETTER N LOCATED 1650 FEET FROM THE East West LINE
990
330 FEET FROM THE South LINE OF SEC. 28 TWP. 16N RSE. 6W NMPM

7. Well Agreement Name
MIGUEL CREEK

8. Name of Lessee Name
MONTROYA

9. Well No.
#1

10. Field and Pool, or Wildcat
MIGUEL CREEK GALLUP

11. County
McKinley

13. Proposed Depth
1000'

14A. Formation
Hospah

15. Elevation (Show whether in K1, etc.)
6477' GL

21A. Kind & Status Plug. Bond
50,000 Blanket

21B. Drilling Contractor
Alamo Drilling

22. Approx. Date Work will start
10-20-81

23. PROPOSED CASING AND CEMENT PROGRAM

SIZE OF HOLE	SIZE OF CASING	WEIGHT PER FOOT	SETTING DEPTH	SACKS OF CEMENT	EST. TOP
7 7/8	5 1/2	14#	1000'	125	Surface

1. Drill and Core to a Depth 20' below the Hospah Sand.
2. Run Open Hole Logs.
3. Run New 5 1/2", 14# Casing.
4. Pump 125 Sacks Class "H" Cement.

APPROVAL VALID
FOR 30 DAYS UNLESS
DRILLING COMMENCED,
EXPIRES - 4-19-82



IN ABOVE SPACE DESCRIBE PROPOSED PROGRAM: IF PROPOSAL IS TO DEEPEN OR PLUG BACK, GIVE DATA ON PRESENT PRODUCTION RATE AND PROPOSED NEW PRODUCTION RATE. GIVE SLOUGH PREVENTION PROGRAM, IF ANY.

I hereby certify that the information above is true and complete to the best of my knowledge and belief.

Signed Darryl Blum Title V.P. Operations Date 10/15/81

(Space for State Use)

APPROVED BY Jeff A. Edmister TITLE DEPUTY OIL & GAS INSPECTOR, DIST. #3 DATE OCT 19 1981

CONDITIONS OF APPROVAL, IF ANY:

Submit plans for surface pipe before spudding well

FILE

NEW MEXICO OIL CONSERVATION COMMISSION
WELL LOCATION AND ACREAGE DEDICATION PLAT

Form C-102
Supersedes C-128
Effective 1-1-65

All distances must be from the outer boundaries of the Section.

Operator CAPITAL OIL & GAS CORPORATION		Lease MONTOYA		Well No. Montoya #1
Unit Letter N	Section 28	Township 16N	Range 6W	County McKinley
Actual Footage Location of Well: 990 feet from the South line and 1650 feet from the West line				
Ground Level Elev. 6477	Producing Formation Hospah	Pool Miguel Creek Gallup	Dedicated Acreage: 40 Acres	

1. Outline the acreage dedicated to the subject well by colored pencil or hatchure marks on the plat below.
2. If more than one lease is dedicated to the well, outline each and identify the ownership thereof (both as to working interest and royalty).
3. If more than one lease of different ownership is dedicated to the well, have the interests of all owners been consolidated by communitization, unitization, force-pooling, etc?

☐ Yes ☒ No If answer is "yes," type of consolidation _____

If answer is "no," list the owners and tract descriptions which have actually been consolidated. (Use reverse side of this form if necessary.) Capital Oil & Gas owns 100% interest in this & surrounding leases.

No allowable will be assigned to the well until all interests have been consolidated (by communitization, unitization, forced-pooling, or otherwise) or until a non-standard unit, eliminating such interests, has been approved by the Commission.

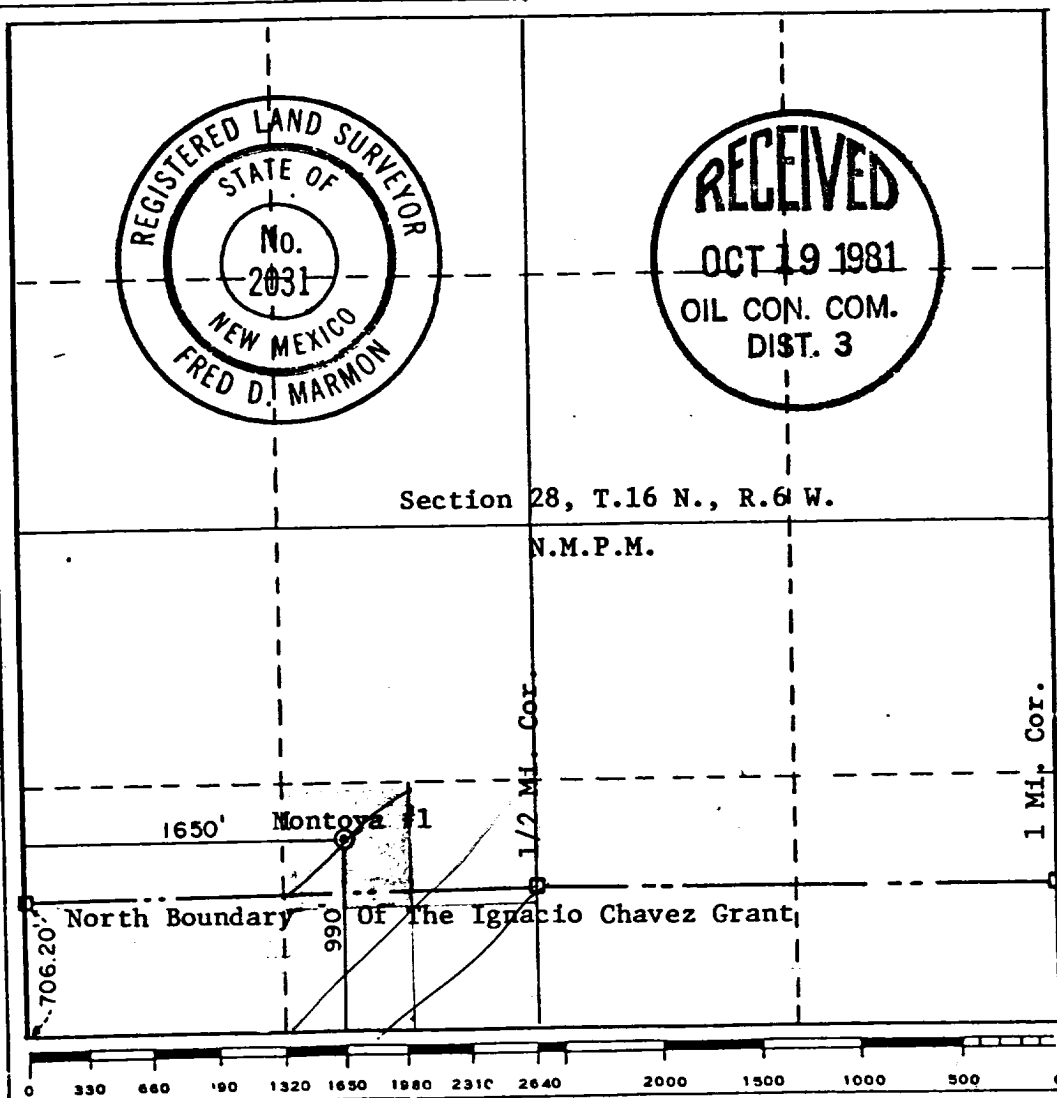

CERTIFICATION

I hereby certify that the information contained herein is true and complete to the best of my knowledge and belief.

Dave Blank
Name

V.P. Operations

Position

CAPITAL OIL & GAS CORP.

Company

10/15/81

Date

I hereby certify that the well location shown on this plat was plotted from field notes of actual surveys made by me or under my supervision, and that the same is true and correct to the best of my knowledge and belief.

Date Surveyed

Oct. 12, 1981

Registered Professional Engineer
and/or Land Surveyor

Fred D. Marmion

Certificate No.

2031