

83

1980' FSL & 10' FWL

21

16N

6W

W.

FOOTAGE LOCATION

SECTION

TOWNSHIP

RANGE

Schematic

Tabular Data

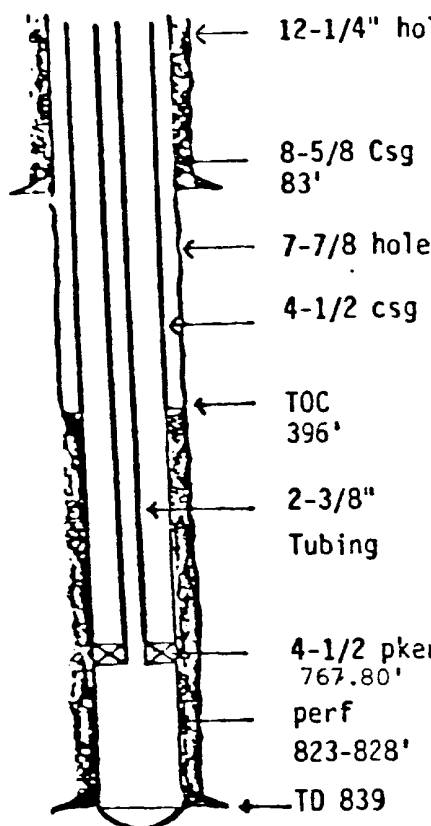

Surface Casing

Size 8-5/8 Cemented with 75 %.TOC Surface feet determined by VisualHole size 12-1/4"

Intermediate Casing

Size Cemented with %.TOC feet determined by Hole size

Long string

Size 4-1/2 Cemented with 85 %.TOC 396' feet determined by CalculatedHole size 7-7/8Total depth 839'

Injection Interval

823 feet to 238 (4JSPF) feet
(perforated or open-hole, indicate which) tubing size 2-3/8 lined with J-55 set in a

(material)

Guiberson Uni - 1

packer at 767.80 feet

(brand and model)

or describe any other casing-tubing seal).

Other Data

1. Name of the injection formation Gallup - Hoshah2. Name of Field or Pool (if applicable) Miguel Creek - Gallup3. Is this a new well drilled for injection? ☒ Yes ☐ NoIf no, for what purpose was the well originally drilled? 4. Has the well ever been perforated in any other zone(s)? List all such perforated intervals and give plugging detail (sacks of cement or bridge plug(s) used) No other perf.5. Give the depth to and name of any overlying and/or underlying oil or gas zones (pools) in this area. None in this area



STATE OF NEW MEXICO
ENERGY AND MINERALS DEPARTMENT

OIL CONSERVATION DIVISION
AZTEC DISTRICT OFFICE

1000 RIO BRAZOS ROAD
AZTEC, NEW MEXICO 87410
(505) 334-6178

OIL CONSERVATION DIVISION
BOX 2088
SANTA FE, NEW MEXICO 87501

DATE 2-25-93

RE: Proposed MC _____
Proposed DHC _____
Proposed NSL ☒ _____
Proposed SWD _____
Proposed WFX _____
Proposed PMX _____

Gentlemen:

I have examined the application dated 2-25-93
for the Capital O&G Corp SFPRR # 93 L-21-16N-6W
Operator Lease and Well No. Unit, S-T-R

and my recommendations are as follows:

Approve

Yours truly,

Jeff A. Edmister



RECEIVED

FEB 25 1983

OIL CON. DIV.

Capital Oil and Gas Corporation

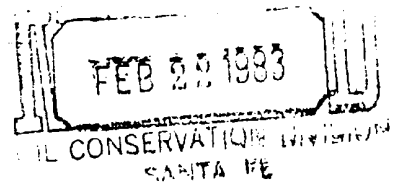

214 - 983-2081

February 17, 1983

214 - 983-2082

Mr. Joe Ramey
Energy and Minerals Department
Oil Conservation Commission
P. O. Box 2088
Santa Fe, New Mexico 87501

Re: Commission Order R-4875

Dear Mr. Ramey:

Enclosed is information needed for request of administrative approval for a nonstandard location for our SFPRR Nos. 79, 80 and 83 wells. The information enclosed is in compliance with the Operating Rules for the Waterflood Project, Miguel Creek Field, Gallup Pool, in McKinley County, New Mexico, Case No. 5321. As requested in Paragraph 6 of the Commission Order No. R-4875, we seek approval for a nonstandard location for SFPRR Nos. 79, 80 and 83.

- A. A plat marked "Exhibit A" for each well is enclosed, showing new location and the particle of acreage dedicated to the well.
- B. Enclosure for each well marked "Exhibit B" is an aerial map of each location and offset wells. At the present time, there are no offset producers except for Capital Oil and Gas Corporation in the area.
- C. "Exhibit C" is a downhole schematic of each well.
- D. "Exhibit D" is a Sundry Notice and Report on Well (Form C-103) for each well.
- E. A nonstandard location is needed for these wells to be in a line drive sequence for a proposed waterflood in this section of the field.
- F. To our knowledge, there are no water, oil and gas strata zones of the Gallup Hospah pay zone in this area.

This information should be satisfactory with the rules set forth in the Commission Order R-4875. If you need further information, please do not hesitate to contact me.

Yours very truly,

CAPITAL OIL AND GAS CORPORATION

By Gary Blanks
Gary Blanks, Vice President

GB:jh

OIL CONSERVATION DIVISION

P. O. BOX 2088

SANTA FE, NEW MEXICO 87501

Form C-102
Revised 10-1-78

All distances must be from the outer boundaries of the Section

Operator Capital Oil and Gas Corporation			Lease S.F.P.R.R.		<div style="border: 2px solid black; padding: 5px; display: inline-block;"> RECEIVED FEB 23 1983 OIL CONSERVATION DIVISION SANTA FE </div>	Well No. S.F.P.R.R. #83
Unit Letter L	Section 21	Township 16N.	Range 6W.	County McKinley		
Actual Footage Location of Well: <div style="display: flex; justify-content: space-between;"> 1980' feet from the South line and 10' feet from the West line </div>						
Ground Level Elev. 6471.02'	Producing Formation Hospah-Gallup	Pool Miguel Creek Gallup Extension		Dedicated Acreage: 40 Acres		

1. Outline the acreage dedicated to the subject well by colored pencil or hatchure marks on the plat below.
2. If more than one lease is dedicated to the well, outline each and identify the ownership thereof (both as to working interest and royalty).
3. If more than one lease of different ownership is dedicated to the well, have the interests of all owners been consolidated by communitization, unitization, force-pooling, etc?

☐ Yes ☒ No If answer is "yes," type of consolidation _____

If answer is "no," list the owners and tract descriptions which have actually been consolidated. (Use reverse side of this form if necessary.) Capital Oil and Gas Corporation and Zenith Energy Corporation own 100% working interest in the lease
 No allowable will be assigned to the well until all interests have been consolidated (by communitization, unitization, forced-pooling, or otherwise) or until a non-standard unit, eliminating such interests, has been approved by the Commission.

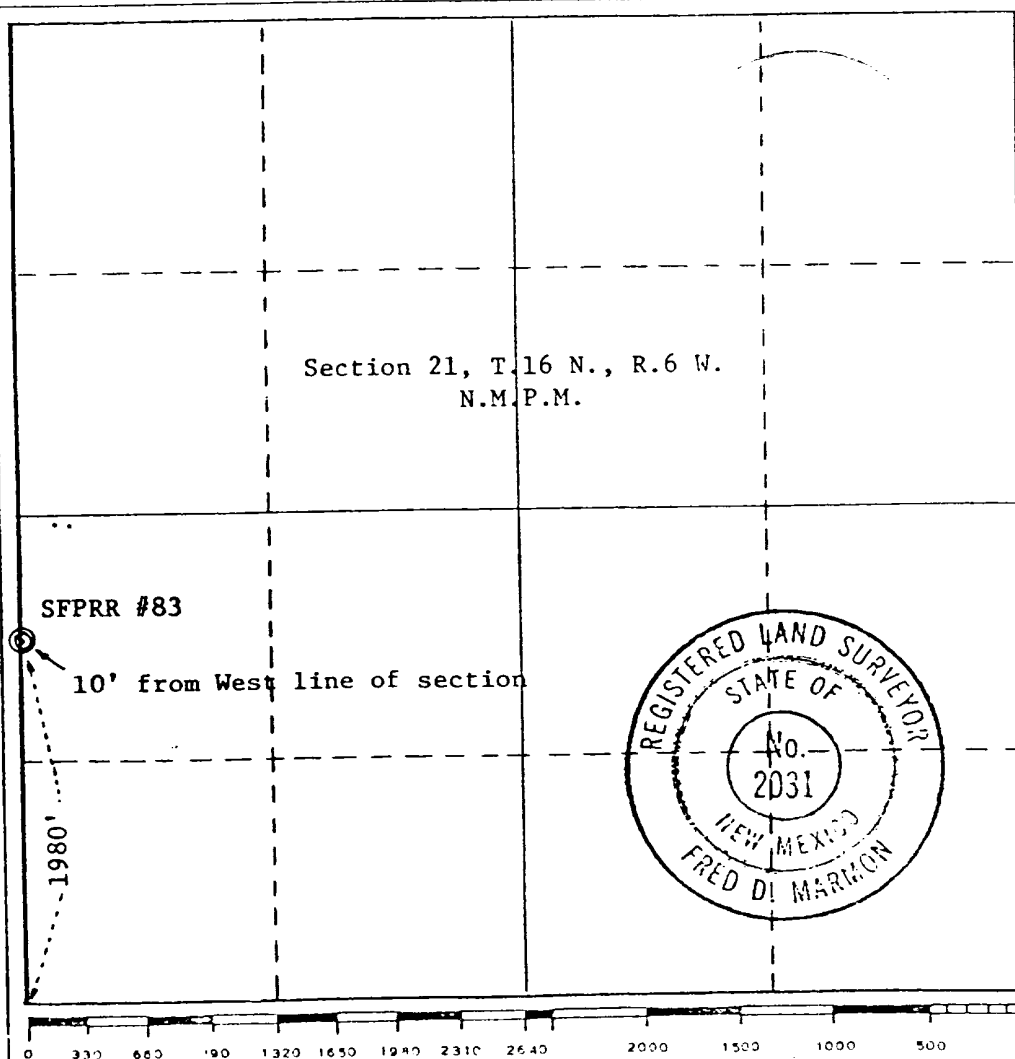

CERTIFICATION	
I hereby certify that the information contained herein is true and complete to the best of my knowledge and belief.	
Name	<u>Jean Houston</u>
Position	Agent
Company	Capital Oil and Gas Corporation
Date	4/22/82
I hereby certify that the well location shown on this plat was plotted from field notes of actual surveys made by me or under my supervision, and that the same is true and correct to the best of my knowledge and belief.	
Date Surveyed	March 12, 1982
Registered Professional Engineer and/or Land Surveyor <u>Fred D. Marmion</u>	
Certificate No.	2031

86
0

7
8
9
6
4
3
5
1
2

20

21

6800

No 1 FERNANDEZ

No 2 FERNANDEZ

35
36
24
25
34
32
44
23
11
2
22

31
39
45
40
46
60

28

29

- - Producing Well
- - Proposed Location
- ✂ - Shut-In Well
- ▲ - Injection Well
- ✦ - Plugged Well

S
A
Z

No 1 MONTANA

Capital Oil & Gas Corp.
SFPRR Lease
Miguel Creek Field

EXHIBIT B

32

33