

APPROVED	
DISTRIBUTION	
DATE	
BY	
OFFICE	
OPERATOR	

30-031-20819

## APPLICATION FOR PERMIT TO DRILL, DEEPEN, OR PLUG BACK

Type of Work

DRILL ☒DEEPEN ☐PLUG BACK ☐

Type of Well

☒

SAB

WELL ☐OTHER ☐SINGLE ZONE ☐MULTIPLE ZONE ☐

Name of Operator

CAPITAL OIL &amp; GAS CORPORATION

Address of Operator

P. O. DRAWER M MILAN, NEW MEXICO 87021

Location of Well

UNIT LETTER E LOCATED 1650 FEET FROM THE North LINE

330

FEET FROM THE West LINE OF SEC. 16 TWP. 16N R. 6W

1. Indicate Type of License

STATE ☒FEE ☐

2. State Oil &amp; Gas License No.

L-6469

3. Unit Agreement Name

Miguel Creek - Gallup

4. Name of Lease Name

STATE

5. Well No.

State #17

6. Field and Pool, or Wildcat

WILDCAT Under Gallup

7. County

McKinley

15. Proposed Depth

1300'

19A. Formation

Hospah-Gallup

20. Rotary or C.T.

Rotary

21A. Kind &amp; Status Plug. Bond

476.92

\$50,000

21B. Drilling Contractor

Alamo Drilling, Inc.

22. Approx. Date Work will start

10-22-82

## PROPOSED CASING AND CEMENT PROGRAM

SIZE OF HOLE	SIZE OF CASING	WEIGHT PER FOOT	SETTING DEPTH	SACKS OF CEMENT	EST. TOP
12 1/4	8 5/8	24	90 ft.	85	Surface
7 7/8	5 1/2	15-50	TD	175	400

1. Drill 12 1/4 hole. Set 2 joints 8 5/8. Cement surface.
2. Drill to top of Hospah.
3. Core log. Drill 20' rat hole
4. If commercially productive, set 4 1/2 casing to total depth and cement with 175 sacks of cement.

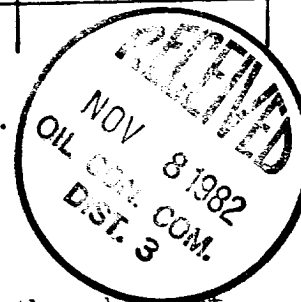

APPROVAL VALID  
FOR 90 DAYS UNLESS  
DRILLING COMMENCED,

EXPIRES 5-8-83

OVER SPACE DESCRIBE PROPOSED PROGRAM IF PROPOSAL IS TO DEEPEN OR PLUG BACK. GIVE DATA ON PRESENT PRODUCTIVE ZONE AND PROPOSED NEW PRODUCTIONS. GIVE DOWNSIDE PREVENTION PROGRAM IF ANY.

I certify that the information above is true and complete to the best of my knowledge and belief.

Tul. Representative

Date 10/22/82

Original Signed by CHARLES GHOLSON

SUPERVISOR DISTRICT # 3

NOV 8 1982

DATE

Joint with wells 13, 14, + 18.

## OIL CONSERVATION DIVISION

P. O. BOX 2088

SANTA FE, NEW MEXICO 87501

Form C-102

Revised 10-1-78

*Milton Office*

All distances must be from the outer boundaries of the Section.

Capital Oil & Gas			Lease State Lease L-6469			Well No. State #17			
Section	16	Township	16N.	Range	6W.	County McKinley			
Footage Location of Well:									
1650'			feet from the North line and			990' feet from the West line			
Land Level Elev.	6476.92			Producing Formation	Hospah-Gallup		Pool	Circles	
							Dedicated Acreage:	Joint with wells # 40 13, 14, & 18 Acres	

1. Outline the acreage dedicated to the subject well by colored pencil or hachure marks on the plat below.
2. If more than one lease is dedicated to the well, outline each and identify the ownership thereof (both as to working interest and royalty).
3. If more than one lease of different ownership is dedicated to the well, have the interests of all owners been consolidated by communitization, unitization, force-pooling, etc?

☐ Yes ☒ No If answer is "yes," type of consolidation \_\_\_\_\_

If answer is "no," list the owners and tract descriptions which have actually been consolidated. (Use reverse side of this form if necessary.) Golden Exploration, Inc. owns 100% interest

No allowable will be assigned to the well until all interests have been consolidated (by communitization, unitization, forced-pooling, or otherwise) or until a non-standard unit, eliminating such interests, has been approved by the Commission.

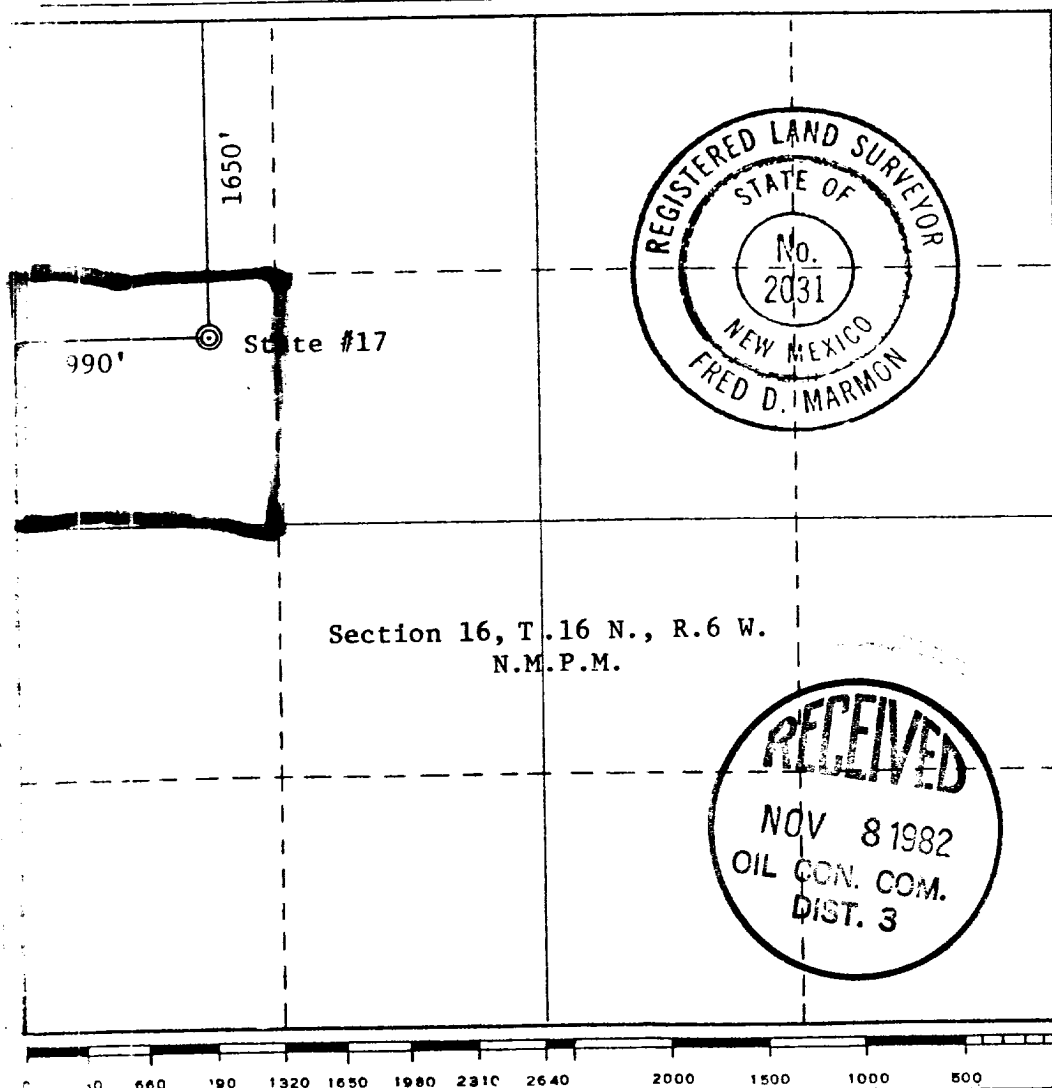

## CERTIFICATION

I hereby certify that the information contained herein is true and complete to the best of my knowledge and belief.

Name

Representative

Position

Capital Oil &amp; Gas

Company

October 22, 1982

Date

I hereby certify that the well location shown on this plat was plotted from field notes of actual surveys made by me or under my supervision, and that the same is true and correct to the best of my knowledge and belief.

Date Surveyed

March 21, 1982

Registered Professional Engineer and/or Land Surveyor

*Fred D. Marmion*

Certificate No.

2031