

NAME OF OPERATOR	
DISTRIBUTION	
DATE	
TIME	
NO. OF WELLS	
AND OFFICE	
OPERATOR	

P. O. BOX 2088
SANTA FE, NEW MEXICO 87501

5A. Indicate Type of Lease

STATE ☒ FEDERAL ☐

5. State Oil & Gas Lease No.

L-6469

30-031-20827
APPLICATION FOR PERMIT TO DRILL, DEEPEN, OR PLUG BACK

7. Unit Agreement Form

Miguel Creek - Gallup

8. Form or Lease Name

STATE

9. Well No.

State #12

10. Field and Pool, or Wildcat

WILDCAT Under Gallup

12. County

McKinley

Type of Work

DRILL ☒DEEPEN ☐PLUG BACK ☐

No. of Well

☒CAB
WELL ☐

OTHER

SINGLE
ZONE ☐MULTIPLE
ZONE ☐

Name of Operator

CAPITAL OIL & GAS CORPORATION

Address of Operator

P. O. DRAWER M MILAN, NEW MEXICO 87021

Location of Well

UNIT LETTER

L

LOCATED 2310'

FEET FROM THE South

LINE

330'

FEET FROM THE West

LINE OF SEC. 16

TWP. 16N

R. 6W

S. 34N

19. Proposed Depth

1300'

19A. Formation

Hospah-Gallup

20. Rotary or C.T.

Rotary

Elevations (Show whether D.T., K.T., etc.)

514.40'

21A. Kind & Status Plug. Bond

\$50,000

21B. Drilling Contractor

Alamo Drilling, Inc.

22. Approx. Date Work will start

10-22-82

PROPOSED CASING AND CEMENT PROGRAM

SIZE OF HOLE	SIZE OF CASING	WEIGHT PER FOOT	SETTING DEPTH	SACKS OF CEMENT	EST. TOP
12 1/4	8 5/8	24	90 ft.	85	Surface
7 7/8	5 1/2	15-50	TD	175	400

1. Drill 12 1/4 hole. Set 2 joints 8 5/8. Cement surface.
2. Drill to top of Hospah.
3. Core log. Drill 20' rat hole
4. If commercially productive, set 4 1/2 casing to total depth and cement with 175 sacks of cement.

APPROVAL VALID
FOR 30 DAYS UNLESS
DRILLING COMMENCED.

EXPIRES 5-8-83

GIVE SPACE DESCRIBE PROPOSED PROGRAM IF PROPOSAL IS TO DEEPEN OR PLUG BACK. GIVE DATA ON PRESENT PRODUCTIVE ZONE AND PROPOSED NEW PROGRAM. GIVE BLOWOUT PREVENTER PROGRAM, IF ANY.

I hereby certify that the information above is true and complete to the best of my knowledge and belief.

Title Representative

Date 10/22/82

(This space for State Use)

SUPERVISOR DISTRICT # 3

NOV 8 1982

APPROVED BY

TITLE

DATE

REASONS OF APPROVAL, IF ANY:

Joint with State wells # 7, 8, & 11

OIL CONSERVATION DIVISION

P. O. BOX 2088

SANTA FE, NEW MEXICO 87501

Form C-102
Revised 10-1-78*Milton Office*

All distances must be from the outer boundaries of the Section.

Capital Oil & Gas			Lease State Lease L-6469			Well No. State #12		
Section 16	Township 16N.	Range 6W.	County McKinley					
Footage Location of Well: 2310' feet from the South line and 330' feet from the West line								
Level Elev. 514.40'	Producing Formation Hospah-Gallup		Pool Unders			Dedicated Acreage: 40 Joint with # 7, 8 + 11 Acres		

Outline the acreage dedicated to the subject well by colored pencil or hachure marks on the plat below.

If more than one lease is dedicated to the well, outline each and identify the ownership thereof (both as to working interest and royalty).

If more than one lease of different ownership is dedicated to the well, have the interests of all owners been consolidated by communitization, unitization, force-pooling, etc?

☐ Yes ☒ No If answer is "yes," type of consolidation _____If answer is "no," list the owners and tract descriptions which have actually been consolidated. (Use reverse side of this form if necessary.) Golden Exploration owns 100%

No allowable will be assigned to the well until all interests have been consolidated (by communitization, unitization, forced-pooling, or otherwise) or until a non-standard unit, eliminating such interests, has been approved by the Commission.

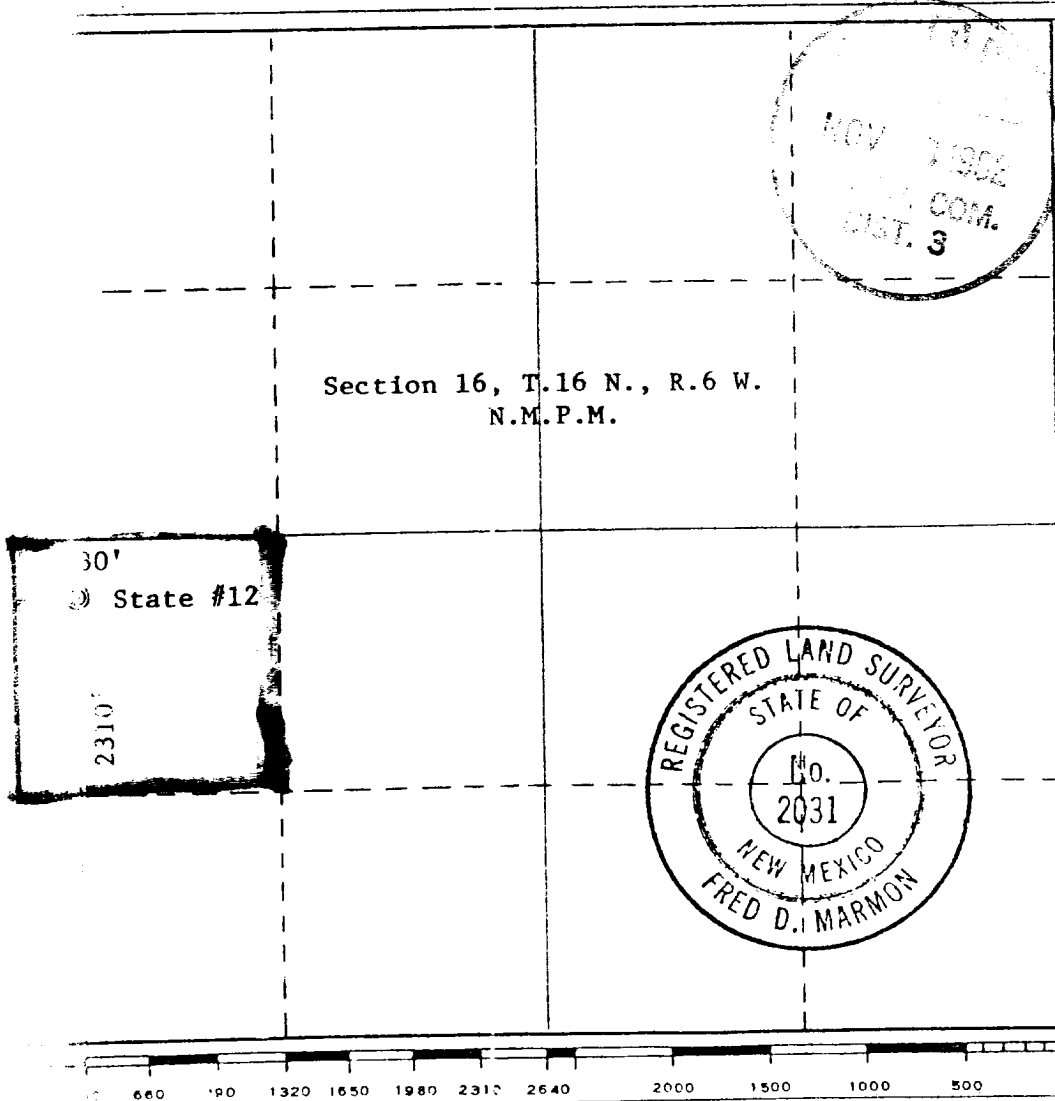

CERTIFICATION

I hereby certify that the information contained herein is true and complete to the best of my knowledge and belief.

Jim Pepper
Representative

Position

Capital Oil & Gas

Company

October 22, 1982

Date

I hereby certify that the well location shown on this plat was plotted from field notes of actual surveys made by me or under my supervision, and that the same is true and correct to the best of my knowledge and belief.

Date Surveyed

March 19, 1982

Registered Professional Engineer
and/or Land Surveyor*Fred D. Marmion*

Certificate No.

2031