

STATE OF NEW MEXICO  
ENERGY AND MINERALS DEPARTMENT

OIL CONSERVATION DIVISION

P. O. BOX 2088

SANTA FE, NEW MEXICO 87501

Form C-101  
Revised 10-1-78

NO. OF COPIES RECEIVED	
DISTRIBUTION	
SANTA FE	
FILE	
U.S.G.S.	
LAND OFFICE	
OPERATOR	

APPROVAL EXPIRES 10-10-85  
UNLESS DRILLING IS COMMENCED.  
SPUD NOTICE MUST BE SUBMITTED  
WITHIN 10 DAYS.

5A. Indicate Type of Lease  
STATE ☒ FEE ☐  
5. State Oil & Gas Lease No.  
V 82-3

APPLICATION FOR PERMIT TO DRILL, DEEPEN, OR PLUG BACK

1a. Type of Work b. Type of Well OIL WELL <input checked="" type="checkbox"/> GAS WELL <input type="checkbox"/> OTHER <input type="checkbox"/> SINGLE ZONE <input checked="" type="checkbox"/> MULTIPLE ZONE <input type="checkbox"/>		7. Unit Agreement Name	
2. Name of Operator Merrion Oil & Gas Corporation		8. Farm or Lease Name Zia	
3. Address of Operator P. O. Box 1017, Farmington, New Mexico 87499		9. Well No. 1	
4. Location of Well UNIT LETTER <u>O</u> LOCATED <u>990'</u> FEET FROM THE <u>South</u> LINE AND <u>1980'</u> FEET FROM THE <u>East</u> LINE OF SEC. <u>2</u> TWP. <u>20N</u> RGE. <u>6W</u> NMPM		10. Field and Pool, or Wildcat WC Mesaverde	
		12. County McKinley	
		19. Proposed Depth 3185'	
		19A. Formation Mesaverde	
		20. Rotary or C.T. Rotary	
21. Elevations (Show whether DF, RT, etc.) 6922' GL		21A. Kind & Status Plug. Bond Nationwide	
		21B. Drilling Contractor Unknown	
		22. Approx. Date Work will start Summer/1985	

PROPOSED CASING AND CEMENT PROGRAM

SIZE OF HOLE	SIZE OF CASING	WEIGHT PER FOOT	SETTING DEPTH	SACKS OF CEMENT	EST. TOP
12-1/4"	8-5/8"	23 #/ft. J-55	200 ft.	175 sx (206.5 cu. ft.)	Surface
7-7/8"	4-1/2"	10.5 #/ft. J-55	3185 ft.	450 sx	

Propose to drill 12-1/4" hole to 200 ft. Will set 200 ft. of 8-5/8", 23 #/ft. J-55 surface casing with 175 sx Class B 2% CaCl<sub>2</sub>. Wait on cement 10 hours, nipple up BOPs and pressure test to 600 PSI prior to drill out. Will drill 7-7/8" hole to 3185 ft. KB with fresh water, gel, starch, low solids non-dispersed mud system. No unusual problems anticipated. Will run open hole logs. If well appears productive, will run 4-1/2", 10.5 #/ft. J-55 casing to 3185 ft. and cement in one stage with 250 sx Class B 2% D-79 (650 cu. ft.) followed by 200 sx Class H 2% gel (244 cu. ft.). Will perforate and stimulate the Mesaverde as necessary. Pressure control will be double ram BOP with minimum working pressure of 2000 PSI.

ESTIMATED TOPS

Ojo Alamo	Surface	Cliffhouse	185
Kirtland	152	Menefee	208
Fruitland	432	Point Lookout	2985
Pictured Cliffs	680	Total Depth	3185

RECEIVED

APR 10 1985

OIL CON. DIV

DIST. 3

IN ABOVE SPACE DESCRIBE PROPOSED PROGRAM: IF PROPOSAL IS TO DEEPEN OR PLUG BACK, GIVE DATA ON PRESENT PRODUCTIVE ZONE AND PROPOSED NEW PRODUCTIVE ZONE. GIVE BLOWOUT PREVENTER PROGRAM, IF ANY.

I hereby certify that the information above is true and complete to the best of my knowledge and belief.

Signed Alan Lab Title Operations Manager Date 4/9/85

(This space for State Use)

APPROVED BY Barry D. [Signature] TITLE SUPERVISOR DISTRICT # 3 DATE APR 10 1985

CONDITIONS OF APPROVAL, IF ANY:

**NEW MEXICO OIL CONSERVATION COMMISSION  
WELL LOCATION AND ACREAGE DEDICATION PLAT**

Form C-102  
Supersedes C-128  
Effective 1-1-65

All distances must be from the outer boundaries of the Section.

Operator <b>MERRION OIL &amp; GAS CORPORATION</b>			Lease <b>ZIA</b>		Well No. <b>1</b>
Unit Letter <b>0</b>	Section <b>2</b>	Township <b>20N</b>	Range <b>6W</b>	County <b>McKinley</b>	
Actual Footage Location of Well: <b>990</b> feet from the <b>South</b> line and <b>1980</b> feet from the <b>East</b> line					
Ground Level Elev: <b>6922</b>	Producing Formation <b>Mesaverde</b>		Pool <b>WC Mesaverde</b>		Dedicated Acreage: <b>40</b> Acres

1. Outline the acreage dedicated to the subject well by colored pencil or hachure marks on the plat below.
2. If more than one lease is dedicated to the well, outline each and identify the ownership thereof (both as to working interest and royalty).
3. If more than one lease of different ownership is dedicated to the well, have the interests of all owners been consolidated by communitization, unitization, force-pooling, etc?

☐ Yes   ☐ No   If answer is "yes," type of consolidation \_\_\_\_\_

If answer is "no," list the owners and tract descriptions which have actually been consolidated. (Use reverse side of this form if necessary.) \_\_\_\_\_

No allowable will be assigned to the well until all interests have been consolidated (by communitization, unitization, forced-pooling, or otherwise) or until a non-standard unit, eliminating such interests, has been approved by the Commission.

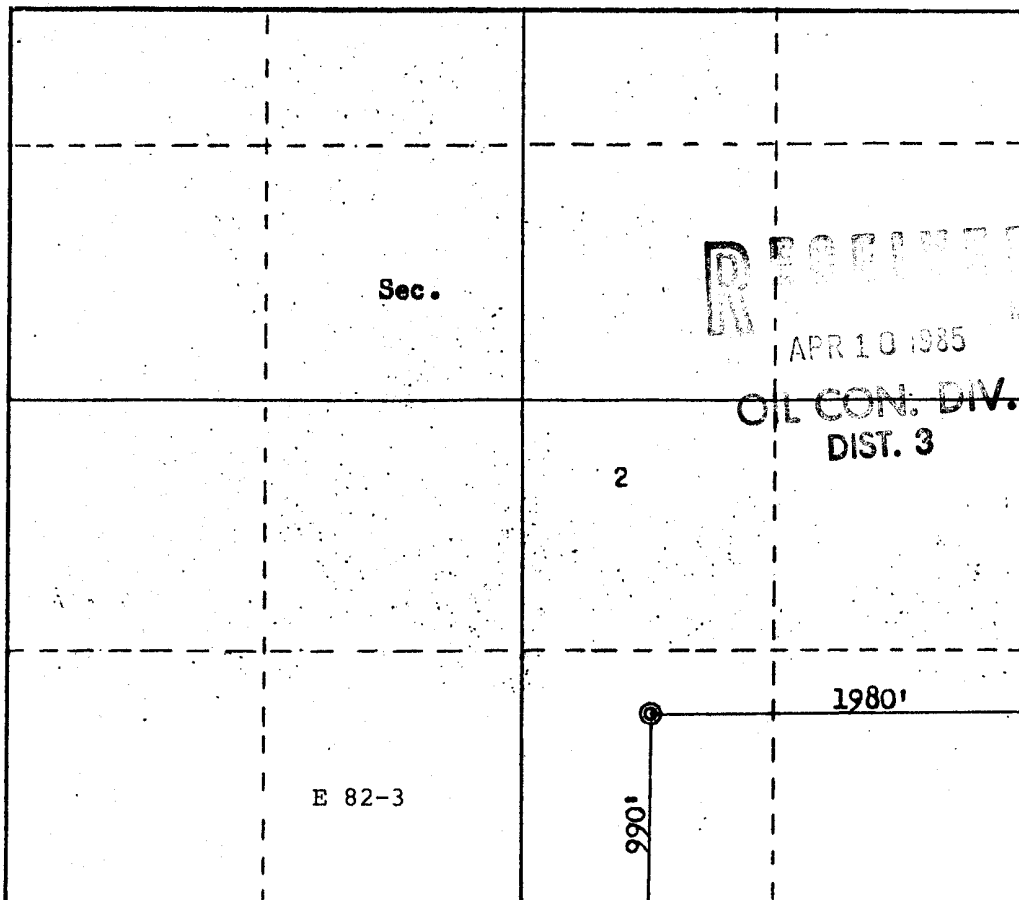

Scale: 1"=1000'

**CERTIFICATION**

*I hereby certify that the information contained herein is true and complete to the best of my knowledge and belief.*

*Steve S. Dunn*  
 Name  
 Steve S. Dunn  
 Position  
 Operations Manager  
 Company  
 Merrion Oil & Gas Corp.

Date  
 4/3/85

*I hereby certify that the well location shown on this plat was plotted from field notes of actual surveys made by me or under my supervision, and that the same is true and correct to the best of my knowledge and belief.*

Date Surveyed  
**April 2, 1985**  
 Registered Professional Engineer and Land Surveyor.  
*Fred B. Kerr Jr.*  
 Fred B. Kerr Jr.  
 Certificate No. **3950**

