

OIL CONSERVATION DIVISION

DISTRICT I
P.O. Box 1980, Hobbs, NM 88240

DISTRICT II
P.O. Drawer DD, Artesia, NM 88210

DISTRICT III
1000 Rio Brazos Rd., Aztec, NM 87410

P.O. Box 2088
Santa Fe, New Mexico 87504-2088

API NO. (assigned by OCD on New Wells)

30-031-20970

5. Indicate Type of Lease

STATE ☒

FEE ☐

6. State Oil & Gas Lease No.

LG 2779

APPLICATION FOR PERMIT TO DRILL, DEEPEN, OR PLUG BACK

1a. Type of Work:

DRILL ☒

RE-ENTER ☐

DEEPEN ☐

PLUG BACK ☐

b. Type of Well:

OIL

GAS

WELL ☒

WELL ☐

OTHER ☐

SINGLE

ZONE ☒

MULTIPLE

ZONE ☐

7. Lease Name or Unit Agreement Name

4009 State

8. Well No.

300

9. Pool name or Wildcat

Chaco Wash Mesa Verde

2. Name of Operator

Enerdyne Corporation

3. Address of Operator

P. O. Box 502, Albuquerque, New Mexico 87103

4. Well Location

Unit Letter

H

: 1430

Feet From The

North

Line and

1040

Feet From The

East

Line

Section

28

Township

20N

Range

9W

NMPM

McKinley

County

10. Proposed Depth

460' GR

11. Formation

Menefee

12. Rotary or C.T.

Rotary

13. Elevations (Show whether DF, RT, GR, etc.)

6418'

14. Kind & Status Plug. Bond

In Process

15. Drilling Contractor

Wayne Smith Drilling

16. Approx. Date Work will start

October 21, 1991

17.

PROPOSED CASING AND CEMENT PROGRAM

Joint w/ 304,305

SIZE OF HOLE

6 1/2"

SIZE OF CASING

4 1/2"

WEIGHT PER FOOT

10.50 lb.

SETTING DEPTH

460' GR

SACKS OF CEMENT

44 sks (52 c.f.)

EST. TOP

GR

Operator proposes to drill a 6 1/2" hole to a depth of 460' GR, using water based drilling mud. The Menefee sandstone will be analyzed by examining drill cuttings and by evaluating resistivity and porosity logs. If our analysis concludes that the Menefee sandstone has potential for producing oil, 4 1/2" casing will be set at total depth and cemented to surface with 44 sks (52 c.f.) class "B" cement.

APPROVAL EXPIRES 5-5-92
UNLESS DRILLING IS COMMENCED.
SPUD NOTICE MUST BE SUBMITTED
WITHIN 10 DAYS.

RECEIVED
OCT 28 1991
OIL CON. DIV.
DIST. 3

IN ABOVE SPACE DESCRIBE PROPOSED PROGRAM: IF PROPOSAL IS TO DEEPEN OR PLUG BACK, GIVE DATA ON PRESENT PRODUCTIVE ZONE AND PROPOSED NEW PRODUCTIVE ZONE. GIVE BLOWOUT PREVENTER PROGRAM, IF ANY.

I hereby certify that the information above is true and complete to the best of my knowledge and belief.

SIGNATURE

Frank Walker

TITLE

Vice President

DATE

10-18-91

TYPE OR PRINT NAME

Frank Walker

291-9502

TELEPHONE NO.

(This space for State Use)

APPROVED BY

35-8

TITLE

SUPERVISOR DISTRICT # 3

DATE

NOV 05 1991

CONDITIONS OF APPROVAL, IF ANY:

Submit to Appropriate
District Office
State Lease - 4 copies
Fee Lease - 3 copies

State of New Mexico
Energy, Minerals and Natural Resources Department

Form C-102
Revised 1-1-89

OIL CONSERVATION DIVISION

DISTRICT I
P.O. Box 1980, Hobbs, NM 88240

P.O. Box 2088

Santa Fe, New Mexico 87504-2088

DISTRICT II
P.O. Drawer DD, Artesia, NM 88210

DISTRICT III
1000 Rio Brazos Rd., Aztec, NM 87410

WELL LOCATION AND ACREAGE DEDICATION PLAT

All Distances must be from the outer boundaries of the section

Operator Enerdyne Corporation			Lease State		Well No. 300
Unit Letter H	Section 28	Township 20 North	Range 9 West	County NMPM	Mc Kinley
Actual Footage Location of Well: 1430 feet from the North line and 1040 feet from the East line					
Ground level Elev. 6418'	Producing Formation Menefee		Pool Chaco Wash Mesa Verde		Dedicated Acreage: 40 joint Acres

1. Outline the acreage dedicated to the subject well by colored pencil or hatchure marks on the plat below.
2. If more than one lease is dedicated to the well, outline each and identify the ownership thereof (both as to working interest and royalty).
3. If more than one lease of different ownership is dedicated to the well, have the interest of all owners been consolidated by communitization, unitization, force-pooling, etc.?
☐ Yes ☐ No If answer is "yes" type of consolidation _____
If answer is "no" list the owners and tract descriptions which have actually been consolidated. (Use reverse side of this form if necessary.)
No allowable will be assigned to the well until all interests have been consolidated (by communitization, unitization, forced-pooling, or otherwise) or until a non-standard unit, eliminating such interest, has been approved by the Division.

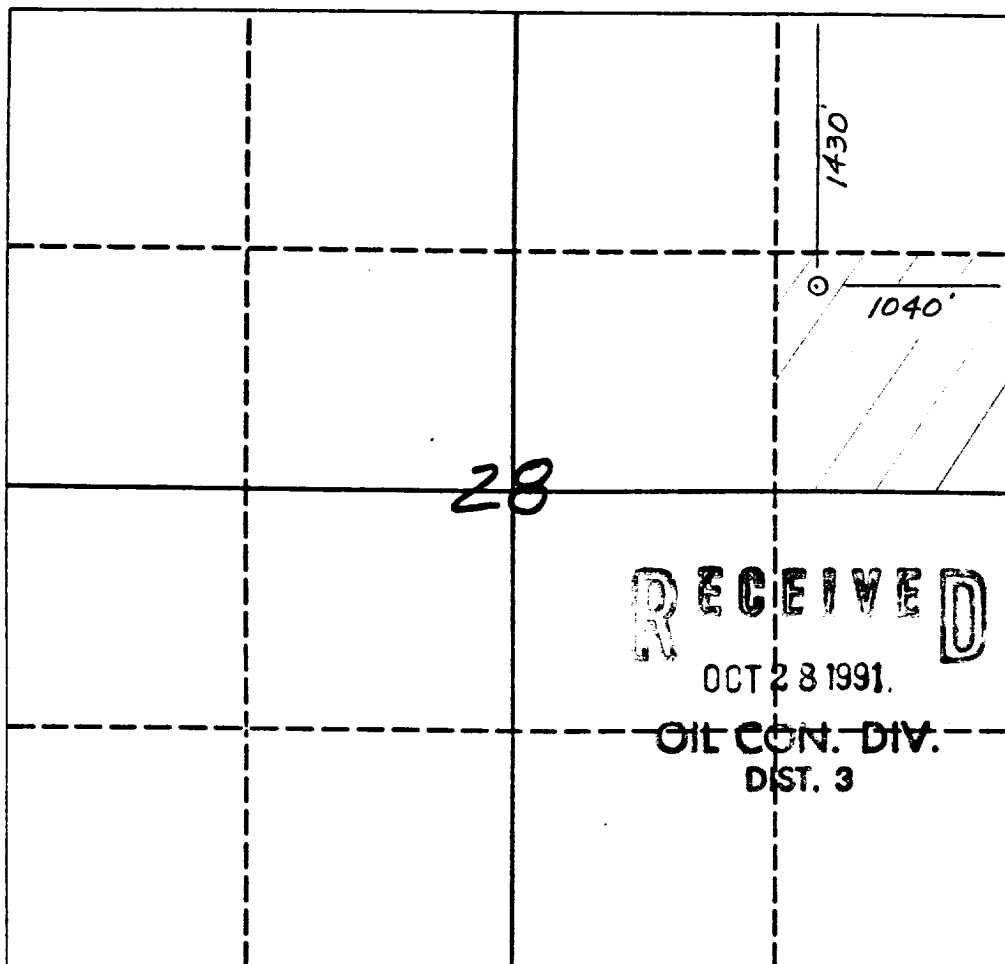

OPERATOR CERTIFICATION

I hereby certify that the information contained herein is true and complete to the best of my knowledge and belief.

Signature
Frank Welker

Printed Name
Frank Welker

Position
Vice President

Company
Enerdyne Corporation

Date
10-21-91

SURVEYOR CERTIFICATION

I hereby certify that the well location shown on this plat was plotted from field notes of actual surveys made by me or under my supervision, and that the same is true and correct to the best of my knowledge and belief.

Date Signed
Neale C. Edwards

Signature & Seal
Professional Surveyor

Certificate No.
6857