

(SUBMIT IN TRIPLICATE)

UNITED STATES
DEPARTMENT OF THE INTERIOR
GEOLOGICAL SURVEY

Land Office **Santa Fe**
Lease No. **SF 080098**
Unit _____

SUNDRY NOTICES AND REPORTS ON WELLS

NOTICE OF INTENTION TO DRILL	<input checked="" type="checkbox"/>	SUBSEQUENT REPORT OF WATER SHUT-OFF	
NOTICE OF INTENTION TO CHANGE PLANS		SUBSEQUENT REPORT OF SHOOTING OR ACIDIZING	
NOTICE OF INTENTION TO TEST WATER SHUT-OFF		SUBSEQUENT REPORT OF ALTERING CASING	
NOTICE OF INTENTION TO RE-DRILL OR REPAIR WELL		SUBSEQUENT REPORT OF RE-DRILLING OR REPAIR	
NOTICE OF INTENTION TO SHOOT OR ACIDIZE		SUBSEQUENT REPORT OF ABANDONMENT	
NOTICE OF INTENTION TO PULL OR ALTER CASING		SUPPLEMENTARY WELL HISTORY	
NOTICE OF INTENTION TO ABANDON WELL			

(INDICATE ABOVE BY CHECK MARK NATURE OF REPORT, NOTICE, OR OTHER DATA)

July 6, _____, 19 **62**

Evans-Federal

Well No. **2** is located **1650** ft. from **XXX** line and **1650** ft. from **E** line of sec. **18**

SE/4 Section 18 **23 North** **1 West** **NMPH**
(1/4 Sec. and Sec. No.) (Twp.) (Range) (Meridian)

Undesignated Pictured Cliffs Rio Arriba **New Mexico**
(Field) (County or Subdivision) (State or Territory)

The elevation of the ~~surface~~ **ground** floor above sea level is **7345** ft.

DETAILS OF WORK

(State names of and expected depths to objective sands; show sizes, weights, and lengths of proposed casings; indicate mudding jobs, cementing points, and all other important proposed work)

Propose to drill the above well to a total depth of approximately 3250' with rotary tools. To set approximately 100' of 8 5/8" casing and cement with 60 sacks. To set approximately 3250' of 4 1/2" casing and cement with 100 sacks.

To sand frac for completion and to test any other zone that appears productive of oil or gas. To comply with all of the rules and regulations of the U.S.G.S. and New Mexico Oil and Gas Commission.

I understand that this plan of work must receive approval in writing by the Geological Survey before operations may be commenced.

Company **Shar-Alan Oil Company**
Address **1402 Denver U. S. National Center**
Denver, Colorado

By **Richard S. Hunt**
Title **Manager of Lands & Explorations**

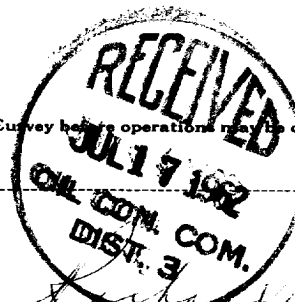

NEW MEXICO OIL CONSERVATION COMMISSION

Well Location and Acreage Dedication Plat

Date _____

Operator Irving Pasternak, dba, Shar Alan Oil Co. Lease _____
 Well No. _____ Unit Letter J Section 18 Township 23 NORTH Range 1 WEST, NMPM
 Located 1650 Feet From the SOUTH Line, 1650 Feet From the EAST Line
 County RIO ARRIBA G. L. Elevation 7540.0 Dedicated Acreage 160 Acres
 Name of Producing Formation Pictured Cliff Pool Undesignated

1. Is the Operator the only owner in the dedicated acreage outlined on the plat below?

Yes X No _____

2. If the answer to question one is "no", have the interests of all the owners been consolidated by communitization agreement or otherwise? Yes _____ No _____. If answer is "yes", Type of Consolidation.

3. If the answer to question two is "no", list all the owners and their respective interests below:

Owner

Land Description

Irving Pasternak, dba, Shar Alan Oil Company

SE $\frac{1}{4}$ Section 18, T 23 N, R 1 W, N.M.P.M.

Section B.

Note: All distances must be from outer boundaries of section.

This is to certify that the information in Section A above is true and complete to the best of my knowledge and belief.

Irving Pasternak, dba,
Shar Alan Oil Company
 (Operator)

Richard S. Hunt, Mgr of Lands &
 (Representative) Exploration
1402 Denver U S National Center
 (Address)

Denver 2, Colorado

Richard S. Hunt
by Summie Gibson

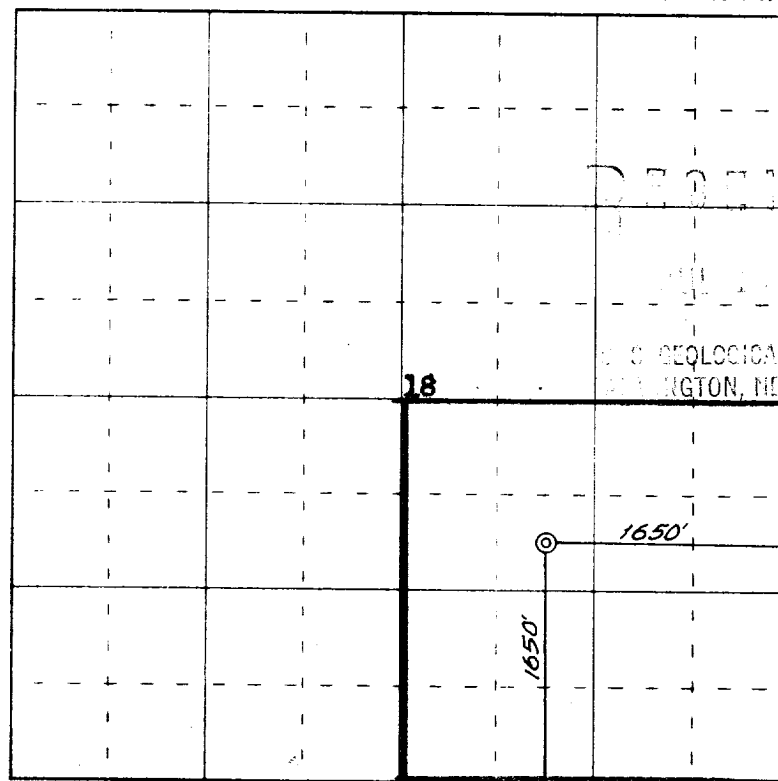

0 330 660 990 1320 1650 1980 2310 2640 2000 1500 1000 500 0

Scale 4 inches equal 1 mile



This is to certify that the above plat was prepared from field notes of actual surveys made by me or under my supervision and that the same are true and correct to the best of my knowledge and belief.

Date Surveyed 7 July 1962

James P. Leese
 Registered Professional Engineer and/or Land Surveyor
James P. Leese N. Mex. Reg. No. 1463

