

NEW MEXICO  
OIL CONSERVATION COMMISSION

Form C-128

Well Location and/or Gas Proration Plat

Date May 15, 1956

Operator HUMBLE OIL & REFINING COMPANY Lease JICARILLA APACHE TRIBE OF INDIANS

Well No. 1 Section 15 Township - 23 - N Range - 5 - W 'NMPM

Located 990 Feet From NORTH Line, 1140 Feet From WEST Line,

RIO ARRIBA County, New Mexico. G. L. Elevation \_\_\_\_\_

Name of Producing Formation PICTURED CLIFF Pool OTERO DAKOTA Dedicated Acreage 160

(Note: All distances must be from outer boundaries of Section)

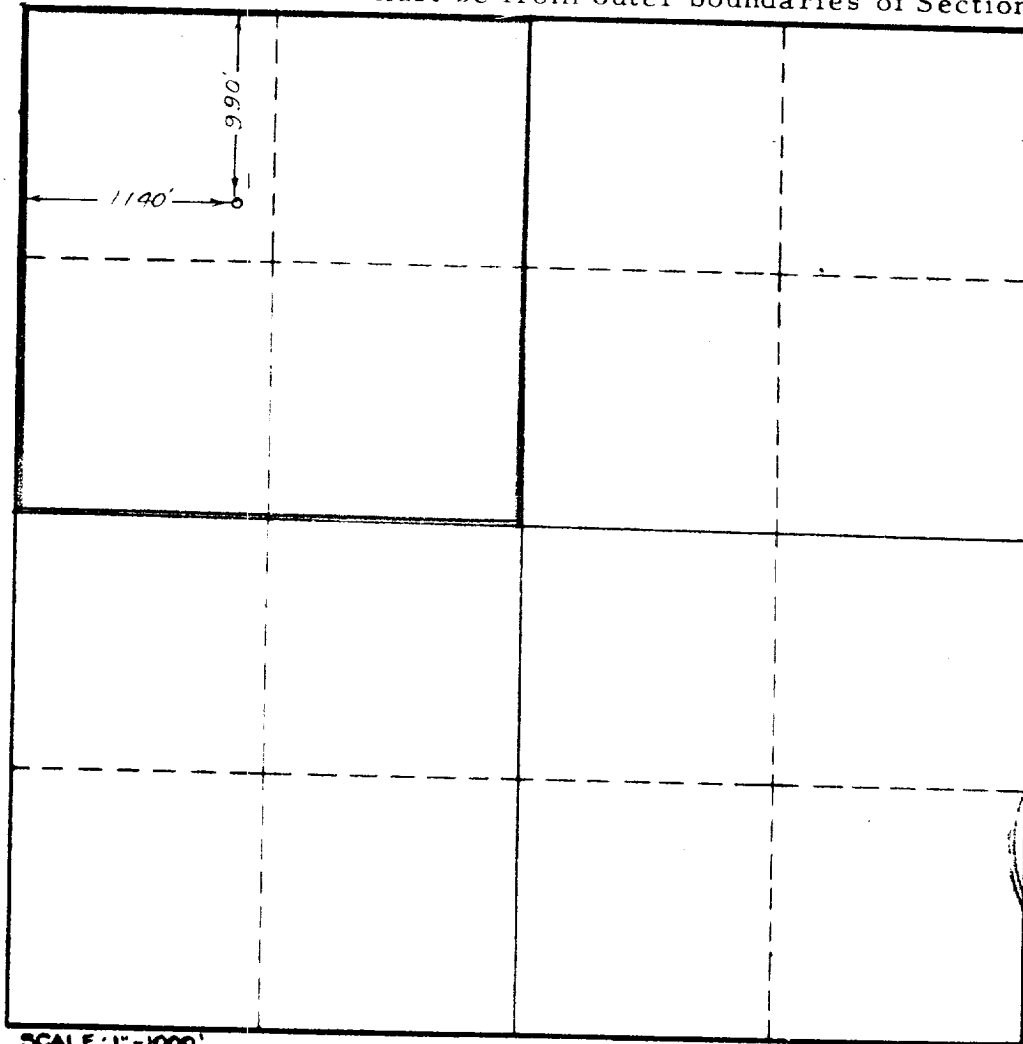

SCALE: 1" = 1000'

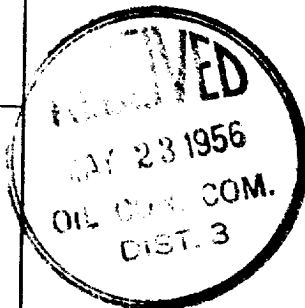

1. Is this Well a Dual Comp. ? Yes No \_\_\_\_\_.
2. If the answer to Question 1 is yes, are there any other dually completed wells within the dedicated acreage ? Yes No \_\_\_\_\_.

This is to certify that the above plat was prepared from field notes of actual surveys made by me or under my supervision and that the same are true and correct to the best of my knowledge and belief.

Name E. T. Shaker  
Position ASSISTANT DIVISION SUPERINTENDENT  
Representing HUMBLE OIL & REFINING COMPANY  
Address BOX 1600 Midland, Texas

Date Surveyed 6-10-54  
E. T. Shaker  
Registered Professional Engineer and/or  
Land Surveyor  
Lease No. 166396  
Contract No. 78

# OIL CONSERVATION COMMISSION

## ATTEC DISTRICT OFFICE

No. Copies Received

5

### DISTRIBUTION

Mr. Tolson	
Mr. E. A. Tamm	2
Mr. Clegg	1
Mr. Glavin	
Mr. Ladd	
Mr. Nichols	
Mr. Rosen	1
Mr. Tracy	
Mr. Carson	1
Mr. Egan	
Mr. Gurnea	
Mr. Hendon	
Mr. Pennington	
Mr. Quinn	
Mr. Nease	
Mr. Gandy	
Mr. Harbo	
Mr. Mohr	
Mr. Winterrowd	
Tele. Room	
Mr. Holloman	
Miss Gandy	