

(SUBMIT IN TRIPLICATE)

Indian Agency San Carlos

Contract No. 77

UNITED STATES
DEPARTMENT OF THE INTERIOR
GEOLOGICAL SURVEY

Allottee _____

Lease No. 166396

			X

See Attached Plans

SUNDRY NOTICES AND REPORTS ON WELLS

NOTICE OF INTENTION TO DRILL	X	SUBSEQUENT REPORT OF WATER SHUT-OFF	
NOTICE OF INTENTION TO CHANGE PLANS		SUBSEQUENT REPORT OF SHOOTING OR ACIDIZING	
NOTICE OF INTENTION TO TEST WATER SHUT-OFF		SUBSEQUENT REPORT OF ALTERING CASING	
NOTICE OF INTENTION TO REDRILL OR REPAIR WELL		SUBSEQUENT REPORT OF REDRILLING OR REPAIR	
NOTICE OF INTENTION TO SHOOT OR ACIDIZE		SUBSEQUENT REPORT OF ABANDONMENT	
NOTICE OF INTENTION TO PULL OR ALTER CASING		SUPPLEMENTARY WELL HISTORY	
NOTICE OF INTENTION TO ABANDON WELL			

(INDICATE ABOVE BY CHECK MARK NATURE OF REPORT, NOTICE, OR OTHER DATA)

**San Carlos Apache
Reservation**

April 22, 19 57

Well No. 4 is located 890 ft. from N line and 890 ft. from E line of sec. 16

NE 1/4 Sec. 16
(1/4 Sec. and Sec. No.)

15-N
(Twp.)

5-4
(Range)

-
(Meridian)

Over Pictured Cliffs (EXT) Rio Arriba
(Field) (County or Subdivision)

New Mexico
(State or Territory)

The elevation of the derrick floor above sea level is later ft.

DETAILS OF WORK

(State names of and expected depths to objective sands; show sizes, weights, and lengths of proposed casings; indicate mudding jobs, cementing points, and all other important proposed work)

CASING PROGRAM

Size	Weight	Depth
5 1/8"	22	150'
5 1/2"	14	2350'

CEMENTING RECORD

Circulate to surface
Circulate to 5 5/8" casing.

CORING PROGRAM

NONE

Proposed Total Depth - 2350' to test Pictured Cliffs
Oil-water emulsion drilling fluid
Halliburton method of cementing.



I understand that this plan of work must receive approval in writing by the Geological Survey before operations may be commenced.

Company Humble Oil & Refining Company

Address Box 1600

Midland, Texas

By

Title Mr. Chief Clerk

NEW MEXICO
OIL CONSERVATION COMMISSION

Form C-128

Well Location and/or Gas Proration Plat

Date 4 - 20 - 57

Operator HUMBLE OIL & REFINING CO.

Lease JICARILLA APACHE TRIBE OF INDIANS

Well No. 4 Section 16 Township 23-N Range 5-W NMPM

Located 890 Feet From NORTH Line, 990 Feet From EAST Line,

RIO ARRIBA

County, New Mexico. G. L. Elevation

Name of Producing Formation PICTURED CLIFFS Pool OTERO CLIFFS Dedicated Acreage 160

(Note: All distances must be from outer boundaries of Section)

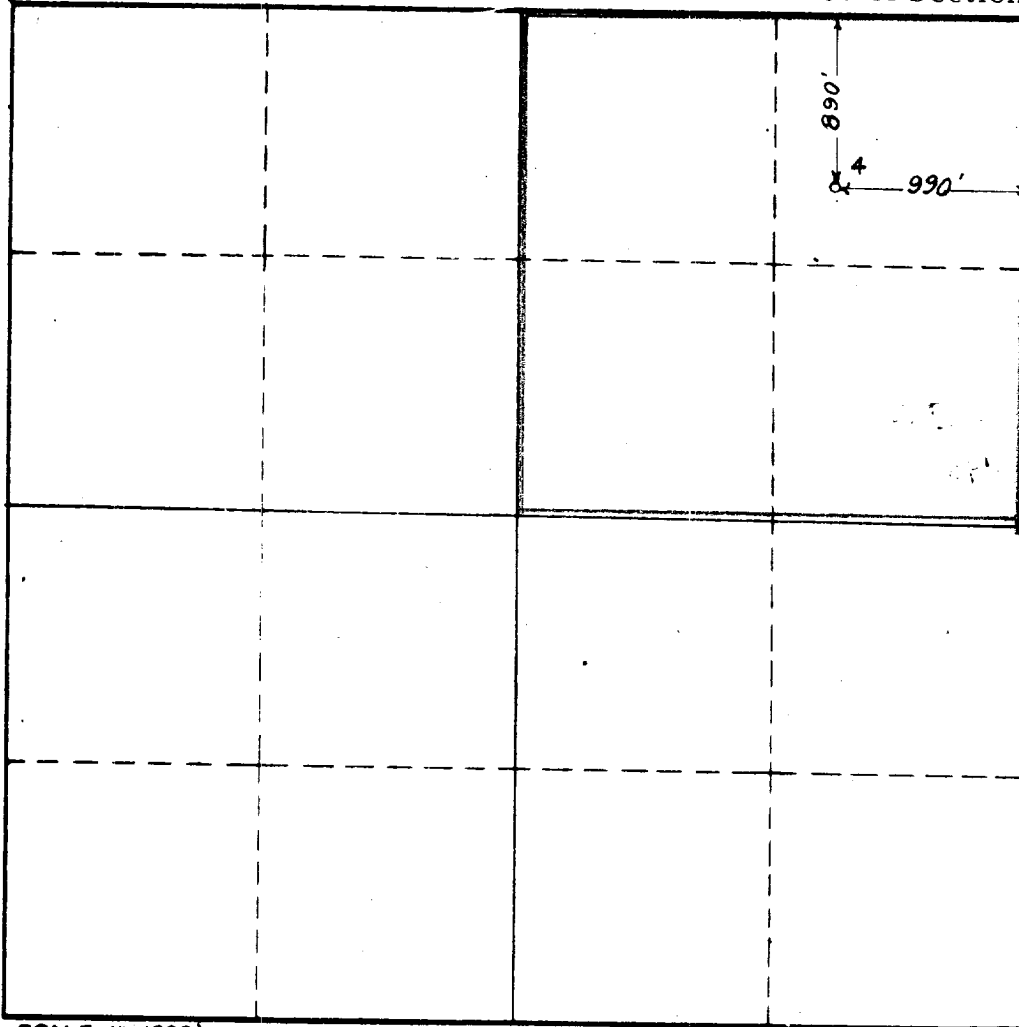

SCALE: 1" = 1000'



1. Is this Well a Dual Comp. ? Yes No
2. If the answer to Question 1 is yes, are there any other dually completed wells within the dedicated acreage? Yes No

This is to certify that the above plat was prepared from field notes of actual surveys made by me or under my supervision and that the same are true and correct to the best of my knowledge and belief.

Name E. T. Shahan
Position ASSISTANT DIVISION SUPERINTENDENT
Representing HUMBLE OIL & REFINING CO.
Address BOX 1600 MIDLAND, TEXAS

Date Surveyed 4 - 20 - 57

E. T. Shahan
Registered Professional Engineer and/or
Land Surveyor

LEASE NO 166396
CONTRACT NO. 78

W-A-2309