

(SUBMIT IN TRIPLICATE)

UNITED STATES
DEPARTMENT OF THE INTERIOR
GEOLOGICAL SURVEY

Budget Bureau No. 42-R358.4.
Approval expires 12-31-60.

Land Office Santa Fe
Lease No. SF 080515-A
Unit _____

SUNDRY NOTICES AND REPORTS ON WELLS

NOTICE OF INTENTION TO DRILL	<input checked="" type="checkbox"/>	SUBSEQUENT REPORT OF WATER SHUT-OFF	
NOTICE OF INTENTION TO CHANGE PLANS		SUBSEQUENT REPORT OF SHOOTING OR ACIDIZING	
NOTICE OF INTENTION TO TEST WATER SHUT-OFF		SUBSEQUENT REPORT OF ALTERING CASING	
NOTICE OF INTENTION TO RE-DRILL OR REPAIR WELL		SUBSEQUENT REPORT OF RE-DRILLING OR REPAIR	
NOTICE OF INTENTION TO SHOOT OR ACIDIZE		SUBSEQUENT REPORT OF ABANDONMENT	
NOTICE OF INTENTION TO PULL OR ALTER CASING		SUPPLEMENTARY WELL HISTORY	
NOTICE OF INTENTION TO ABANDON WELL			

(INDICATE ABOVE BY CHECK MARK NATURE OF REPORT, NOTICE, OR OTHER DATA)

February 11, _____, 19 62

Hall-Federal

Well No. 2 is located 790 ft. from N line and 1850 ft. from E line of sec. 7

NE/4 7 23 North 1 West N.M.P.M.
(1/4 Sec. and Sec. No.) (Twp.) (Range) (Meridian)

South Blanco Pictured Cliffs Rio Arriba
(Field) (County or Subdivision)

New Mexico
(State or Territory)

The elevation of the ground floor above sea level is 7568 ft.

DETAILS OF WORK

(State names of and expected depths to objective sands; show sizes, weights, and lengths of proposed casings; indicate mudding jobs, cementing points, and all other important proposed work)

To set approx. 100 feet of 8 5/8 inch surface casing and cement with approx. 50 sacks. To drill with rotary tools to an approx. total depth of 3400 feet. To run an electric log and if productive, to set approx. 3400 feet of 4 1/2 inch new casing and cement with approx. 100/sacks. To perforate the Pictured Cliffs pay zone and sand-water frac same. To run approx. 3350 feet of 1 1/4 inch Eut tubing and to complete and produce as a Pictured Cliffs gas producer. To comply with the rules and regulations of the U.S.G.S. and New Mexico Oil and Gas Commission.

I understand that this plan of work must receive approval in writing by the Geological Survey before operations may be commenced.

Company SHAR-ALAN OIL COMPANY

Address 1402 Denver U. S. National Center
Denver, Colorado

By Richard S. Hunt

Title Manager of Lands & Explorations

NEW MEXICO OIL CONSERVATION COMMISSION

Well Location and Acreage Dedication Plat

Section A.

Date 19 January 1962# 2 Hall FederalOperator Irving Pasternak, DBA Shar-Alan Oil Co. Lease SF 080 515 AWell No. # 2 Unit Letter A Section 7 Township 23 N Range 1 West NMPMLocated 790 Feet From North Line 1850 Feet From East LineCounty Rio Arriba G. L. Elevation 7568 ungraded Dedicated Acreage 160 AcresName of Producing Formation Picture Cliff Pool undesignated

1. Is the Operator the only owner in the dedicated acreage outlined on the plat below?

Yes X No

2. If the answer to question one is "no", have the interests of all the owners been consolidated by communitization agreement or otherwise? Yes No If answer is "yes", Type of Consolidation.

3. If the answer to question two is "no", list all the owners and their respective interests below:

Owner

Land Description

Irving Pasternak, DBA Shar-Alan Oil CompanyNE 1/4 Section 7, T23N, RLW, N.M.P.M.

RECEIVED

FEB 15 1962

OIL CON. COM.

Section B.

Note: All distances must be from outer boundaries of section.

This is to certify that the information in Section A above is true and complete to the best of my knowledge and belief.

Irving Pasternak, DBA Shar-Alan Oil Co.

Richard S. Hunt, Manager of Lands
(Representative) & Exploration
P. O. Box 1428 Durango, Colo.
(Address)

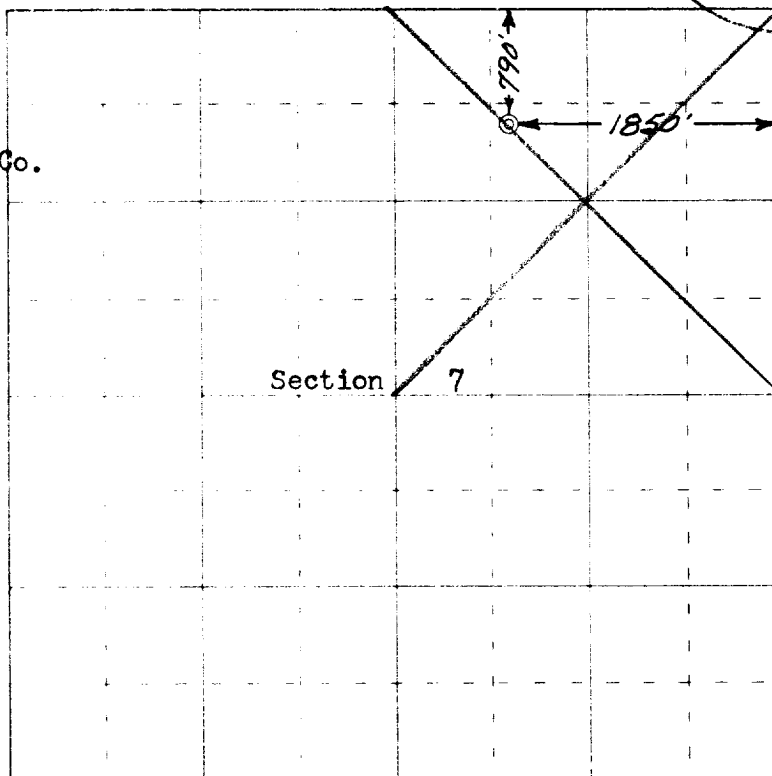

0 330 660 990 1320 1650 1980 2310 2640 2000 1500 1000 500 0

Scale 4 inches equal 1 mile

This is to certify that the above plat was prepared from field notes of actual surveys made by me or under my supervision and that the same are true and correct to the best of my knowledge and belief.

(Seal)

Date Surveyed 18 January 1962

Robert H. Ernst
Robert H. Ernst, PE & LS 2463
Registered Professional Engineer and/or Land Surveyor
San Juan Engineering Co.

Farmington, New Mexico