

NEW MEXICO OIL CONSERVATION COMMISSION
Well Location and Acreage Dedication Plat

Section A.

Date July 20, 1962

Operator Southern Union Production Co. Lease Dunn
Well No. 1 Unit Letter P Section 9 Township 23N Range 7W NMPM
Located 790 Feet From South Line, 790 Feet From East Line
County Hio Arriba G. L. Elevation 7240 Dedicated Acreage 80 Acres
Name of Producing Formation Gallup Pool Lybrook Gallup

1. Is the Operator the only owner* in the dedicated acreage outlined on the plat below?
Yes X No _____.
2. If the answer to question one is "no," have the interests of all the owners been consolidated by communitization agreement or otherwise? Yes _____ No _____. If answer is "yes," Type of Consolidation _____
3. If the answer to question two is "no," list all the owners and their respective interests below:

Owner

Land Description

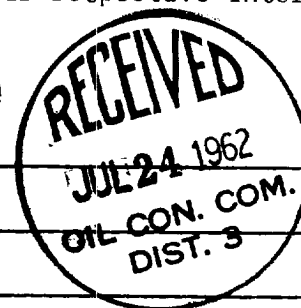

Section B

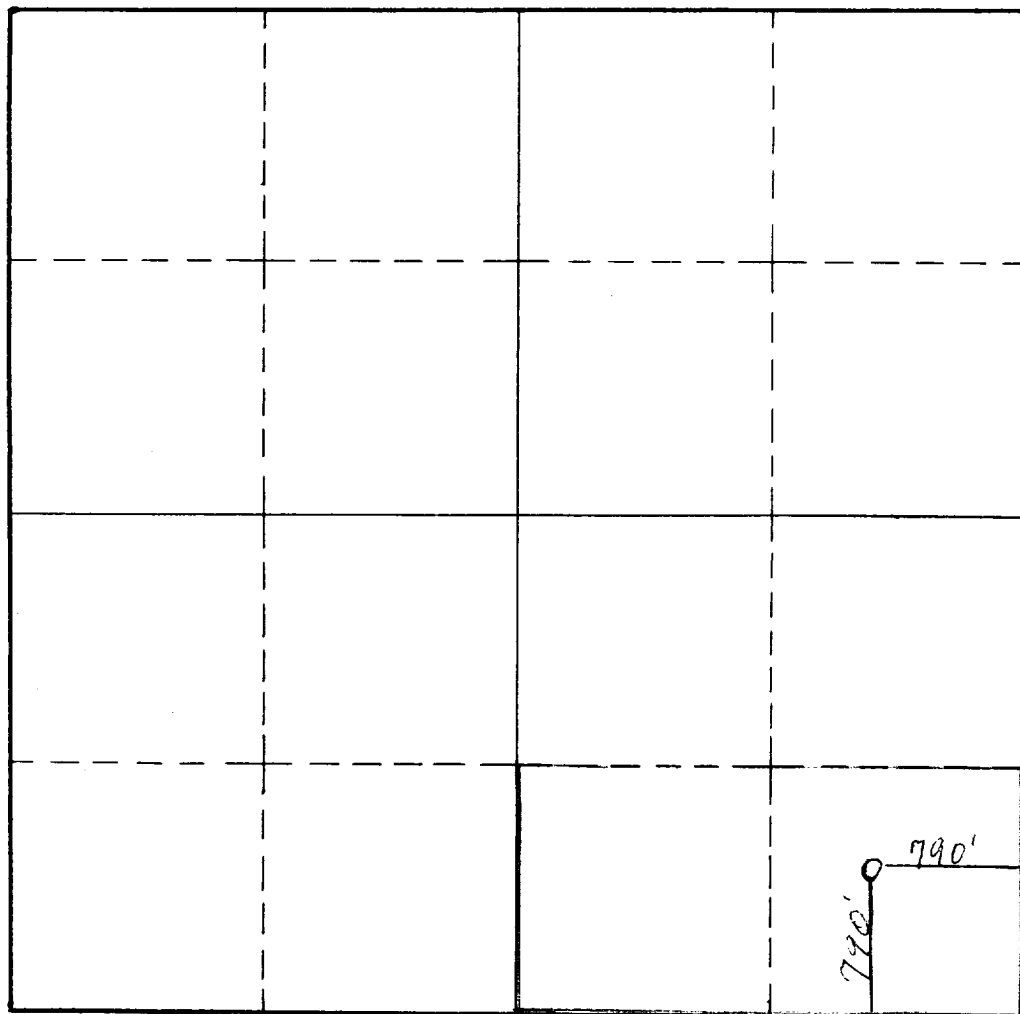

This is to certify that the information in Section A above is true and complete to the best of my knowledge and belief.

Southern Union Production Co.

(Operator)
L. S. Muennink
(Representative)

Box 808, Farmington, N. M.
Address

This is to certify that the well location shown on the plat in Section B was plotted from field notes of actual surveys made by me or under my supervision and that the same is true and correct to the best of my knowledge and belief.

Date Surveyed 11/15/56

James P. Lease
Registered Professional
Engineer and/or Land Surveyor.

0 330 660 990 1320 1650 1980 2310 2640 2000 1500 1000 500 0

(See instructions for completing this form on the reverse side)

Certificate No. N.M. 1463

INSTRUCTIONS FOR COMPLETION:

1. Operator shall furnish and certify to the information called for in Section A.
2. Operator shall outline the dedicated acreage for both oil and gas wells on the plat in Section B.
3. A registered professional engineer or land surveyor registered in the State of New Mexico or approved by the Commission shall show on the plat the location of the well and certify this information in the space provided.
4. All distances shown on the plat must be from the outer boundaries of Section.
5. If additional space is needed for listing owners and their respective interests as required in question 3, Section A, please use space below

* "Owner" means the person who has the right to drill into and to produce from any pool and to appropriate the production either for himself or for himself and another. (65-3-29 (e) NMSA 1953 Comp.)