

NEW MEXICO OIL CONSERVATION COMMISSION

Well Location and Acreage Dedication Plat

Section A.

Date March 26, 1958

United States Smelting Refining

Operator and Mining Company

Lease Jicarilla Tribal #71 Tract #136

Well No. 1-3 Unit Letter P Section 3 Township 23 North Range 4 West NMPM

Located 1070 Feet From South Line, 1100 Feet From East Line

County Rio Arriba G. L. Elevation 7249 Dedicated Acreage 160 Acres

Name of Producing Formation Pictured Cliffs Pool Undesignated

1. Is the Operator the only owner* in the dedicated acreage outlined on the plat below?
Yes X No .
2. If the answer to question one is "no," have the interests of all the owners been consolidated by communitization agreement or otherwise? Yes No . If answer is "yes,"
Type of Consolidation
3. If the answer to question two is "no," list all the owners and their respective interests below:

Owner

Land Description

Section. B

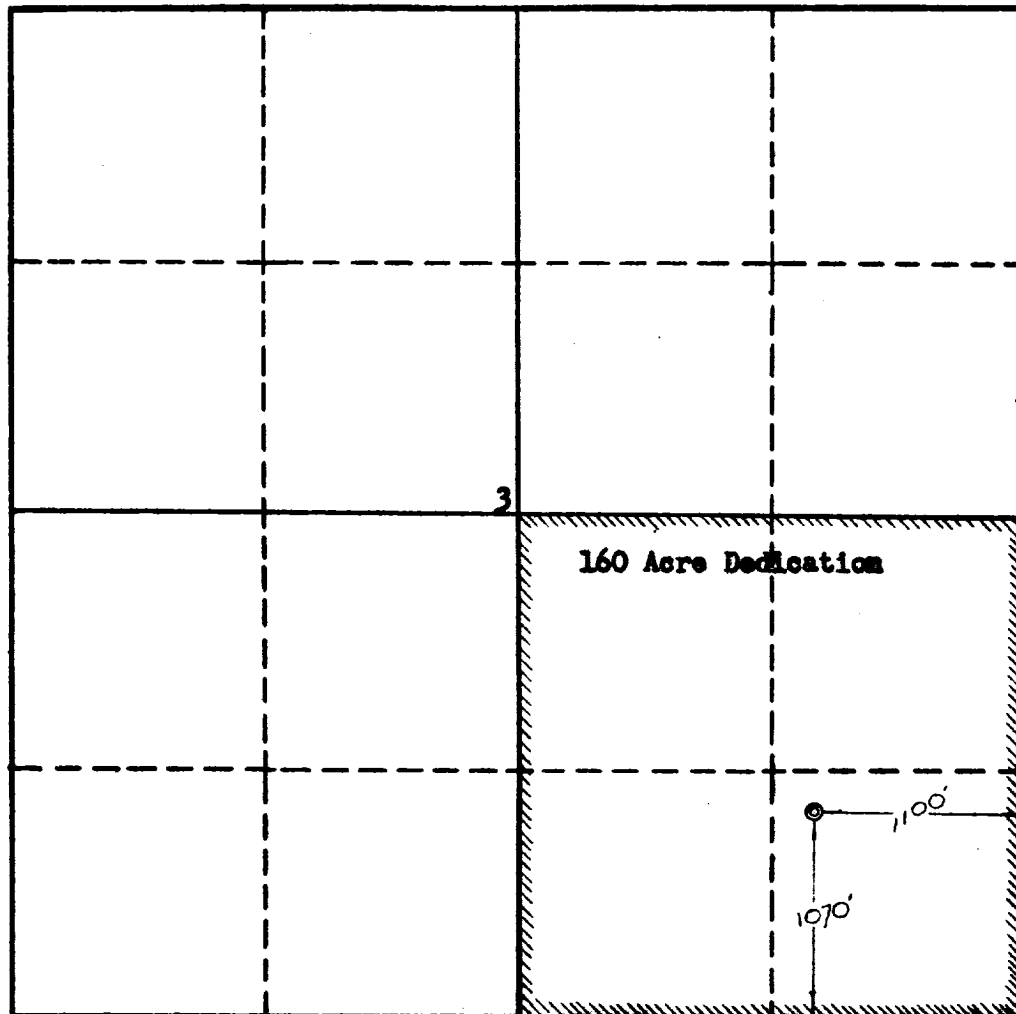

This is to certify that the information in Section A above is true and complete to the best of my knowledge and belief.

United States Smelting Refining & Mining Company
(Operator)

Manager - Denver Oil Operations, 900 Patterson Building
Address

Denver 2, Colorado

This is to certify that the well location shown on the plat is the same as that plotted from field notes of actual survey made by me or under my supervision and that the same is true and correct to the best of my knowledge and belief.

Date Surveyed October 10, 1955

Ernest V. Echhawk
Registered Land Surveyor.

Certificate No. 1545

