

(SUBMIT IN TRIPLICATE)

UNITED STATES
DEPARTMENT OF THE INTERIOR
GEOLOGICAL SURVEY

Land Office **Santa Fe**
Lease No. **SF 080345**
Unit _____

SUNDRY NOTICES AND REPORTS ON WELLS

| | | | |
|---|-------------------------------------|---|--|
| NOTICE OF INTENTION TO DRILL..... | <input checked="" type="checkbox"/> | SUBSEQUENT REPORT OF WATER SHUT-OFF..... | |
| NOTICE OF INTENTION TO CHANGE PLANS..... | | SUBSEQUENT REPORT OF SHOOTING OR ACIDIZING..... | |
| NOTICE OF INTENTION TO TEST WATER SHUT-OFF..... | | SUBSEQUENT REPORT OF ALTERING CASING..... | |
| NOTICE OF INTENTION TO RE-DRILL OR REPAIR WELL..... | | SUBSEQUENT REPORT OF RE-DRILLING OR REPAIR..... | |
| NOTICE OF INTENTION TO SHOOT OR ACIDIZE..... | | SUBSEQUENT REPORT OF ABANDONMENT..... | |
| NOTICE OF INTENTION TO PULL OR ALTER CASING..... | | SUPPLEMENTARY WELL HISTORY..... | |
| NOTICE OF INTENTION TO ABANDON WELL..... | | | |

(INDICATE ABOVE BY CHECK MARK NATURE OF REPORT, NOTICE, OR OTHER DATA)

October 17, 1961

Well No. **1** is located **1650** ft. from **{N}** line and **1650** ft. from **{E}** line of sec. **5**

SE/4 **5** **23 North** **1 West** **RMPM**
(1/4 Sec. and Sec. No.) (Twp.) (Range) (Meridian)
Undesignated **Rio Arriba** **New Mexico**
(Field) (County or Subdivision) (State or Territory)

The elevation of the ~~ground~~ floor above sea level is **7415** ft.

DETAILS OF WORK

(State names of and expected depths to objective sands; show sizes, weights, and lengths of proposed casings; indicate mudlogging jobs, cementing points, and all other important proposed work)

To set approximately 100' of 8 5/8" surface casing and cement with approx. 75 sacks. To drill with rotary tools to an approx. depth of 3400'. If production encountered, to set 4 1/2" casing to TD, to perforate and sandfrac the Pictured Cliffs formation, to run 1" EUE Tubing to approx. 3100' and complete as a Pictured Cliffs gas producer. To comply with all rules and regulations of the U.S.G.S. and New Mexico Oil and Gas Conservation Commission.

I understand that this plan of work must receive approval in writing by the Geological Survey before operations may be commenced.

Company **SHAR-ALAN OIL COMPANY**
Address **1402 Denver U.S. National Center**
Denver, Colorado

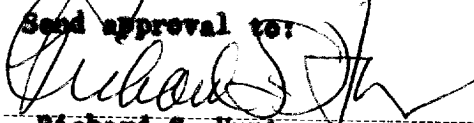
Send approval to:
By 
Richard S. Hunt
Title **Mgr., Lands and Exploration**
Box 1428, Durango, Colorado

NEW MEXICO OIL CONSERVATION COMMISSION

Well Location and Acreage Dedication Plot

SECTION A.

Date October 16, 1961

Operator Shaw-Alan Oil Company Lease Beachside-Browning 87 000345
 Well No. 1 Unit Letter _____ Section 5 Township 23 North Range 1 West MPM
 Located 1650 Feet From South Line, 1650 Feet From East Line
 County Elizabethe G. L. Elevation 7415 Dedicated Acreage 2 1/4 - 160 Acres
 Name of Predating Formation Placered Cliffs Pool Undesignated

1. Is the Operator the only owner* in the dedicated acreage outlined on the plot below? Yes X No _____
2. If the answer to question One is "No," have the interests of all the owners been consolidated by communitization agreement or otherwise? Yes _____ No _____ If answer is "Yes," Type of Consolidation _____
3. If the answer to question Two is "No," list all the owners and their respective interests below:

OWNER

LAND DESCRIPTION



SECTION B.

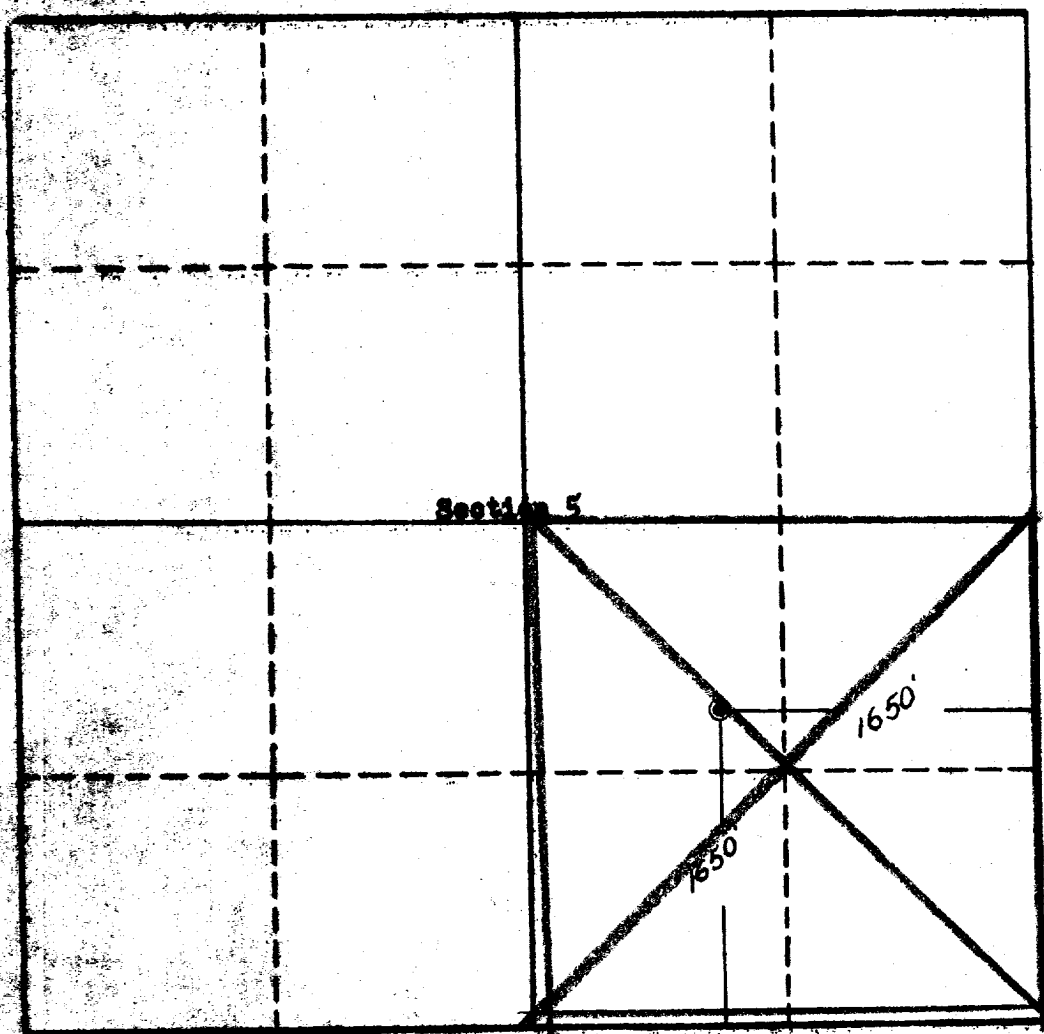

This is to certify that the information in Section A above is true and complete to the best of my knowledge and belief.

SHAW-ALAN OIL COMPANY

(OPERATOR)

By:

(REPRESENTATIVE)

Richard A. Hunt
 Mgr., Lands and Exploration
 Box 1420, Durango, Colorado

(ADDRESS)

This is to certify that the information shown on the plot above was plotted from actual surveys made by my supervisor and is true and correct to the best of my knowledge and belief.

Date Surveyed Oct. 11, 1961

Four States Engineering Co.
 FARMINGTON, NEW MEXICO

REGISTERED ENGINEER OR
 LAND SURVEYOR

Certificate No. 3084