

(SUBMIT IN TRIPLICATE)

UNITED STATES
DEPARTMENT OF THE INTERIOR
GEOLOGICAL SURVEY

Land Office Santa Fe
Lease No. SF 080515
Unit _____

SUNDRY NOTICES AND REPORTS ON WELLS

NOTICE OF INTENTION TO DRILL.....	<input checked="" type="checkbox"/>	SUBSEQUENT REPORT OF WATER SHUT-OFF.....	
NOTICE OF INTENTION TO CHANGE PLANS.....		SUBSEQUENT REPORT OF SHOOTING OR ACIDIZING.....	
NOTICE OF INTENTION TO TEST WATER SHUT-OFF.....		SUBSEQUENT REPORT OF ALTERING CASING.....	
NOTICE OF INTENTION TO RE-DRILL OR REPAIR WELL.....		SUBSEQUENT REPORT OF RE-DRILLING OR REPAIR.....	
NOTICE OF INTENTION TO SHOOT OR ACIDIZE.....		SUBSEQUENT REPORT OF ABANDONMENT.....	
NOTICE OF INTENTION TO PULL OR ALTER CASING.....		SUPPLEMENTARY WELL HISTORY.....	
NOTICE OF INTENTION TO ABANDON WELL.....			

(INDICATE ABOVE BY CHECK MARK NATURE OF REPORT, NOTICE, OR OTHER DATA)

October 10, 19.61
Elliott-Federal
Well No. 1 is located 1650 ft. from N line and 1650 ft. from W line of sec. 6
SW/4 6 23 North 1 West NMPM
(1/4 Sec. and Sec. No.) (Twp.) (Range) (Meridian)
Undesignated Rio Arriba New Mexico
(Field) (County or Subdivision) (State or Territory)

The elevation of the derrick floor above sea level is _____ ft.

DETAILS OF WORK

(State names of and expected depths to objective sands; show sizes, weights, and lengths of proposed casings; indicate mudlogging jobs, cementing points, and all other important proposed work)

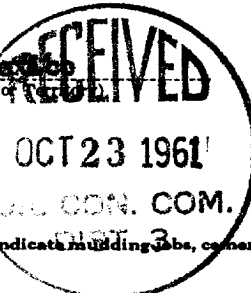

To set approx. 100 feet of 8 5/8 inch surface casing and cement with approx. 50 sacks. To drill with rotary tools to an approx. total depth of 3400 feet. To run an electric log and if productive to set approx. 3400 feet of 4 1/2 inch new casing and cement with approx. 100 sacks. To perforate the Pictured Cliffs pay zone and sand-water frac same. To run approx. 3350 feet of 1 1/4 inch EUE tubing and to complete and produce as a Pictured Cliffs gas producer. To comply with the rules and regulations of the U.S.G.S. and New Mexico Oil and Gas Commission.

I understand that this plan of work must receive approval in writing by the Geological Survey before operations may be commenced.

Company SHAR-ALAN OIL COMPANY
Address 1402 Denver U.S. National Center
Denver 2, Colorado

Send approval to:
By Richard S. Hunt
Title Manager of Lands and Exploration
Box 1428, Durango, Colorado
GPO 862040

NEW MEXICO OIL CONSERVATION COMMISSION
Well Location and Acreage Dedication Plat

SECTION A.

Operator Shaw-Alan Oil Company Lease Elliott-Federal Date October 10, 1961
 Well No. 1 Unit Letter _____ Section 6 Township 23 North Range 1 West NMPM
 Located 1650 Feet From South Line, 1650 Feet From West Line
 County Rio Arriba G. L. Elevation 7636 Dedicated Acreage SW/4 - 160 Acres
 Name of Producing Formation Pictured Cliffs Pool Undesignated

1. Is the Operator the only owner* in the dedicated acreage outlined on the plat below? Yes 1 No _____
2. If the answer to question One is "No," have the interests of all the owners been consolidated by communitization agreement or otherwise? Yes _____ No _____ If answer is "Yes," Type of Consolidation _____
3. If the answer to question Two is "No," list all the owners and their respective interests below:

OWNER

LAND DESCRIPTION

SECTION B.

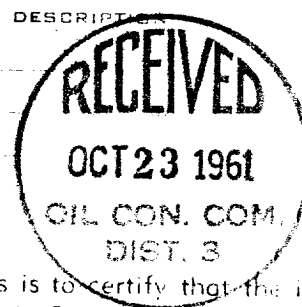
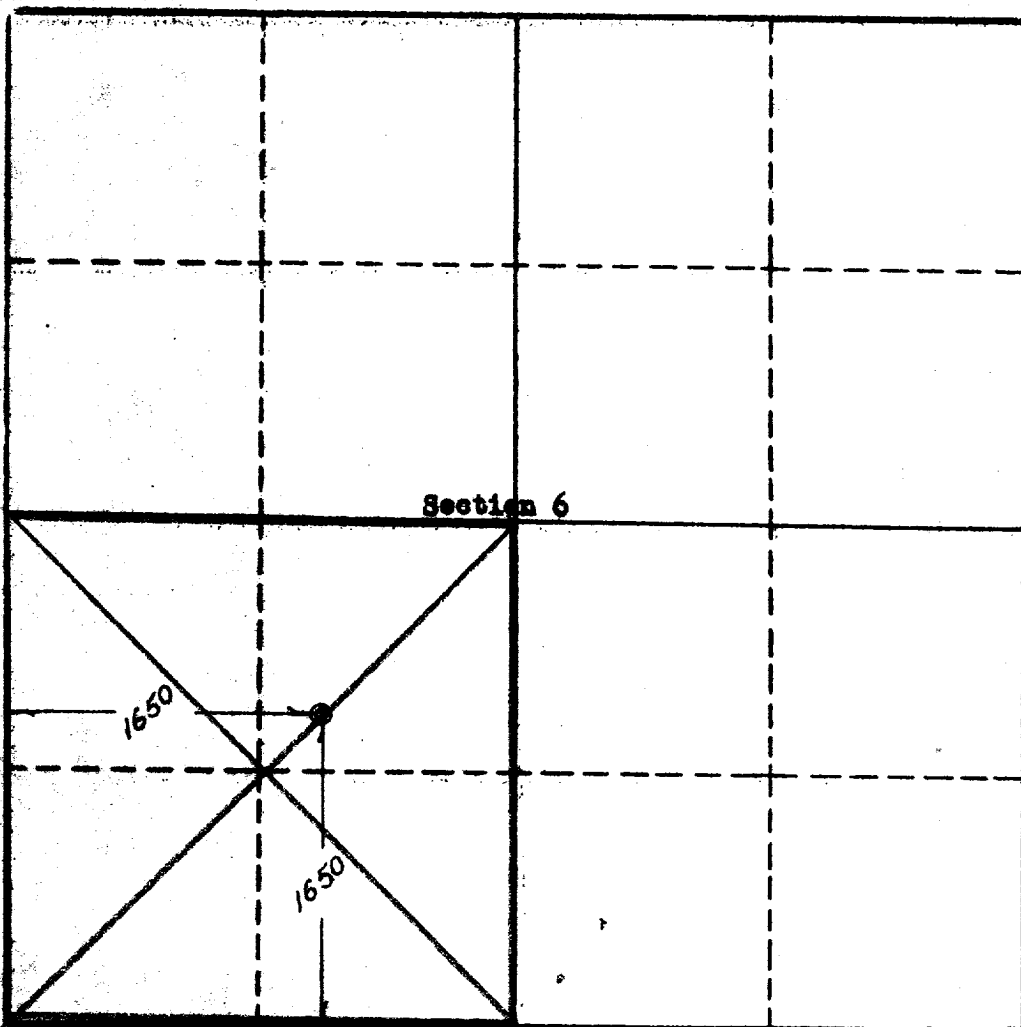

This is to certify that the information in Section A above is true and complete to the best of my knowledge and belief.

SHAW-ALAN OIL COMPANY

(OPERATOR)

By:

(REPRESENTATIVE)

Richard S. Hunt
 Mgr., Lands and Exploration
 Box 1428, Durango, Colorado

This is to certify that the information shown on the plat in Section B was plotted from field notes and actual surveys made by me or my supervising engineer and is true and correct to the best of my knowledge and belief.

Date Surveyed: Oct. 10, 1961

Four States Engineering Co.
 FARMINGTON, NEW MEXICO

E. L. Potat
 REGISTERED ENGINEER OR
 LAND SURVEYOR

Certificate No. 3084