

(SUBMIT IN TRIPLICATE)

UNITED STATES
DEPARTMENT OF THE INTERIOR
GEOLOGICAL SURVEY

Indian Agency _____
Allottee Jicarilla - A
Lease No. Cort. #159

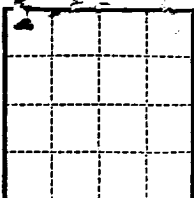

SUNDRY NOTICES AND REPORTS ON WELLS

NOTICE OF INTENTION TO DRILL	<input checked="" type="checkbox"/>	SUBSEQUENT REPORT OF WATER SHUT-OFF	RECEIVED SEP 2 1960 U. S. GEOLOGICAL SURVEY FARMINGTON, NEW MEXICO
NOTICE OF INTENTION TO CHANGE PLANS		SUBSEQUENT REPORT OF SHOOTING OR ACIDIZING	
NOTICE OF INTENTION TO TEST WATER SHUT-OFF		SUBSEQUENT REPORT OF ALTERING CASING	
NOTICE OF INTENTION TO REDRILL OR REPAIR WELL		SUBSEQUENT REPORT OF REDRILLING OR REPAIR	
NOTICE OF INTENTION TO SHOOT OR ACIDIZE		SUBSEQUENT REPORT OF ABANDONMENT	
NOTICE OF INTENTION TO PULL OR ALTER CASING		SUPPLEMENTARY WELL HISTORY	
NOTICE OF INTENTION TO ABANDON WELL			

(INDICATE ABOVE BY CHECK MARK NATURE OF REPORT, NOTICE, OR OTHER DATA)

August 10, 1960

Well No. 14-6 is located 790 ft. from N line and 790 ft. from E line of sec. 6
NW/4, Sec. 6 23N 2W NMPM
(1/4 Sec. and Sec. No.) (Twp.) (Range) (Meridian)
Unnamed Rio Arriba New Mexico
(Field) (County or Subdivision) (State or Territory)

The elevation of the derrick floor above sea level is _____ ft.

DETAILS OF WORK

(State names of and expected depths to objective sands; show sizes, weights, and lengths of proposed casings; indicate mudding jobs, cementing points, and all other important proposed work)

- Propose well to test Pictured Cliffs zone at approximately 3250'.
- Drill surface hole to 120'. Cement 8 5/8", 24#, J-55 casing at 120' cemented to surface.
- Drill 7 7/8" hole to total depth, estimated at 3250'.
- Run electric logs and micrologs for decision to complete.
- If logs satisfactory, run 4 1/2", 116, #J-55 casing to total depth and cement with 250 sac.
- Productive intervals to be perforated and fraced.

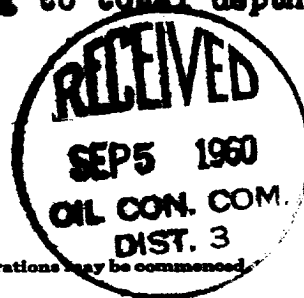

I understand that this plan of work must receive approval in writing by the Geological Survey before operations may be commenced.

Company John J. August and S. F. Wagenseller

Address 170 S. Beverly Dr.
Beverly Hills, California

By John J. August
Title Owner-Operator

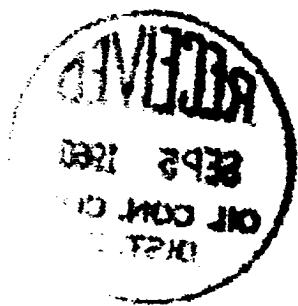

CERTIFICATE OF SURVEY

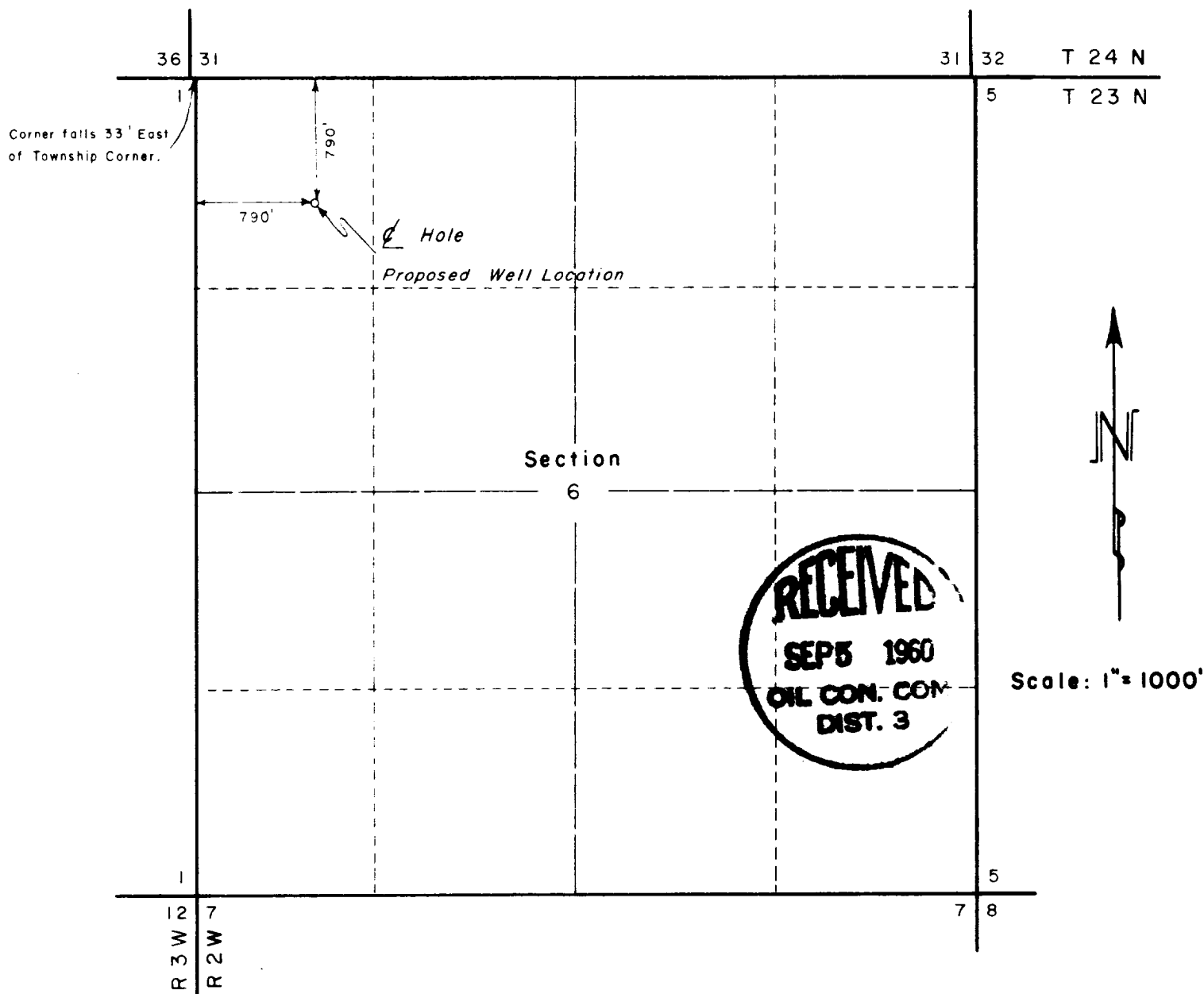

WELL LOCATION: WAGENSELLER-AUGUST No. 1A-6 (Jicarilla 159)

Located 790 feet South of the North line and 790 feet East of the West line of Section 6
 Township 23 North Range 2 West New Mexico Principal Meridian
 Rio Arriba County, New Mexico
 Existing ground elevation determined at approximately 7195 feet.

I hereby certify the above plat represents a survey made under my supervision and is accurate to the best of my knowledge and belief.

Elmer M. Clark

ELMER M. CLARK
 Registered Land Surveyor
 New Mexico (No. 3189)

E.M. CLARK & ASSOCIATES
 Durango, Colorado

Aug. 3, 1960

NEW MEXICO OIL CONSERVATION COMMISSION
WELL LOCATION AND ACREAGE DEDICATION PLAT

FORM C-128
 Revised 5/1/57

SEE INSTRUCTIONS FOR COMPLETING THIS FORM ON THE REVERSE SIDE

SECTION A

Operator Wagenseller-August		Lease Jicarilla - A		Well No. 246 1
Unit Letter	Section 6	Township 23 North	Range 2 West	County Rio Arriba
Actual Footage Location of Well: 790 feet from the North line and 790 feet from the West line				
Ground Level Elev. 7195' ±	Producing Formation Pictured Cliffs	Pool Un-named	Dedicated Acreage: 160 220 Acres	

1. Is the Operator the only owner in the dedicated acreage outlined on the plat below? YES ☒ NO ____ . ("Owner" means the person who has the right to drill into and to produce from any pool and to appropriate the production either for himself or for himself and another. (65-3-29 (e) NMSA 1935 Comp.)
2. If the answer to question one is "no," have the interests of all the owners been consolidated by communitization agreement or otherwise? YES ____ NO ____ . If answer is "yes," Type of Consolidation _____
3. If the answer to question two is "no," list all the owners and their respective interests below:

Owner Wagenseller-August 170 South Beverly Drive Beverly Hills, California	Land Description Jicarilla 159 SEP 1960
--	---

U. S. GEOLOGICAL SURVEY
 DISTRICT OFFICE, NEW MEXICO

SECTION B

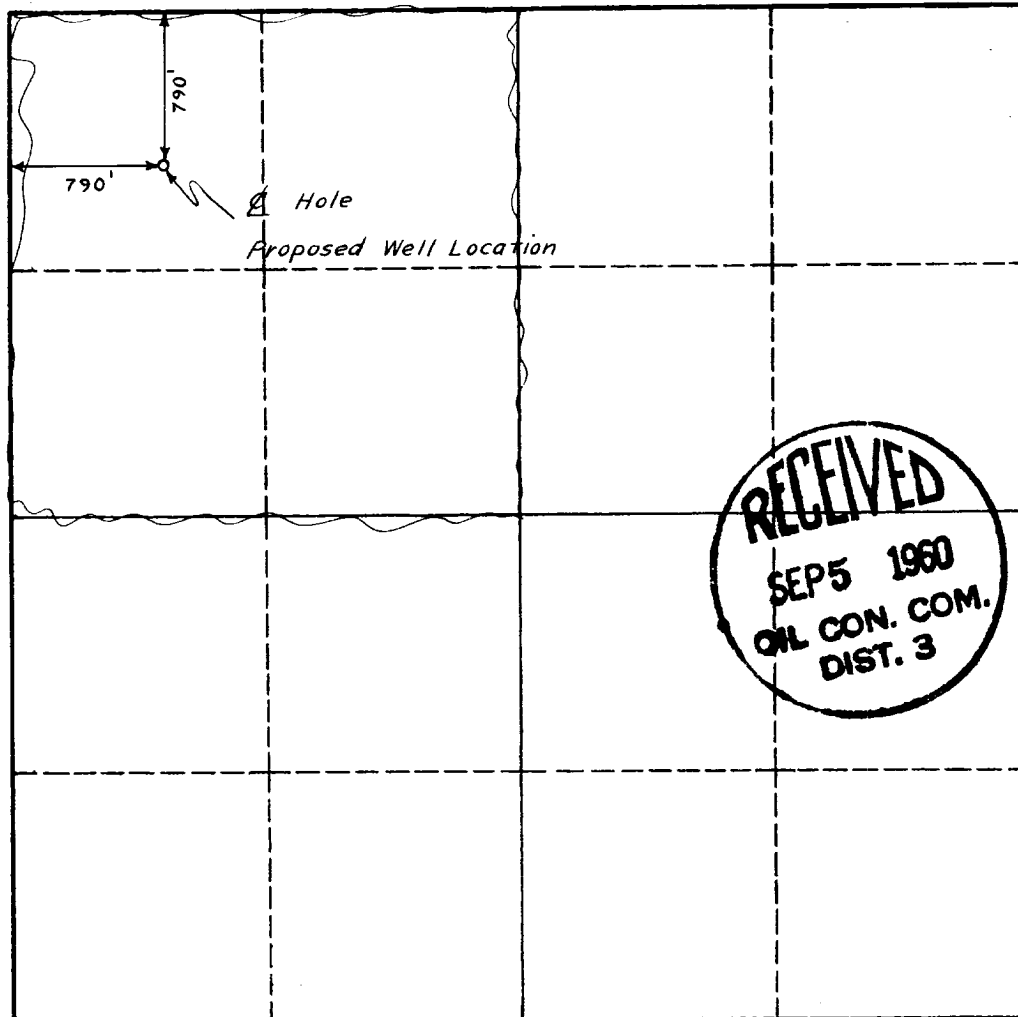

CERTIFICATION

I hereby certify that the information in SECTION A above is true and complete to the best of my knowledge and belief.

Name *Wagenseller-August*
 Position *Proprietor-Owner*
 Company *Wagenseller-August*
 Date *August 31, 1960*

I hereby certify that the well location shown on the plat in SECTION B was plotted from field notes of actual surveys made by me or under my supervision, and that the same is true and correct to the best of my knowledge and belief.

Date Surveyed
August 3, 1960
 Registered Professional Engineer and/or Land Surveyor

Edmund M. Clark
 Certificate No. **3189**

INSTRUCTIONS FOR COMPLETION OF FORM C-128

1. Operator shall furnish and certify to the information called for in Section A.
2. Operator shall outline the dedicated acreage for *both* oil and gas wells on the plat in Section B.
3. A registered professional engineer or land surveyor registered in the State of New Mexico or approved by the Commission shall show on the plat the location of the well and certify this information in the space provided.
4. All distances shown on the plat must be from the outer boundaries of the Section.
5. If additional space is needed for listing owners and their respective interests as required in question 3 of Section A, please use space below.