

Manager, Field
DEPUTY OIL & GAS INSPECTOR

MAR 28 1997

JICARILLA APACHE TRIBE

ENVIRONMENTAL PROTECTION OFFICE

P.O. BOX 507
DULCE, NEW MEXICO 87528

SUBMIT 1 COPY TO
NATURAL
RESOURCE DEPT
AND OIL-GAS
ADMINISTRATION

Approved

PIT REMEDIATION AND CLOSURE REPORT

Operator:	PNM Gas Services (<i>Bayless</i>)		Telephone:	324-3764										
Address:	603 W. Elm Street Farmington, NM 87401													
Facility or Well Name:	<i>Axi Apache C-7</i>													
Location:	Unit: <i>A</i>	Sec. <i>4</i>	T. <i>23</i> N	R. <i>5</i> W	County <i>Rio Arriba</i>									
Pit Type:	Separator <input type="checkbox"/>	Dehydrator <input type="checkbox"/>	Other <i>Drip</i>											
Land Type:	<i>Jicarilla Apache</i>													
Pit Location:	Pit dimensions: length <i>25'</i> width <i>16'</i> depth <i>13'</i>													
(Attach diagram)	Reference: wellhead <i>X</i> other <input type="checkbox"/>													
	Footage from reference: <i>76'</i>													
	Direction from reference: <i>Straight</i> Degrees <input type="checkbox"/> East <input type="checkbox"/> North <input type="checkbox"/>													
	<input type="checkbox"/> West of <input checked="" type="checkbox"/> South													
Depth to Ground Water:	<div><div>(Vertical distance from contaminants to seasonal high water elevation or ground water)</div><table><tr><td>Less than 50 feet</td><td>(20 points)</td><td><input type="checkbox"/></td></tr><tr><td>50 feet to 99 feet</td><td>(10 points)</td><td><input type="checkbox"/></td></tr><tr><td>Greater than 100 feet</td><td>(0 points)</td><td><input checked="" type="checkbox"/></td></tr></table></div>					Less than 50 feet	(20 points)	<input type="checkbox"/>	50 feet to 99 feet	(10 points)	<input type="checkbox"/>	Greater than 100 feet	(0 points)	<input checked="" type="checkbox"/>
Less than 50 feet	(20 points)	<input type="checkbox"/>												
50 feet to 99 feet	(10 points)	<input type="checkbox"/>												
Greater than 100 feet	(0 points)	<input checked="" type="checkbox"/>												
Wellhead Protection Area:	<div><div>(Less than 200 feet from a private domestic water source, or: less than 1,000 feet from all other water sources)</div><table><tr><td>Yes</td><td>(20 points)</td><td><input type="checkbox"/></td></tr><tr><td>No</td><td>(0 points)</td><td><input checked="" type="checkbox"/></td></tr></table></div>					Yes	(20 points)	<input type="checkbox"/>	No	(0 points)	<input checked="" type="checkbox"/>			
Yes	(20 points)	<input type="checkbox"/>												
No	(0 points)	<input checked="" type="checkbox"/>												
Distance to Surface Water:	<div><div>(Horizontal distance to perennial lakes, ponds, rivers, streams, creeks, irrigation canals and ditches)</div><table><tr><td>Less than 200 feet</td><td>(20 points)</td><td><input type="checkbox"/></td></tr><tr><td>200 feet to 1,000 feet</td><td>(10 points)</td><td><input type="checkbox"/></td></tr><tr><td>Greater than 1,000 feet</td><td>(0 points)</td><td><input checked="" type="checkbox"/></td></tr></table></div>					Less than 200 feet	(20 points)	<input type="checkbox"/>	200 feet to 1,000 feet	(10 points)	<input type="checkbox"/>	Greater than 1,000 feet	(0 points)	<input checked="" type="checkbox"/>
Less than 200 feet	(20 points)	<input type="checkbox"/>												
200 feet to 1,000 feet	(10 points)	<input type="checkbox"/>												
Greater than 1,000 feet	(0 points)	<input checked="" type="checkbox"/>												
Distance to Ephemeral Stream (dry wash):	<div><div>(Horizontal distance to all downgradient streams having a width of at least 10 feet)</div><table><tr><td>Less than or equal to 100 feet</td><td>(10 points)</td><td><input type="checkbox"/></td></tr><tr><td>Greater than 100 feet</td><td>(0 points)</td><td><input checked="" type="checkbox"/></td></tr></table></div>					Less than or equal to 100 feet	(10 points)	<input type="checkbox"/>	Greater than 100 feet	(0 points)	<input checked="" type="checkbox"/>			
Less than or equal to 100 feet	(10 points)	<input type="checkbox"/>												
Greater than 100 feet	(0 points)	<input checked="" type="checkbox"/>												
Distance to Nearest Lake, Playa, or Watering Pond:	<div><div>(Horizontal distance to all downgradient lakes, playas, and livestock or wildlife water ponds)</div><table><tr><td>Less than or equal to 100 feet</td><td>(10 points)</td><td><input type="checkbox"/></td></tr><tr><td>Greater than 100 feet</td><td>(0 points)</td><td><input checked="" type="checkbox"/></td></tr></table></div>					Less than or equal to 100 feet	(10 points)	<input type="checkbox"/>	Greater than 100 feet	(0 points)	<input checked="" type="checkbox"/>			
Less than or equal to 100 feet	(10 points)	<input type="checkbox"/>												
Greater than 100 feet	(0 points)	<input checked="" type="checkbox"/>												
RANKING SCORE (TOTAL POINTS):					<i>6</i>									

Date Remediation Started: 10-1-96 Date Completed: 11-12-96

Remediation Method: Excavation X Approx. Cubic Yards 192

(Check all appropriate sections)

Landfarmed X Amount Landfarmed (cubic yds): 192

Other _____

Remediation Location: Onsite X Offsite _____

(i.e., landfarmed onsite, name and location of offsite facility)

General Description of Remedial Action:

Removed contaminated soil from all four side walls as to get a below 100 ppm head space reading. Bottom was solid sand stone rock.

Ground Water Encountered: No X Yes _____ Depth _____

Final Pit Closure Sampling:

Sample Location North, East, South & West side walls

(if multiple samples, attach sample result and diagram of sample locations and depths.)

Sample depth 13'

Sample date 10-1-96 Sample time 1020

Sample Results

Soil: Benzene (ppm) 0.0005 Water: Benzene (ppb) _____

Total BTEX (ppm) 0.0316 Toluene (ppb) _____

Field headspace (ppm) 43.6 Ethylbenzene (ppb) _____

TPH 5.0 ppm Method 8015 Total Xylenes (ppb) _____

Ground Water Sample: Yes _____ No X (If yes, attach sample results)

I HEREBY CERTIFY THAT THE INFORMATION ABOVE IS TRUE AND COMPLETE TO THE BEST OF MY KNOWLEDGE AND MY BELIEF

DATE 10/4/96 PRINTED NAME Ronald A. Dedrick

SIGNATURE Ronald A. Dedrick AND TITLE Environmental Technician II

AFTER REVIEW OF THE PIT CLOSURE INFORMATION, PIT CLOSURE IS APPROVED IN ACCORDANCE TO JICARILLA APACHE TRIBE PIT CLOSURE ORDINANCE.

APPROVED: YES ✓ NO _____ (REASON): Spray

SIGNED: Gabeil Julian DATE: 10/7/96

Hx147pache C-1
Sec. 4 T23N R5W
Bayless

Drip
O
Column

Drip
O
Riser

 meter
house

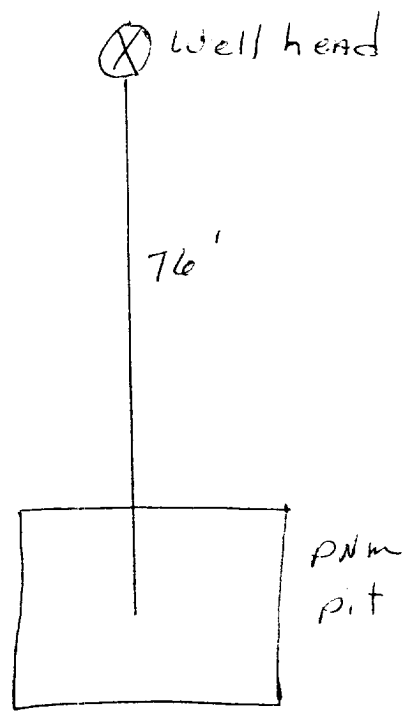

OFF: (505) 325-5667



LAB: (505) 325-1556

Diesel Range Organics

Attn: *Denver Bearden*
Company: *PNM Gas Services*
Address: *603 W. Elm*
City, State: *Farmington, NM 87401*

Date: *2-Oct-96*
COC No.: *5287*
Sample No. *12424*
Job No. *2-1000*

Project Name: *PNM Gas Services - Axi Apache C-7 Run 116*
Project Location: *9610011020; 4pt. Composite*
Sampled by: *EP* Date: *1-Oct-96* Time: *10:20*
Analyzed by: *DC/BV* Date: *2-Oct-96*
Sample Matrix: *Soil*

Laboratory Analysis

<i>Parameter</i>	<i>Result</i>	<i>Unit of Measure</i>	<i>Detection Limit</i>	<i>Unit of Measure</i>
<i>Diesel Range Organics (C10 - C28)</i>	<i><5.0</i>	<i>mg/kg</i>	<i>5.0</i>	<i>mg/kg</i>

Quality Assurance Report

DRO QC No.: 0489-QC

Calibration Check

<i>Parameter</i>	<i>Method Blank</i>	<i>Unit of Measure</i>	<i>True Value</i>	<i>Analyzed Value</i>	<i>% Diff</i>	<i>Limit</i>
<i>Diesel Range (C10 - C28)</i>	<i><5.0</i>	<i>ppm</i>	<i>100</i>	<i>100</i>	<i>0.2</i>	<i>15%</i>

Matrix Spike

<i>Parameter</i>	<i>1 - Percent Recovered</i>	<i>2 - Percent Recovered</i>	<i>Limit</i>	<i>%RSD</i>	<i>Limit</i>
<i>Diesel Range (C10-C28)</i>	<i>91</i>	<i>79</i>	<i>(70-130)</i>	<i>10</i>	<i>20%</i>

Method - SW-846 EPA Method 8015A mod. - Nonhalogenated Volatile Hydrocarbons by Gas Chromatography

Approved by: *[Signature]*
Date: *10/2/96*

P.O. BOX 2606 • FARMINGTON, NM 87499

- TECHNOLOGY BLENDING INDUSTRY WITH THE ENVIRONMENT -

OFF: (505) 325-5667



LAB: (505) 325-1556

AROMATIC VOLATILE ORGANICS

Attn: *Denver Bearden*
Company: *PNM Gas Services*
Address: *603 W. Elm*
City, State: *Farmington, NM 87401*

Date: *2-Oct-96*
COC No.: *5287*
Sample No.: *12424*
Job No.: *2-1000*

Project Name: ***PNM Gas Services - Axi Apache C-7 Run 116***
Project Location: ***9610011020; 4pt. Composite***
Sampled by: EP Date: 1-Oct-96 Time: 10:20
Analyzed by: DC Date: 2-Oct-96
Sample Matrix: *Soil*

Laboratory Analysis

<i>Parameter</i>	<i>Result</i>	<i>Unit of Measure</i>	<i>Detection Limit</i>	<i>Unit of Measure</i>
<i>Benzene</i>	0.5	ug/kg	0.2	ug/kg
<i>Toluene</i>	7.4	ug/kg	0.2	ug/kg
<i>Ethylbenzene</i>	4.4	ug/kg	0.2	ug/kg
<i>m,p-Xylene</i>	15.1	ug/kg	0.2	ug/kg
<i>o-Xylene</i>	4.2	ug/kg	0.2	ug/kg
	<i>TOTAL</i>	31.6	ug/kg	

Method - SW-846 EPA Method 8020 Aromatic Volatile Organics by Gas Chromatography

Approved by: 
Date: *10/2/96*

P.O. BOX 2606 • FARMINGTON, NM 87499

- TECHNOLOGY BLENDING INDUSTRY WITH THE ENVIRONMENT -

JICARILLA APACHE TRIBE
ENVIRONMENTAL
PROTECTION OFFICE
P.O. BOX 507
DULCE, NEW MEXICO 87528

SUBMIT 1 COPY TO
NATURAL
RESOURCE DEPT
AND OIL GAS
ADMINISTRATION

ON-SITE SOIL REMEDIATION REPORT

Operator: <u>PNM Gas Services (Bayless)</u> Telephone: <u>324-3764</u>	
Address: <u>603 W. Elm Street Farmington, NM 87401</u>	
Facility or Well Name: <u>Axi Apache C-7</u>	
Location: Unit: <u>A</u> Sec. <u>4</u> T. <u>23</u> N R. <u>5</u> W County <u>Rio Arriba</u>	
Land Type: <u>Jicarilla Apache</u>	
Date Remediation Started: <u>10/1/96</u> Date Completed: <u>10/22/96</u>	
Remediation Method: Landfarmed <u>X</u> Approx. cubic yards <u>192</u>	
Composted <u> </u>	
Other <u> </u>	
Depth to Ground Water: (pts.) <u>0</u>	Final Closure Sampling: Sampling Date: <u>10/22/96</u> Time <u>1745</u> Sampling Results: Field Headspace (ppm) <u>24.5</u> TPH (ppm) <u><5.0</u> Method <u>8015</u> Other <u> </u>
Distance to an Ephemeral Stream: (pts.) <u>0</u>	
Distance to Nearest Lake, Playa, or Watering Pond: (pts.) <u>0</u>	
Wellhead Protection Area: (pts.) <u>0</u>	
Distance to Surface Water: (pts.) <u>0</u>	
Ranking Score (Total Points): <u>0</u>	
I HEREBY CERTIFY THAT THE INFORMATION ABOVE IS TRUE AND COMPLETE TO THE BEST OF MY KNOWLEDGE AND BELIEF	
DATE <u>10/22/96</u>	PRINTED NAME <u>Roy Burnham</u>
SIGNATURE <u>Roy Burnham</u>	AND TITLE <u>Environmental Technician II</u>
AFTER REVIEW OF THE SOIL REMEDIATION INFORMATION, ON-SITE REMEDIATION APPROVED IN ACCORDANCE TO THE JICARILLA APACHE TRIBE PIT CLOSURE ORDINANCE	
APPROVED: YES <u>X</u> NO <u> </u> (REASON) <u> </u>	
SIGNED: <u>Kenn C Mandy</u>	DATE: <u>10-28-96</u>

17X1 Hpatche C-1
Sec. 4 T23N R5W
Bayless

Land farm

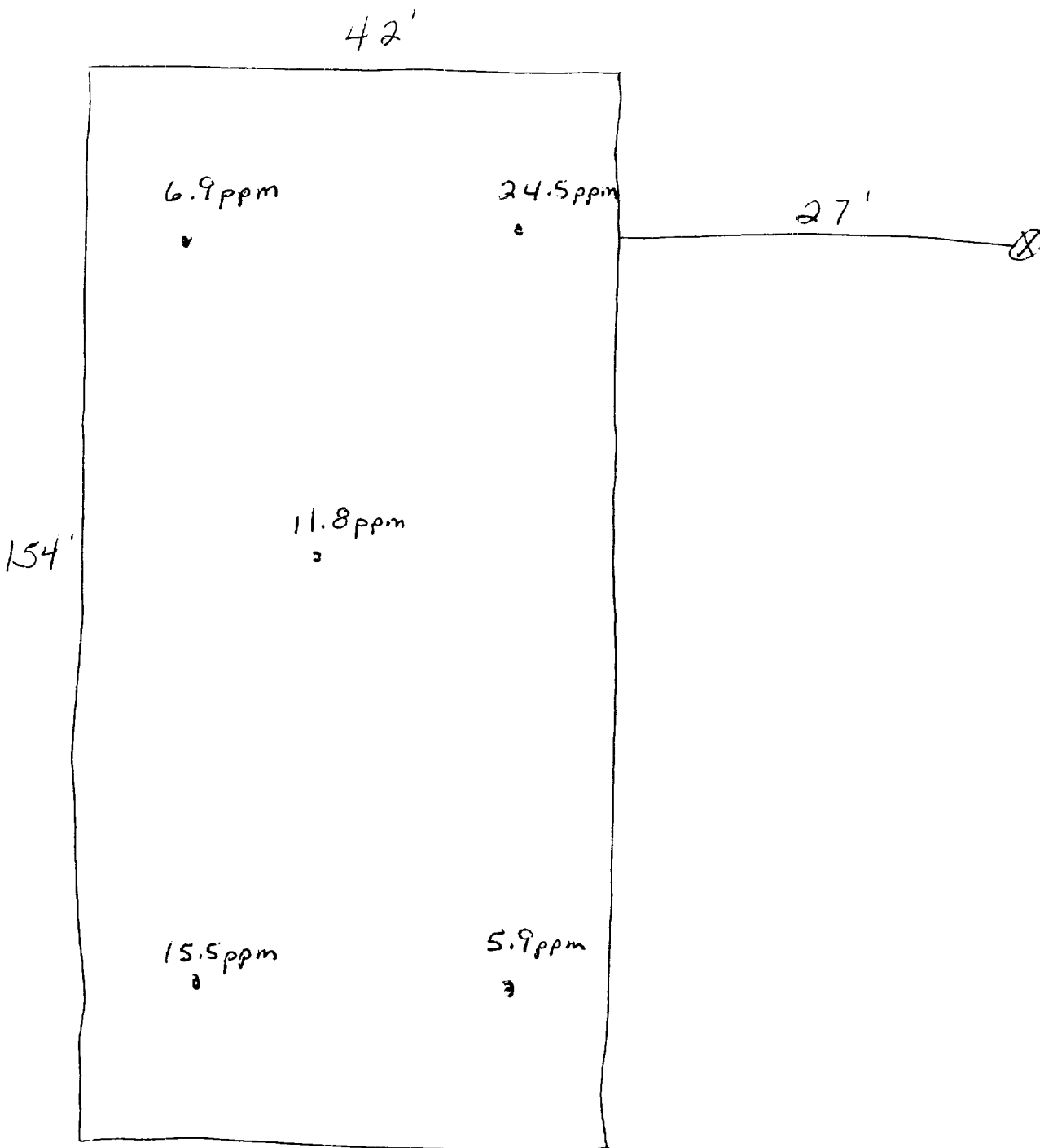

OFF: (505) 325-5667



LAB: (505) 325-1556

Diesel Range Organics

Attn: *Denver Bearden*
Company: *PNM Gas Services*
Address: *603 W. Elm*
City, State: *Farmington, NM 87401*

Date: *24-Oct-96*
COC No.: *5383*
Sample No. *12674*
Job No. *2-1000*

Project Name: *PNM Gas Services - Axi Apache C-7 Landfarm Run 116*

Project Location: *9610221745; 5pt. Composite*

Sampled by: *RB* Date: *22-Oct-96* Time: *17:45*

Analyzed by: *DC/HR* Date: *24-Oct-96*

Sample Matrix: *Soil*

Laboratory Analysis

<i>Parameter</i>	<i>Result</i>	<i>Unit of Measure</i>	<i>Detection Limit</i>	<i>Unit of Measure</i>
<i>Diesel Range Organics (C10 - C28)</i>	<i><5.0</i>	<i>mg/kg</i>	<i>5.0</i>	<i>mg/kg</i>

Quality Assurance Report

DRO QC No.: *0489-QC*

Calibration Check

<i>Parameter</i>	<i>Method Blank</i>	<i>Unit of Measure</i>	<i>True Value</i>	<i>Analyzed Value</i>	<i>% Diff</i>	<i>Limit</i>
<i>Diesel Range (C10 - C28)</i>	<i><5.0</i>	<i>ppm</i>	<i>100</i>	<i>96</i>	<i>4.4</i>	<i>15%</i>

Matrix Spike

<i>Parameter</i>	<i>1- Percent Recovered</i>	<i>2 - Percent Recovered</i>	<i>Limit</i>	<i>%RSD</i>	<i>Limit</i>
<i>Diesel Range (C10-C28)</i>	<i>114</i>	<i>104</i>	<i>(70-130)</i>	<i>6</i>	<i>20%</i>

Method - *SW-846 EPA Method 8015A mod. - Nonhalogenated Volatile Hydrocarbons by Gas Chromatography*

Approved by: 

Date: *10/24/96*

P.O. BOX 2606 • FARMINGTON, NM 87499

- TECHNOLOGY BLENDING INDUSTRY WITH THE ENVIRONMENT -