

Land Office _____
Lease No. **11-24955** _____
Unit _____

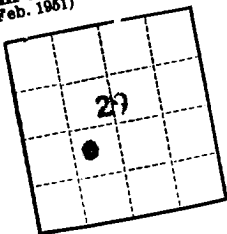

(SUBMIT IN)

UNITED STATES
DEPARTMENT OF THE INTERIOR
GEOLOGICAL SURVEY

DEPT. OF GEOLOGICAL SURVEY

SUNDRY NOTICES AND REPORTS ON WELLS

1. SUBSEQUENT REPORT OF WATER SHUT-OFF

2. SUBSEQUENT REPORT OF SHOOTING OR ACIDIZING

3. REPORT OF ALTERING CASING

4. REPORT OF REPAIRS



DEPT. OF THE INTERIOR
GEOLOGICAL SURVEY

SUNDRY NOTICES AND REPORTS ON WELLS

NOTICE OF INTENTION TO DRILL	<input type="checkbox"/>	SUBSEQUENT REPORT OF WATER SHUT-OFF
NOTICE OF INTENTION TO CHANGE PLANS	<input type="checkbox"/>	SUBSEQUENT REPORT OF SHOOTING OR ACIDIZING
NOTICE OF INTENTION TO TEST WATER SHUT-OFF	<input type="checkbox"/>	SUBSEQUENT REPORT OF ALTERING CASING
NOTICE OF INTENTION TO RE-DRILL OR REPAIR WELL	<input type="checkbox"/>	SUBSEQUENT REPORT OF RE-DRILLING OR REPAIR
NOTICE OF INTENTION TO SHOOT OR ACIDIZE	<input type="checkbox"/>	SUBSEQUENT REPORT OF ABANDONMENT
NOTICE OF INTENTION TO PULL OR ALTER CASING	<input type="checkbox"/>	SUPPLEMENTARY WELL HISTORY
NOTICE OF INTENTION TO ABANDON WELL	<input type="checkbox"/>	

(INDICATE ABOVE BY CHECK MARK NATURE OF REPORT, NOTICE, OR OTHER DATA)

RECEIVED

DEC 4 1962

U. S. GEOLOGICAL SURVEY
FARMINGTON, NEW MEXICO

1962

line of sec. 29

NOTICE OF INTENTION TO SHOOT OR ACIDIZE
 NOTICE OF INTENTION TO PULL OR ALTER CASING
 NOTICE OF INTENTION TO ABANDON WELL

(INDICATE ABOVE BY CHECK MARK NATURE OF REPORT, NOTICE, OR OTHER DATA)

Well No. 100-100-100-100 is located 100 ft. from N line and 100 ft. from E line of sec. 29
100 (Twp.) 100 (Range) 100 (Meridian) 100 (State or Territory)

(County or Subdivision)

(Field)

or above sea level is 100 ft.

RECEIVED
 DEC 5 1961
 OIL CON. COM.
 DIST. 3

WORK

The elevation of the derrick floor above sea level is _____

DETAILS OF WORK

_____ size sands; show sizes, weights, and lengths
and all other important properties.

[illegible]

I understand that this plan of work must receive approval in writing by the Geological Survey before operations may be commenced.

Charles A. Mendenhall

John F. Mendenhall

I understand that this plan of work must reach

Company _____ Charles A. Marzadro

Address _____ P. O. Box 351

_____ Durango, Colorado

By John F. Mitchell
 Title _____

NUMBER OF COPIES RECEIVED	
DISTRIBUTION	
SANITARY	
FILE	
U.S.G.S.	
LAND OFFICE	
TRANSPORTER	OIL
	GAS
PRODUCTION OFFICE	
OPERATOR	

NEW MEXICO OIL CONSERVATION COMMISSION
WELL LOCATION AND ACREAGE DEDICATION PLAT
 SEE INSTRUCTIONS FOR COMPLETING THIS FORM ON THE REVERSE SIDE

FORM C-128
 Revised 5/1/57

SECTION A

Operator Charles P. Marzedro			Lease W-049655		Well No. Gov't #1
Unit Letter A	Section 29	Township 24 North	Range 1 East, N.M.	County Rio Arriba	
Actual Footage Location of Well: 1960 feet from the East line and 1940 feet from the South line					
Ground Level Elev. 7239 feet	Producing Formation		Pool Wildcat	Dedicated Acreage: 30 Acres	

1. Is the Operator the only owner in the dedicated acreage outlined on the plat below? YES ☒ NO ☐ ("Owner" means the person who has the right to drill into and to produce from any pool and to appropriate the production either for himself or for himself and another. (65-3-29 (e) NMSA 1935 Comp.)
2. If the answer to question one is "no," have the interests of all the owners been consolidated by communization agreement or otherwise? YES ☐ NO ☐ If answer is "yes," Type of Consolidation _____
3. If the answer to question two is "no," list all the owners and their respective interests below:

Owner	Land Description

RECEIVED
 DEC 4 1961
 U. S. GEOLOGICAL SURVEY
 FARMINGTON, NEW MEXICO
 CERTIFICATION

SECTION B

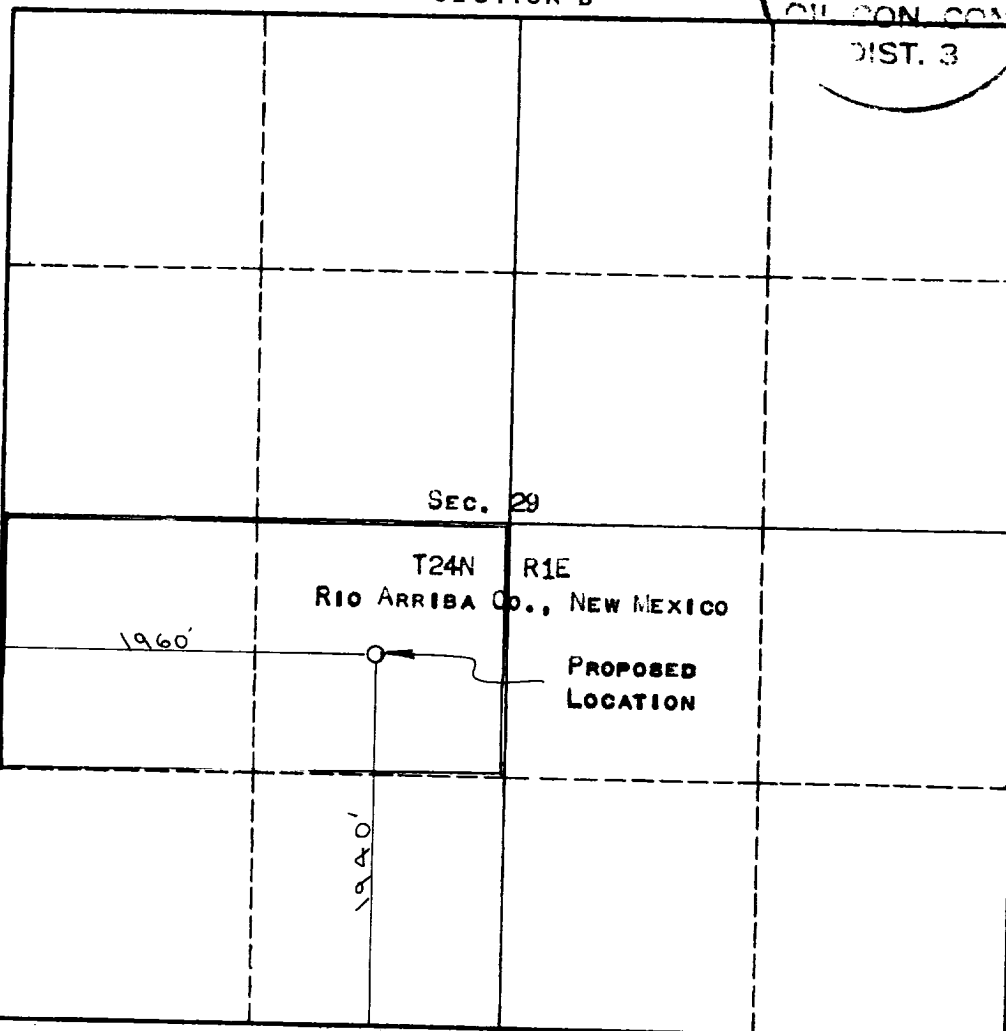

I hereby certify that the information in SECTION A above is true and complete to the best of my knowledge and belief.

Name **John F. Mitchell**
 Position **Agent**
 Company
 Date **November 30, 1961**

I hereby certify that the well location shown on the plat in SECTION B was plotted from field notes of actual surveys made by me or under my supervision, and that the same is true and correct to the best of my knowledge and belief.

Date Surveyed **11-18-61**
 Registered Professional Engineer and/or Land Surveyor

Certificate No. **NEW MEXICO #3189**

INSTRUCTIONS FOR COMPLETION OF FORM C-128

1. Operator shall furnish and certify to the information called for in Section A.
2. Operator shall outline the dedicated acreage for *both* oil and gas wells on the plat in Section B.
3. A registered professional engineer or land surveyor registered in the State of New Mexico or approved by the Commission shall show on the plat the location of the well and certify this information in the space provided.
4. All distances shown on the plat must be from the outer boundaries of the Section.
5. If additional space is needed for listing owners and their respective interests as required in question 3 of Section A, please use space below.