

NEW MEXICO OIL CONSERVATION COMMISSION  
Santa Fe, New Mexico

Form C-101  
Revised (12/1/55)

NOTICE OF INTENTION TO DRILL

Notice must be given to the District Office of the Oil Conservation Commission and approval obtained before drilling or recompletion begins. If changes in the proposed plan are considered advisable, a copy of this notice showing such changes will be returned to the sender. Submit this notice in QUINTUPLICATE. One copy will be returned following approval. See additional instructions in Rules and Regulations of the Commission. If State Land submit 6 Copies Attach Form C- 128 in triplicate to first 3 copies of form C-101

Durango, Colorado  
(Place)

December 19, 1960  
(Date)

OIL CONSERVATION COMMISSION  
SANTA FE, NEW MEXICO

Gentlemen:

You are hereby notified that it is our intention to commence the Drilling of a well to be known as

LEMM & MAIATICO

(Company or Operator)

Arellano

(Lease)

Well No. 1, in F (Unit) The well is

located 1963 feet from the north line and 1980 feet from the

west line of Section 5, T 24N, R 1E, NMPM.

(GIVE LOCATION FROM SECTION LINE) (Wildcat) Pool, Rio Arriba County

D	C	B	A
E	F	G	H
L	K	J	I
M	N	O	P

If State Land the Oil and Gas Lease is No.

If patented land the owner is Eleocadio Arellano

Address Llavas, New Mexico

We propose to drill well with drilling equipment as follows: cable tools, surfact to M TD

The status of plugging bond is in transit

Drilling Contractor Western Drilling Company  
Lubbock, Texas

We intend to complete this well in the Greenhorn formation at an approximate depth of 4300 feet.

CASING PROGRAM

We propose to use the following strings of Casing and to cement them as indicated:

Size of Hole	Size of Casing	Weight per Foot	New or Second Hand	Depth	Sucks Cement
12 1/2"	9 5/8"		used	2100'	100
8"	5 1/2"	15.50	new	TD	150

If changes in the above plans become advisable we will notify you immediately.

ADDITIONAL INFORMATION (If recompletion give full details of proposed plan of work.)

Approved  
Except as follows:

Sincerely yours,

LEMM & MAIATICO

(Company or Operator)

By Clinton White

Position Agent  
Send Communications regarding well to

Name Clinton White, Box 351

Address Durango, Colorado

OIL CONSERVATION COMMISSION

By

# CERTIFICATE OF SURVEY

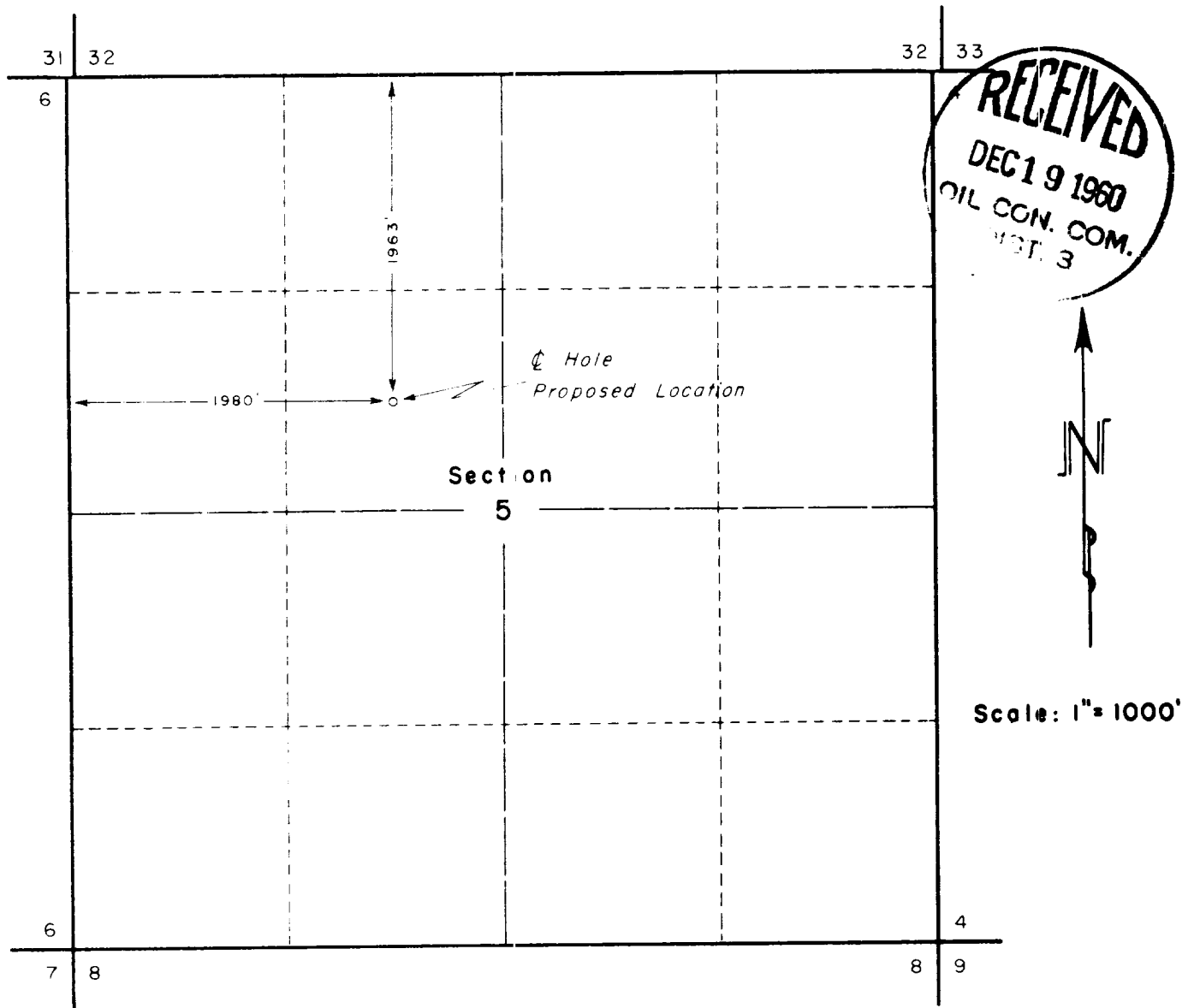

## WELL LOCATION: Lemn - Maiatico - Arellano No. 1

Located 1963 feet South of the North line and 1980 feet East of the West line of Section 5  
Township 24 North Range 1 East New Mexico Principal Meridian  
Rio Arriba County, New Mexico  
Existing ground elevation determined at 6958 feet based on U.S.G.S. Datum

I hereby certify the above plat represents a survey  
made under my supervision and is accurate to the  
best of my knowledge and belief.

*Elmer M. Clark*  
ELMER M. CLARK  
Registered Land Surveyor  
State of New Mexico (No. 3189)

**E.M. CLARK & ASSOCIATES**  
Durango, Colorado

Dec. 16, 1960  
File No. 60 673

NUMBER OF COPIES RECEIVED	
DISTRIBUTION	
SANTA FE	
FILE	
U.S.G.S.	
LAND OFFICE	
TRANSPORTER	OIL GAS
PRODUCTION OFFICE	
OPERATOR	

**NEW MEXICO OIL CONSERVATION COMMISSION**  
**WELL LOCATION AND ACREAGE DEDICATION PLAT**  
 SEE INSTRUCTIONS FOR COMPLETING THIS FORM ON THE REVERSE SIDE

FORM C-128  
 Revised 5/1/57

**SECTION A**

Operator <b>Lemm &amp; Malatico</b>		Lease <b>Arellano</b>		Well No. <b>1</b>
Unit Letter <b>F</b>	Section <b>5</b>	Township <b>24 North</b>	Range <b>1 East</b>	County <b>Rio Arriba</b>
Actual Footage Location of Well: <b>1963</b> feet from the <b>North</b> line and <b>1980</b> feet from the <b>West</b> line				
Ground Level Elev. <b>6958</b>	Producing Formation <b>Greenhorn</b>	Pool <b>undesignated</b>	Dedicated Acreage: <b>40</b> Acres	

1. Is the Operator the only owner in the dedicated acreage outlined on the plat below? YES ☒ NO \_\_\_\_ . ("Owner" means the person who has the right to drill into and to produce from any pool and to appropriate the production either for himself or for himself and another. (65-3-29 (e) NMSA 1935 Comp.)
2. If the answer to question one is "no," have the interests of all the owners been consolidated by communication agreement or otherwise? YES \_\_\_\_ NO \_\_\_\_ . If answer is "yes," Type of Consolidation \_\_\_\_
3. If the answer to question two is "no," list all the owners and their respective interests below:

Owner	Land Description

**SECTION B**

**CERTIFICATION**

I hereby certify that the information in SECTION A above is true and complete to the best of my knowledge and belief.

Name <b>W. E. Carr</b>
Position <b>Agent for Lemm &amp; Malatico</b>
Company
Date <b>12/29/60</b>

I hereby certify that the well location shown on the plat in SECTION B was plotted from field notes of actual surveys made by me or under my supervision, and that the same is true and correct to the best of my knowledge and belief.

Date Surveyed
Registered Professional Engineer and/or Land Surveyor
Certificate No.

0 330 660 990 1320 1650 1980 2310 2640 2000 1500 1000 500 0

## INSTRUCTIONS FOR COMPLETION OF FORM C-128

1. Operator shall furnish and certify to the information called for in Section A.
2. Operator shall outline the dedicated acreage for *both* oil and gas wells on the plat in Section B.
3. A registered professional engineer or land surveyor registered in the State of New Mexico or approved by the Commission shall show on the plat the location of the well and certify this information in the space provided.
4. All distances shown on the plat must be from the outer boundaries of the Section.
5. If additional space is needed for listing owners and their respective interests as required in question 3 of Section A, please use space below.

STATE OF NEW MEXICO		
OIL CONSERVATION COMMISSION		
AZTEC DISTRICT OFFICE		
NUMBER OF COPIES RECEIVED		5
DISTRIBUTION		
SANTA FE		
FILE		
U.S.G.S.		
LAND OFFICE		
TRANSPORTER		
PRODUCTION OFFICE		
OPERATOR		