

UNITED STATES  
DEPARTMENT OF THE INTERIOR

## GEOLOGICAL SURVEY

API 30-039-21182

1. LEASE OR LOCATION AND SERIAL NO.

Contract # 413

6. LESSEE, ALLOTTEE OR MINOR NAME

Jicarilla

7. UNIT AGREEMENT NAME

8. LEASE OR LEASE NAME

Chacon Jicarilla Apache

9. WELL NO.

D-3

10. FIELD AND POOL, OR WILDCAT

Undesignated Dakota

11. SEC., T., R., M., OR BLK.  
AND SURVEY OR AREA

Sec. 15, T23N, R3W

12. COUNTY OR PARISH

13. STATE

Rio Arriba

N.M.

## APPLICATION FOR PERMIT TO DRILL, DEEPEN, OR PLUG BACK

1. TITLE OF WORK

DRILL ☒DEEPEN ☐PLUG BACK ☐

2. TYPE OF WELL

OIL  
WELL ☒GAS  
WELL ☐OTHER ☐LEASER  
ZONE ☒MULTIPLE  
ZONE ☐

3. NAME OF OPERATOR

Dave M. Thomas, Jr.

4. ADDRESS OF OPERATOR

P. O. Box 2026, Farmington, New Mexico 87401

5. LOCATION OF WELL (Report location clearly and in accordance with any State requirements.)\*

At surface

800' FNL, 880' FWL

At proposed prod. zone

same

14. DISTANCE IN MILES AND DIRECTION FROM NEAREST TOWN OR POST OFFICE\*

20 miles North of Cuba, New Mexico

15. DISTANCE FROM PROPOSED\*

LOCATION TO NEAREST

PROPERTY OR LEASE LINE, FT.

800'

(Also to nearest drlg. unit line, if any)

18. DISTANCE FROM PROPOSED LOCATION\*

TO NEAREST WELL, DRILLING, COMPLETED,  
OR APPLIED FOR, ON THIS LEASE, FT.

4500'

16. NO. OF ACRES IN LEASE

1920

19. PROPOSED DEPTH

7800'

17. NO. OF ACRES ASSIGNED

TO THIS WELL

40

20. ROTARY OR CABLE TOOLS

Rotary

21. ELEVATIONS (Show whether DF, RT, GR, etc.)

7322' GR.

22. APPROX. DATE WORK WILL START\*

4-01-76

## 23. PROPOSED CASING AND CEMENTING PROGRAM

SIZE OF HOLE	SIZE OF CASING	WEIGHT PER FOOT	SETTING DEPTH	QUANTITY OF CEMENT
12-1/4	8-5/8"	24.0#	300'	200 sacks-circulated to surface
7-7/8	4-1/2"	10.5-11.6	TD	600-150 sacks

It is intended to drill this well to a depth sufficient to penetrate the Dakota formation using rotary tools and a fresh water gel-chemical mud as a circulating media. Electric logs will be run to TD and, if a completion is attempted, casing will be run to total depth and cement circulated above the Gallup formation on the first stage. The Pictured Cliffs formation will be covered with cement on second stage cementing. Productive formations will be perforated and sand water fractured.

IN ABOVE SPACE DESCRIBE PROPOSED PROGRAM: If proposal is to deepen or plug back, give data on present productive zone and proposed new productive zone. If proposal is to drill or deepen directionally, give pertinent data on subsurface locations and proposed and true vertical depths. Give blowout preventer program, if any.

24.

SIGNED

*Dave M. Thomas, Jr.*

TITLE

DATE 2-10-76

(This space for Federal or State office use)

PERMIT NO.

APPROVAL DATE

APPROVED BY

TITLE

DATE

CONDITIONS OF APPROVAL, IF ANY:

*Okal**14*

\*See Instructions On Reverse Side

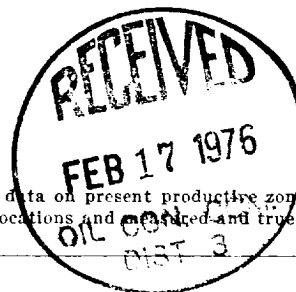

**NEW MEXICO OIL CONSERVATION COMMISSION  
WELL LOCATION AND ACREAGE DEDICATION PLAT**

Form C-102  
Supersedes C-128  
Effective 1-1-65

All distances must be from the outer boundaries of the Section.

Operator <b>DAVE M. THOMAS JR</b>			Lease <b>CHACON JICARILLA APACHE D</b>		Well No. <b>8-3</b>
Unit Letter <b>D</b>	Section <b>15</b>	Township <b>23 NORTH</b>	Range <b>3 WEST</b>	County <b>RIO ARriba</b>	
Actual Footage Location of Well: <div style="display: flex; justify-content: space-between;"> <span>800 feet from the <b>NORTH</b> line and</span> <span>880 feet from the <b>WEST</b> line</span> </div>					
Ground Level Elev. <b>7322</b>	Producing Formation <b>Dakota</b>	Pool <b>Undesignated Dakota</b>	Dedicated Acreage: <b>40</b> Acres		

1. Outline the acreage dedicated to the subject well by colored pencil or hachure marks on the plat below.
2. If more than one lease is dedicated to the well, outline each and identify the ownership thereof (both as to working interest and royalty).
3. If more than one lease of different ownership is dedicated to the well, have the interests of all owners been consolidated by communitization, unitization, force-pooling, etc?  
☐ Yes    ☐ No    If answer is "yes," type of consolidation \_\_\_\_\_

If answer is "no," list the owners and tract descriptions which have actually been consolidated. (Use reverse side of this form if necessary.) \_\_\_\_\_

No allowable will be assigned to the well until all interests have been consolidated (by communitization, unitization, forced-pooling, or otherwise) or until a non-standard unit, eliminating such interests, has been approved by the Commission.

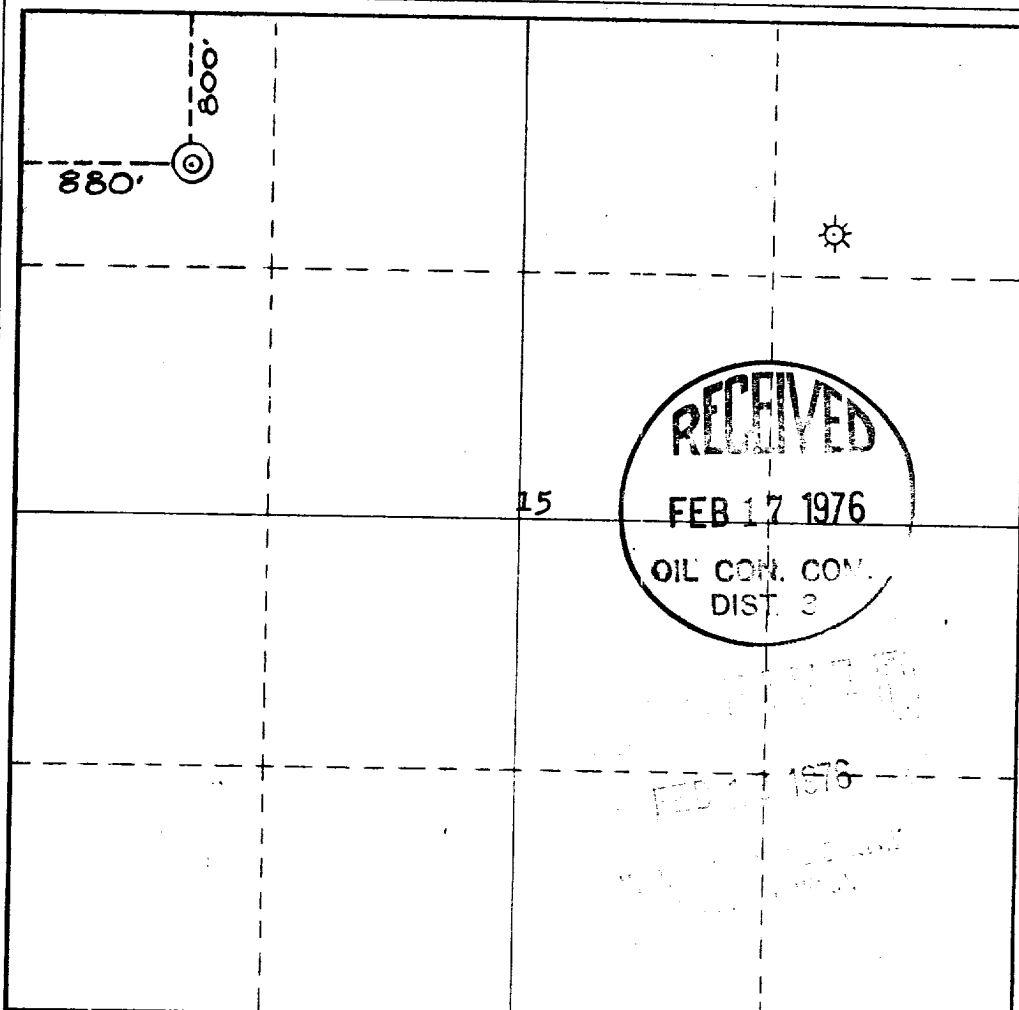

**CERTIFICATION**

I hereby certify that the information contained herein is true and complete to the best of my knowledge and belief.

ORIGINAL OF  
**DAVE M. THOMAS, JR.**

**Dave M. Thomas, Jr.**  
Position

Company  
**Dave M. Thomas, Jr.**

Date  
**2-10-76**

I hereby certify that the information shown on this plat was plotted from field notes of actual surveys made by me or under my supervision, and that the same is true and correct to the best of my knowledge and belief.

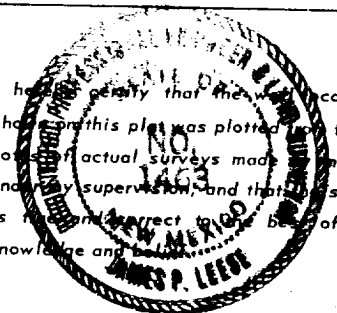

Date Surveyed  
**29 January 1976**

Registered Professional Engineer and/or Land Surveyor

*James P. Leese*  
**James P. Leese**

Certificate No. **1463**

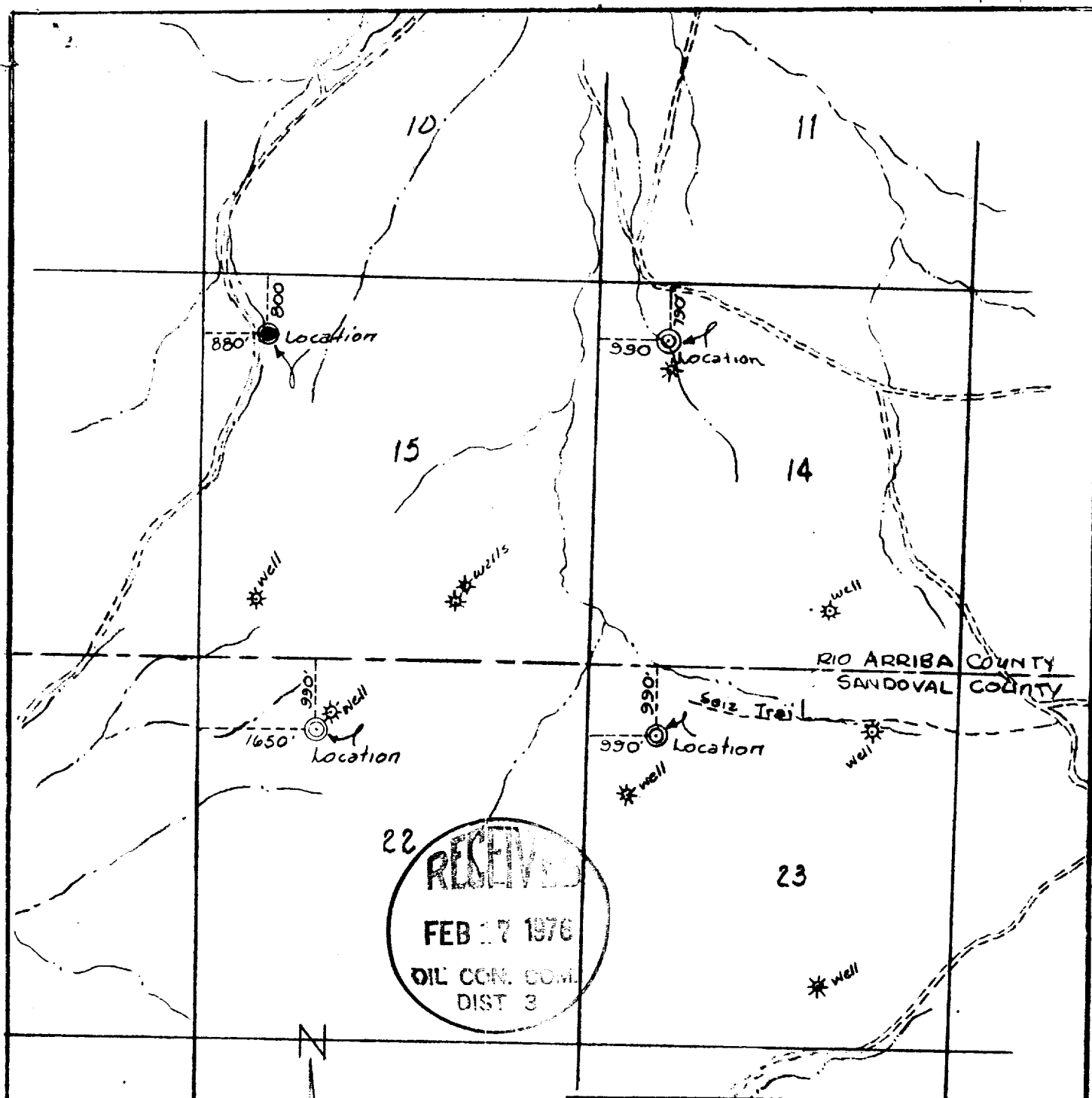

RECEIVED  
 FEB 17 1976  
 OIL CON. COM.  
 DIST 3



RECEIVED  
 FEB 18 1976  
 U.S. GEOLOGICAL SURVEY  
 WASHINGTON, D.C.

SCALE: 1" = 2000'

VICINITY MAP FOR  
**DAVE M. THOMAS**  
 Showing well locations in sections  
 14, 15, 22 & 23, T23N, R3W, N.M.P.M.  
 Rio Arriba & Sandoval Counties,  
 New Mexico  
 DATE: Jan, 28, 1976    SCALE: 1" = 2000'  
 SAN JUAN ENGINEERING CO.  
 FARMINGTON, NEW MEXICO