

UNITED STATES
DEPARTMENT OF THE INTERIOR
GEOLOGICAL SURVEY

30-039-21283

APPLICATION FOR PERMIT TO DRILL, DEEPEN, OR PLUG BACK

1a. TYPE OF WORK

DRILL ☒DEEPEN ☐PLUG BACK ☐

b. TYPE OF WELL

OIL
WELL ☒GAS
WELL ☐OTHER ☐SINGLE
ZONE ☒MULTIPLE
ZONE ☐

2. NAME OF OPERATOR

Mobil Oil Corporation

3. ADDRESS OF OPERATOR

3 Greenway Plaza East, Suite 800, Houston, Texas 77046

4. LOCATION OF WELL (Report location clearly and in accordance with any State requirements.)*

At surface

330' FSL & 330' FWL Sec. 13, T23N, R3W

At proposed prod. zone

Same as surface

11. DISTANCE IN MILES AND DIRECTION FROM NEAREST TOWN OR POST OFFICE*

10. DISTANCE FROM PROPOSED*

LOCATION TO NEAREST
PROPERTY OR LEASE LINE, FT.
(Also to nearest drlg. unit line, if any)18. DISTANCE FROM PROPOSED LOCATION*
TO NEAREST WELL, DRILLING, COMPLETED,
OR APPLIED FOR, ON THIS LEASE, FT.

21. ELEVATIONS (Show whether DF, RT, GR, etc.)

7379 - Ground

23.

PROPOSED CASING AND CEMENTING PROGRAM

SIZE OF HOLE	SIZE OF CASING	WEIGHT PER FOOT	SETTING DEPTH	QUANTITY OF CEMENT
14-3/4"	10-3/4"	32.75#-H-40	0-300'	(1) Circulate to surface
9-1/2"	7-5/8"	26.4#-K-55	0-3200'	(2) Circulate to surface
6-1/2"	4-1/2"	10.5#-K-55	0-7650'	(3) Above pay zones

CEMENTING PROGRAM

- (1) Class A cement W/2% CaCl₂
- (2) Light weight slurry, tailed in with Class C Neat
- (3) Circulate in two stages with Class "C" cement to cover pay zones
tail in with Class C Neat

MUD PROGRAM

Depth	Type of Mud	Weight	Viscosity	PH
0-300'	Spud Mud	No Control		
300-3900'	Low Solids Fresh Water Gel	8.6-10.0	30-55	9+

BLOWOUT PREVENTER PROGRAM ATTACHED

IN ABOVE SPACE DESCRIBE PROPOSED PROGRAM: If proposal is to deepen or plug back, give data on present productive zone and proposed new productive zone. If proposal is to drill or deepen directionally, give pertinent data on subsurface locations and measured and true vertical depths. Give blowout preventer program, if any.

24.

SIGNED

A. D. Bond

A.D. Bond

TITLE

Regulatory
Engineering Coordinator

DATE 8-31-76

(This space for Federal or State office use)

PERMIT NO.

APPROVAL DATE

APPROVED BY

TITLE

DATE

CONDITIONS OF APPROVAL, IF ANY:

ok

*See Instructions On Reverse Side

5. LEASE DESIGNATION AND SERIAL NO.

6. IF INDIAN, ALLOTTEE OR TRIBE NAME

Jicarilla Contract #168

7. UNIT AGREEMENT NAME

8. FARM OR LEASE NAME

Jicarilla "M"

9. WELL NO.

1

10. FIELD AND POOL, OR WILDCAT

Chacon-Dakota *ext*11. SEC., T., R., M., OR B.L.K.
AND SURVEY OR AREA

Sec. 13, T23N, R3W

12. COUNTY OR PARISH

13. STATE

Rio Arriba

New Mexico

16. NO. OF ACRES IN LEASE

1920

17. NO. OF ACRES ASSIGNED
TO THIS WELL

80

19. PROPOSED DEPTH

7650

20. ROTARY OR CABLE TOOLS

Rotary

22. APPROX. DATE WORK WILL START*

As soon as possible

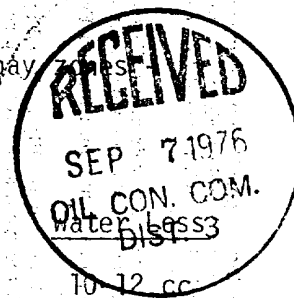

NEW MEXICO OIL CONSERVATION COMMISSION
WELL LOCATION AND ACREAGE DEDICATION PLAT

Form C-102
Supersedes C-123
Effective 1-1-65

All distances must be from the outer boundaries of the Section.

Operator Mobil Oil Corporation			Lease Jicarilla "M"		Well No. 1
Unit Letter M	Section 13	Township 23N	Range 3W	County Rio Arriba	
Actual Footage Location of Well: 330 feet from the South line and 330 feet from the West line					
Ground Level Elev. 7379	Producing Formation Dakota	Pool Chacon-Dakota ex		Dedicated Acreage: 80 Acres	

1. Outline the acreage dedicated to the subject well by colored pencil or hatchure marks on the plat below.
2. If more than one lease is dedicated to the well, outline each and identify the ownership thereof (both as to working interest and royalty).
3. If more than one lease of different ownership is dedicated to the well, have the interests of all owners been consolidated by communitization, unitization, force-pooling, etc?

☐ Yes ☐ No If answer is "yes," type of consolidation _____

If answer is "no," list the owners and tract descriptions which have actually been consolidated. (Use reverse side of this form if necessary.) _____

No allowable will be assigned to the well until all interests have been consolidated (by communitization, unitization, forced-pooling, or otherwise) or until a non-standard unit, eliminating such interests, has been approved by the Commission.

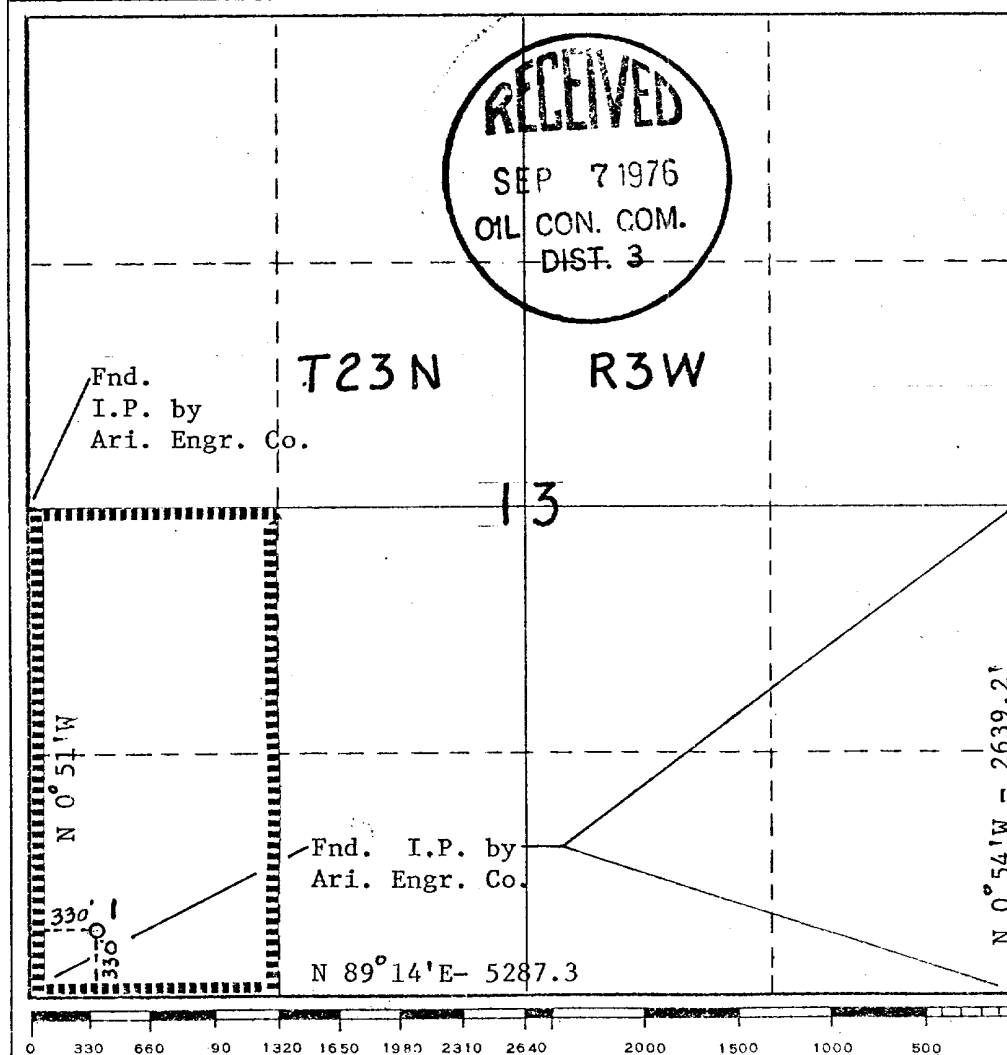

CERTIFICATION

I hereby certify that the information contained herein is true and complete to the best of my knowledge and belief.

W. B. Simmons, Jr.
Name

W. B. Simmons, Jr.

Position
Engineering Specialist

Company
Mobil Oil Corporation

Date
August 27, 1976

I hereby certify that the well location shown on this plat was plotted from field notes of actual surveys made by me or under my supervision, and that the same is true and correct to the best of my knowledge and belief.

J. F. Godfrey, Jr.
Date Surveyed

July 26, 1976
Registered Professional Engineer
and/or Land Surveyor

J. F. Godfrey, Jr.
Certificate No.

2663

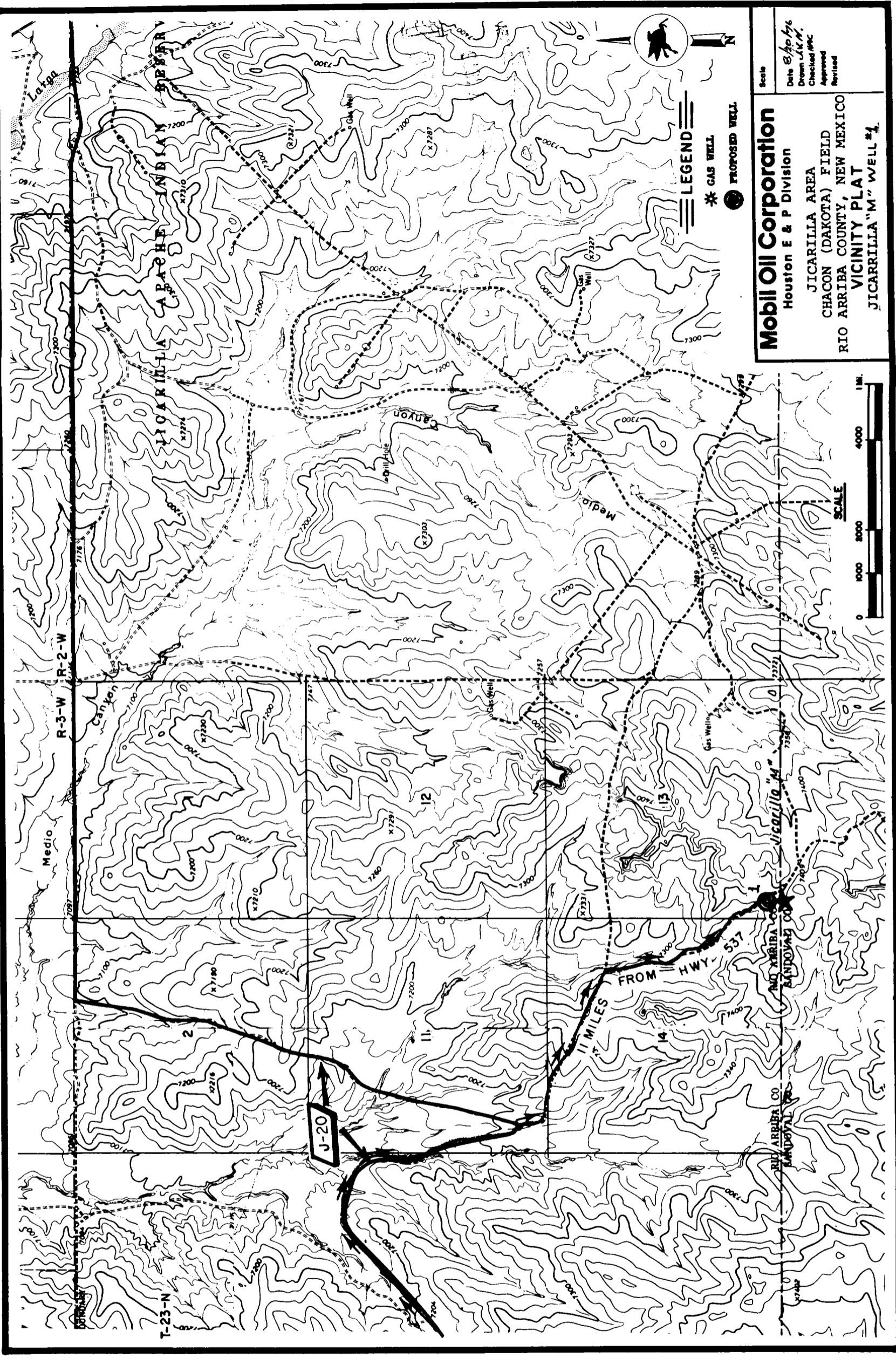

LEGEND

- * GAS WELL
- PROPOSED WELL

Mobil Oil Corporation

Houston E & P Division
JICARRILLA AREA
CHACON (DAKOTA) FIELD
RIO ARriba COUNTY, NEW MEXICO
VICINITY PLAT
JICARRILLA "M" WELL #1

Scale
Date 8/20/76
Drawn J.M.M.
Checked J.M.C.
Approved
Revised

