

UNITED STATES
DEPARTMENT OF THE INTERIOR
GEOLOGICAL SURVEY

SUBMIT IN TRIPPLICATE*
(Other instructions on re-verse side)

Form approved.
Budget Bureau No. 42-B1424.

SUNDRY NOTICES AND REPORTS ON WELLS

(Do not use this form for proposals to drill or to deepen or plug back to a different reservoir. Use "APPLICATION FOR PERMIT—" for such proposals.)

1. OIL WELL <input checked="" type="checkbox"/> GAS WELL <input type="checkbox"/> OTHER <input type="checkbox"/>		5. LEASE DESIGNATION AND SERIAL NO.
2. NAME OF OPERATOR Odessa Natural Corporation		6. IF INDIAN, ALLOTTEE OR TRIBE NAME Jicarilla Apache
3. ADDRESS OF OPERATOR P. O. Box 3908, Odessa, Texas 79760		7. UNIT AGREEMENT NAME
4. LOCATION OF WELL (Report location clearly and in accordance with any State requirements.* See also space 17 below.) At surface 990'FSL, 800'FEL		8. FARM OR LEASE NAME Jicarilla Joint Venture "KD"
14. PERMIT NO.		9. WELL NO. 1
15. ELEVATIONS (Show whether DF, RT, GR, etc.) 7296'GL, 7309'DF, 7310'KB		10. FIELD AND POOL OR WILDCAT Chacon Dakota Associated Oil Pool
		11. SEC., T., R., M., OR BLK. AND SURVEY OR AREA Sec. 4-T23N-R3W N.M.P.M.
		12. COUNTY OR PARISH Rio Arriba
		13. STATE N.M.

18. Check Appropriate Box To Indicate Nature of Notice, Report, or Other Data

NOTICE OF INTENTION TO:

TEST WATER SHUT-OFF ☐
FRACTURE TREAT ☐
SHOOT OR ACIDIZE ☐
REPAIR WELL ☐
(Other) ☐

PULL OR ALTER CASING ☐
MULTIPLE COMPLETE ☐
ABANDON* ☐
CHANGE PLANS ☐

SUBSEQUENT REPORT OF:

WATER SHUT-OFF ☐
FRACTURE TREATMENT ☐
SHOOTING OR ACIDIZING ☐

REPAIRING WELL ☐
ALTERING CASING ☐
ABANDONMENT* ☐

(Other) Change in Acreage Dedication ☒
(NOTE: Report results of multiple completion on Well Completion or Recompletion Report and Log form.)

17. DESCRIBE PROPOSED OR COMPLETED OPERATIONS (Clearly state all pertinent details, and give pertinent dates, including estimated date of starting any proposed work. If well is directionally drilled, give subsurface locations and measured and true vertical depths for all markers and zones pertinent to this work.)*

Change Acreage Dedication:

From: SE/4 Section 4-T23N-R3W, 160 Acres
To: S/2 Section 5-T23N-R3W, 320 Acres.

FOR: Odessa Natural Corporation

18. I hereby certify that the foregoing is true and correct

SIGNED Ewell N. Walsh, P.E.

President, Walsh Engr. & Production Corp.

DATE 6-26-78

(This space for Federal or State office use)

APPROVED BY _____
CONDITIONS OF APPROVAL, IF ANY:

TITLE _____

DATE _____

*See Instructions on Reverse Side



**NEW MEXICO OIL CONSERVATION COMMISSION
WELL LOCATION AND ACREAGE DEDICATION PLAT**

Form C-102
Supersedes C-101
Effective 1-1-78

All distances must be from the outer boundaries of the Section

Operator Odessa Natural Corporation			Lease Jicarilla Joint Ventures "JD" Lease		Well No. 1
Unit Letter P	Section 4	Township 23N	Range 3W	County Rio Arriba	
Actual Footage Location of Well: 990 feet from the South line and 800 feet from the East line					
Ground Level Elev. 7296	Producing Formation Dakota	Pool Chacon Dakota Associated		Dedicated Acreage: 320 Acres	

1. Outline the acreage dedicated to the subject well by colored pencil or hatchure marks on the plat below.
2. If more than one lease is dedicated to the well, outline each and identify the ownership thereof (both as to working interest and royalty).
3. If more than one lease of different ownership is dedicated to the well, have the interests of all owners been consolidated by communitization, unitization, force-pooling, etc?

☐ Yes ☐ No If answer is "yes," type of consolidation _____

If answer is "no," list the owners and tract descriptions which have actually been consolidated. (Use reverse side of this form if necessary.) _____

No allowable will be assigned to the well until all interests have been consolidated (by communitization, unitization, forced-pooling, or otherwise) or until a non-standard unit, eliminating such interests, has been approved by the Commission.

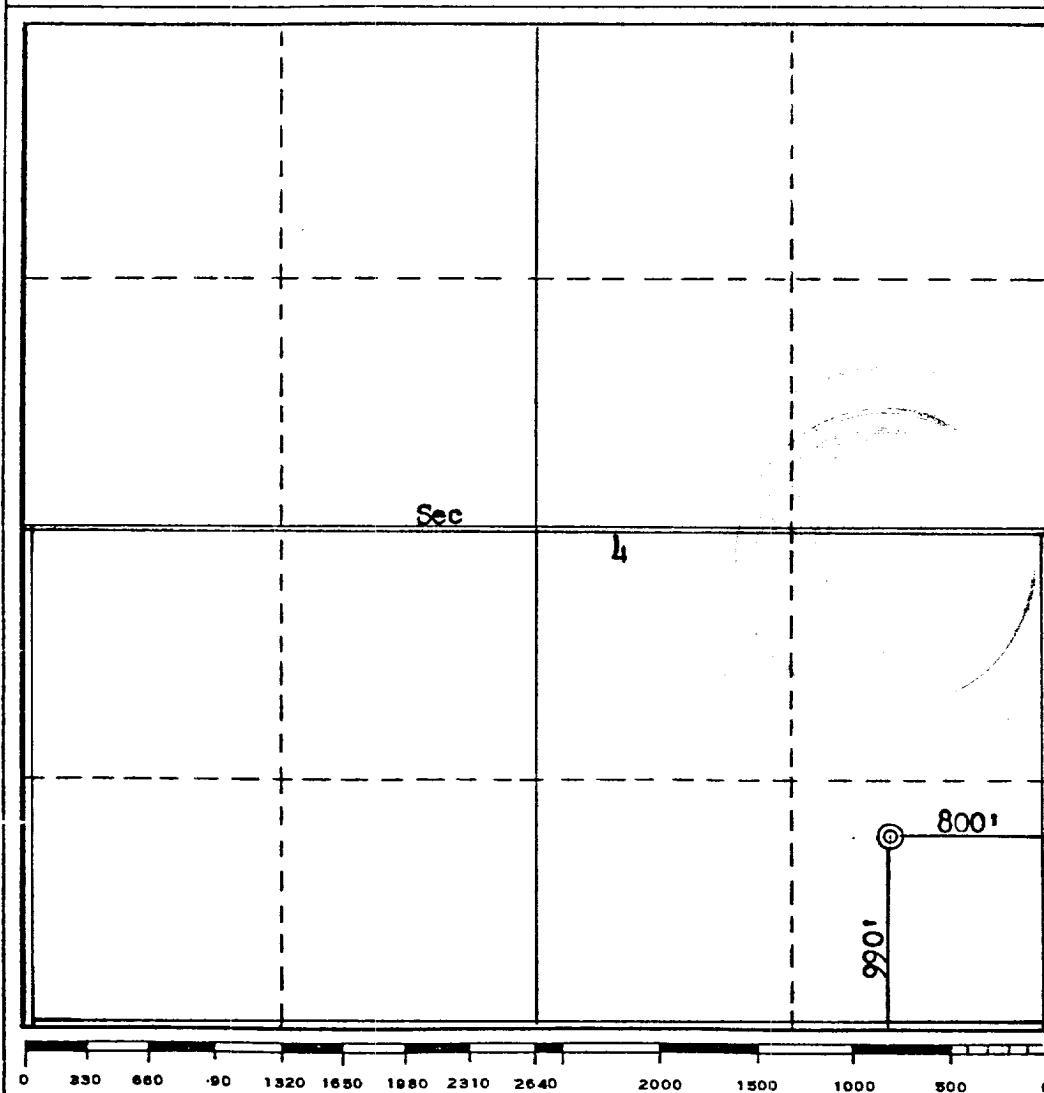

CERTIFICATION	
I hereby certify that the information contained herein is true and complete to the best of my knowledge and belief.	
FOR: Odessa Natural Corp.	
Name	Ewell N. Walsh, P. E.
Position	President, Walsh Engr.
Company	& Production Corp.
Date	6-26-78
I hereby certify that the well location shown on this plat was plotted from field notes of actual surveys made by me or under my supervision, and that the same is true and correct to the best of my knowledge and belief.	
Date Surveyed	May 10, 1977
Registered Professional Engineer and/or Land Surveyor	
Fred B. Kerr Jr.	
Certificate No.	3950