

UNITED STATES  
DEPARTMENT OF THE INTERIOR  
GEOLOGICAL SURVEY

SUBMIT IN TRIPPLICATE\*  
(Other instructions on re-  
verse side)

Form approved.  
Budget Bureau No. 42-R1424

SUNDRY NOTICES AND REPORTS ON WELLS

(Do not use this form for proposals to drill or to deepen or plug back to a different reservoir.  
Use "APPLICATION FOR PERMIT—" for such proposals.)

1. OIL WELL <input checked="" type="checkbox"/> GAS WELL <input type="checkbox"/> OTHER <input type="checkbox"/>		5. LEASE DESIGNATION AND SERIAL NO. Jicarilla Joint Venture "KD"
2. NAME OF OPERATOR ODESSA NATURAL CORPORATION ATTN: John Strojek		6. IF INDIAN, ALLOTTEE OR TRIBE NAME Jicarilla Apache
3. ADDRESS OF OPERATOR P. O. Box 3908 Odessa, Texas 79760		7. UNIT AGREEMENT NAME
4. LOCATION OF WELL (Report location clearly and in accordance with any State requirements.* See also space 17 below.) At surface 2310'FNL, 2310'FWL		8. FARM OR LEASE NAME Jicarilla Joint Venture "KD"
14. PERMIT NO.		9. WELL NO. 4
15. ELEVATIONS (Show whether DF, RT, GR, etc.) 7200'GR, 7213'DF, 7214'KB		10. FIELD AND POOL, OR WILDCAT Chacon Dakota Associated
		11. SEC., T., R., M., OR BLK. AND SURVEY OR AREA Sec. 4-T23N-R3W N.M.P.M.
		12. COUNTY OR PARISH Rio Arriba
		13. STATE N.M.

16. Check Appropriate Box To Indicate Nature of Notice, Report, or Other Data

NOTICE OF INTENTION TO:

TEST WATER SHUT-OFF <input type="checkbox"/>	PULL OR ALTER CASING <input type="checkbox"/>
FRACTURE TREAT <input type="checkbox"/>	MULTIPLE COMPLETE <input type="checkbox"/>
SHOOT OR ACIDIZE <input type="checkbox"/>	ABANDON* <input type="checkbox"/>
REPAIR WELL <input type="checkbox"/>	CHANGE PLANS <input type="checkbox"/>
(Other) <input type="checkbox"/>	

SUBSEQUENT REPORT OF:

WATER SHUT-OFF <input type="checkbox"/>	REPAIRING WELL <input type="checkbox"/>
FRACTURE TREATMENT <input type="checkbox"/>	ALTERING CASING <input type="checkbox"/>
SHOOTING OR ACIDIZING <input type="checkbox"/>	ABANDONMENT* <input type="checkbox"/>
(Other) Acreage Dedication Change <input checked="" type="checkbox"/>	

(NOTE: Report results of multiple completion on Well Completion or Recompletion Report and Log form.)

17. DESCRIBE PROPOSED OR COMPLETED OPERATIONS (Clearly state all pertinent details, and give pertinent dates, including estimated date of starting any proposed work. If well is directionally drilled, give subsurface locations and measured and true vertical depths for all markers and zones pertinent to this work.)\*

Change in Acreage Dedication

From: N/2 Sec. 4-T23N-R3W  
302.08 Acres

TO: NW/4 Sec. 4-T23N-R3W  
150.72 Acres

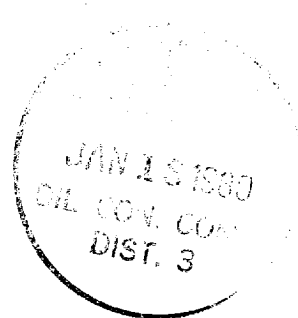

FOR: ODESSA NATURAL CORPORATION

18. I hereby certify that the foregoing is true and correct  
SIGNED EWELL N. WALSH TITLE President, Walsh Engineering & Prod. Corp. DATE 1/14/80  
Ewell N. Walsh, P.E.  
(This space for Federal or State office use)

APPROVED BY \_\_\_\_\_ TITLE \_\_\_\_\_ DATE \_\_\_\_\_  
CONDITIONS OF APPROVAL, IF ANY:

ACCEPTED FOR RECORD

JAN 17 '80

\*See Instructions on Reverse Side

JAN 15 1980

U. S. GEOLOGICAL SURVEY  
DURANGO, COLO.

**NEW MEXICO OIL CONSERVATION COMMISSION  
WELL LOCATION AND ACREAGE DEDICATION PLAT**

Form C-102  
Supersedes C-1, 2  
Effective 1-1-65

All distances must be from the outer boundaries of the Section.

Operator <b>Odessa Natural Corporation</b>			Lease <b>Jicarilla Joint Venture "KD" Lease</b>		Well No. <b>4</b>
Unit Letter <b>F</b>	Section <b>4</b>	Township <b>23N</b>	Range <b>3W</b>	County <b>Rio Arriba</b>	
Actual Footage Location of Well: <b>2310</b> feet from the <b>North</b> line and <b>2310</b> feet from the <b>West</b> line					
Ground Level Elev. <b>7200</b>	Producing Formation <b>Dakota</b>		Pool <b>Chacon Dakota Associated</b>		Dedicated Acreage: <b>150.72</b> Acres

1. Outline the acreage dedicated to the subject well by colored pencil or hachure marks on the plat below.
2. If more than one lease is dedicated to the well, outline each and identify the ownership thereof (both as to working interest and royalty).
3. If more than one lease of different ownership is dedicated to the well, have the interests of all owners been consolidated by communitization, unitization, force-pooling, etc?

☐ Yes    ☐ No    If answer is "yes," type of consolidation \_\_\_\_\_

If answer is "no," list the owners and tract descriptions which have actually been consolidated. (Use reverse side of this form if necessary.) \_\_\_\_\_

No allowable will be assigned to the well until all interests have been consolidated (by communitization, unitization, forced-pooling, or otherwise) or until a non-standard unit, eliminating such interests, has been approved by the Commission.

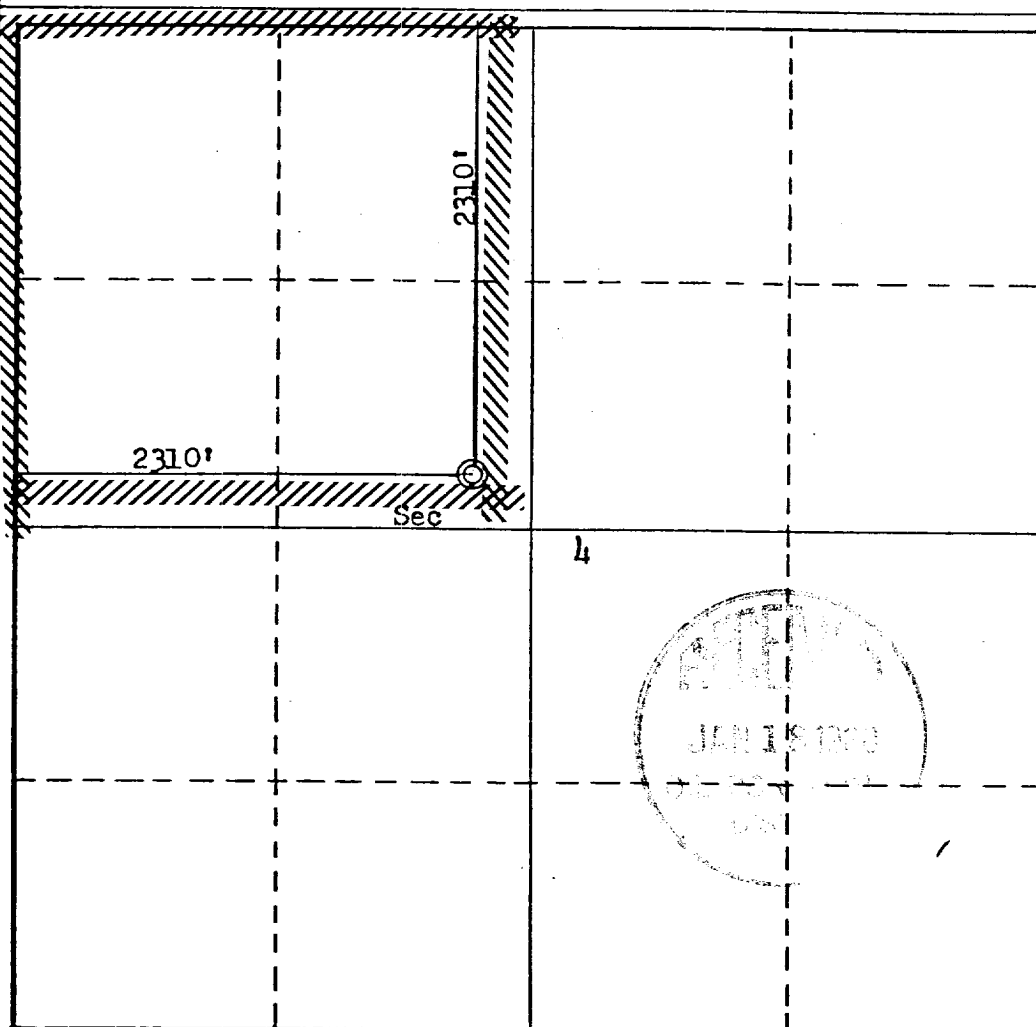

**CERTIFICATION**

*I hereby certify that the information contained herein is true and complete to the best of my knowledge and belief.*

FOR: **ODESSA NATURAL CORPORATION**

Name	<b>ORIGINAL SIGNED BY EWELL N. WALSH</b>
Position	<b>Ewell N. Walsh, P.E. President</b>
Company	<b>Walsh Engineering &amp; Production Corp.</b>
Date	<b>1/14/80</b>

*I hereby certify that the well location shown on this plat was plotted from field notes of actual surveys made by me or under my supervision, and that the same is true and correct to the best of my knowledge and belief.*

Date Surveyed	<b>March 29, 1977</b>
Registered Professional Engineer and/or Land Surveyor	<i>Fred B. Kerr Jr.</i> <b>Fred B. Kerr Jr.</b>
Certificate No.	<b>3950</b>

