

UNITED STATES  
DEPARTMENT OF THE INTERIOR  
GEOLOGICAL SURVEY

SUNDRY NOTICES AND REPORTS ON WELLS

(Do not use this form for proposals to drill or to deepen or plug back to a different reservoir. Use Form 9-331-C for such proposals.)

1. oil well ☐ gas well ☒ other ☐  
2. NAME OF OPERATOR  
El Paso Exploration Company  
3. ADDRESS OF OPERATOR  
PO Box 4289, Farmington, NM 87499  
4. LOCATION OF WELL (REPORT LOCATION CLEARLY. See space 17 below.)  
1650'S, 1850'W  
AT SURFACE:  
AT TOP PROD. INTERVAL:  
AT TOTAL DEPTH:

16. CHECK APPROPRIATE BOX TO INDICATE NATURE OF NOTICE, REPORT, OR OTHER DATA

REQUEST FOR APPROVAL TO:

TEST WATER SHUT-OFF ☐  
FRACTURE TREAT ☐  
SHOOT OR ACIDIZE ☐  
REPAIR WELL ☐  
PULL OR ALTER CASING ☐  
MULTIPLE COMPLETE ☐  
CHANGE ZONES ☐  
ABANDON\* ☐  
(other) ☐

SUBSEQUENT REPORT OF:

☐  
☐  
☐  
☐  
☐  
☐  
☐  
☐  
☐  
☐

Change Dedication

5. LEASE  
Jicarilla Jt. Venture  
6. IF INDIAN, ALLOTTEE OR TRIBE NAME  
Jicarilla Apache  
7. UNIT AGREEMENT NAME  
8. FARM OR LEASE NAME  
Jicarilla Jt. Venture "KD"  
9. WELL NO.  
8  
10. FIELD OR WILDCAT NAME  
Chacon Dakota Associated Pool  
11. SEC., T., R., M., OR BLK. AND SURVEY OR AREA  
Section 4, T-23-N, R-3-W, NMPM  
12. COUNTY OR PARISH  
Rio Arriba  
13. STATE  
NM  
14. API NO.  
15. ELEVATIONS (SHOW DF, KDB, AND WD)  
2201' GL

RECEIVED  
APR 21 1983

(NOTE: Report results of multiple completion or zone change on Form 9-330.)  
U. S. GEOLOGICAL SURVEY  
FARMINGTON, N. M.

17. DESCRIBE PROPOSED OR COMPLETED OPERATIONS (Clearly state all pertinent details, and give pertinent dates, including estimated date of starting any proposed work. If well is directionally drilled, give subsurface locations and measured and true vertical depths for all markers and zones pertinent to this work.)\*

Attached is a revised C-102 in order to comply with the New Mexico Oil Conservation Division pool rules for the Chacon Dakota Associated Pool. Note the acreage dedication change from the SW/4 to the S/2.

Subsurface Safety Valve Manu. and Type \_\_\_\_\_ Set @ \_\_\_\_\_ Ft.

18. I hereby certify that the foregoing is true and correct

SIGNED Larry W. Smith TITLE Project Drilling Engineer DATE April 19, 1983

(This space for Federal or State office use)

APPROVED BY \_\_\_\_\_ TITLE \_\_\_\_\_ DATE \_\_\_\_\_  
CONDITIONS OF APPROVAL, IF ANY:

\*See Instructions on Reverse Side

APR 26 1983

JAC

NMOCC

All distances must be from the outer boundaries of the Section.

Operator EL PASO EXPLORATION COMPANY			Lease JICARILLA JOINT VENTURES "KDM"		Well No. 8
Unit Letter K	Section 4	Township 23N	Range 3W	County Rio Arriba	
Actual Footage Location of Well:					
1650 feet from the South		line and 1850		feet from the West line	
Ground Level Elev. 7201	Producing Formation Dakota	Pool Chacon Dakota Associated		Dedicated Acreage: 320 Acres	

1. Outline the acreage dedicated to the subject well by colored pencil or hachure marks on the plat below.
2. If more than one lease is dedicated to the well, outline each and identify the ownership thereof (both as to working interest and royalty).
3. If more than one lease of different ownership is dedicated to the well, have the interests of all owners been consolidated by communitization, unitization, force-pooling, etc?

☐ Yes ☐ No If answer is "yes," type of consolidation \_\_\_\_\_

If answer is "no," list the owners and tract descriptions which have actually been consolidated. (Use reverse side of this form if necessary.) \_\_\_\_\_

No allowable will be assigned to the well until all interests have been consolidated (by communitization, unitization, forced-pooling, or otherwise) or until a non-standard unit, eliminating such interests, has been approved by the Commission. REISSUED TO SHOW OPERATOR & DEDICATION CHANGE 4/18/83

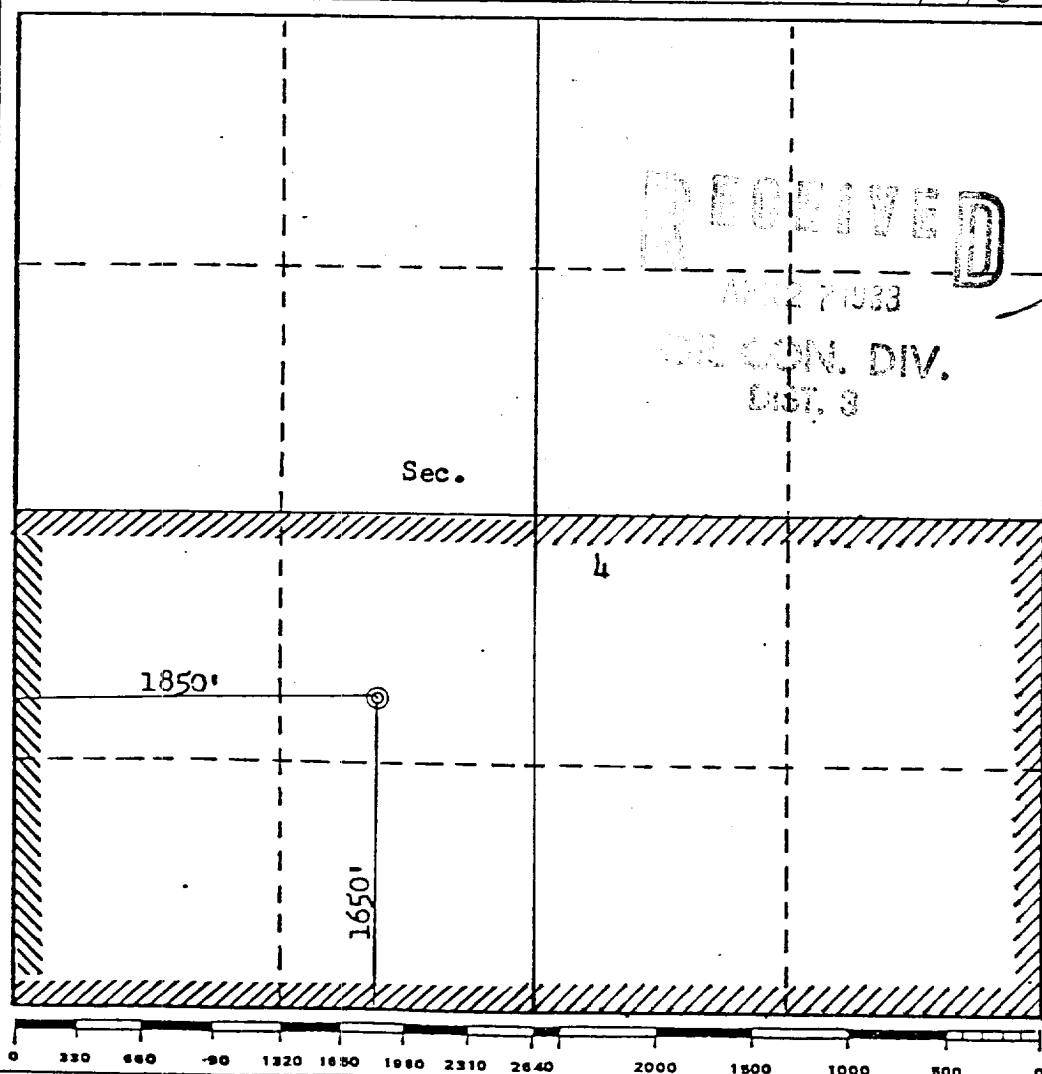

CERTIFICATION

I hereby certify that the information contained herein is true and complete to the best of my knowledge and belief.

*D. G. Guisco*

Name \_\_\_\_\_

Drilling Clerk

Position  
El Paso Exploration Co.

Company

April 21, 1983

Date

I hereby certify that the well location shown on this plat was plotted from field notes of actual surveys made by me or under my supervision, and that the same is true and correct to the best of my knowledge and belief.

Date Surveyed \_\_\_\_\_

August 10, 1983

Registered Professional Engineer and/or Land Surveyor

*Fred B. Kerr, Jr.*

Certificate No. 3950

3950