

UNITED STATES
DEPARTMENT OF THE INTERIOR
GEOLOGICAL SURVEY

30-039-22322

APPLICATION FOR PERMIT TO DRILL, DEEPEN, OR PLUG BACK

1a. TYPE OF WORK

DRILL ☒DEEPEN ☐PLUG BACK ☐

b. TYPE OF WELL

OIL
WELL ☒GAS
WELL ☐

OTHER

SINGLE
ZONE ☒MULTIPLE
ZONE ☐

2. NAME OF OPERATOR

Grace Petroleum Corporation

3. ADDRESS OF OPERATOR

3 Park Central Suite 200 1515 Arapahoe Denver, Co. 80202

4. LOCATION OF WELL (Report location clearly and in accordance with any State requirements.)*

At surface

960' FNL, 1750' FWL

At proposed prod. zone

14. DISTANCE IN MILES AND DIRECTION FROM NEAREST TOWN OR POST OFFICE*

50 Miles SE of Bloomfield

15. DISTANCE FROM PROPOSED* 960' FNL, 1750' FWL
LOCATION TO NEAREST
PROPERTY OR LEASE LINE, FT.
(Also to nearest drlg. unit line, if any)16. NO. OF ACRES IN LEASE
2567.3717. NO. OF ACRES ASSIGNED
TO THIS WELL

8540

18. DISTANCE FROM PROPOSED LOCATION*
TO NEAREST WELL, DRILLING, COMPLETED,
OR APPLIED FOR, ON THIS LEASE, FT.19. PROPOSED DEPTH
543020. ROTARY OR CABLE TOOLS
Rotary

21. ELEVATIONS (Show whether DF, RT, GR, etc.)

6992 Ungraded Ground

22. APPROX. DATE WORK WILL START*

June, 1980

23.

PROPOSED CASING AND CEMENTING PROGRAM

SIZE OF HOLE	SIZE OF CASING	WEIGHT PER FOOT	SETTING DEPTH	QUANTITY OF CEMENT
12 1/2"	8-5/8"	24#	300'	CMT to Surface
7-7/8"	4 1/2"	10.5#	TD	300sx Class "G"

It is proposed to drill and test the Gallup formation at the above location. Total depth will be approximately 5430'.

A 4 1/2" production string will be run and cemented, or the well plugged and abandoned as per regulations, whichever test indicates.

See attached for pertinent data.

APPROVED

APR 4 1980

District Engineer

IN ABOVE SPACE DESCRIBE PROPOSED PROGRAM: If proposal is to deepen or plug back, give data on present productive zone and proposed new productive zone. If proposal is to drill or deepen directionally, give pertinent data on subsurface locations and measured and true vertical depths. Give blowout preventer program, if any.

24.

SIGNED

Scotty G. Smith

TITLE

Southern District
Operations Manager

(This space for Federal or State office use)

PERMIT NO.

APPROVAL DATE

APPROVED BY

CONDITIONS OF APPROVAL, IF ANY:

TITLE

DRILLING OPERATIONS AUTHORIZED ARE
SUBJECT TO COMPLIANCE WITH ATTACHED
"GENERAL REQUIREMENTS"

*See Instructions On Reverse Side

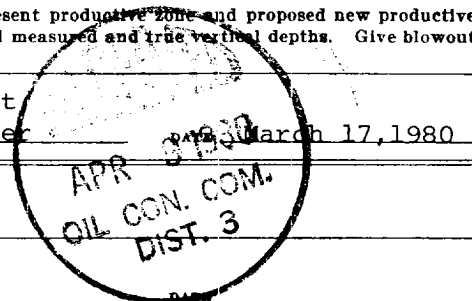

APR 17 1980

OIL CONSERVATION DIVISION

P. O. BOX 2088

Form C-107
Revised 10-1-78STATE OF NEW MEXICO
ENERGY AND MINERALS DEPARTMENT

SANTA FE, NEW MEXICO 87501

All distances must be from the outer boundaries of the Section

Operator GRACE PETROLEUM CORPORATION			Lease VANDENBURGH		Well No. 2
Unit Letter C	Section 11	Township 23N	Range 7W	County RIO ARriba	
Actual Footage Location of Well: 960 feet from the North line and 1750 feet from the West line					
Ground Level Elev. 6992	Producing Formation Gallup		Pool Lybrook		Dedicated Acreage: 80 70 Acres

1. Outline the acreage dedicated to the subject well by colored pencil or hachure marks on the plat below.
2. If more than one lease is dedicated to the well, outline each and identify the ownership thereof (both as to working interest and royalty). **Single Lease**
3. If more than one lease of different ownership is dedicated to the well, have the interests of all owners been consolidated by communitization, unitization, force-pooling, etc? **Single Lease**

☐ Yes ☐ No If answer is "yes," type of consolidation **N/A**If answer is "no," list the owners and tract descriptions which have actually been consolidated. (Use reverse side of this form if necessary.) **N/A**

No allowable will be assigned to the well until all interests have been consolidated (by communitization, unitization, forced-pooling, or otherwise) or until a non-standard unit, eliminating such interests, has been approved by the Commission.

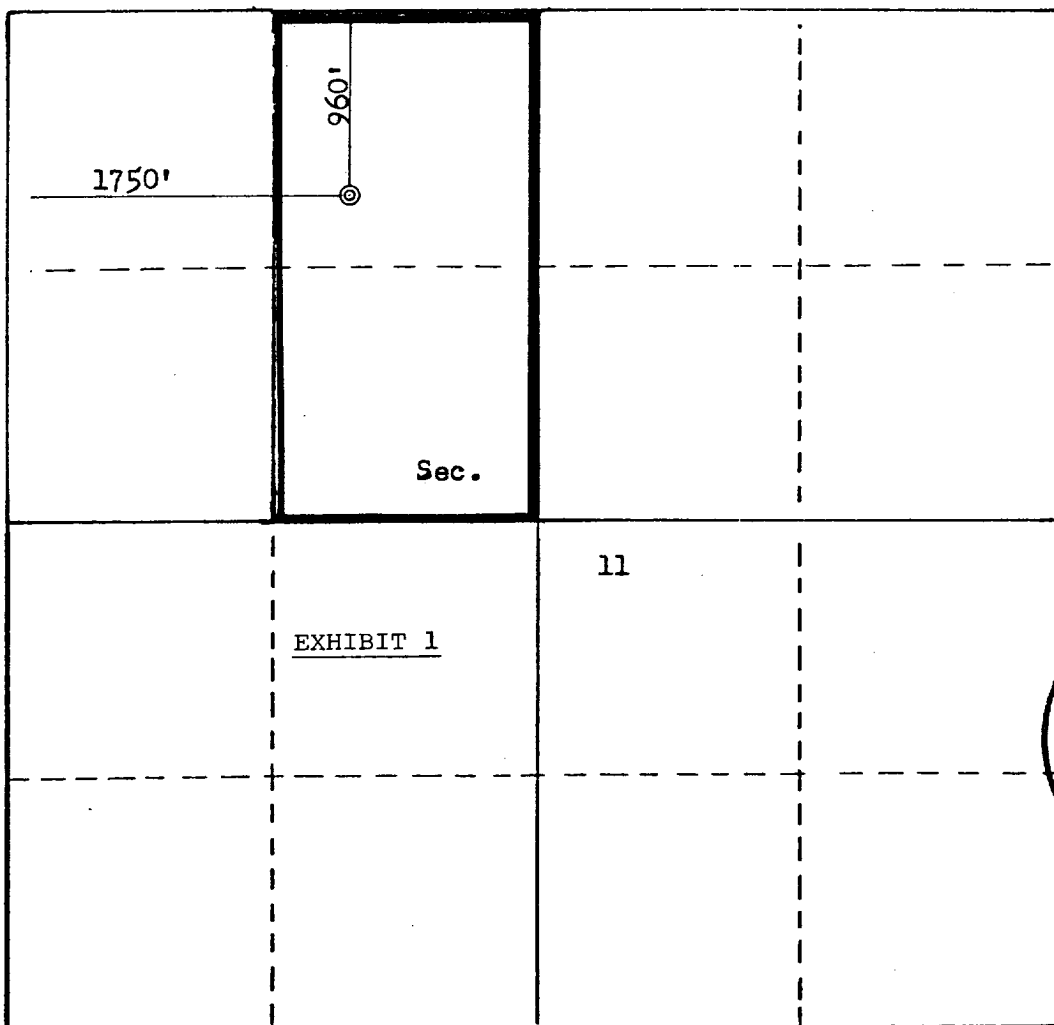

CERTIFICATION

I hereby certify that the information contained herein is true and complete to the best of my knowledge and belief.

Name

Scotty A. Smith

Position

**Southern District
Operations Manager**

Company

Grace Petroleum Corporation

Date

March 14, 1980

I hereby certify that the well location shown on this plat was plotted from field notes of actual surveys made by me or under my supervision, and that the same is true and correct to the best of my knowledge and belief.

Date Surveyed

Registered Professional Engineer
and/or Land Surveyor**Fred B. Kerr, Jr.**Certificate No. **3950**

