

UNITED STATES  
DEPARTMENT OF THE INTERIOR  
GEOLOGICAL SURVEY30-039-22599  
3. TRASE DESIGNATION AND SERIAL NO.  
121 23050

## APPLICATION FOR PERMIT TO DRILL, DEEPEN, OR PLUG BACK

1a. TYPE OF WORK

DRILL ☒DEEPEN ☐PLUG BACK ☐

b. TYPE OF WELL

OIL  
WELL ☒GAS  
WELL ☐OTHER ☐SINGLE  
ZONE ☐MULTIPLE  
ZONE ☐

2. NAME OF OPERATOR

MESA PETROLEUM CO.

3. ADDRESS OF OPERATOR

1660 Lincoln, 2800 Lincoln Center, Denver, Colorado 80264

4. LOCATION OF WELL Report location clearly and in accordance with any State requirements.\*  
At surface

1740'N &amp; 330'E

At proposed prod. zone

SAME

14. DISTANCE IN MILES AND DIRECTION FROM NEAREST TOWN OR POST OFFICE\*

15. DISTANCE FROM PROPOSED\*

LOCATION TO NEAREST  
PROPERTY OR LEASE LINE, FT.  
(Also to nearest drlg. unit line, if any.)

16. NO. OF ACRES IN LEASE

241.26

17. NO. OF ACRES ASSIGNED  
TO THIS WELL

40

18. DISTANCE FROM PROPOSED LOCATION\*  
TO NEAREST WELL DRILLING, COMPLETED,  
OR APPLIED FOR, ON THIS LEASE, FT.

19. PROPOSED DEPTH

5750

20. ROTARY OR CABLE TOOLS

ROTARY

21. ELEVATIONS (Show whether DF, RT, GR, etc.)

7008 GL

22. APPROX. DATE WORK WILL START\*

December 20, 1980

## 23. PROPOSED CASING AND CEMENTING PROGRAM

SIZE OF HOLE	SIZE OF CASING	WEIGHT PER FOOT	SETTING DEPTH	QUANTITY OF CEMENT
12 1/4	8 5/8	24	250	250 sks
7 7/8	4 1/2	10.5	5750	950 sks

This section is subject to administrative  
approval pursuant to 30 CFR 250.  
(SEE ATTACHMENTS)

GAS UNDER THIS LEASE IS NOT DEDICATED TO A CONTRACT

DRILLING OPERATIONS AUTHORIZED ARE  
SUBJECT TO OIL LEASE WITH ATTACHED  
"GENERAL AND SPECIALS"

IN ABOVE SPACE DESCRIBE PROPOSED PROGRAM: If proposal is to deepen or plug back, give data on present productive zone and proposed new productive zone. If proposal is to drill or deepen directionally, give pertinent data on subsurface locations and measured and true vertical depths. Give blowout preventer program, if any.

24.

SIGNED

*John Alexander*

TITLE AGENT

DATE December 20, 1980

(This space for Federal or State office use)

PERMIT NO.

APPROVAL DATE

APPROVED BY

*Bill Wamsley*

TITLE

DATE

CONDITIONS OF APPROVAL, IF ANY: 1. 2. 3.

DIST. OF ENGINEER

111000

*ok 3m*

## OIL CONSERVATION DIVISION

P. O. BOX 2388

SANTA FE, NEW MEXICO 87501

Form C-107  
Revised 10-1-78

STATE OF NEW MEXICO

OIL AND MINERALS DEPARTMENT

All distances must be from the outer boundaries of the Section.

Owner MESA PETROLEUM COMPANY			Lease SOUTH BLANCO-FEDERAL 6		Well No. 3
Section Letter H	Section 6	Township 23N	Range 7W	County Rio Arriba	
Actual Footage Location of Well:					
1740 feet from the North		line end	330 feet from the East	line	
Land Level Elev. 7008	Producing Formation GALLUP	Pool LYBROOK GALLUP		Dedicated Acreage: 40 Acres	

1. Outline the acreage dedicated to the subject well by colored pencil or hatchure marks on the plat below.

2. If more than one lease is dedicated to the well, outline each and identify the ownership thereof (both as to working interest and royalty).

3. If more than one lease of different ownership is dedicated to the well, have the interests of all owners been consolidated by communitization, unitization, force-pooling, etc?

☐ Yes ☐ No If answer is "yes," type of consolidation \_\_\_\_\_

If answer is "no," list the owners and tract descriptions which have actually been consolidated. (Use reverse side of this form if necessary.) \_\_\_\_\_

No allowable will be assigned to the well until all interests have been consolidated (by communitization, unitization, forced-pooling, or otherwise) or until a non-standard unit, eliminating such interests, has been approved by the Commission.

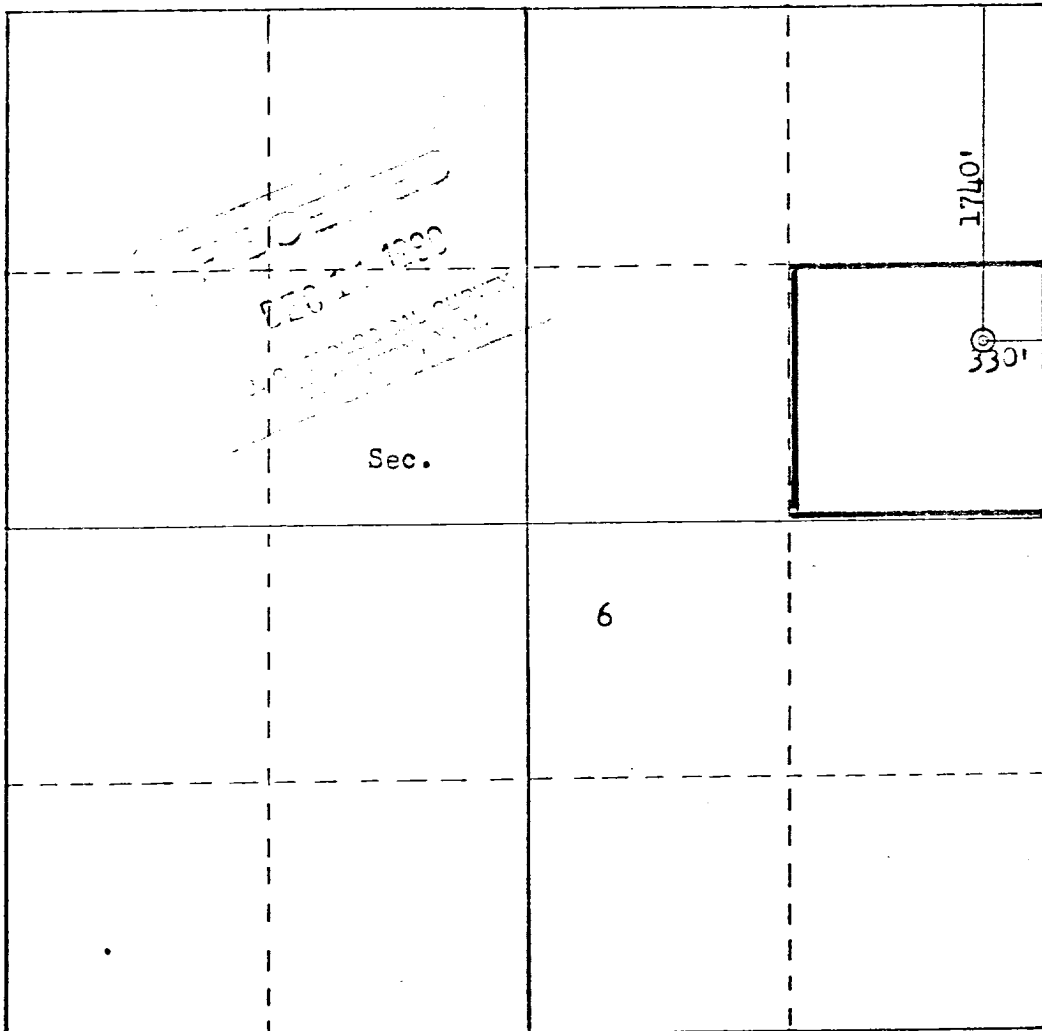

## CERTIFICATION

I hereby certify that the information contained herein is true and complete to the best of my knowledge and belief.

John Alexander

JOHN ALEXANDER

Position

AGENT

Company

MESA PETROLEUM CO.

Date

December 5, 1980

I hereby certify that the well location shown on this plat was plotted from field notes of actual surveys made by me or under my supervision and that the same is true and correct to the best of my knowledge and belief.

Date Surveyed

November 5, 1980

Registered Professional Engineer and Land Surveyor

Fred B. Kent Jr.

Certificate No.

3950 JR.

Scale: 1"=1000'