

UNITED STATES  
DEPARTMENT OF THE INTERIOR  
GEOLOGICAL SURVEY

## APPLICATION FOR PERMIT TO DRILL, DEEPEN, OR PLUG BACK

## 1a. TYPE OF WORK

DRILL ☒DEEPEN ☐PLUG BACK ☐

## b. TYPE OF WELL

OIL  
WELL ☐GAS  
WELL ☒

OTHER

SINGLE  
ZONE ☒MULTIPLE  
ZONE ☐

## 2. NAME OF OPERATOR

Petro-Lewis Corporation

## 3. ADDRESS OF OPERATOR

717 17th Street, Energy Center One, Denver, Colorado 80201

## 4. LOCATION OF WELL (Report location clearly and in accordance with any State requirements.)\*

At surface

1670' FSL &amp; 1600' FEL (NW SE)

At proposed prod. zone

same

## 14. DISTANCE IN MILES AND DIRECTION FROM NEAREST TOWN OR POST OFFICE\*

The location is 5 miles Northwest of Regina, New Mexico.

## 15. DISTANCE FROM PROPOSED\*

LOCATION TO NEAREST  
PROPERTY OR LEASE LINE, FT.  
(Also to nearest drlg. unit line, if any)

1600'

## 16. NO. OF ACRES IN LEASE

1892.65

17. NO. OF ACRES ASSIGNED  
TO THIS WELL

160

18. DISTANCE FROM PROPOSED LOCATION\*  
TO NEAREST WELL, DRILLING, COMPLETED,  
OR APPLIED FOR, ON THIS LEASE, FT.

---

## 19. PROPOSED DEPTH

3325'

## 20. ROTARY OR CABLE TOOLS

Rotary

## 21. ELEVATIONS (Show whether DF, RT, GR, etc.)

7394' GR

## 22. APPROX. DATE WORK WILL START\*

September 1, 1981

DRILLING OPERATIONS AUTHORIZED ARE

SUBJECT TO COMPLIANCE WITH ATTACHED

"GENERAL REQUIREMENTS"

PROPOSED CASING AND CEMENTING PROGRAM This action is subject to administrative

SIZE OF HOLE	SIZE OF CASING	WEIGHT PER FOOT	SETTING DEPTH	QUANTITY OF CEMENT
12 3/4"	8-5/8" New	24# K-55 ST&C	300'	225 sx Class A w/2% CaCl <sub>2</sub>
7-7/8"	4 1/2" New	10.5# K-55 ST&C	3325'	200 sx Class A w/4% gel; 200 sx Class A

1. Drill 12 3/4" hole and set 8-5/8" surface casing to 300' with good returns.
2. Log B.O.P. checks in daily drill reports and drill 7-7/8" hole to 3325'.
3. Run tests if warranted and run 4 1/2" casing if productive.
4. Run logs, as needed, and perforate and stimulate as needed.

## EXHIBITS ATTACHED:

"A" Location and Elevation Plat  
"B" The Ten-Point Compliance Program  
"C" The Blowout Preventer Diagram  
"D" The Multi-Point Requirements for A.P.D.  
"E" & "E<sub>1</sub>" Access Road Maps to Location  
"F" Radius Map of Field  
"G" & "G<sub>1</sub>" Drill Pad Layout, Proposed Pipeline & Cut-Fill Cross-Sections  
"H" Drill Rig Layout

IN ABOVE SPACE DESCRIBE PROPOSED PROGRAM: If proposal is to deepen or plug back, give data on present productive zone and proposed new productive zone. If proposal is to drill or deepen directionally, give pertinent data on subsurface locations and measured and true vertical depths. Give blowout preventer program, if any.

24.

SIGNED

*John L. Schmidt*

TITLE Senior Staff Production

Engineer

DATE August 10, 1981

(This space for Federal or State office use)

PERMIT NO.

APPROVAL DATE

APPROVED BY

TITLE

CONDITIONS OF APPROVAL, IF ANY:

*ah 7*

\*See Instructions On Reverse Side

NMOCC

30-039-22825

5. LEASE DESIGNATION AND SERIAL NO.

SF-080345

6. IF INDIAN, ALLOTTEE OR TRIBE NAME

N/A

7. UNIT AGREEMENT NAME

N/A

8. FARM OR LEASE NAME

Douthit Federal

9. WELL NO.

4

10. FIELD AND POOL, OR WILDCAT

Blanco Pictured Cliffs

11. SEC., T., R., M., OR BLK.  
AND SURVEY OR AREA

Sec. 4 T23N R1W

12. COUNTY OR PARISH

Rio Arriba

13. STATE

New Mexico

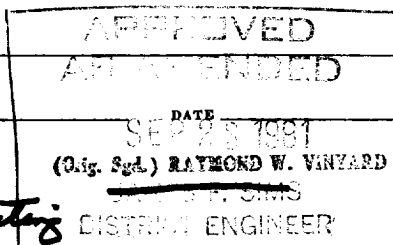

STATE OF NEW MEXICO  
ENERGY AND MINERALS DEPARTMENT

OIL CONSERVATION DIVISION  
P. O. BOX 2088  
SANTA FE, NEW MEXICO 87501

EXHIBIT "A"  
Location and Elevation Plat  
Form C-102  
Revised 10-1-72

All distances must be from the outer boundaries of the Section.

Operator <b>Petro-Lewis Corp.</b>		Lease <b>SF-080345</b>		Well No. <b>4-4</b> <b>PLC Douthit Federal</b>	
Unit Letter <b>J</b>	Section <b>4</b>	Township <b>23 North</b>	Range <b>1 West</b>	County <b>Rio Arriba</b>	
Actual Footage Location of Well: <b>1670</b> feet from the <b>South</b> line and <b>1600</b> feet from the <b>East</b> line					
Ground Level Elev. <b>7394'</b>	Producing Formation <b>Pictured Cliffs</b>		Pool <b>South Blanco Pictured Cliffs</b>	Dedicated Acreage: <b>160</b> Acres	

1. Outline the acreage dedicated to the subject well by colored pencil or hatchure marks on the plat below.
2. If more than one lease is dedicated to the well, outline each and identify the ownership thereof (both as to working interest and royalty).
3. If more than one lease of different ownership is dedicated to the well, have the interests of all owners been consolidated by communitization, unitization, force-pooling, etc? **N/A**

☐ Yes ☐ No If answer is "yes," type of consolidation \_\_\_\_\_

If answer is "no," list the owners and tract descriptions which have actually been consolidated. (Use reverse side of this form if necessary.) \_\_\_\_\_

No allowable will be assigned to the well until all interests have been consolidated (by communitization, unitization, forced-pooling, or otherwise) or until a non-standard unit, eliminating such interests, has been approved by the Division.

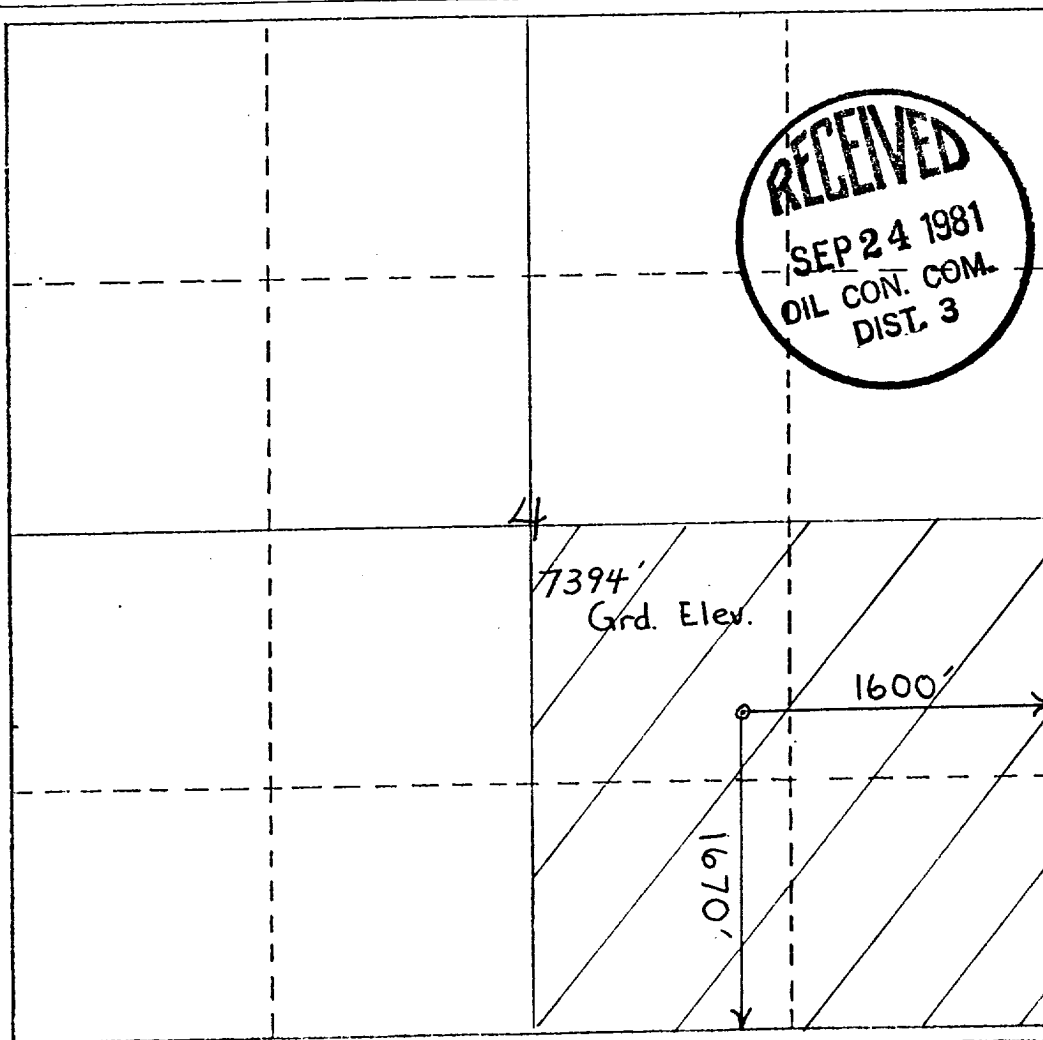

CERTIFICATION

I hereby certify that the information contained herein is true and complete to the best of my knowledge and belief.

*George Papaseotes*

Name **George Papaseotes**  
Position **President, Powers Elevation**

Agent Consultant for

Company **Petro-Lewis Corporation**

Date **August 10, 1981**

I hereby certify that the well location shown on this plat was plotted from field notes of actual surveys made by me or under my supervision, and that the same is true and correct to the best of my knowledge and belief.

**GERARD G. HUDDLES**  
Date Surveyed **SEP 10 1981**  
Registered Professional Engineer and/or Land Surveyor **8844**  
*Gerard G. Huddles*  
Certificate No. **8844**

EXHIBIT "E<sub>1</sub>"  
Detail of Access Roads

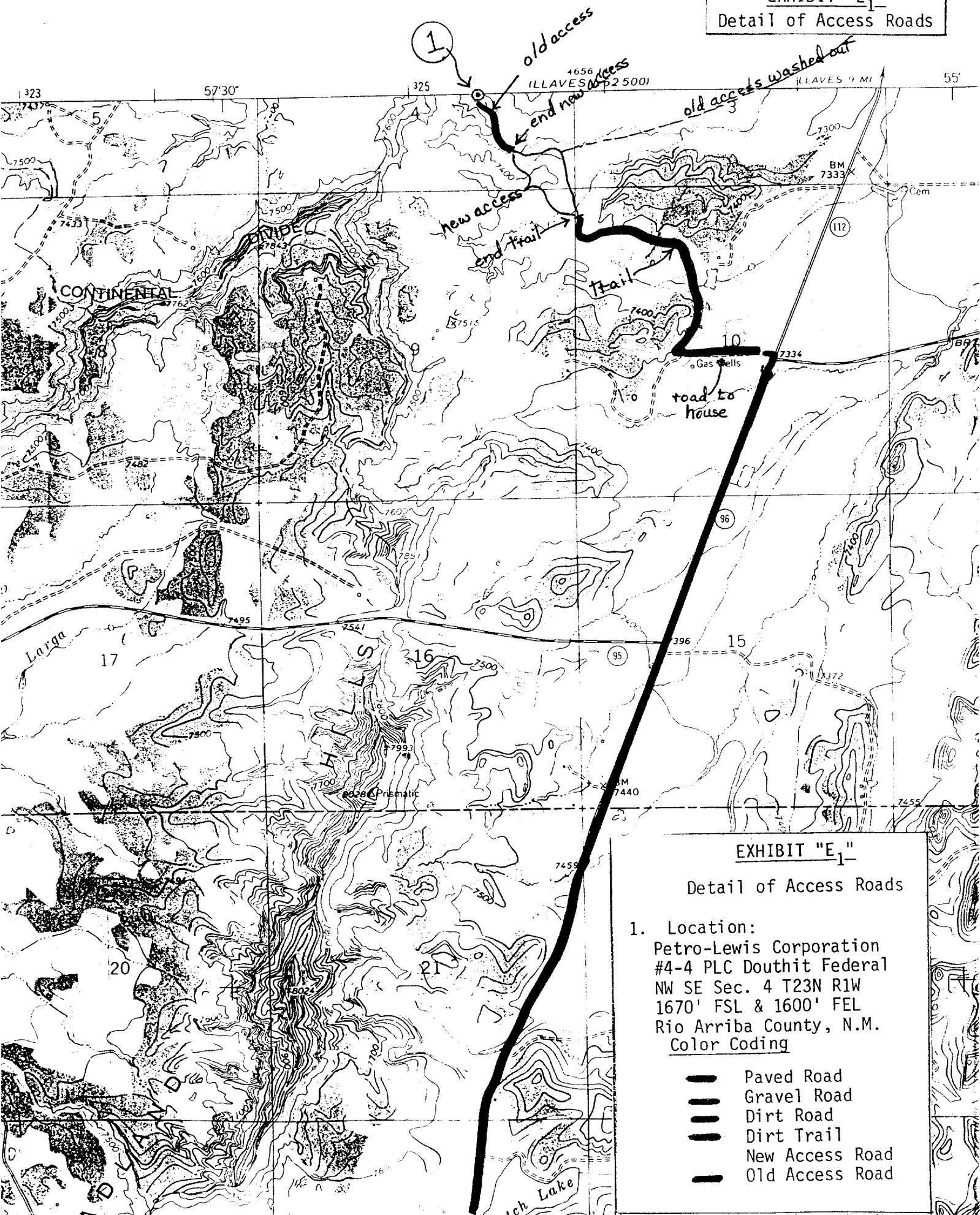

EXHIBIT "E<sub>1</sub>"

Detail of Access Roads

- Location:  
Petro-Lewis Corporation  
#4-4 PLC Douthit Federal  
NW SE Sec. 4 T23N R1W  
1670' FSL & 1600' FEL  
Rio Arriba County, N.M.  
Color Coding

- Paved Road
- Gravel Road
- Dirt Road
- Dirt Trail
- New Access Road
- Old Access Road