

Form 9-331C
(May 1963)SUBMIT IN TRIPPLICATE*
(Other instructions on
reverse side)Form approved.
Budget Bureau No. 42-R1425.UNITED STATES
DEPARTMENT OF THE INTERIOR
GEOLOGICAL SURVEY

30-039-22835

5. LEASE DESIGNATION AND SERIAL NO.

NM 28734

6. IF INDIAN, ALLOTTEE OR TRIBE NAME

7. UNIT AGREEMENT NAME

8. FARM OR LEASE NAME

Lough Erne

9. WELL NO.

#1

10. FIELD AND POOL, OR WILDCAT

Lybrook Gallup

11. SEC., T., R., M., OR BLK.
AND SURVEY OR AREA

G Sec 4 T23N R6W

12. COUNTY OR PARISH 13. STATE

Rio Arriba NM

APPLICATION FOR PERMIT TO DRILL, DEEPEN, OR PLUG BACK

1a. TYPE OF WORK

DRILL ☒DEEPEN ☐PLUG BACK ☐

b. TYPE OF WELL

OIL
WELL ☒GAS
WELL ☐

OTHER

SINGLE
ZONE ☐MULTIPLE
ZONE ☐

2. NAME OF OPERATOR

Dugan Production Corp.

3. ADDRESS OF OPERATOR

P O Box 208, Farmington, NM 87401

4. LOCATION OF WELL (Report location clearly and in accordance with any State requirements.)

At surface

2160' FNL - 2310' FEL

At proposed prod. zone

14. DISTANCE IN MILES AND DIRECTION FROM NEAREST TOWN OR POST OFFICE*

3 miles North of Counselors, NM

15. DISTANCE FROM PROPOSED*

LOCATION TO NEAREST
PROPERTY OR LEASE LINE, FT.
(Also to nearest drlg. unit line, if any)

2160'

18. DISTANCE FROM PROPOSED LOCATION*
TO NEAREST WELL, DRILLING, COMPLETED,
OR APPLIED FOR, ON THIS LEASE, FT.

1 mile

16. NO. OF ACRES IN LEASE

640

19. PROPOSED DEPTH

5600'

17. NO. OF ACRES ASSIGNED
TO THIS WELL

40

20. ROTARY OR CABLE TOOLS

Rotary

21. ELEVATIONS (Show whether DF, RT, GR, etc.)

6725' GL

22. APPROX. DATE WORK WILL START*

ASAP

23.

PROPOSED CASING AND CEMENTING PROGRAM

SIZE OF HOLE	SIZE OF CASING	WEIGHT PER FOOT	SETTING DEPTH	QUANTITY OF CEMENT
12 1/4"	8-5/8"	24 #	200'	135 sx class B to surface
7-7/8"	4 1/2"	10.5 #	5600'	1600 cu.ft. slurry in 2 stages

Plan to drill a 12 1/4" hole w/ spud mud to 200' and set surface csg. (circ. to surface). Then will drill a 7-7/8" hole to TD to test Gallup Formation. Will run IES & CDL logs and, if productive, will run casing, cement in two stages (covering the top of the Ojo Alamo at 1311'). Will then selectively perforate, frac, clean out after frac and complete well.

GAS NOT DEDICATED



IN ABOVE SPACE DESCRIBE PROPOSED PROGRAM: If proposal is to deepen or plug back, give data on present productive zone and proposed new productive zone. If proposal is to drill or deepen directionally, give pertinent data on subsurface locations and measured and true vertical depths. Give blowout preventer program, if any.

24.

SIGNED

Jerome P. McHugh Jr.
Jerome P. McHugh Jr.

TITLE

Landman

DATE 9-17-81

(This space for Federal or State office use)

PERMIT NO.

APPROVAL DATE

APPROVED BY

John H. Kellin
John H. Kellin

TITLE

Acting Dist. Super.

DATE

CONDITIONS OF APPROVAL, IF ANY:

NMOC

STATE OF NEW MEXICO
ENERGY AND MINERALS DEPARTMENT

OIL CONSERVATION DIVISION

P. O. BOX 2088

SANTA FE, NEW MEXICO 87501

Form C-102
Revised 10-1-78

All distances must be from the outer boundaries of the Section.

Operator Dugan Production Corporation			Lease Lough Erne		Well No. #1
Init Letter G	Section 4	Township 23 North	Range 6 West	County Rio Arriba	
Actual Footage Location of Well:					
2160	feet from the	North	line and	2310	feet from the East line
Ground Level Elev. 6725	Producing Formation Gallup		Pool Lybrook Gallup		Dedicated Acreage: 40 Acres

1. Outline the acreage dedicated to the subject well by colored pencil or hachure marks on the plat below.

2. If more than one lease is dedicated to the well, outline each and identify the ownership thereof (both as to working interest and royalty).

3. If more than one lease of different ownership is dedicated to the well, have the interests of all owners been consolidated by communitization, unitization, force-pooling, etc?

☐ Yes ☐ No If answer is "yes," type of consolidation _____

If answer is "no," list the owners and tract descriptions which have actually been consolidated. (Use reverse side of this form if necessary.) _____

No allowable will be assigned to the well until all interests have been consolidated (by communitization, unitization, forced-pooling, or otherwise) or until a non-standard unit, eliminating such interests, has been approved by the Division.

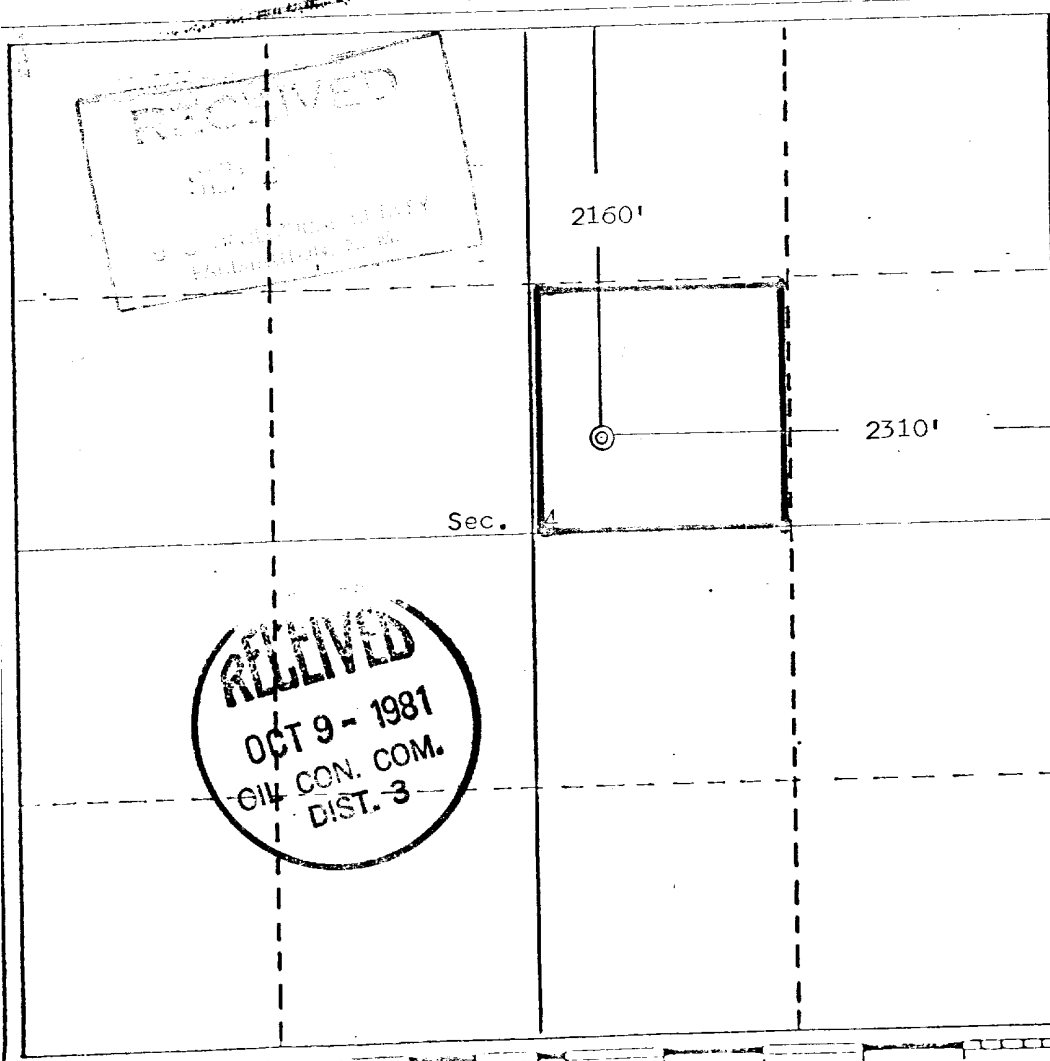

CERTIFICATION

I hereby certify that the information contained herein is true and complete to the best of my knowledge and belief.

Jerome P. McHugh Jr.
Name
Jerome P. McHugh Jr.

Position
Landman

Company
Dugan Production Corp.

Date
9-17-81

I hereby certify that the location shown on this plat was located from field notes and observations made by me or under my supervision, and that the same is correct to the best of my knowledge.

Date Surveyed
August 24, 1981

Registered Professional Engineer and/or Land Surveyor

Edgar L. Risenhoover
Certificate No. 5979
Edgar L. Risenhoover, L.S.

