

UNITED STATES
DEPARTMENT OF THE INTERIOR
GEOLOGICAL SURVEY

30-039-23023

APPLICATION FOR PERMIT TO DRILL, DEEPEN, OR PLUG BACK

1a. TYPE OF WORK

DRILL ☒DEEPEN ☐PLUG BACK ☐

b. TYPE OF WELL

OIL
WELL ☒GAS
WELL ☐OTHER ☐SINGLE
ZONE ☐MULTIPLE
ZONE ☐

2. NAME OF OPERATOR

Chace Oil Company, Inc.

3. ADDRESS OF OPERATOR

313 Washington, S. E., Albuquerque, NM 87108

4. LOCATION OF WELL (Report location clearly and in accordance with any State requirements.)

At surface Unit "K" 2310' FSL and 2310' FWL

At proposed prod. zone

14. DISTANCE IN MILES AND DIRECTION FROM NEAREST TOWN OR POST OFFICE*

12 miles SW of Lindrith, N. M.

10. DISTANCE FROM PROPOSED*

LOCATION TO NEAREST
PROPERTY OR LEASE LINE, FT.
(Also to nearest drlg. unit line, if any) 2310'

16. NO. OF ACRES IN LEASE

1920

18. DISTANCE FROM PROPOSED LOCATION*
TO NEAREST WELL, DRILLING, COMPLETED,
OR APPLIED FOR, ON THIS LEASE, FT. 2000'

19. PROPOSED DEPTH

7480'

17. NO. OF ACRES ASSIGNED
TO THIS WELL

40'

20. ROTARY OR CABLE TOOLS

Rotary

21. ELEVATIONS (Show whether DF, RT, GR, etc.)

7210' 7230' ~~KB~~ GL

22. APPROX. DATE WORK WILL START*

September 13, 1982

23.

PROPOSED CASING AND CEMENTING PROGRAM

SIZE OF HOLE	SIZE OF CASING	WEIGHT PER FOOT	SETTING DEPTH	QUANTITY OF CEMENT
9 3/4"	8 5/8"	22	225'	225 sxs Class "B" cement
7 7/8"	4 1/2"	11.6	7480'	1st stage - 750 sxs 50/50 posmix; 2nd stage - 550 sxs 40/60 posmix; 12% gel; 200 sxs Class "B" cement

Drill 230' of 9 3/4" surface hole. Set 225' of 8 5/8" casing; cement to surface with 225 sxs cement. Use an oil base mud (15% oil) and Schaeffer 5000# standard doublegate hydraulic BOP. Drill 7 7/8" hole to 7480' to test the Dakota formation.

Wasatch formation on surface. Estimated tops: Ojo-2500'; Pictured Cliffs-2955'; Chacra-3320'; Cliff House-4530'; Point Lookout-5040'; Gallup-6155'; Greenhorn-7085'; Dakota "A"-7200'; Dakota "D"-7330'.

D. V. Tool @ 3000'. Float collar at 7450'.

RECEIVED

APR 2 1982

U. S. GEOLOGICAL SURVEY
FARMINGTON, N. M.

IN ABOVE SPACE DESCRIBE PROPOSED PROGRAM: If proposal is to deepen or plug back, give data on present productive zone and proposed new productive zone. If proposal is to drill or deepen directionally, give pertinent data on subsurface locations and measured and true vertical depths. Give blowout preventer program, if any.

24.

SIGNED

Ross Easterday

TITLE

Landman

DATE

3-30-82

(This space for Federal or State office use)

PERMIT NO.

APPROVAL DATE

APPROVED BY

TITLE

CONDITIONS OF APPROVAL, IF ANY:

APPROVED
AS AMENDED

JUN 16 1982

JAMES F. SIMS
DISTRICT ENGINEER

*See Instructions On Reverse Side

NMOC

NEW MEXICO OIL CONSERVATION COMMISSION
WELL LOCATION AND ACREAGE DEDICATION PLAT

Form C-102
Supersedes C-128
Effective 1-1-65

All distances must be from the outer boundaries of the Section.

Operator CHACE OIL CO.		Lease JICARILLA 71		Well No. 4-8
Unit Letter K	Section 3	Township 23 NORTH	Range 4 WEST	County RIO ARriba
Actual Footage Location of Well: 2310 feet from the SOUTH line and 2310 feet from the WEST line				
Ground Level Elev. 7216	Producing Formation Gallup - Dakota	Pool S. Lindrith Gallup-Dakota E.		Dedicated Acreages 40 Acres

1. Outline the acreage dedicated to the subject well by colored pencil or hatchure marks on the plat below.
2. If more than one lease is dedicated to the well, outline each and identify the ownership thereof (both as to working interest and royalty).
3. If more than one lease of different ownership is dedicated to the well, have the interests of all owners been consolidated by communitization, unitization, force-pooling, etc?

☐ Yes ☐ No If answer is "yes," type of consolidation _____

If answer is "no," list the owners and tract descriptions which have actually been consolidated. (Use reverse side of this form if necessary.) _____

No allowable will be assigned to the well until all interests have been consolidated (by communitization, unitization, forced-pooling, or otherwise) or until a non-standard unit, eliminating such interests, has been approved by the Commission.

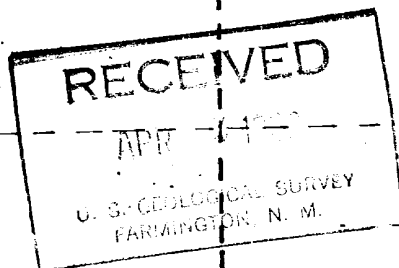
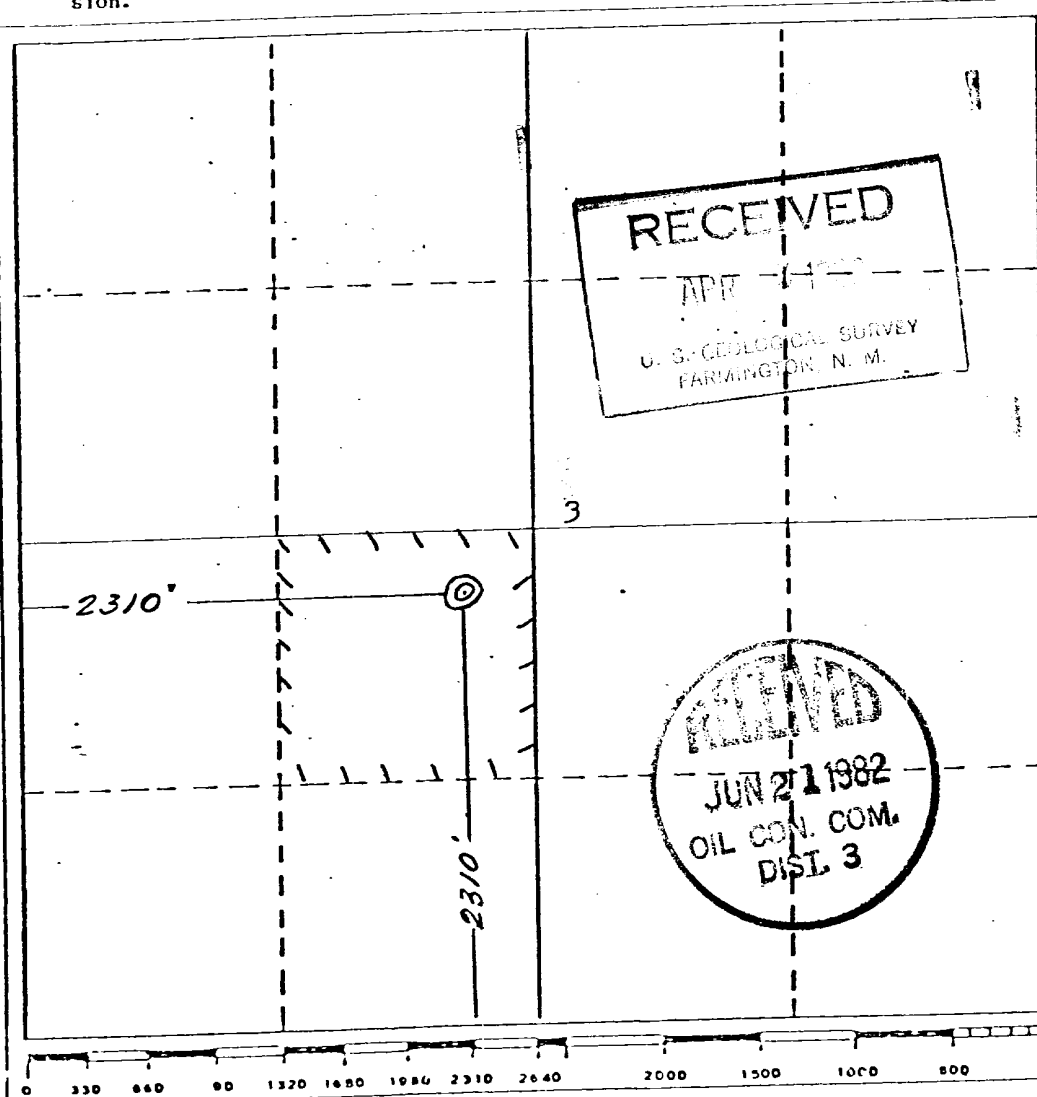

CERTIFICATION

I hereby certify that the information contained herein is true and complete to the best of my knowledge and belief.

Name **James P. Leese**
Position **Geologist**
Company **Chace Oil Co.**
Date **4-1-82**

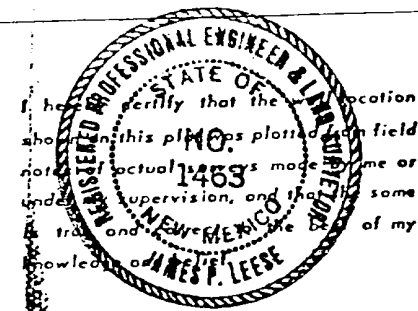

Date Surveyed
March 18, 1982
Registered Professional Engineer and/or Land Surveyor
James P. Leese
Certificate No.
1463

