

SUBMIT IN TRIPLICATE*

(Other instructions on reverse side)

Form approved.
Budget Bureau No. 42-R1425.Form 331 C
(May 1963)UNITED STATES
DEPARTMENT OF THE INTERIOR
GEOLOGICAL SURVEY

30-039-23048

5. LEASE DESIGNATION AND SERIAL NO.

SF 080230

6. IF INDIAN, ALLOTTEE OR TRIBE NAME

7. UNIT AGREEMENT NAME

8. FARM OR LEASE NAME

Sapp C

9. WELL NO.

3

10. FIELD AND POOL, OR WILDCAT

Lybrook Gallup

11. SEC., T., R., M., OR BLK.
AND SURVEY OR AREA

O Sec 5 T23N R7W

12. COUNTY OR PARISH 13. STATE

Rio Arriba

NM

APPLICATION FOR PERMIT TO DRILL, DEEPEN, OR PLUG BACK

1a. TYPE OF WORK

DRILL ☒DEEPEN ☐PLUG BACK ☐

b. TYPE OF WELL

OIL
WELL ☒GAS
WELL ☐

OTHER

SINGLE
ZONE ☒MULTIPLE
ZONE ☐

2. NAME OF OPERATOR

DUGAN PRODUCTION CORP.

3. ADDRESS OF OPERATOR

P O Box 208, Farmington, NM 87401

4. LOCATION OF WELL (Report location clearly and in accordance with any State requirements.)*

At surface

890' FSL - 1930' FEL

At proposed prod. zone

RECEIVED

MAY 25 1982

14. DISTANCE IN MILES AND DIRECTION FROM NEAREST TOWN OR POST OFFICE

2 miles NW of Lybrook, NM

15. DISTANCE FROM PROPOSED*

LOCATION TO NEAREST
PROPERTY OR LEASE LINE, FT.
(Also to nearest drlg. unit line, if any)

890'

16. NO. OF ACRES IN LEASE, ETC.

640

17. NO. OF ACRES ASSIGNED
TO THIS WELL

40

18. DISTANCE FROM PROPOSED LOCATION*
TO NEAREST WELL, DRILLING, COMPLETED,
OR APPLIED FOR, ON THIS LEASE, FT.

2000' to SW

19. PROPOSED DEPTH

5700'

20. ROTARY OR CABLE TOOLS

Rotary

21. ELEVATIONS (Show whether DF, RT, GR, etc.)

7142' GL

22. APPROX. DATE WORK WILL START*

ASAP

23.

PROPOSED CASING AND CEMENTING PROGRAM

SIZE OF HOLE	SIZE OF CASING	WEIGHT PER FOOT	SETTING DEPTH	QUANTITY OF CEMENT
12-1/4"	8-5/8"	24#	200'	160 cu.ft. to surface
7-7/8"	4-1/2"	10.5#	5700'	1300 cu.ft. to surface

Plan to drill with spud mud to 200' to set the surface casing. Then will drill with water-mud-gel mixture to TD to test the Gallup Formation. Will run IES and CDL logs and, if it appears productive, will then selectively perforate, frac, clean out after frac, and complete well.

IN ABOVE SPACE DESCRIBE PROPOSED PROGRAM: If proposal is to deepen or plug back, give data on present productive zone and proposed new productive zone. If proposal is to drill or deepen directionally, give pertinent data on subsurface locations and measured and true vertical depths. Give blowout preventer program, if any.

24.

SIGNED

Jerry McHugh

TITLE Well Site Coordinator

DATE 5-21-82

(This space for Federal or State office use)

PERMIT NO.

APPROVAL DATE

APPROVED BY

TITLE

CONDITIONS OF APPROVAL, IF ANY:

APPROVED
AS AMENDED

DATE

JUL 28 1982

DISTRICT ENGINEER

NMCCG

OIL CONSERVATION DIVISION

STATE OF NEW MEXICO
ENERGY AND MINERALS DEPARTMENTP. O. BOX 2088
SANTA FE, NEW MEXICO 87501Form C-102
Revised 10-1-78

All distances must be from the outer boundaries of the Section.

Operator Dugan Production Corp.		Lease Sapp C		Well No. 3
Unit Letter 0	Section 5	Township 23 North	Range 7 West	County Rio Arriba
Actual Footage Location of Well: 890' feet from the South line and 1930' feet from the East line				
Ground Level Elev. 7142'	Producing Formation Gallup	Pool Lybrook Gallup	Dedicated Acreage: 40 Acres	

1. Outline the acreage dedicated to the subject well by colored pencil or hachure marks on the plat below.
2. If more than one lease is dedicated to the well, outline each and identify the ownership thereof (both as to working interest and royalty).
3. If more than one lease of different ownership is dedicated to the well, have the interests of all owners been consolidated by communitization, unitization, force-pooling, etc?

☐ Yes ☐ No If answer is "yes," type of consolidation _____

If answer is "no," list the owners and tract descriptions which have actually been consolidated. (Use reverse side of this form if necessary.) _____

No allowable will be assigned to the well until all interests have been consolidated (by communitization, unitization, forced-pooling, or otherwise) or until a non-standard unit, eliminating such interests, has been approved by the Division.

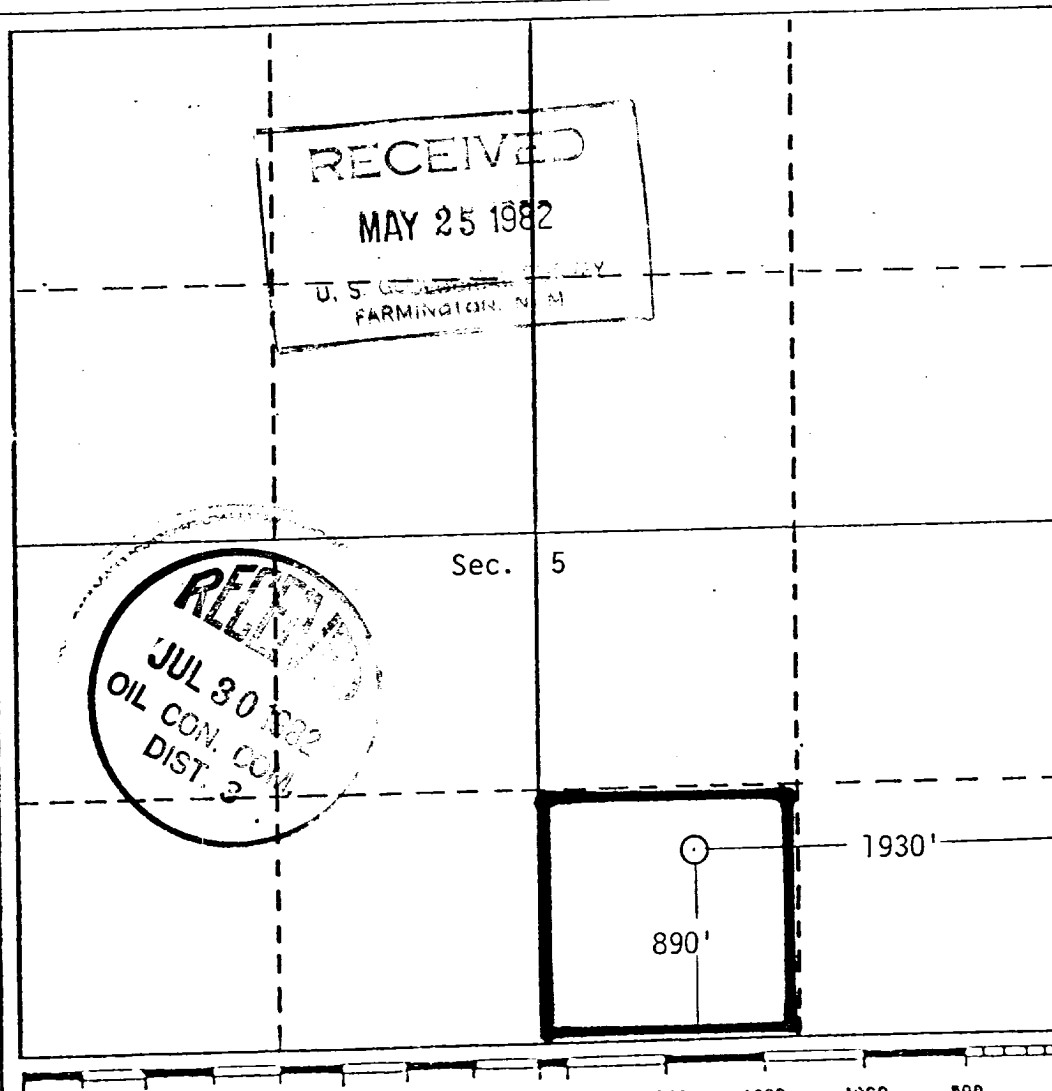

CERTIFICATION

I hereby certify that the information contained herein is true and complete to the best of my knowledge and belief.

Jerry McHugh
Name
Jerry McHugh

Position
Well Site Coordinator

Company
Dugan Production Corp.

Date
5-21-82

I hereby certify that the well location shown on this plat was plotted from field notes of actual surveys made by me or under my supervision, and that the same is true and correct to the best of my knowledge and belief.

Thomas A. Dugan

Date Surveyed
5-12-82

Registered Professional Engineer
and/or Land Surveyor

Thomas A. Dugan

Certificate No.
NM 2373 PE/LS

