

SUNDRY NOTICES AND REPORTS ON WELLS

1. oil ☒ gas ☐ other

2. NAME OF OPERATOR
Chace Oil Company, Inc.

3. ADDRESS OF OPERATOR
313 Washington, SE, Albuquerque, NM 87108

4. LOCATION OF WELL (REPORT LOCATION CLEARLY. See space 17 below.)
AT SURFACE: Unit "C", 336' FNL & 2310' FWL
AT TOP PROD. INTERVAL:
AT TOTAL DEPTH:

16. CHECK APPROPRIATE BOX TO INDICATE NATURE OF NOTICE,
REPORT, OR OTHER DATA

REQUEST FOR APPROVAL TO:

TEST WATER SHUT-OFF	<input type="checkbox"/>
FRACTURE TREAT	<input type="checkbox"/>
SHOOT OR ACIDIZE	<input type="checkbox"/>
REPAIR WELL	<input type="checkbox"/>
PULL OR ALTER CASING	<input type="checkbox"/>
MULTIPLE COMPLETE	<input type="checkbox"/>
CHANGE ZONES	<input type="checkbox"/>
ABANDON*	<input type="checkbox"/>

(other) Install tank battery off existing pad

SUBSEQUENT REPORT OF

APR 22 1983

APR 1983
U. S. GEOLOGICAL SURVEY
EAPENINGTON, N. M.
OIL CON. DIV.

RECEIVED

OIL CON. DIV.
DIST. 3

17. DESCRIBE PROPOSED OR COMPLETED OPERATIONS (Clearly state all pertinent details, and give pertinent dates, including estimated date of starting any proposed work. If well is directionally drilled, give subsurface locations and measured and true vertical depths for all markers and zones pertinent to this work.)*

We propose to install a 100' x 100' tank battery approximately 125' from existing well pad, due to topography.

A 2" line will be run from separator to tanks and buried 3-4' deep. Normal fencing and firewalls will be built around tanks and water pit.

No new roads will be needed to connect tanks with existing pad.

Refer to attached diagram for layout.

Subsurface Safety Valve: Manu. and Type _____ Set @ _____ Ft.

18. I hereby certify that the foregoing is true and correct

SIGNED R. J. [Signature] TITLE Geologist DATE April 20, 1983

(This space for Federal or State office use)

APPROVED BY _____
CONDITIONS OF APPROVAL, IF ANY:

APPROVED

MAY 6 1983
 JAMES F. SIMP
 DISTRICT ENGINEER

***See Instructions on Reverse Side**

NMOCC

Tank Battery Diagram

Chace Oil Company
47-3 JV Jicarilla Apache Well

Well Location: 336' FNL & 2310' FWL

Sec. 11 T23N R4W

Rio Arriba Co., NM

Battery Location: Approximately
100-125 ft. west of well location

N
↑

RECEIVED
JAN 19 1983
C.O. DIV.
DIST. 8

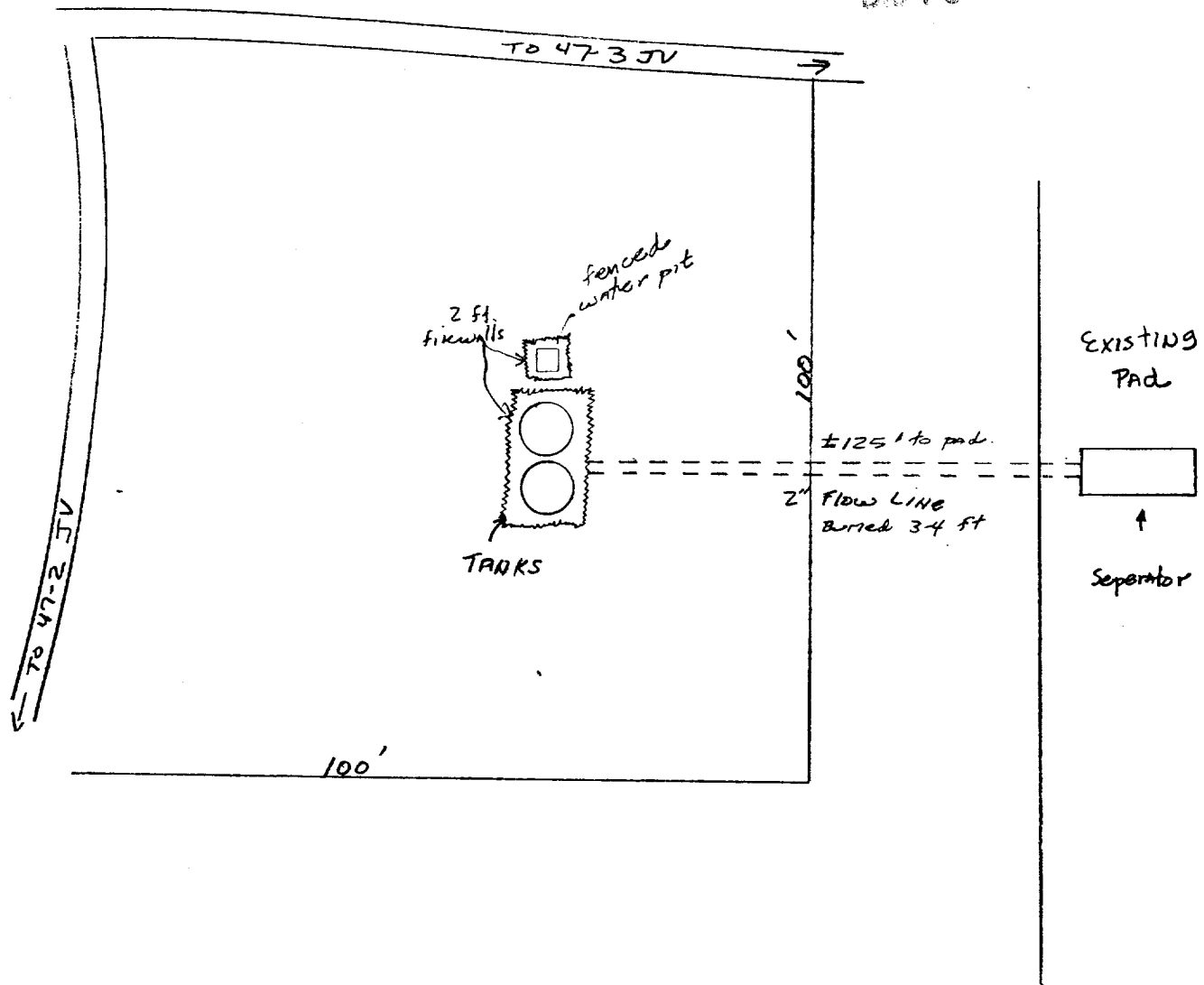

==== = existing roads
Scale: 1" = 50'

Ground cover of area to be cleared consists of sage and native grasses with a few pinon and juniper trees near existing pad. A 3-5 ft. cut on east side of battery area will be required.