

UNITED STATES  
DEPARTMENT OF THE INTERIOR  
GEOLOGICAL SURVEY

## APPLICATION FOR PERMIT TO DRILL, DEEPEN, OR PLUG BACK

## 1a. TYPE OF WORK

DRILL ☒DEEPEN ☐PLUG BACK ☐

## b. TYPE OF WELL

OIL  
WELL ☒GAS  
WELL ☐

OTHER

SINGLE  
ZONE ☐MULTIPLE  
ZONE ☒

## 2. NAME OF OPERATOR

Chace Oil Company, Inc.

## 3. ADDRESS OF OPERATOR

313 Washington, SE, Albuquerque, NM 87108

## 4. LOCATION OF WELL (Report location clearly and in accordance with any requirements.)

At surface

Unit 'B' 517' FNL &amp; 1913' FEL

At proposed prod. zone

## 14. DISTANCE IN MILES AND DIRECTION FROM NEAREST TOWN OR POST OFFICE\*

12 miles SW of Lindrith, New Mexico

## 15. DISTANCE FROM PROPOSED\*

LOCATION TO NEAREST

PROPERTY OR LEASE LINE, FT.

(Also to nearest drlg. unit line, if any) 517' Unit Line

1913' Lease Line

TO NEAREST WELL, DRILLING, COMPLETED,

OR APPLIED FOR, ON THIS LEASE, FT.

1300'

## 16. NO. OF ACRES IN LEASE

1920 1895.28

## 19. PROPOSED DEPTH

7550'

17. NO. OF ACRES ASSIGNED  
TO THIS WELL

40

## 20. ROTARY OR CABLE TOOLS

Rotary

## 21. ELEVATIONS (Show whether DF, RT, GR, etc.)

7262' GL

## 23.

DRILLING OPERATIONS AUTHORIZED AND

SUBJECT TO COMPLIANCE WITH ATTACHED

"GENERAL REQUIREMENTS"

PROPOSED CASING AND CEMENTING PROGRAM

## 22. APPROX. DATE WORK WILL START\*

6-15-83

This action is subject to administrative  
appeal pursuant to 30 CFR 290.

SIZE OF HOLE	SIZE OF CASING	WEIGHT PER FOOT	SETTING DEPTH	QUANTITY OF CEMENT
9 3/4"	8 5/8"	22# (J-55)	225'	225 sxs Class B cement (405 CF)
7 7/8"	4 1/2"	11.6# (N-80)	7550'	1st stage: 750 sxs (1350 CF)
				50/50 pozmix.
				2nd stage: 525 sxs (945 CF) 40/60
				pozmix, 12% gel.
				40 sxs (72 CF) Class B cement

Drill 230' of 9 3/4" surface hole. Set 225' of 8 5/8" casing. Cement to surface with 225 sxs (405 CF) cement. Use an oil base mud, (15% oil), and Schaeffer 5000# standard doublegate hydraulic BOP. Drill 7 7/8" hole to 7550', to test Dakota formation.

Wasatch formation on surface. Estimated tops: Ojo-2535'; Pictured Cliffs-2980'; Chacra-3330'; Cliff House-4515'; Point Lookout-5045'; Gallup-6140'; Tociro-6810'; Greenhorn-7120'; Dakota 'A'-7205'; Dakota 'D'-7345'; Burro Canyon-7400'.

D. V. Tool @ 3030'. Float Collar @ 7520'.

IN ABOVE SPACE DESCRIBE PROPOSED PROGRAM: If proposal is to deepen or plug back, give data on present productive zone and proposed new productive zone. If proposal is to drill or deepen directionally, give pertinent data on subsurface locations and measured and true vertical depth. Give blowout preventer program, if any.

## 24.

SIGNED

TITLE Geologist

DATE

(This space for Federal or State office use)

PERMIT NO.

APPROVAL DATE

APPROVED BY

TITLE

CONDITIONS OF APPROVAL, IF ANY:

DATE

APPROVED  
AS AMENDED

APR 11 1983

JAMES F. SIMS  
DISTRICT ENGINEER

\*See Instructions On Reverse Side

NMCCO

**NEW MEXICO OIL CONSERVATION COMMISSION  
WELL LOCATION AND ACREAGE DEDICATION PLAT**

Form C-102  
Supersedes C-128  
Effective 1-1-65

All distances must be from the outer boundaries of the Section.

Operator <b>CHACE OIL COMPANY, INC.</b>			Lease <b>JICARILLA TRIBAL #71</b>		Well No. <b>71-20</b>
Unit Letter <b>B</b>	Section <b>10</b>	Township <b>23N.</b>	Range <b>4W.</b>	County <b>RIO ARriba</b>	
Actual Footage Location of Well: <div style="display: flex; justify-content: space-between;"> <span>1913</span> <span>EAST</span> <span>517</span> <span>NORTH</span> </div> <div style="display: flex; justify-content: space-between; font-size: small;"> <span>feet from the</span> <span>line and</span> <span>feet from the</span> <span>line</span> </div>					
Ground Level Elev. <b>7262</b>	Producing Formation <b>GALLUP-DAKOTA</b>	Pool <b>S. LINDRITH GALLUP-DAKOTA</b>	Dedicated Acreage: <b>40 Acres</b>		

1. Outline the acreage dedicated to the subject well by colored pencil or hachure marks on the plat below.
2. If more than one lease is dedicated to the well, outline each and identify the ownership thereof (both as to working interest and royalty).
3. If more than one lease of different ownership is dedicated to the well, have the interests of all owners been consolidated by communitization, unitization, force-pooling, etc?

☐ Yes    ☐ No    If answer is "yes," type of consolidation \_\_\_\_\_

If answer is "no," list the owners and tract descriptions which have actually been consolidated. (Use reverse side of this form if necessary.) \_\_\_\_\_

No allowable will be assigned to the well until all interests have been consolidated (by communitization, unitization, forced-pooling, or otherwise) or until a non-standard unit, eliminating such interests, has been approved by the Commission.

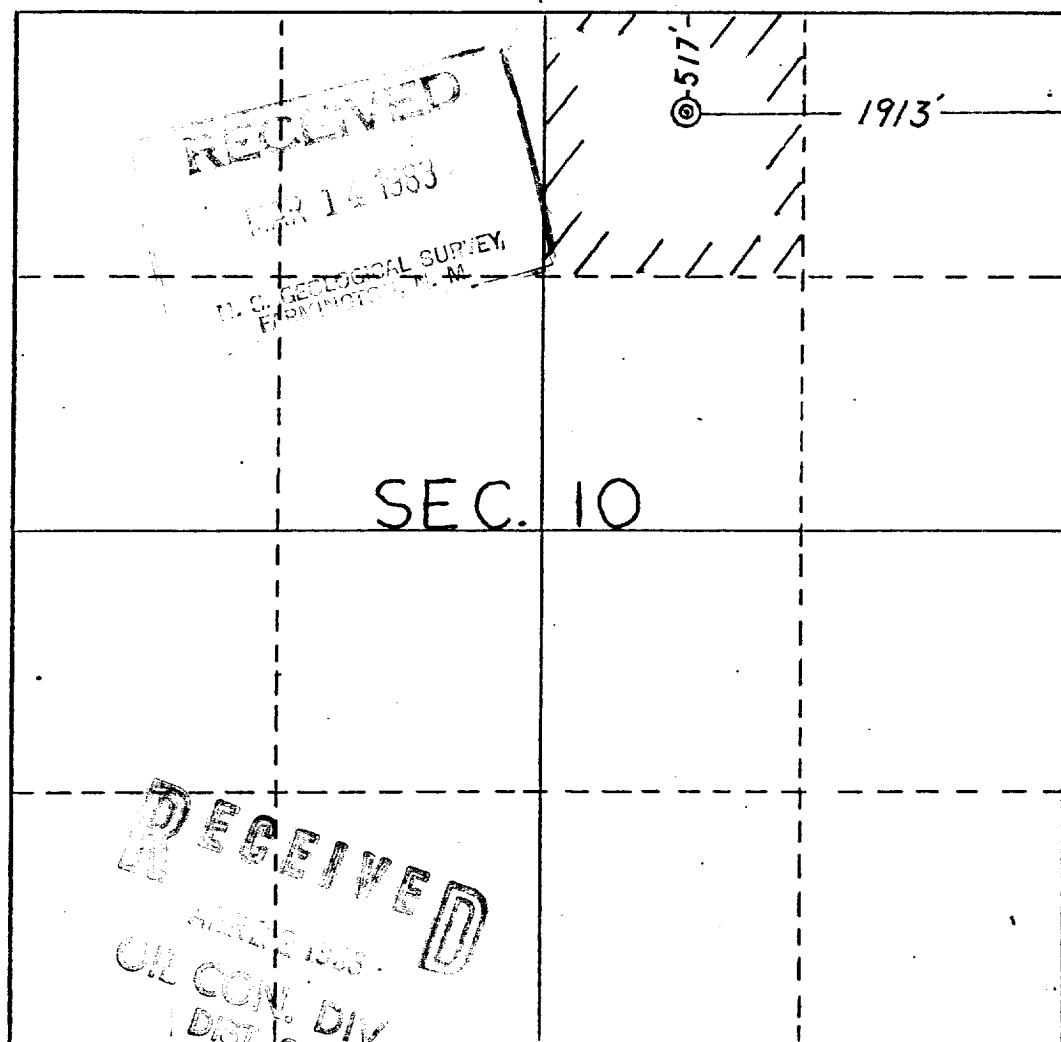

**CERTIFICATION**

I hereby certify that the information contained herein is true and complete to the best of my knowledge and belief.

Name *R. J. Ford*  
 Position *Geologist*  
 Company *Chace Oil Co.*  
 Date *1-18-83*

I hereby certify that the well location shown on this plat was plotted from field notes of actual surveys made by me or under my supervision, and that the same is true and correct to the best of my knowledge and belief.

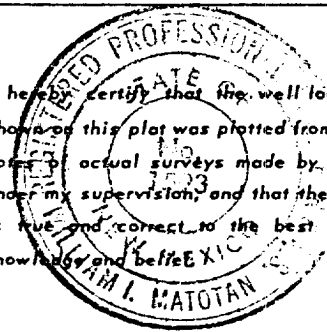

Date Surveyed  
**January 13, 1983**  
 Registered Professional Engineer and/or Land Surveyor  
*William I. Matotan*  
**William I. Matotan**

Certificate No. **1593**

