

UNITED STATES
DEPARTMENT OF THE INTERIOR
GEOLOGICAL SURVEY

APPLICATION FOR PERMIT TO DRILL, DEEPEN, OR PLUG BACK

1a. TYPE OF WORK

DRILL ☒DEEPEN ☐PLUG BACK ☐

b. TYPE OF WELL

OIL
WELL ☒GAS
WELL ☐

OTHER

SINGLE
ZONE ☐MULTIPLE
ZONE ☒

2. NAME OF OPERATOR

Chace Oil Company, Inc.

3. ADDRESS OF OPERATOR

313 Washington, SE, Albuquerque, NM 87101

4. LOCATION OF WELL (Report location clearly and in accordance with all State requirements.)*

At surface

Unit 'F' - 1890' FNL & 1900' FWL

At proposed prod. zone

14. DISTANCE IN MILES AND DIRECTION FROM NEAREST TOWN OR POST OFFICE*

12 miles W-SW of Lindrith, New Mexico

15. DISTANCE FROM PROPOSED*

LOCATION TO NEAREST 1890' Lease Line
PROPERTY OR LEASE LINE, FT.
(Also to nearest drlg. unit line, if any) 570' Unit Line

16. NO. OF ACRES IN LEASE

2560

17. NO. OF ACRES ASSIGNED
TO THIS WELL

40

18. DISTANCE FROM PROPOSED LOCATION*
TO NEAREST WELL, DRILLING, COMPLETED,
OR APPLIED FOR, ON THIS LEASE, FT.

1200'

19. PROPOSED DEPTH

7700'

20. ROTARY OR CABLE TOOLS

Rotary

21. ELEVATIONS (Show whether DF, RT, GR, etc.)

7422' GL

22. APPROX. DATE WORK WILL START*

5-18-83

23.

PROPOSED CASING AND CEMENTING PROGRAM

This action is subject to administrative
appeal pursuant to 30 CFR 290.

SIZE OF HOLE	SIZE OF CASING	WEIGHT PER FOOT	SETTING DEPTH	QUANTITY OF CEMENT
9 3/4"	8 5/8"	22# (J-55)	225'	225 sxs (405 CF) Class B cement
7 7/8"	4 1/2"	11.6# (N-80)	7700'	1st stage: 750 sxs (1350 CF) 50/50 pozmix 2nd stage: 550 sxs (990 CF) 40/60 pozmix, 12% gel 50 sxs (90 CF) Class B cement

Drill 230' of 9 3/4" surface hole. Set 225' of 8 5/8" casing. Cement to surface with 225 sxs (405 CF) cement. Use an oil base mud, (15% oil); and Schaeffer 5000# standard doublegate hydraulic BOP. Drill 7 7/8" hole to 7700' to test Dakota formation.

Wasatch formation on surface. Estimated tops: Ojo-2700'; Pictured Cliffs-3150'; Chacra-3500'; Cliff House-4685'; Pt. Lookout-5210'; Gallup-6305'; Tocito-6960'; Greenhorn-7270'; Dakota 'A'-7355'; Dakota 'D'-7500'; Burro Canyon-7605'.

D. V. Tool @ 3200'. Float Collar @ 7575'.

IN ABOVE SPACE DESCRIBE PROPOSED PROGRAM: If proposal is to deepen or plug back, give data on present productive zone and proposed new productive zone. If proposal is to drill or deepen directionally, give pertinent data on subsurface locations and measured and true vertical depths. Give blowout preventer program, if any.

24.

SIGNED

TITLE Geologist

(This space for Federal or State office use)

PERMIT NO.

APPROVAL DATE

APPROVED BY

TITLE

CONDITIONS OF APPROVAL, IF ANY:

*See Instructions On Reverse Side

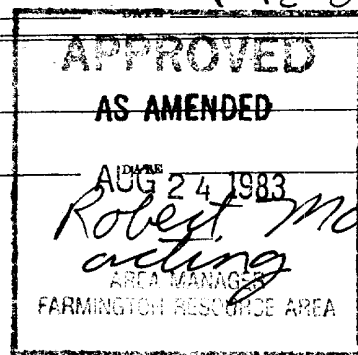

All distances must be from the outer boundaries of the Section.

Operator CHACE OIL COMPANY, INC.		Lease JICARILLA TRIBAL #47		Well No. #5-JV
Unit Letter F	Section 11	Township 23 NORTH	Range 4 WEST	County RIO ARRIBA
Actual Footage Location of Well:				
1890 feet from the NORTH line and		1900 feet from the WEST line		
Ground Level Elev. 7422	Producing Formation GALLUP-DAKOTA	Pool S. L. Underth GALLUP DAKOTA	Dedicated Acreage 40 Acres	

1. Outline the acreage dedicated to the subject well by colored pencil or hatchure marks on the plat below.
2. If more than one lease is dedicated to the well, outline each and identify the ownership thereof (both as to working interest and royalty).
3. If more than one lease of different ownership is dedicated to the well, have the interests of all owners been consolidated by communitization, unitization, force-pooling, etc?

☐ Yes ☐ No If answer is "yes," type of consolidation _____

If answer is "no," list the owners and tract descriptions which have actually been consolidated (Use reverse side of this form if necessary.) _____

No allowable will be assigned to the well until all interests have been consolidated (by communitization, unitization, forced-pooling, or otherwise) or until a non-standard unit, eliminating such interests, has been approved by the Division _____

RECEIVED

AUG 30 1983

CON. DIV.

DIST. 3

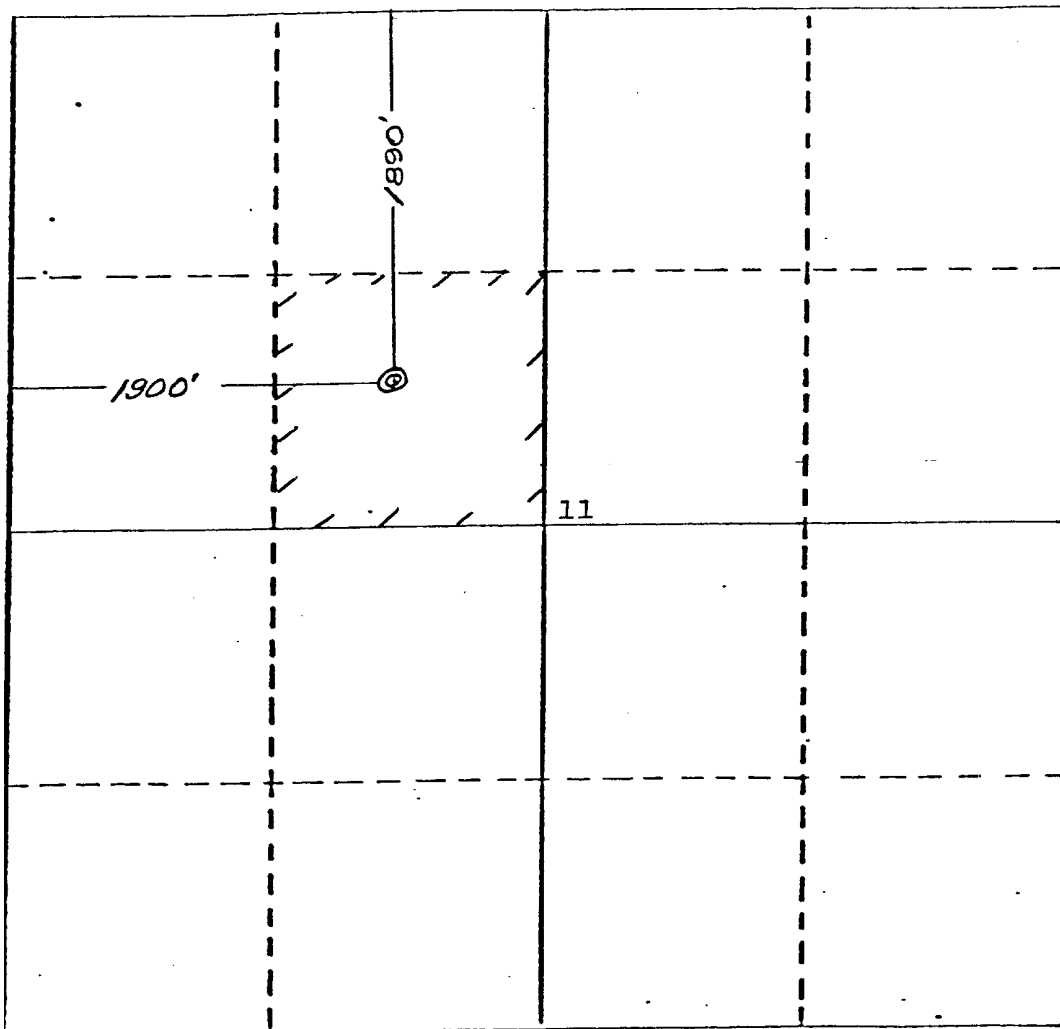

CERTIFICATION

I hereby certify that the information contained herein is true and complete to the best of my knowledge and belief.

Name [Signature]
Position Geologist
Company Chace Oil Co
Date 1-11-83

I hereby certify that the well location shown on this plat was plotted on field notes of actual surveys made by me or under my supervision, and that the same is true and correct to the best of my knowledge and belief.

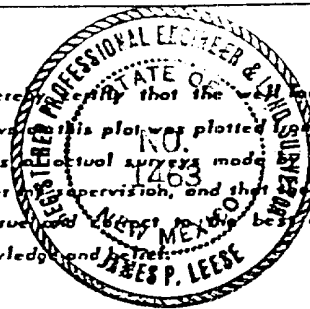

Date Surveyed
November 16, 1982
Registered Professional Engineer and/or Land Surveyor
[Signature]
James P. Leese

Certificate No.
1463

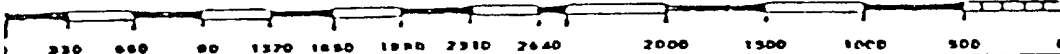



CHACE OIL COMPANY, INC.
47-JV #5
SE $\frac{1}{4}$ NW $\frac{1}{4}$, Sec. 11, T23N, R4W, N.M.P.M.,
Rio Arriba County, New Mexico

RIO ARRIBA CO
SANDOVAL CO

7275 SANDOVAL CO

Borrow
Pit

07428