

UNITED STATES
DEPARTMENT OF THE INTERIOR
GEOLOGICAL SURVEY

APPLICATION FOR PERMIT TO DRILL, DEEPEN, OR PLUG BACK

1a. TYPE OF WORK

DRILL ☒DEEPEN ☐PLUG BACK ☐

b. TYPE OF WELL

OIL
WELL ☒GAS
WELL ☐

OTHER

SINGLE
ZONE ☒MULTIPLE
ZONE ☐

2. NAME OF OPERATOR

Merrion Oil & Gas Corporation

3. ADDRESS OF OPERATOR

P. O. Box 1017, Farmington, New Mexico 87499

4. LOCATION OF WELL (Report location clearly and in accordance with any State requirements.*)

At surface

1880' FNL and 1730' FWL

At proposed prod. zone

Same

14. DISTANCE IN MILES AND DIRECTION FROM NEAREST TOWN OR POST OFFICE*

3 miles West of Counselors, New Mexico

15. DISTANCE FROM PROPOSED*

LOCATION TO NEAREST
PROPERTY OR LEASE LINE, FT.
(Also to nearest drlg. unit line, if any)

600'

16. NO. OF ACRES IN LEASE

2462

17. NO. OF ACRES ASSIGNED
TO THIS WELL

220 160 40

18. DISTANCE FROM PROPOSED LOCATION*

TO NEAREST WELL DRILLING COMPLETED,
OR APPLIED FOR, ON THIS LEASE, FT.

3000'

19. PROPOSED DEPTH

6500'

20. ROTARY OR CABLE TOOLS

Rotary

21. ELEVATIONS (Show whether DF, RT, GR, etc.)

6811' GL

22. APPROX. DATE WORK WILL START*

Winter/spring, 1984

23.

PROPOSED CASING AND CEMENTING PROGRAM

This action is subject to administrative
appeal pursuant to 30 CFR 290.

SIZE OF HOLE	SIZE OF CASING	WEIGHT PER FOOT	SETTING DEPTH	QUANTITY OF CEMENT
12-1/4"	8-5/8"	24 #/ft.	200'	170 sx (200.60 cu. ft.)
7-7/8"	4-1/2"	10.5 #/ft.	6500'	500 sx (1104.80 cu. ft.)

Will drill 12-1/4" hole to 200' and set 8-5/8", 24 #/ft. surface casing with 170 sx (200.6 cu. ft.) Class B, 2% CACL₂. Will pressure test to 500 PSI. Will drill 7-7/8" hole to 6500' or depth sufficient to test the Dakota. Will run open hole logs. If appears productive, will run 4-1/2", 10.5 #/ft. J-55 casing to TD with stage tools @ 4600' and 2350', and 3 stage cement to cover Dakota, Gallup, Mesa Verde, Pictured Cliffs and Ojo Alamo as follows: 1st Stage with 375 sx (457.50 cu. ft.) Class H 2% gel to cover Dakota and Gallup. 2nd Stage with 185 sx (381.10 cu. ft.) Class B 2% D-79 plus 50 sx (61 cu. ft.) Class H 2% gal to cover Mesa Verde and Chacra. 3rd Stage with 70 sx (144.20 cu. ft.) Class B 2% D-79 plus 50 sx (61 cu. ft.) Class H 2% gel to cover Pictured Cliffs, Fruitland, Kirtland and Ojo Alamo. Will perf and stimulate as required. The gas from this formation is dedicated. Mud - gel fresh water and starch (low solids mud.)

ESTIMATED TOPS

(On Back)

IN ABOVE SPACE DESCRIBE PROPOSED PROGRAM: If proposal is to deepen or plug back, give data on present productive zone and proposed new productive zone. If proposal is to drill or deepen directionally, give pertinent data on subsurface locations and measured and true vertical depths. Give blowout preventer program, if any.

24.

SIGNED

TITLE Operations Manager

(This space for Federal or State office use)

PERMIT NO.

APPROVAL DATE

APPROVED BY

TITLE

CONDITIONS OF APPROVAL, IF ANY:

At 1730' depth if gas well

NMOCC

30-039-23378

5. LEASE DESIGNATION AND SERIAL NO.

SF 078359

6. IF INDIAN, ALLOTTEE OR TRIBE NAME

7. UNIT AGREEMENT NAME

8. FARM OR LEASE NAME

Rita Com

9. WELL NO.

4

10. FIELD AND POOL, OR WILDCAT

Undesignated Dakota

11. SEC., T., R., M., OR BLK.
AND SURVEY OR AREA

F Sec. 8, T23N, R6W

12. COUNTY OR PARISH

13. STATE

Rio Arriba

New Mexico

OIL CONSERVATION DIVISION

STATE OF NEW MEXICO

P. O. BOX 2088

Form C-107

HGY AND MINERALS DEPARTMENT

SANTA FE, NEW MEXICO 87501

Revised 10-1-78

All distances must be from the outer boundaries of the Section.

Operator MERRION OIL & GAS CORPORATION			Lease RITA COM		Well No. 4
Unit Letter F	Section 8	Township 23N	Range 6W	County Rio Arriba	
Actual Footage Location of Well: 1880 feet from the North line and 1730 feet from the West line					
Ground Level Elev. 6811	Producing Formation Dakota		Pool Undesignated Dakota		Dedicated Acreage: 220 160 40 Acres

1. Outline the acreage dedicated to the subject well by colored pencil or hachure marks on the plat below.
2. If more than one lease is dedicated to the well, outline each and identify the ownership thereof (both as to working interest and royalty).
3. If more than one lease of different ownership is dedicated to the well, have the interests of all owners been consolidated by communitization, unitization, force-pooling, etc?

☒ Yes ☐ No If answer is "yes," type of consolidation Communitized

If answer is "no," list the owners and tract descriptions which have actually been consolidated. (Use reverse side of this form if necessary.)

No allowable will be assigned to the well until all interests have been consolidated (by communitization, unitization, forced-pooling, or otherwise) or until a non-standard unit, eliminating such interests, has been approved by the Commission.

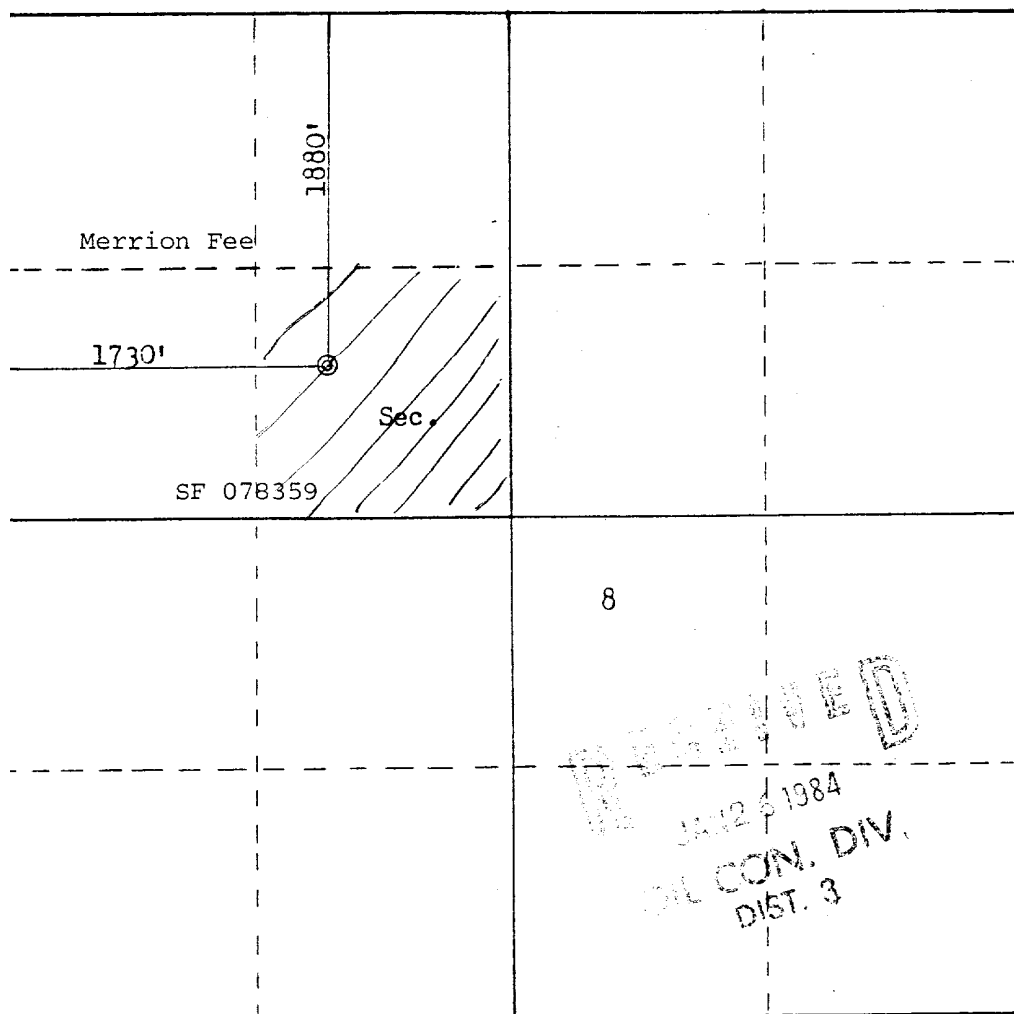

Scale: 1"=1000'

CERTIFICATION

I hereby certify that the information contained herein is true and complete to the best of my knowledge and belief.

Steve S. Dunn

Name
Steve S. Dunn
Position
Operations Manager
Company
Merrion Oil & Gas Corporation
Date
12/21/83

I hereby certify that the well location shown on this plat was plotted from field notes of actual surveys made by me or under my supervision, and that the same is true and correct to the best of my knowledge and belief.

Date Surveyed
December 16, 1983
Registered Professional Engineer
and Land Surveyor
Fred B. Kerr Jr.
Fred B. Kerr Jr.
Certificate No. **3950**

2500

DEPARTMENT OF THE INTERIOR
GEOLOGICAL SURVEY

