

UNITED STATES
DEPARTMENT OF THE INTERIOR
BUREAU OF LAND MANAGEMENT

APPLICATION FOR PERMIT TO DRILL, DEEPEN, OR PLUG BACK

1a. TYPE OF WORK

DRILL ☒

DEEPEN ☐

PLUG BACK ☐

b. TYPE OF WELL

OIL
WELL ☒

GAS
WELL ☐

OTHER

SINGLE
ZONE ☐

MULTIPLE
ZONE ☒

2. NAME OF OPERATOR

Chace Oil Company, Inc.

3. ADDRESS OF OPERATOR

313 Washington, SE, Albuquerque, NM 87108

4. LOCATION OF WELL (Report location clearly and in accordance with any State requirements.)*

At surface

Unit 'K' - 1650' FWL & 2310' FSL

At proposed prod. zone

14. DISTANCE IN MILES AND DIRECTION FROM NEAREST TOWN OR POST OFFICE*

16 1/2 miles W-SW of Lindrith, New Mexico

15. DISTANCE FROM PROPOSED*

LOCATION TO NEAREST

PROPERTY OR LEASE LINE, FT.

(Also to nearest drlg. unit line, if any) 660' Unit Line

18. DISTANCE FROM PROPOSED LOCATION*

TO NEAREST WELL, DRILLING, COMPLETED,
OR APPLIED FOR, ON THIS LEASE, FT.

1030'

16. NO. OF ACRES IN LEASE

1920

19. PROPOSED DEPTH

7429'

17. NO. OF ACRES ASSIGNED
TO THIS WELL

40

20. ROTARY OR CABLE TOOLS

Rotary

21. ELEVATIONS (Show whether DF, RT, GR, etc.)

7223' GR

DRILLING OPERATIONS AUTHORIZED ARE
SUBJECT TO COMPLIANCE WITH ATTACHED

"GENERAL REQUIREMENTS"
PROPOSED CASING AND CEMENTING PROGRAM

22. APPROX. DATE WORK WILL START*

April 15, 1984

23.

SIZE OF HOLE	SIZE OF CASING	WEIGHT PER FOOT	SETTING DEPTH	QUANTITY OF CEMENT
12 1/4"	8 5/8"	24# (J-55)	225'	225 sxs. (266 CF) Class B cement.
7 7/8"	4 1/2"	11.6# N-80	7429'	1st stage: 750 sxs (1073 CF) 50/50 pozmix. 2nd stage: 505 sxs (1177 CF) 65/35 pozmix; 12% gel. 40 sxs. (47) Class B cement

Drill 230' of 12 1/4" surface hole. Set 225' of 8 5/8" casing. Cement to surface with 225 sxs (266 CF) cement. Use an oil base mud (15% oil) and Schaeffer 5000# standard double-date hydraulic BOP. Drill 7 7/8" hole to 7429' to test Dakota formation. Wasatch formation on surface. Estimated tops: Ojo- 2402'; Pictured Cliffs - 2820'; Chacra - 3203'; Cliff House - 4388'; Point Lookout - 4928'; Gallup - 5667'; Tociro - 6682'; Greenhorn - 7007'; Dakota 'A' - 7102'; Dakota 'D' - 7227'; Burro Canyon - 7329'

D. V. Tool at 2860'. Float Collar at 7289'.

RECEIVED

APR 03 1984

OIL CON. DIV.

IN ABOVE SPACE DESCRIBE PROPOSED PROGRAM: If proposal is to deepen or plug back, give data on present productive zone and proposed new productive zone. If proposal is to drill or deepen directionally, give pertinent data on subsurface locations and measured and true vertical depths. Give blowout preventer program, if any.

24.

SIGNED

D. W. Miller

TITLE President

(This space for Federal or State office use)

PERMIT NO.

APPROVAL DATE

APPROVED BY

TITLE

CONDITIONS OF APPROVAL, IF ANY:

NMOCC

*See Instructions On Reverse Side

Title 18 U.S.C. Section 1001, makes it a crime for any person knowingly and willfully to make to any department or agency of the United States any false, fictitious or fraudulent statements or representations as to any matter within its jurisdiction.

APPROVED
AS AMENDED
APR 02 1984
DATE
AS AMENDED
FARMINGTON RESOURCE AREA

All distances must be from the outer boundaries of the Section.

Operator CHACE OIL COMPANY, INC.			Lease Jicarilla Tribal Contract #71		Well No. 23 24
Unit Letter K	Section 10	Township 23 NORTH	Range 4 WEST	County RIO ARriba	
Actual Footage Location of Well: 2310 feet from the SOUTH line and 1650 feet from the WEST line					
Ground Level Elev. 7219	Producing Formation Gallup Dakota		Pool South Lindrith, Gallup-Dakota		Dedicated Acreage: 40 Acres

1. Outline the acreage dedicated to the subject well by colored pencil or hatchure marks on the plat below.
2. If more than one lease is dedicated to the well, outline each and identify the ownership thereof (both as to working interest and royalty).
3. If more than one lease of different ownership is dedicated to the well, have the interests of all owners been consolidated by communitization, unitization, force-pooling, etc?

☐ Yes ☐ No If answer is "yes," type of consolidation _____

If answer is "no," list the owners and tract descriptions which have actually been consolidated. (Use reverse side of this form if necessary.) _____

No allowable will be assigned to the well until all interests have been consolidated (by communitization, unitization, forced-pooling, or otherwise) or until a non-standard unit, eliminating such interests, has been approved by the Division

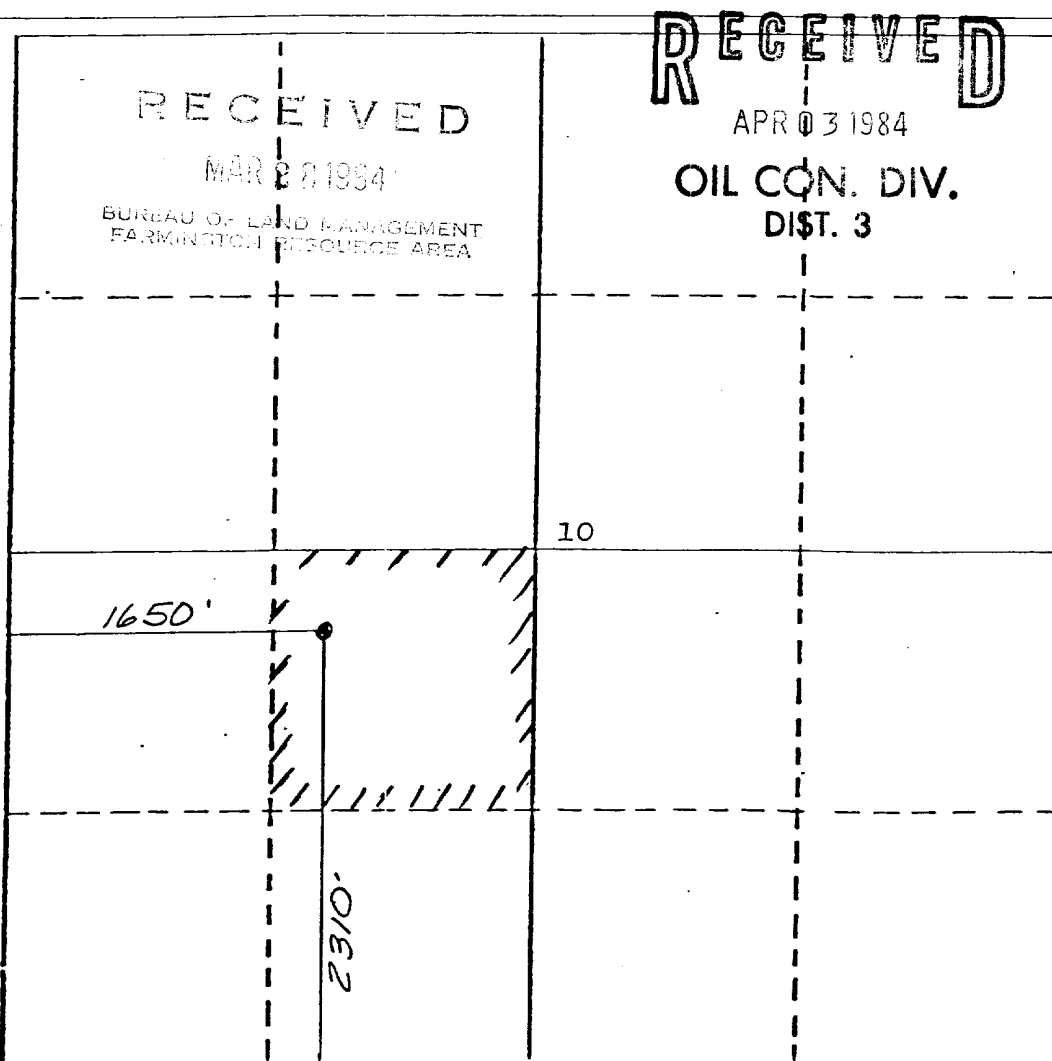

CERTIFICATION

I hereby certify that the information contained herein is true and complete to the best of my knowledge and belief.

Name Monte Anderson
Position Geologist
Company Chace Oil Company, Inc.
Date March 27, 1984

I hereby certify that the well location shown on this plat was plotted from field notes of actual survey made by me or under my supervision and that the same is true and correct to the best of my knowledge and belief.

Date Surveyed February 7, 1984
Registered Professional Engineer and/or Land Surveyor

Michael Daly

Certificate No.
5992

