

UNITED STATES
DEPARTMENT OF THE INTERIOR
GEOLOGICAL SURVEY

APPLICATION FOR PERMIT TO DRILL, DEEPEN, OR PLUG BACK

1a. TYPE OF WORK

DRILL ☒DEEPEN ☐PLUG BACK ☐

b. TYPE OF WELL

OIL
WELL ☒GAS
WELL ☐

OTHER

SINGLE
ZONE ☐MULTIPLE
ZONE ☒

2. NAME OF OPERATOR

Chace Oil Company, Inc.

3. ADDRESS OF OPERATOR

313 Washington, S.E., Albuquerque, New Mexico 87108

4. LOCATION OF WELL (Report location clearly and in accordance with any State requirements.)*

At surface

Unit 'N' 2230' FWL + 747' FSL

At proposed prod. zone

14. DISTANCE IN MILES AND DIRECTION FROM NEAREST TOWN OR POST OFFICE*

17 miles W-SW of Lindrith, New Mexico

15. DISTANCE FROM PROPOSED* 747' Lease Line
LOCATION TO NEAREST
PROPERTY OR LEASE LINE, FT.
(Also to nearest drig. unit line, if any) 410' Unit Line16. NO. OF ACRES IN LEASE
192017. NO. OF ACRES ASSIGNED
TO THIS WELL 4018. DISTANCE FROM PROPOSED LOCATION*
TO NEAREST WELL, DRILLING, COMPLETED,
OR APPLIED FOR, ON THIS LEASE, FT. 1600'19. PROPOSED DEPTH
7464'20. ROTARY OR CABLE TOOLS
Rotary

21. ELEVATIONS (Show whether DF, RT, GR, etc.)

7259' GR

DRILLING OPERATIONS AUTHORIZED ARE
SUBJECT TO COMPLIANCE WITH ATTACHED

22. APPROX. DATE WORK WILL START*

5/1/84

23. "GENERAL REQUIREMENTS" PROPOSED CASING AND CEMENTING PROGRAM

This section is subject to administrative
approval pursuant to 30 CFR 200.
QUANTITY OF CEMENT

SIZE OF HOLE	SIZE OF CASING	WEIGHT PER FOOT	SETTING DEPTH	QUANTITY OF CEMENT
12 1/4"	8 5/8"	24# (J-55)	225'	225 SXS (266 CF) Class B cement
7 7/8"	4 1/2"	11.6# (N-80)	7460'	1st stage: 750 SXS (1073 CF) 50/50 pozmix 2nd stage: 505 SXS (1177 CF) 65/35 pozmix, 12% gel 40 SXS (47 CF) Class B cement

Drill 230' of 12 1/4" surface hole. Set 225' of 8 5/8" casing. Cement to surface with 225 SXS (266 CF) cement. Use an oil based mud (15% oil) and Schaeffer 5000# standard doublegate hydraulic BOP. Drill 7 7/8" hole to 7464' to test Dakota formation.

Wasatch formation on surface. Estimated tops: Ojo - 2437'; Pictured Cliffs - 2855'; Chacra - 3238'; Cliff House - 4423'; Point Lookout - 4963'; Gallup - 5702'; Tocito - 6717'; Greenhorn - 7042'; Dakota 'A' - 7137'; Dakota 'D' - 7272'; Burro Canyon - 7364'.

D. V. Tool at 2895'. Float Collar at 7324'.

IN ABOVE SPACE DESCRIBE PROPOSED PROGRAM: If proposal is to deepen or plug back, give data on present productive zone and proposed new productive zone. If proposal is to drill or deepen directionally, give pertinent data on subsurface locations and depths and true vertical depths. Give blowout preventer program, if any.

24.

SIGNED

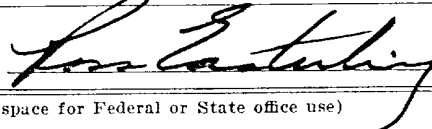

TITLE

Landman

(This space for Federal or State office use)

PERMIT NO.

APPROVAL DATE

APPROVED BY

TITLE

CONDITIONS OF APPROVAL, IF ANY:

oh7

*See Instructions On Reverse Side

NMOCC

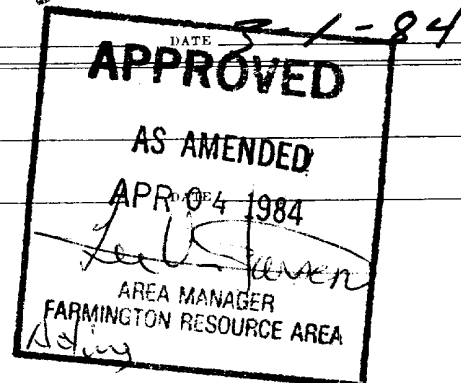

All distances must be from the outer boundaries of the section.

Operator CHACE OIL COMPANY, INC.			Lease Jicarilla Tribal Contract # 71		Well No. 27
Unit Letter N	Section 10	Township 23 NORTH	Range 4 WEST	County RIO ARriba	
Actual Footage Location of Well: 747 feet from the SOUTH line and 2230 feet from the WEST line					
Ground Level Elev. 7259	Producing Formation Gallup - Dakota		Pool S-Lindcith Gallup Dakota		Dedicated Acreage: 40 Acres

1. Outline the acreage dedicated to the subject well by colored pencil or hatchure marks on the plat below.
2. If more than one lease is dedicated to the well, outline each and identify the ownership thereof (both as to working interest and royalty).
3. If more than one lease of different ownership is dedicated to the well, have the interests of all owners been consolidated by communitization, unitization, force-pooling, etc?

☐ Yes ☐ No If answer is "yes," type of consolidation _____

If answer is "no," list the owners and tract descriptions which have actually been consolidated. (Use reverse side of this form if necessary.) _____

No allowable will be assigned to the well until all interests have been consolidated (by communitization, unitization, forced-pooling, or otherwise) or until a non-standard unit, eliminating such interests, has been approved by the Division

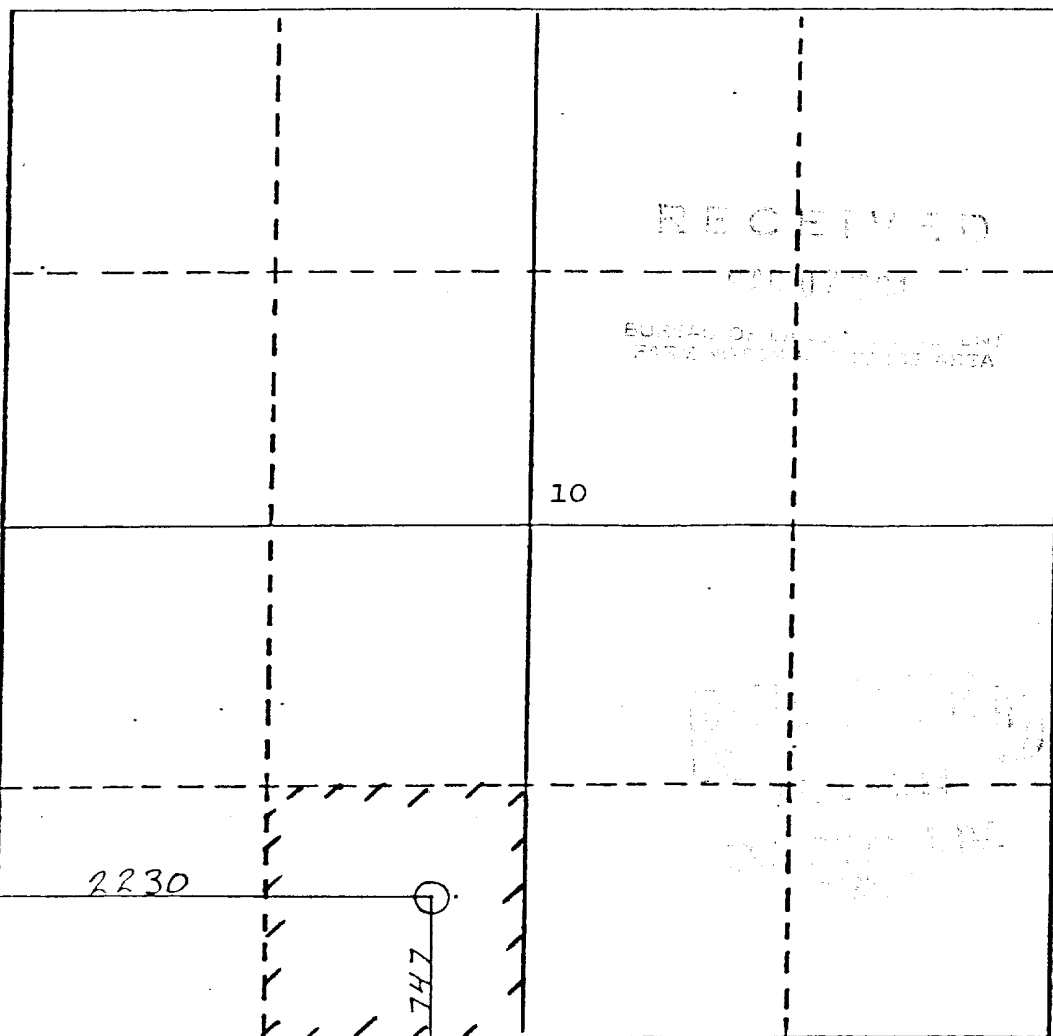

CERTIFICATION

I hereby certify that the information contained herein is true and complete to the best of my knowledge and belief.

Name **Ross Gentry**
Position **Landman**
Company **Chace Oil Co., Inc**
Date **3-1-84**

I hereby certify that the well location shown on this plat was plotted from field notes of actual surveys made by me or under my supervision, and that the same is true and correct to the best of my knowledge and belief.

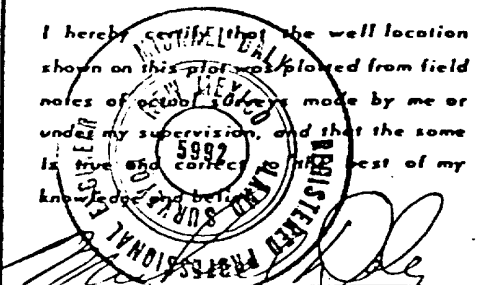

Date Surveyed
November 29, 1983

Registered Professional Engineer
and/or Land Surveyor

Michael Daly

Certificate No.
5992

