

Kenneth L. Bust
DEPUTY OIL & GAS INSPECTOR

SEP 17 2000

Denied

JICARILLA APACHE TRIBE

ENVIRONMENTAL PROTECTION OFFICE

P.O. BOX 507
DULCE, NEW MEXICO 87528

Incomplete

LF
Data

SUBMIT 1 COPY TO
NATURAL
RESOURCE DEPT
AND OIL-GAS
ADMINISTRATION

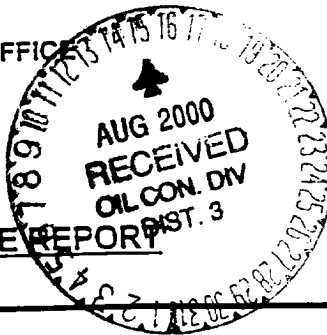

PIT REMEDIATION AND CLOSURE REPORT

Operator: ROBERT L. BAYLESS Telephone: 326-2659
Address: 318 HWY 170, FARMINGTON NM 87401
Facility or Well Name: JICARILLA 362 B#1
Location: Unit: A Sec. 7 T. 23 N R. 4 W County SANDOVAL
Pit Type: Separator Dehydrator Other DRIP
Land Type: Jicarilla Apache

Pit Location: Pit dimensions: length 18 width 18 depth 9
(Attach diagram) Reference: wellhead ☒ other
Footage from reference: 25 FT FROM REFERENCE
Direction from reference: 90 Degrees East North ☒
 ☒ West of South

Depth to Ground Water:

(Vertical distance from contaminants
to seasonal high water elevation of
ground water)

Less than 50 feet	(20 points)
50 feet to 99 feet	(10 points)
Greater than 100 feet	(0 points)

0

Wellhead Protection Area:

(Less than 200 feet from a private domestic
water source, or, less than 1,000 feet from all
other water sources)

Yes	(20 points)
No	(0 points)

0

Distance to Surface Water:

(Horizontal distance to perennial
lakes, ponds, rivers, streams,
creeks, irrigation canals and ditches)

Less than 200 feet	(20 points)
200 feet to 1,000 feet	(10 points)
Greater than 1,000 feet	(0 points)

0

Distance to Ephemeral Stream (dry wash):

(Horizontal distance to all downgradient
streams having a width of at least 10
feet)

Less than or equal to 100 feet	(10 points)
Greater than 100 feet	(0 points)

0

**Distance to Nearest Lake, Playa, or Watering
Pond:**

(Horizontal distance to all downgradient
lakes, playas, and livestock or wildlife
water ponds)

Less than or equal to 100 feet	(10 points)
Greater than 100 feet	(0 points)

0

RANKING SCORE (TOTAL POINTS):

0

Date Remediation Started: 9-23-96 Date Completed: 9-23-96

Remediation Method: Excavation ☒ Approx. Cubic Yards 20

(Check all appropriate sections)

Landfarmed ☒ Amount Landfarmed (cubic yds): 5

Other _____

Remediation Location: Onsite ☒ Offsite _____

(i.e., landfarmed onsite, name and location of offsite facility)

General Description of Remedial Action:

Excavated Pit to a depth of 4' Below
existing Bottom rock Sample Tested
Below 100 ppm

Ground Water Encountered: No ☒ Yes _____ Depth _____

Final Pit Closure Sampling:

Sample Location South wall

(if multiple samples, attach sample result and diagram of sample locations and depths.)

Sample depth 4' Below existing Bottom

Sample date 9-23-96 Sample time 1600

Sample Results

Soil: Benzene (ppm) _____ Water: Benzene (ppb) _____

Total BTEX (ppm) _____ Toluene (ppb) _____

Field headspace (ppm) 11.7 Ethylbenzene (ppb) _____

TPH 29 ppm Method 3550 and 418.1 Total Xylenes (ppb) _____

Ground Water Sample: Yes _____ No A (If yes, attach sample results)

I HEREBY CERTIFY THAT THE INFORMATION ABOVE IS TRUE AND COMPLETE TO THE BEST OF MY KNOWLEDGE AND MY BELIEF

DATE 9-23-96 PRINTED NAME Dave Sims

SIGNATURE Dave Sims AND TITLE Project manager

AFTER REVIEW OF THE PIT CLOSURE INFORMATION, PIT CLOSURE IS APPROVED IN ACCORDANCE TO JICARILLA APACHE TRIBE PIT CLOSURE ORDINANCE.

APPROVED: YES ☒ NO _____ (REASON): _____

SIGNED: Habert John DATE: 10/15/96

ROBERT L. BAYLESS
JICARILLA 362 B#1

DEPTH: 4 FT FROM ORIGINAL BOTTOM

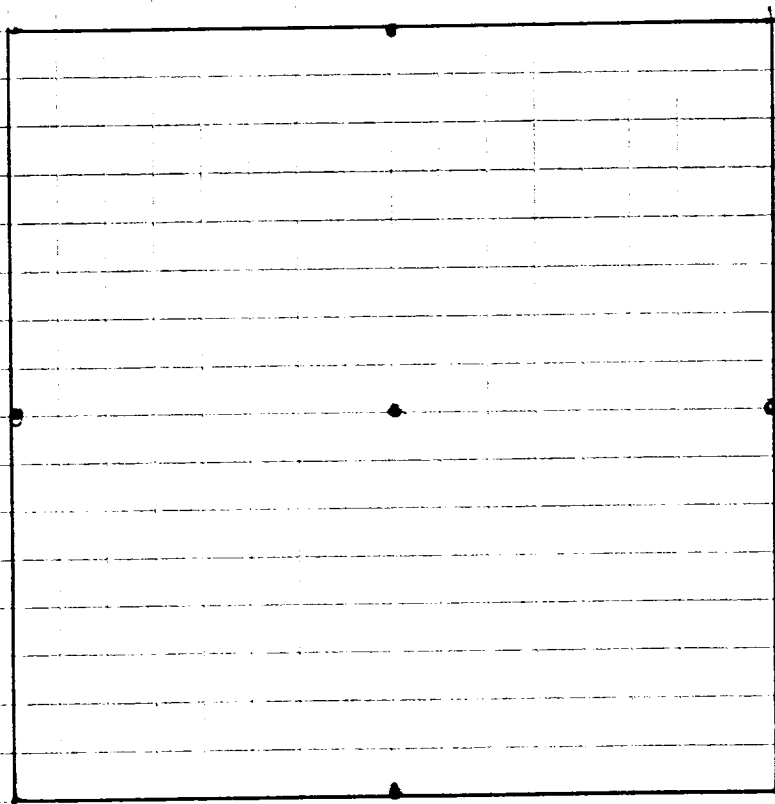

• DENOTES SAMPLE LOCATION

SAMPLES:

NORTH	:	9.1 PPM
SOUTH	:	11.9 PPM
EAST	:	3.4 PPM
WEST	:	4.8 PPM
BOTTOM	:	10.2 PPM

BFR
10.2



ROBERT L. BAYLESS
JICARILLA 362 B#1 SEC. 7 T. 23N R 4W

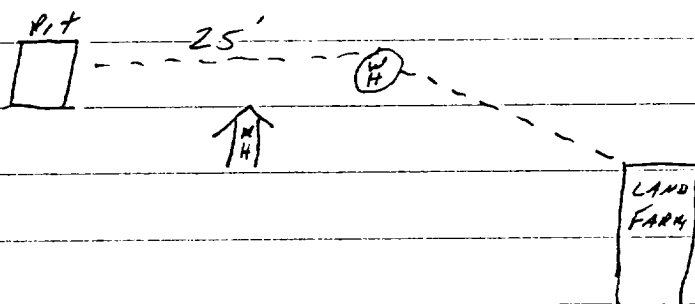

• I
A
LO
300
A
WE
BE M:

Jicarilla 362 B#1

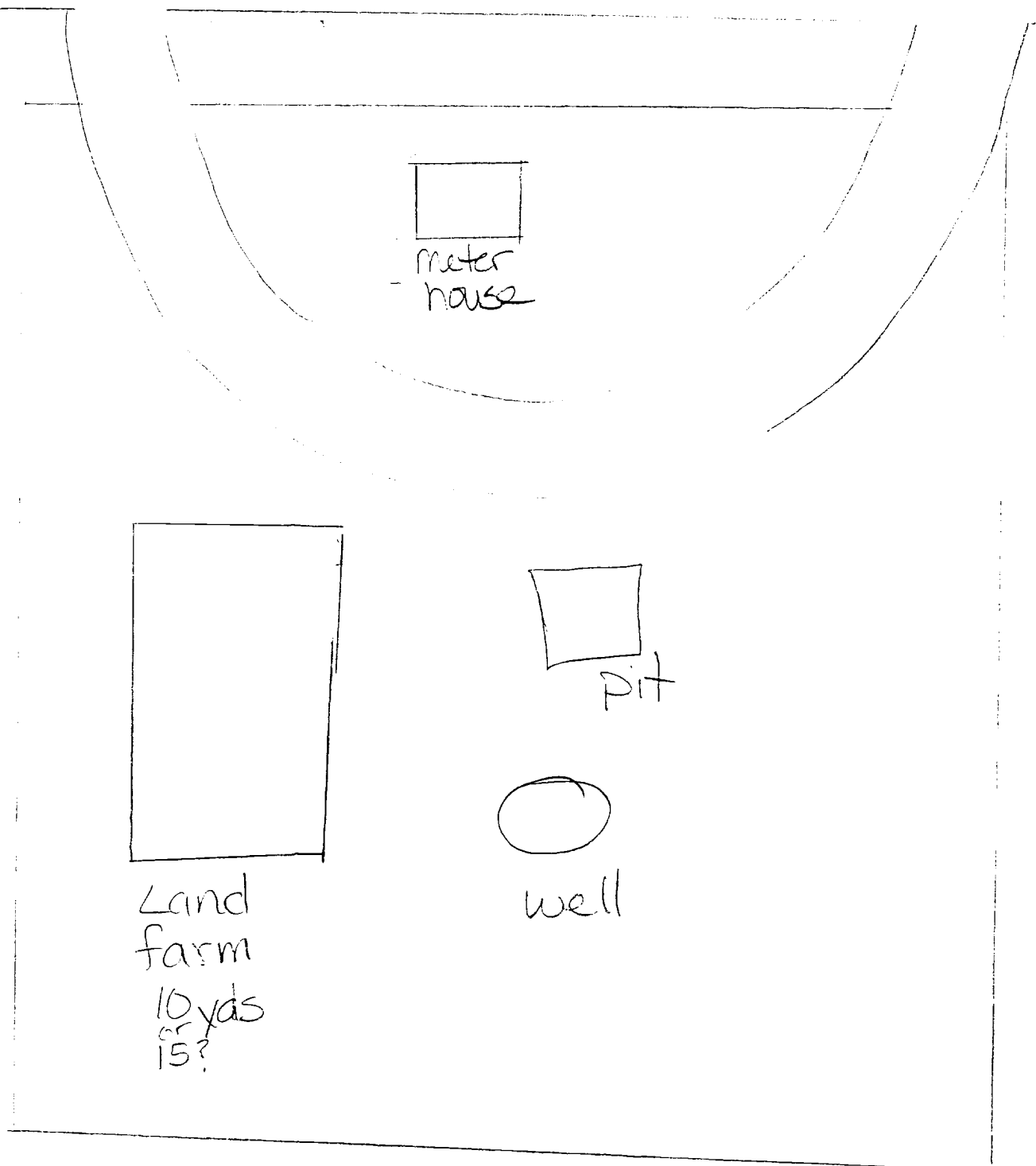

*copy***TOTAL PETROLEUM HYDROCARBONS**
EPA Method 418.1**RMI Environmental Services**

Project ID: Bayless
Sample Matrix: Soil
Preservative: Cool
Condition: Intact

Report Date: 09/26/96
Date Sampled: 9/23-24/96
Date Received: 09/25/96
Date Extracted: 09/26/96
Date Analyzed: 09/26/96

Sample ID	Lab ID	Concentration (mg/kg)	Detection Limit (mg/kg)
J - 398 B1	5184	ND	32.0
J - 362 B2	5185	329	32.0
J - 362 B3	5186	ND	30.2

ND- Analyte not detected at the stated detection limit.

Reference: Method 3550 - Sonication Extraction; Test Methods for Evaluating Solid Waste, SW-846, United States Environmental Protection Agency, September, 1986;
Method 418.1 - Petroleum Hydrocarbons, Total Recoverable; Chemical Analysis of Water and Waste, United States Environmental Protection Agency, 1978.

Comments:

[Signature]
Analyst

[Signature]
Review

OFF: (505) 325-5667



LAB: (505) 325-1556

ANALYTICAL REPORT

Date: 30-Sep-98

Client:	Bayless Drilling Company / Robert L. Bayl	Client Sample Info:	R.L. Bayless
Work Order:	9809062	Client Sample ID:	Jicarilla 362 B #1
Lab ID:	9809062-05A	Matrix:	SOIL
Project:	Bayless Jicarilla	Collection Date:	9/23/98 6:30:00 PM
		COC Record:	5567

Parameter	Result	PQL	Qual	Units	DF	Date Analyzed
TPH, T/R SOIL	E418.1					Analyst: HR
Petroleum Hydrocarbons, T/R	29	24		mg/Kg	1	9/28/98

Qualifiers:

PQL - Practical Quantitation Limit

S - Spike Recovery outside accepted recovery limits

ND - Not Detected at Practical Quantitation Limit

R - RPD outside accepted recovery limits

J - Analyte detected below Practical Quantitation Limit

E - Value above quantitation range

B - Analyte detected in the associated Method Blank

Surr - Surrogate

1 of 1

P.O. BOX 2606 • FARMINGTON, NM 87499

White/Yellow: Anaitas
Pink: Client

JICARILLA APACHE TRIBE
ENVIRONMENTAL
PROTECTION OFFICE
P.O. BOX 507
DULCE, NEW MEXICO 87528

SUBMIT 1 COPY TO
NATURAL
RESOURCE DEPT
AND OIL-GAS
ADMINISTRATION

ON-SITE SOIL REMEDIATION REPORT

Landfarm

Operator: <u>ROBERT L. BAYLESS</u>		Telephone: <u>326-2659</u>	
Address: <u>368 Hwy 170, FARMINGTON NM 87401</u>			
Facility or Well Name: <u>JICARILLA 362 B#1 LANDFARM</u>			
Location: Unit: _____		Sec. <u>7</u> T. <u>23</u> N R. <u>4</u> W County <u>SANDOVAL</u>	
Land Type: <u>Jicarilla Apache</u>			
Date Remediation Started: <u>9-23-96</u>		Date Completed: <u>9-23-96</u>	
Remediation Method: Landfarmed <input checked="" type="checkbox"/>		Approx. cubic yards <u>20</u>	
Composted _____			
Other _____			
Depth to Ground Water: (pts.) <u>0</u>		Final Closure Sampling:	
Distance to an Ephemeral Stream: (pts.) <u>0</u>		Sampling Date: <u>9-23-96</u> Time <u>16:00</u>	
Distance to Nearest Lake, Playa, or Watering Pond: (pts.) <u>0</u>		Sampling Results:	
Wellhead Protection Area: (pts.) <u>0</u>		Field Headspace (ppm) <u>4.7</u>	
Distance to Surface Water: (pts.) <u>0</u>		TPH (ppm) <u>65.2</u> Method <u>3550</u>	
Ranking Score (Total Points): <u>0</u>		Other <u>29</u> <u>and 418.1</u>	
I HEREBY CERTIFY THAT THE INFORMATION ABOVE IS TRUE AND COMPLETE TO THE BEST OF MY KNOWLEDGE AND BELIEF			
DATE <u>9-23-96</u>		PRINTED NAME <u>DAVE SIMS</u>	
SIGNATURE <u><i>Dave Sims</i></u>		AND TITLE <u>PROJECT MANAGER</u>	
AFTER REVIEW OF THE SOIL REMEDIATION INFORMATION, ON-SITE REMEDIATION APPROVED IN ACCORDANCE TO THE JICARILLA APACHE TRIBE PIT CLOSURE ORDINANCE			
APPROVED: YES <input checked="" type="checkbox"/> NO _____ (REASON) _____			
SIGNED: <u><i>Harold Gibson</i></u>		DATE: <u>10/15/96</u>	