

UNITED STATES  
DEPARTMENT OF THE INTERIOR  
BUREAU OF LAND MANAGEMENT

APPLICATION FOR PERMIT TO DRILL, DEEPEN, OR PLUG BACK

1a. TYPE OF WORK  
DRILL ☒ DEEPEN ☐ PLUG BACK ☐

b. TYPE OF WELL  
OIL WELL ☒ GAS WELL ☐ OTHER ☐ Comingled ☐ SINGLE ZONE ☐ MULTIPLE ZONE ☐

2. NAME OF OPERATOR  
W.B. Martin and Associates

3. ADDRESS OF OPERATOR  
709 N. Butler, Farmington, New Mexico 87401

4. LOCATION OF WELL (Report location clearly and in accordance with any State requirements.)\*  
At surface 1770 FNL and 860 FWL  
At proposed prod. zone

14. DISTANCE IN MILES AND DIRECTION FROM NEAREST TOWN OR POST OFFICE\*  
18 miles NW of Cuba, N.M.

10. DISTANCE FROM PROPOSED\* LOCATION TO NEAREST PROPERTY OR LEASE LINE, FT. (Also to nearest drlg. unit line, if any) 1770'  
16. NO. OF ACRES IN LEASE 2560 1280

18. DISTANCE FROM PROPOSED LOCATION\* TO NEAREST WELL, DRILLING, COMPLETED, OR APPLIED FOR, ON THIS LEASE, FT. 2560'  
19. PROPOSED DEPTH 7275'

21. ELEVATIONS (Show whether DF, RT, GR, etc) 7188 GR  
22. APPROX. DATE WORK WILL START\* Dependant Upon Approval

23. "GENERAL REQUIREMENTS" AND CEMENTING PROGRAM  
This action is subject to administrative appeal pursuant to 30 CFR 290.1

SIZE OF HOLE	SIZE OF CASING	WEIGHT PER FOOT	SETTING DEPTH
12 1/4"	8 5/8"	32	250'
7 7/8"	5 1/2"	17	7275'

RECEIVED

JUL 3 1984

Proposed Operation:

BUREAU OF LAND MANAGEMENT  
FARMINGTON RESOURCE AREA

1. Drill 12 1/4" hole to  $\pm 250'$ . Run and cement surface casing. WOC 12 hours. Pressure test BOP to 1000 PSI.
2. Drill 7 7/8" hole to  $\pm 7275'$  with low solids low water loss mud. Run and cement long string.

IN ABOVE SPACE DESCRIBE PROPOSED PROGRAM: If proposal is to deepen or plug back, give data on present productive zone and proposed new productive zone. If proposal is to drill or deepen directionally, give pertinent data on subsurface locations and measured and true vertical depths. Give blowout preventer program, if any.

24. SIGNED W.B. Martin Jr TITLE Operator  
(This space for Federal or State signature)  
PERMIT NO. SEP 10 1984 APPROVAL DATE SEP 07 1984  
APPROVED BY ahs TITLE OIL CON. DIV. DIST. 3  
CONDITIONS OF APPROVAL, IF ANY:  
\*See Instructions On Reverse Side

APPROVED  
DATE June 28, 1984  
AS AMENDED  
SEP 07 1984  
DATE  
AREA MANAGER  
FARMINGTON RESOURCE AREA

All distances must be from the outer boundaries of the Section.

Operator <b>B. MARTIN &amp; ASSOCIATES INC</b>			Lease <b>MARTIN-WHITAKER</b>		Well No. <b>39</b>
Section Letter <b>E</b>	Section <b>15</b>	Township <b>23N</b>	Range <b>4W</b>	County <b>Rio Arriba</b>	
Actual Footage Location of Well: <b>1770</b> feet from the <b>North</b> line and <b>860</b> feet from the <b>West</b> line					
Ground Level Elev. <b>7188</b>	Producing Formation <b>Gallup-Dakota</b>		Pool <del>Wildcat</del> <b>S. Lind.</b>		Dedicated Acreage: <b>40</b> <del>80</del> Acres

1. Outline the acreage dedicated to the subject well by colored pencil or hatchure marks on the plat below.
2. If more than one lease is dedicated to the well, outline each and identify the ownership thereof (both as to working interest and royalty).
3. If more than one lease of different ownership is dedicated to the well, have the interests of all owners been consolidated by communitization, unitization, force-pooling, etc?

☐ Yes ☐ No If answer is "yes," type of consolidation \_\_\_\_\_

If answer is "no," list the owners and tract descriptions which have actually been consolidated. (Use reverse side of this form if necessary.) \_\_\_\_\_

No allowable will be assigned to the well until all interests have been consolidated (by communitization, unitization, forced-pooling, or otherwise) or until a non-standard unit, eliminating such interests, has been approved by the Commission.

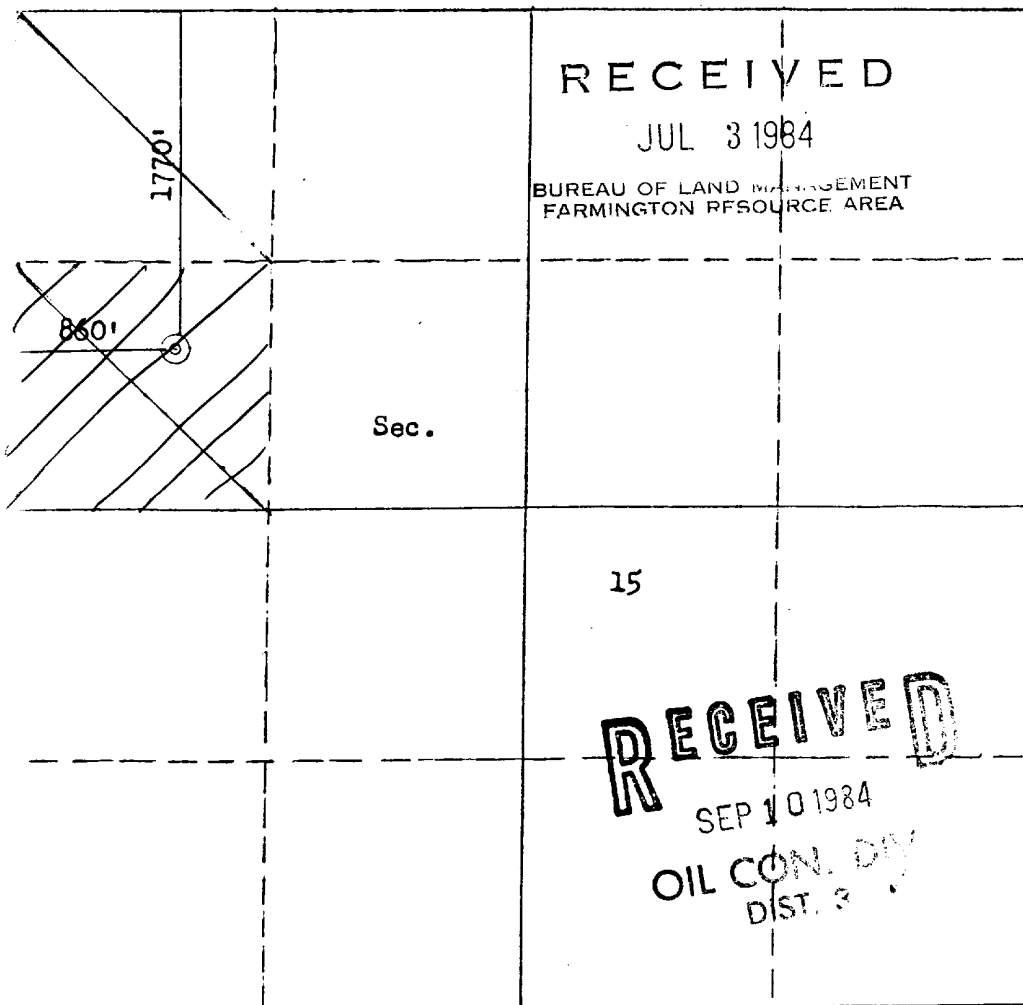

Scale: 1"=1000'

## CERTIFICATION

I hereby certify that the information contained herein is true and complete to the best of my knowledge and belief.

Name  
*W.B. Martin*  
Position  
President  
Company  
W.B. Martin & Associates  
Date  
June 28, 1984

I hereby certify that the well location shown on this plat was plotted from field notes of actual surveys made by me or under my supervision, and that the same is true and correct to the best of my knowledge and belief.

Date Surveyed  
June 25, 1984  
Registered Professional Engineer and Land Surveyor  
*Fred E. Kerr Jr.*  
Fred E. Kerr Jr.  
Certificate No. 3950

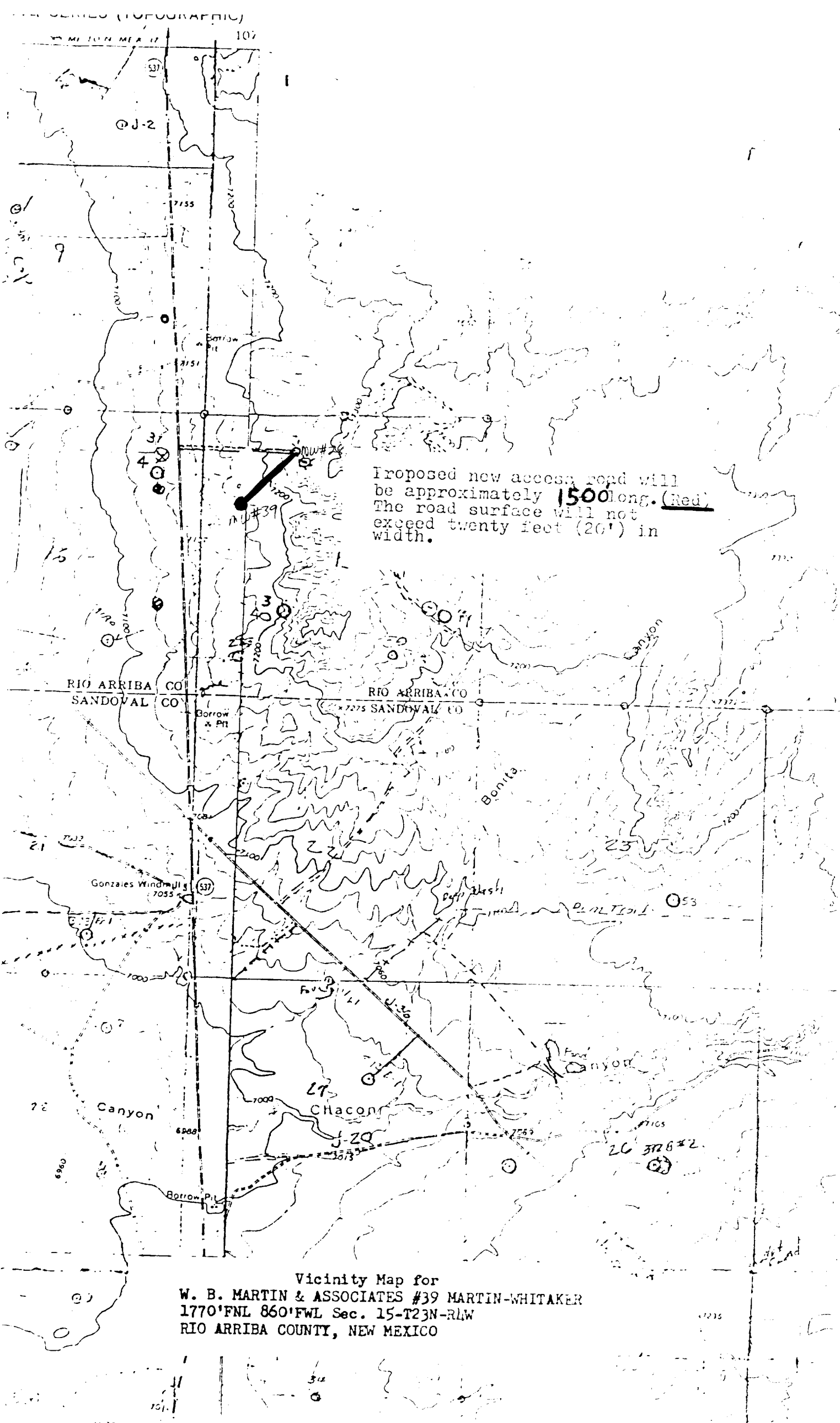

Proposed new access road will be approximately **1500** long. (Red) The road surface will not exceed twenty feet (20') in width.

Vicinity Map for  
W. B. MARTIN & ASSOCIATES #39 MARTIN-WHITAKER  
1770' FNL 860' FWL Sec. 15-T23N-RAW  
RIO ARRIBA COUNTY, NEW MEXICO