

UNITED STATES
DEPARTMENT OF THE INTERIOR
BUREAU OF LAND MANAGEMENT

APPLICATION FOR PERMIT TO DRILL, DEEPEN, OR PLUG BACK

1A. TYPE OF WORK
DRILL ☒ DEEPEN ☐ PLUG BACK ☐

b. TYPE OF WELL
OIL WELL ☒ (both) GAS WELL ☒ OTHER ☐ SINGLE ZONE ☒ MULTIPLE ZONE ☐

2. NAME OF OPERATOR
Amoco Production Company

3. ADDRESS OF OPERATOR
501 Airport Drive, Farmington, New Mexico 87401

4. LOCATION OF WELL (Report location clearly and in accordance with any State requirements.)*
At surface 2075' FSL X 2230' FEL

At proposed prod. zone
Same

14. DISTANCE IN MILES AND DIRECTION FROM NEAREST TOWN OR POST OFFICE*
20 miles northwest of Cuba, NM

15. DISTANCE FROM PROPOSED*
LOCATION TO NEAREST
PROPERTY OR LEASE LINE, FT.
(Also to nearest drlg. unit line, if any) 2075'

18. DISTANCE FROM PROPOSED LOCATION*
TO NEAREST WELL, DRILLING, COMPLETED,
OR APPLIED FOR, ON THIS LEASE, FT. 4000' E

21. ELEVATIONS (Show whether ~~DRILLING OPERATIONS~~ DRILLING OPERATIONS AUTHORIZED ARE
7330' GR SUBJECT TO COMPLIANCE WITH ATTACHED

23. "GENERAL REQUIREMENTS" PROPOSED CASING AND CEMENTING PROGRAM

SIZE OF HOLE	SIZE OF CASING	WEIGHT PER FOOT	SETTING DEPTH
12 - 1/4"	8 - 5/8"	24#, K-55	300'
7 - 7/8"	5 - 1/2"	15.5#, K-55	7620'

Amoco proposes to drill the above well to further develop the West Lindrith GP-DK reservoir. The well will be drilled to the surface casing point using native mud. The well will then be drilled to TD with a low solids nondispersed mud system. Completion design will be based on open hole logs. Copy of all logs will be filed upon completion. Amoco's standard blowout prevention will be employed; see attached drawing for blowout preventer design. Upon completion the well site will be cleaned and the reserve pit filled and leveled. The gas from this well is undedicated at this time.

RECEIVED

SEP 24 1984

OIL CON. DIV.

IN ABOVE SPACE DESCRIBE PROPOSED PROGRAM: If proposal is to deepen or plug back, give data on present productive zone and proposed new productive zone. If proposal is to drill or deepen directionally, give pertinent data on subsurface locations and measured true vertical depths. Give blowout preventer program, if any.

24. Original Signed By
SIGNED B. D. Shaw TITLE Adm. Supervisor

(This space for Federal or State office use)

PERMIT NO. APPROVAL DATE

APPROVED BY TITLE
CONDITIONS OF APPROVAL, IF ANY:

NMOC

*See Instructions On Reverse Side

Title 18 U.S.C. Section 1001, makes it a crime for any person knowingly and willfully to make to any department or agency of the United States any false, fictitious or fraudulent statements or representations as to any matter within its jurisdiction.

5. LEASE DESIGNATION AND SERIAL NO.
Jicarilla Tribal 396

6. IF INDIAN, ALLOTTEE OR TRIBE NAME
Jicarilla Apache

7. UNIT AGREEMENT NAME

8. FARM OR LEASE NAME
Jicarilla Tribal 396

9. WELL NO.
10

10. FIELD AND POOL, OR WILDCAT
West Lindrith GP-DK

11. SEC. T. R. M., OR BLK.
AND SURVEY OR AREA
NW/SE Sec. 18,
T23N, R3W

12. COUNTY OR PARISH
Rio Arriba

13. STATE
NM

22. APPROX. DATE WORK WILL START*
As soon as permitted

This action is subject to administrative appeal pursuant to 30 CFR 290.
QUANTITY OF CEMENT
354 ft³ Class B W/2% CACI₂
1585 ft³ Class B 50:50 poz W/6%
gel x .8% FLA. Tail-in
w/395 ft³ Class B neat.

APPROVED

8/24/84
DATE AS AMENDED

SEP 20 1984

/s/ J. Stan McKee

DATE
AREA MANAGER
FARMINGTON RESOURCE AREA

All distances must be from the outer boundaries of the Section.

Operator AMOCO PRODUCTION COMPANY			Lease JICARILLA CONTRACT 396		Well No. 10
Unit Letter J	Section 18	Township 23N	Range 3W	County Rio Arriba	
Actual Footage Location of Well: 2075 feet from the South line and 2230 feet from the East line					
Ground Level Elev. 7330	Producing Formation Gallup - Dakota		Pool West Lindrith GP-DK		Dedicated Acreage 160 Acres

1. Outline the acreage dedicated to the subject well by colored pencil or hachure marks on the plat below.
2. If more than one lease is dedicated to the well, outline each and identify the ownership thereof (both as to working interest and royalty).
3. If more than one lease of different ownership is dedicated to the well, have the interests of all owners been consolidated by communitization, unitization, force-pooling, etc?

☐ Yes ☒ No If answer is "yes," type of consolidation _____

If answer is "no," list the owners and tract descriptions which have actually been consolidated. (Use reverse side of this form if necessary.) _____

No allowable will be assigned to the well until all interests have been consolidated (by communitization, unitization, forced-pooling, or otherwise) or until a non-standard unit, eliminating such interests, has been approved by the Commission.

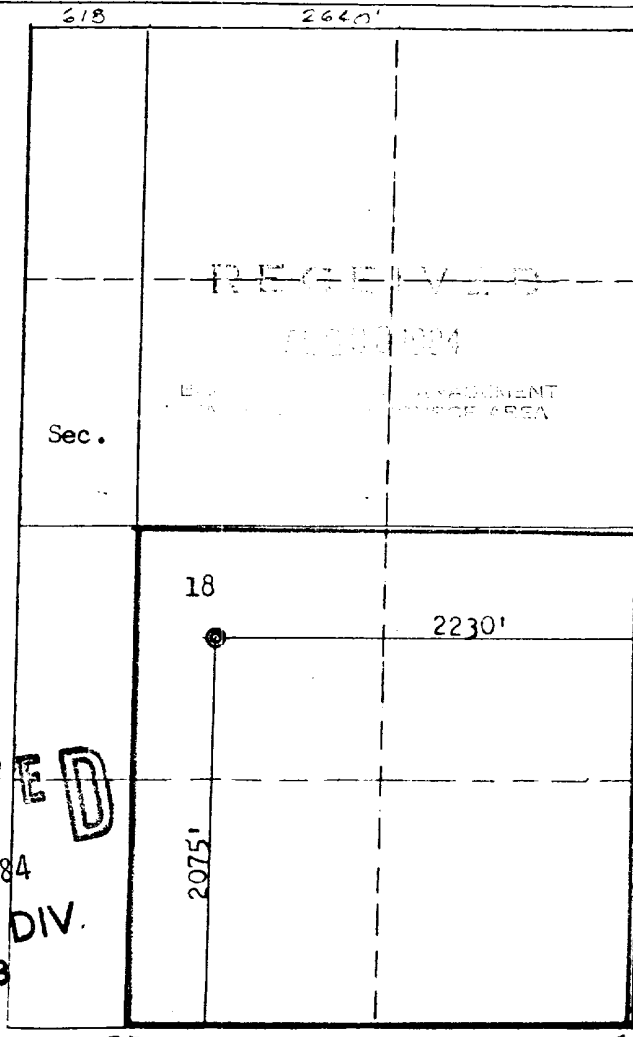

CERTIFICATION

I hereby certify that the information contained herein is true and complete to the best of my knowledge and belief.

B.D. Shaw
Name
B.D. Shaw
Position
Adm. Supervisor
Company
Amoco Production Company
Date
8/24/84

I hereby certify that the well location shown on this plat was plotted from field notes of actual surveys made by me or under my supervision, and that the same is true and correct to the best of my knowledge and belief.

Date Surveyed
July 27, 1984
Registered Professional Engineer and Land Surveyor
Fred E. Kerr Jr.
Fred E. Kerr Jr.
Certificate No. 4330
1950

